

Assembly Instructions

- 1) Attach *Strain Relief* (B) to *Plastic Enclosure* (C).
- 2) Pass *Cable* (A) through *Strain Relief* (B)/*Plastic Enclosure* (C) assembly, *Metal Spring* (D), and *Plastic Guide Ring* (E).
- 3) Solder cable wires to solder cups on *Pin Mold* (G).
- 4) Properly align *Pin Mold* (G) with *Lower Metal Sleeve* (H). The slotted sections on the sides of the *Pin Mold* (G) must line up with the slotted cut-outs on the *Lower Metal Sleeve* (H) and the 3 semi-circular notches around the perimeter of the *Pin Mold* (G) must line up with the 3 metal tabs inside the *Lower Metal Sleeve* (H).
- 5) Push *Pin Mold* (G) forward into the *Lower Metal Sleeve* (H) until it locks into place.
- 6) ***IMPORTANT*** Manually press the 3 metal tabs on the *Lower Metal Sleeve* (H) into the notches in the *Pin Mold* (G).
- 7) Crimp 'U' section of *Lower Metal Sleeve* (H) onto *Cable* (A).
- 8) Fit *Plastic Ring Guide* (E) into *Lower Metal Sleeve* (H) by placing plastic arms into the appropriate slots on the sides of the sleeve.
- 9) Attach *Top Metal Cover* (F) onto *Lower Metal Sleeve* (H). Be sure to align all tabs and securely install cover.
- 10) Push *Metal Spring* (D) onto the *Top Metal Cover* (F)/*Lower Metal Sleeve* (H) assembly. This will help to hold the assembly together.
- 11) Push *Strain Relief* (B)/*Plastic Enclosure* (C) assembly onto the *Top Metal Cover* (F)/*Lower Metal Sleeve* (H) assembly. The two assemblies must be properly aligned as shown in the drawing. Be sure to check that the *Metal Spring* (D) remains in place and does not go underneath either the *Plastic Enclosure* (C) or the *Plastic Guide* (E) or twists during assembly. A significant amount of force may be necessary to lock the two assemblies together.
- 12) Check to make sure that the *Strain Relief* (B)/*Plastic Enclosure* (C) assembly is securely locked into place over the *Top Metal Cover* (F)/*Lower Metal Sleeve* (H) assembly. The two assemblies should not be able to be pulled apart.
- 13) Properly align the new assembly with the *Plastic Coupling* (I) as shown in the drawing. Push assembly (twisting plastic enclosure "C" part) into *Plastic Coupling* (I) until it locks properly into place. The entire plug assembly is now complete.

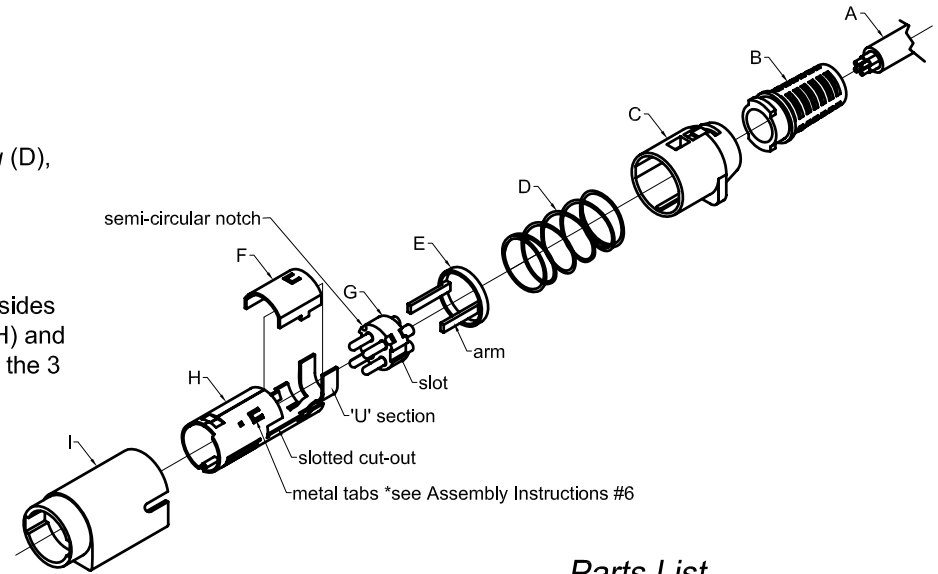

Parts List

- A - Customer Cable
- B - Strain Relief
- C - Plastic Enclosure
- D - Metal Spring
- E - Plastic Guide
- F - Top Metal Cover
- G - Pin Mold
- H - Lower Metal Sleeve
- I - Plastic Coupling



REV.	DATE	DESCRIPTION	REV. BY	CHK. BY	DRAWN BY	DATE
A1	9/21/05	New Drawing	H. MA	C. Furumasu	H. MA	9/21/05
A2	11/29/06	ECO 06-051	R. Aguirre	H. Ma		
A3	07/24/07	ECO 07-028	A. Frederick	R. Aguirre		

KPPX Series Assembly

KPPX Series Assembly
Parts List & Instructions

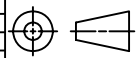

UNITS
mm