

**Materials and Finish**

Housing: PBT Thermoplastic  
 15% Glass Filled, Black  
 UL 94V-0 Rated

Terminals: Copper Alloy,  
 100u" Tin over  
 50u" Nickel underplating

**Mechanical Characteristics**

Insertion Force:  
 0.4kg - 3.0kg  
 Extraction Force:  
 0.3kg - 3.0kg  
 Durability: 5000 mating cycles

**Electrical Characteristics**

Contact Resistance:  
 Before Test: 50 milliohms max.  
 After Durability Test:  
 100 milliohms max.  
 Insulation Resistance:  
 More than 100 Megohms  
 at 500V DC  
 Dielectric Strength:  
 500V AC RMS for 1 minute  
 Operating Temp:  
 -25°C to +85°C

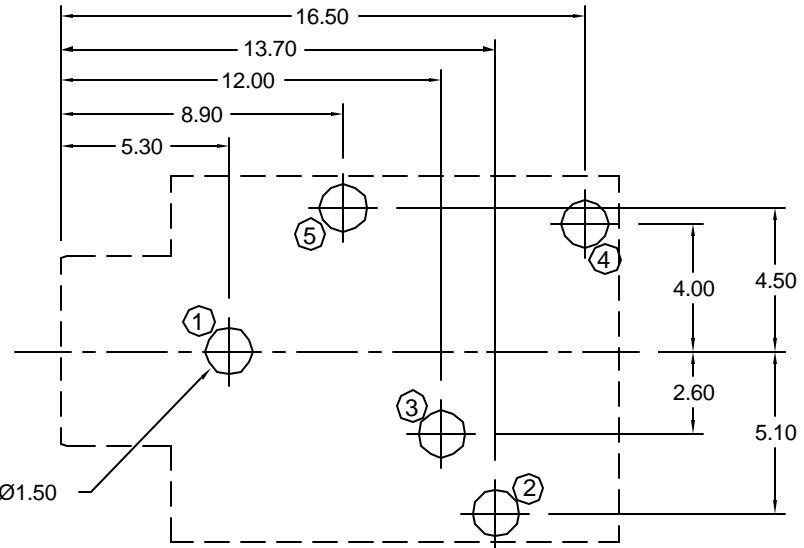
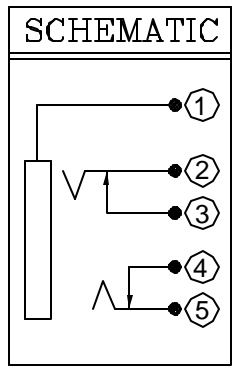

PCB LAYOUT  
 (BOTTOM VIEW)

**RoHS COMPLIANT**  
 EU Directive 2002/95/EC

Tolerances	
X.X ± 0.25	
X.XX ± 0.15	
Unless Stated Otherwise	



REV.	DATE	DESCRIPTION	REV. BY	CHK. BY	DRAWN BY	DATE
A0	9/22/05	New Drawing	R. Aguirre	H. MA	R. Aguirre	07/11/05
A1	6/2/06	Release Drawing	H. MA	N/A		

**STX-3081-5C**

Low Profile Stereo Jack, 5 pos, RoHS Compliant

Metal Bushing, Threaded Barrel

