

Materials and Finish

Housing: PBT Thermoplastic
15% Glass Filled, Black Color,
UL 94V-0 Rated

Terminals: Copper Alloy,
100u" Tin over
50u" Nickel Underplating

Mechanical Characteristics

Insertion Force:
0.4kg - 3.0kg

Extraction Force:
0.3kg - 3.0kg

Durability: 5000 mating cycles

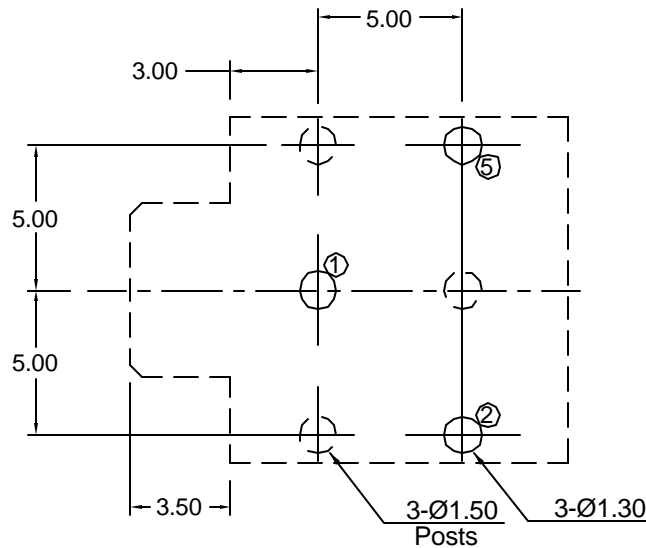
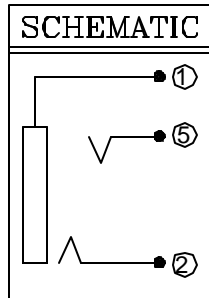

Recommended PCB Layout
(Bottom View)

Electrical Characteristics

Contact Resistance:
Before Test: 50 milliohms Max.
After Durability Test:
100 milliohms Max.

Insulation Resistance:
More than 100 Megohms
at 500V DC

Dielectric Strength:
500V AC RMS for 1 minute

Operating Temp:
-25°C to +85°C



Tolerances
X.X ± 0.25
X.XX ± 0.15
Unless Stated Otherwise

REV.	DATE	DESCRIPTION	REV. BY	CHK. BY	DRAWN BY	DATE
A0	9/22/05	New Drawing	R. Aguirre	H.MA	R. Aguirre	07/14/05
A1	6/2/06	Release Drawing	H. MA	N/A		

STX-3120-3B

Stereo Jack , RoHS Compliant

3-Position

