

**Materials and Finish**

Housing Material-  
PBT thermoplastic  
UL 94V-0 rated

Contact Material-  
phosphor bronze

**Contact Plating Options-**

Standard: gold flash over  
nickel on entire contact

15: 15u" gold over  
nickel on entire contact

50: 50u" gold over  
nickel on entire contact to  
comply with FCC Requirements  
under No. 47 C.F.R. Part 68,  
Subpart F

**Electrical Characteristics**

Current Rating-  
1.5 Amps

Voltage Rating-  
125V DC

Insulation Resistance-  
500 Megohms min.

Dielectric Withstanding Voltage-  
1000V rms, 60Hz

Contact Resistance-  
20 milliohms max.

PCB Edge

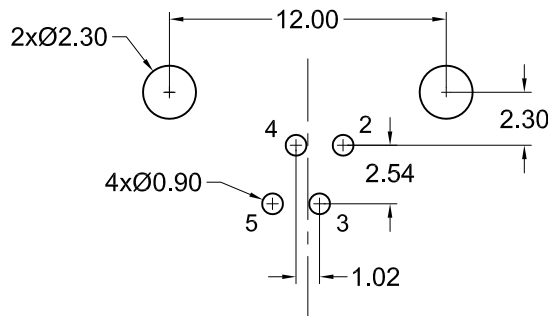

Recommended PCB Layout  
(Bottom View)

Part Number	Contact Area Plating Finish	Color
GLX-A-64	Gold Flash (standard)	Grey
GLX-A-64-15	15u" Gold (15 option)	Grey
GLX-A-64-50	50u" Gold (50 option)	Grey
GLX-A-64-BLK	Gold Flash (standard)	Black

ROHS COMPLIANT

UL  
E134345

SP  
LR78160

Tolerances
X.X ± 0.35
X.XX ± 0.25
Unless Stated Otherwise

REV.	DATE	DESCRIPTION	REV. BY	CHK. BY	DRAWN BY	DATE
A3	02/27/09	ECO #09-023	S. Vien	H. MA	R. Aguirre	9/09/05
A4	07/30/09	ECO #09-055	S. Vien	H. MA		
A5	05/13/10	ECO #10-025	S. Vien	H. MA		
A6	12/07/11	ECO #11-081	S. Vien	H. MA		UNITS
A7	12/12/13	ECO #13-091	D. Gih	H. MA		
A8	05/30/17	Updated Address	H. MA	N/A		

**GLX-A-64**

Mod. Jack, Rt Ang., PCB Mount

6 Position, 4 Contacts, RoHS Compliant

