

**Terminal blocks**

to **Type 020**

- Type 009** page 93
- Type 026** page 129
- Type 049** page 93

to **Type 320**

- ASP045** page 49
- Type 313** page 96
- Type 314** page 96
- Type 349** page 94
- Type 350** page 94

**Accessories**

for **Type 320**  
Coding set  
700024 page 206

**Type 020**

Header, centerline 5 mm / 0.197 inches, vertical mounting, round contact pins 1.3 mm / 0.051 inches, closed ends

**Technical Data**

	V / A	300 / 15
	V / A	300 / 15
		250 V / 4 kV / 10 A
Insulation co-ordination according to EN 60664-1		
Clearance and creepage distances	min. 3.7 mm	
Insulating material class	CTI 600	
Overvoltage category	III	III II
Pollution degree	3	2 2
Rated voltage	250	630 630
Rated test voltage	2.5	6 4
Protection category according to IEC 529	IP00	
Solder pin dimension	1 mm	
Recommended pc board hole dia.	Ø 1.3 mm	
Solder pin length	5.2 mm	
Pole size	2 - 22	
Color	black	

Dimensions in mm 1 mm = 0.0394 in.

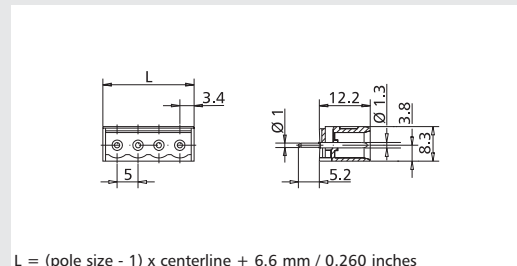

**Part numbers (P/N)**

(information: page 110)

Complete the part number by adding the pole size.

**Type 020**

centerline 5 mm / 0.197 inches

P/N 310201

	02	03	04	05	06	07	08
09	10	11	12	13	14	15	16
17	18	19	20	21	22		

**Type 020**

centerline 10 mm / 0.394 inches

P/N 310202

	02	03	04	05	06	07	08
09	10	11					

Standard pole sizes

Available on demand. Minimum order quantity 5000 pieces per item.

**Type 320**

Header, centerline 5 mm / 0.197 inches, vertical square contact pins 1 mm / 0.039 inches, closed ends, codable

**Technische Daten**

	V / A	300 / 15
		320 V / 4 kV / 10 A
Insulation co-ordination according to EN 60664-1		
Clearance and creepage distances	min. 4 mm	
Insulating material class	CTI 600	
Overvoltage category	III	III II
Pollution degree	3	2 2
Rated voltage	320	800 800
Rated test voltage	4	6 4
Protection category according to IEC 529	IP00	
Solder pin dimension	1.0 x 1.0 mm	
Recommended pc board hole dia.	Ø 1.5 mm	
Solder pin length	3.25 mm	
Pole size	2 - 24	
Color	black	

Dimensions in mm 1 mm = 0.0394 in.

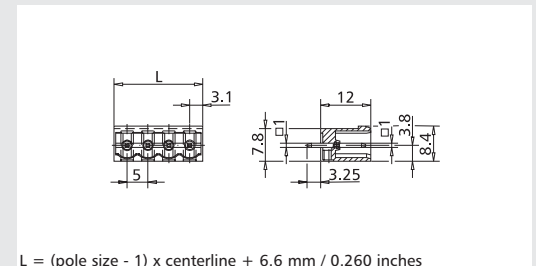

**Part numbers (P/N)**

(information: page 110)

Complete the part number by adding the pole size.

**Type 320**

centerline 5 mm / 0.197 inches

P/N 313201

	02	03	04	05	06	07	08
09	10	11	12	13	14	15	16
17	18	19	20	21	22	23	24

Standard pole sizes

Available on demand. Minimum order quantity 5000 pieces per item.