

0906-0

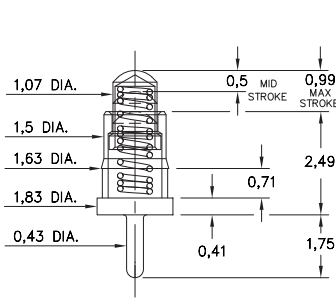

0906-0-15-20-76-14-11-0

Short Stroke

Solder mount in 0,46 min. mounting hole

0906-1⇒4

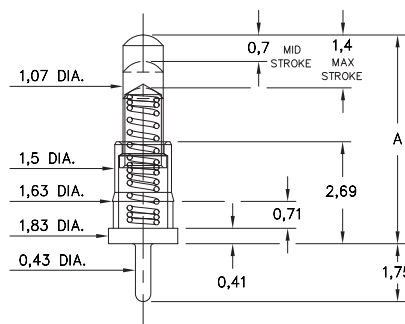

0906-X-15-20-75-14-11-0

Standard Stroke

Solder mount in 0,46 min. mounting hole

| Basic Part Number | Length A |
|-------------------|----------|
| 0906-1 | 4,5 |
| 0906-2 | 5,0 |
| 0906-3 | 5,51 |
| 0906-4 | 5,99 |

0930

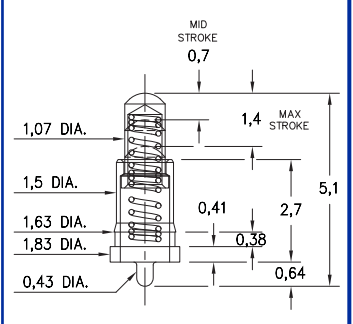

0930-0-15-20-75-14-11-0

Standard Stroke

Solder Mount in 0,46 min. mounting hole

0914

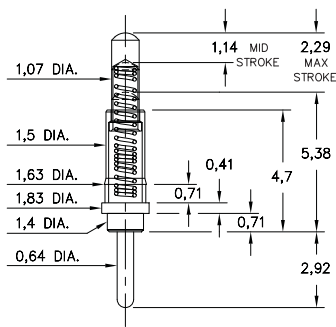

0914-0-15-20-77-14-11-0

Long Stroke

Solder mount in 0,69 min. mounting hole

0932

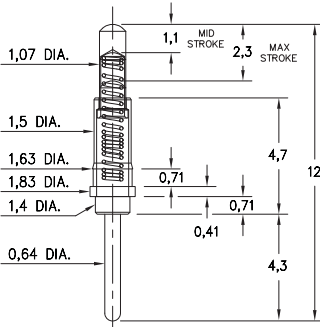

0932-0-15-20-77-14-11-0

Long Stroke

Solder Mount in 0,69 min. mounting hole

0908-0⇒9

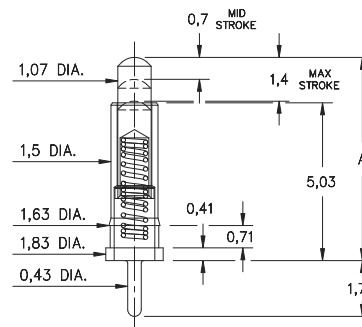

0908-X-15-20-75-14-11-0

Standard Stroke

Solder mount in 0,46 min. mounting hole

| Basic Part Number | Length A |
|-------------------|----------|
| 0908-0 | 6,48 |
| 0908-1 | 6,99 |
| 0908-2 | 7,49 |
| 0908-3 | 8,0 |
| 0908-4 | 8,51 |
| 0908-5 | 8,89 |
| 0908-6 | 9,4 |
| 0908-7 | 9,91 |
| 0908-8 | 10,41 |
| 0908-9 | 10,92 |

0901

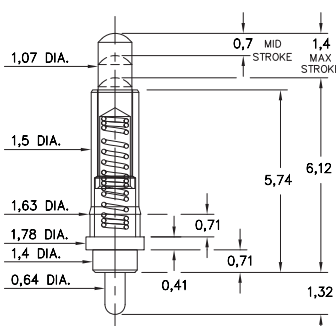

0901-0-00-00-00-00-11-0

Standard Stroke

Solder mount in 0,69 min. mounting hole

0929

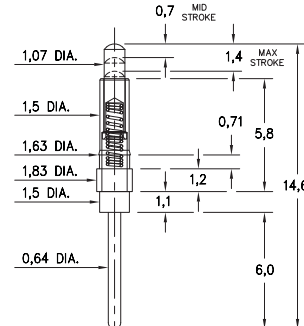

0929-0-15-20-75-14-11-0

Standard Stroke

Solder Mount in 0,69 min. mounting Hole

0922

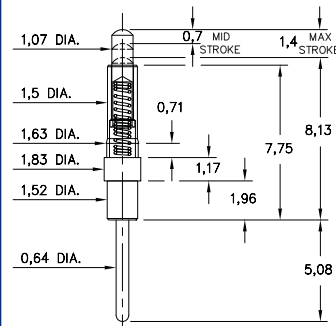

0922-0-15-20-75-14-11-0

Standard Stroke

Solder mount in 0,69 min. mounting hole

0980

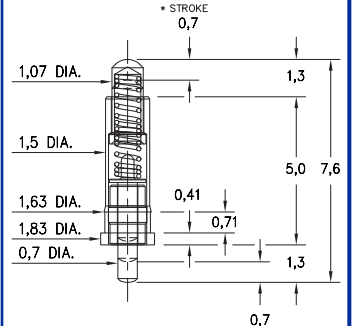

0980-0-15-20-75-14-11-0

Double action, *1,4 Combined Stroke

Mount between parallel circuit boards

ORDER CODE: 09XX - X - 15 - 20 - 7X - 14 - 11 - 0

Spring Number ↗

MATERIAL SPECIFICATIONS:

- SLEEVE & PLUNGER MATERIAL:** Copper Alloy
- SPRING MATERIAL:** Beryllium Copper
- SLEEVE & PLUNGER FINISH:** 0,51 µm Gold over Nickel
- SPRING FINISH:** 0,25 µm Gold over Nickel
- DIMENSION IN INCHES:**
- TOLERANCES ON:** LENGTHS: ±0,15
DIAMETERS: ±0,05
ANGLES: ± 2°



MECHANICAL & ELECTRICAL SPECIFICATIONS:

DURABILITY: 1,000,000 cycles

CURRENT RATING: 2A continuous, 3A peak

CONTACT RESISTANCE: 20 mΩ max.

| SPRING NUMBER | Mid. STROKE | Max. STROKE | FORCE @ Mid. Stroke | Initial Force (Pre-load) |
|---------------|-------------|-------------|---------------------|--------------------------|
| 75 | 0,7 | 1,4 | 60 g | 25 g |
| 76 | 0,5 | 0,99 | 60 g | 25 g |
| 77 | 1,14 | 2,29 | 60 g | 25 g |

75, 76, 77 Springs are not interchangeable