

| PART NO.. | ENG. NUMBER | TERMINAL LOCATION (SEE CHART) | MAT'L | PEG TYPE | PLATING (SEE CHART) | DIA. "A" |
|------------|-------------|-------------------------------|-------|------------|---------------------|--|
| 10-18-1031 | A-3099-P3 | A | V-0 | POLARIZING | B | $.100 \pm .005$ (2.54 ± 0.13) |
| 10-18-1032 | A-3099-P3I | B | | POLARIZING | | |
| 10-18-1033 | A-3099-P3A | C | | POLARIZING | | |
| 10-18-1034 | A-3099-P3B | D | | POLARIZING | | |
| 10-18-1035 | A-3099-P3C | E | | POLARIZING | | |
| 10-18-1036 | A-3099-P3D | F | | POLARIZING | | |
| 10-18-1037 | A-3099-P3H | G | | POLARIZING | | |
| 10-18-1038 | A-3099-P3E | H | | POLARIZING | | |
| 38-00-0204 | A-3099-P3I3 | B | | NONE | | |
| 22-19-1031 | A-3099-030I | A | | LOCKING | | $.103 \pm .003 / -.002$ (2.62 ± 0.08 / -0.05) |

| TERMINAL LOCATION CHART (M=MALE, F=FEMALE, B=BLANK) | | | |
|---|-------------|---|---|
| TERMINAL LOCATION CODE | CIRCUIT NO. | | |
| | 1 | 2 | 3 |
| A | M | B | M |
| B | M | M | M |
| C | F | M | M |
| D | M | F | M |
| E | M | M | F |
| F | M | F | B |
| G | M | F | F |
| H | F | F | F |

| PLATING CODE | PLATING |
|--------------|--|
| A | UNPLATED |
| B | PINS ONLY: OVERALL TIN: .000200/(0.00508) MIN. OVER COPPER .000100/(0.00254) MIN. |
| | SOCKETS ONLY: OVERALL TIN: .000050/(0.00127) MIN. OVER NICKEL .000050/(0.00127) MIN. |

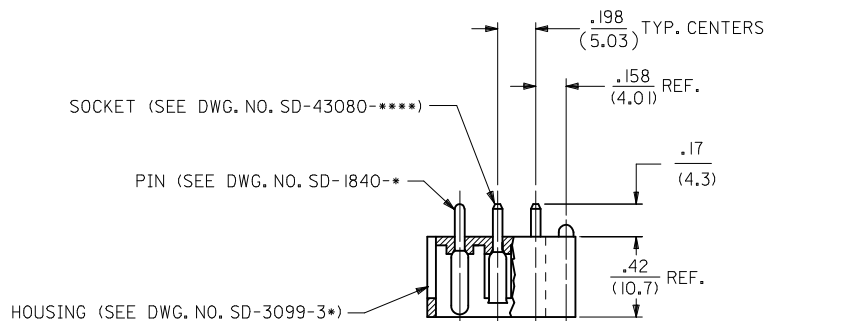

HOUSING WITH POLARIZING PEG SHOWN

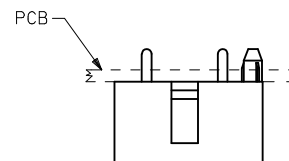

HOUSING WITH LOCKING PEG SHOWN

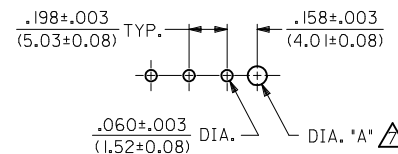
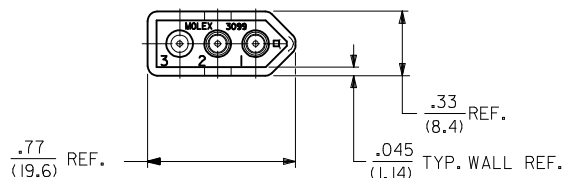

RECOMMENDED P.C. BOARD HOLE LAYOUT

NOTES:

- MATERIAL:
HOUSING: UNFILLED POLYESTER, 94V-0, COLOR: BLACK
PIN TERMINAL: CARTRIDGE BRASS
SOCKET TERMINAL: PHOSPHOR BRONZE
 - FINISH: SEE TABLE
 - PRODUCT SPECIFICATION: N/A
 - PACKAGING SPECIFICATION: PK-3099-002
 - MATES WITH MOLEX 1396 RECEPTACLES AND .093/(2.36) SERIES TERMINALS.
 - ASSEMBLIES TO BE MOUNTED ON SUPPORTED EDGE OF P.C. BOARD.
- ▲ ONLY REQUIRED WHEN USING PARTS WITH OPTIONAL POLARIZING OR LOCKING PEGS.

| ADD PKG SPECS EC NO: UCP2013-4695 DRW: NAEHAG 2013/04/30 CHKD: JEBEL 2013/04/30 APPR: FSMITH 2013/05/13 DESCRIPTION: | QUALITY SYMBOLS ▽=0 ▽=0 | GENERAL TOLERANCES (UNLESS SPECIFIED) <table border="1"> <thead> <tr> <th></th> <th>mm</th> <th>INCH</th> </tr> </thead> <tbody> <tr> <td>4 PLACES</td> <td>± .010</td> <td>± .0004</td> </tr> <tr> <td>3 PLACES</td> <td>± .015</td> <td>± .0006</td> </tr> <tr> <td>2 PLACES</td> <td>± 0.25</td> <td>± .010</td> </tr> <tr> <td>1 PLACE</td> <td>± 0.36</td> <td>± .014</td> </tr> </tbody> </table> | | mm | INCH | 4 PLACES | ± .010 | ± .0004 | 3 PLACES | ± .015 | ± .0006 | 2 PLACES | ± 0.25 | ± .010 | 1 PLACE | ± 0.36 | ± .014 | DIMENSION STYLE IN/MM | SCALE 2:1 | DESIGN UNITS INCH | THIRD ANGLE PROJECTION |
|---|---|--|------|----|------|----------|--------|---------|----------|--------|---------|----------|--------|--------|---------|--------|--------|---------------------------------|---------------------|-----------------------------|------------------------|
| | | mm | INCH | | | | | | | | | | | | | | | | | | |
| 4 PLACES | ± .010 | ± .0004 | | | | | | | | | | | | | | | | | | | |
| 3 PLACES | ± .015 | ± .0006 | | | | | | | | | | | | | | | | | | | |
| 2 PLACES | ± 0.25 | ± .010 | | | | | | | | | | | | | | | | | | | |
| 1 PLACE | ± 0.36 | ± .014 | | | | | | | | | | | | | | | | | | | |
| DRAWN BY: GEP DATE: 5/25/89 CHECKED BY: RW DATE: 5/25/89 APPROVED BY: RAS DATE: 5/25/89 MATERIAL NO.: SEE CHART DOCUMENT NO.: SDA-3099-3** SHEET NO.: 1 OF 1 | CONNECTOR ASSEMBLY ENCLOSED WAFER 3 CIRCUIT MOLEX INCORPORATED | | | | | | | | | | | | | | | | | | | | |
| DRAFT WHERE APPLICABLE MUST REMAIN WITHIN DIMENSIONS | | THIS DRAWING CONTAINS INFORMATION THAT IS PROPRIETARY TO MOLEX INCORPORATED AND SHOULD NOT BE USED WITHOUT WRITTEN PERMISSION | | | | | | | | | | | | | | | | | | | |