

NOTES:

1. MATERIAL:
HOUSING MATERIAL: SEE CHART
TERMINAL MATERIAL: BRASS ALLOY
2. FINISH: SEE CHART
3. PRODUCT SPECIFICATION: PS-5556-001
4. PACKAGING SPECIFICATION: TBD
5. MATES WITH 5557 SERIES MINIFIT JR RECEPTACLE
- △ FOR THE 2 CIRCUITS HEADER, THIS DIMENSION IS 4.2 MM
7. DISCOLORATION IN THE BANDOLIER CARRIER AREA OF THE PIN IS INHERENT TO THE PLATING PROCESS AND IS DUE TO THE MASKING EFFECT OF THE CARRIER. THIS DISCOLORATION IS IN A NON-FUNCTIONAL AREA OF THE PIN AND WILL NOT AFFECT THE PERFORMANCE OF THE HEADER ASSEMBLY.
8. PARTS ARE NOT DESIGNED FOR CURRENT SHARING.
9. CONNECTORS ARE NOT TO BE MATED OR UNMATED WHILE CIRCUITS ARE LIVE.
10. PART CONFORMS TO CLASS "B" REQUIREMENTS OF COSMETIC SPECIFICATION PS-45499-002.
- △ FORMING MARKS ON PINS ARE ACCEPTABLE.

ENG. NO.	HEADER MATERIAL	FINISH OF PIN
5569-NA1	NYLON 66, UL94V-2, COLOR: NATURAL	
▲ -NA1-210	NYLON 66, UL94V-0, COLOR: NATURAL	MATTE TIN 2.54 μm MIN. OVER NICKEL 1.27 μm MIN.
-NAIS	NYLON 66, UL94V-2, COLOR: NATURAL	
-NAIS-210	NYLON 66, UL94V-0, COLOR: NATURAL	
-NAG1	NYLON 66, UL94V-2, COLOR: NATURAL	
-NAG1-210	NYLON 66, UL94V-0, COLOR: NATURAL	GOLD 0.76 μm MIN. AND TIN OVER 2.54 μm MIN. OVER NICKEL 1.27 μm MIN.
-NA1GS	NYLON 66, UL94V-2, COLOR: NATURAL	
-NA1GS-210	NYLON 66, UL94V-0, COLOR: NATURAL	GOLD 0.76 μm MIN. AND TIN OVER 2.54 μm MIN. OVER NICKEL 1.27 μm MIN.
-NAIGS2	NYLON 66, UL94V-2, COLOR: NATURAL	
-NAIGS2-210	NYLON 66, UL94V-0, COLOR: NATURAL	GOLD 0.38 μm MIN. AND TIN OVER 2.54 μm MIN. OVER NICKEL 1.27 μm MIN.
▼ -NAIGS3	NYLON 66, UL94V-2, COLOR: NATURAL	
5569-NAIGS3-210	NYLON 66, UL94V-0, COLOR: NATURAL	GOLD 1.27 μm MIN. AND TIN OVER 2.54 μm MIN. OVER NICKEL 1.27 μm MIN.

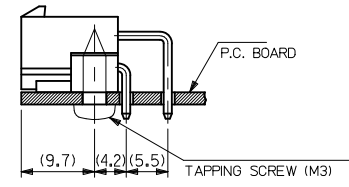
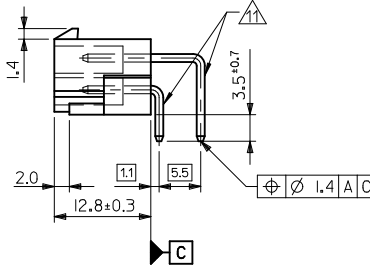
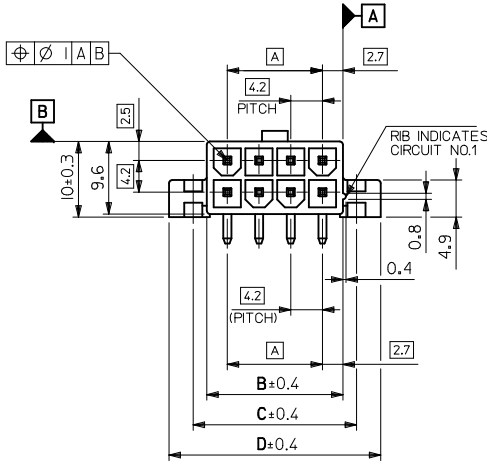
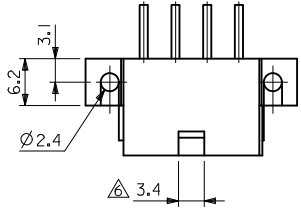

RECOMMENDED INSTALLATION

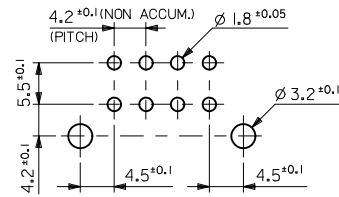

RECOMMENDED PCB HOLE LAYOUT
VIEWED FROM COMPONENT SIDE
1.78 MAX. THICK P.C. BOARD

61.6	55.2	51.6	46.2	24
57.4	51	47.4	42	22
53.2	46.8	43.2	37.8	20
49	42.6	39	33.6	18
44.8	38.4	34.8	29.4	16
40.6	34.2	30.6	25.2	14
36.4	30	26.4	21	12
32.2	25.8	22.2	16.8	10
28	21.6	18	12.6	8
23.8	17.4	13.8	8.4	6
19.6	13.2	9.6	4.2	4
15.4	9	5.4	—	2

D	C	B	A	NO. OF CIRCUITS
12	11	10	9	8

CHANGE PLATING	DESCRIPTION	QUALITY SYMBOLS
EC NO: UCP2012-1560	2011/10/14	▽=0
DRWINHNGUYEN	2011/10/14	▽=0
CHKD:JBELL	2012/02/02	▽=0
APPR:FSMITH		

GENERAL TOLERANCES (UNLESS SPECIFIED)	DIMENSION STYLE	SCALE	DESIGN UNITS	THIRD ANGLE PROJECTION
	MM ONLY	2:1	METRIC	
4 PLACES ± ---	mm			
3 PLACES ± ---	INCH			
2 PLACES ± 0.2				
1 PLACE ± 0.2				
ANGULAR ± 3 °				

DRAWN BY	DATE	CHECKED BY	DATE	TITLE
H. HIRAMOTO	'90/04/23	M. FUKUSHIMA	'91/07/04	MINI FIT JR RIGHT ANGLE HEADER ASSY WITH FLANGES
M. ENOMOTO	'91/07/04			

MATERIAL NO.		DOCUMENT NO.		SHEET NO.
SEE TABLE		SD-5569-002		1 OF 2
DRAFT WHERE APPLICABLE MUST REMAIN WITHIN DIMENSIONS				
THIS DRAWING CONTAINS INFORMATION THAT IS PROPRIETARY TO MOLEX INCORPORATED AND SHOULD NOT BE USED WITHOUT WRITTEN PERMISSION				

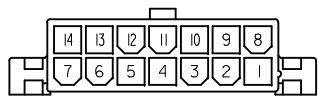

14 CKTS.

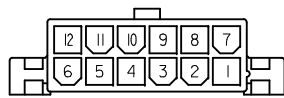

12 CKTS.

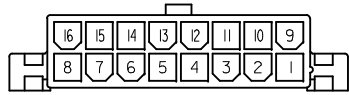

16 CKTS.

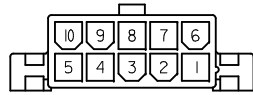

10 CKTS.

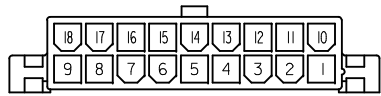

18 CKTS.

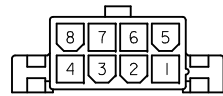

8 CKTS.

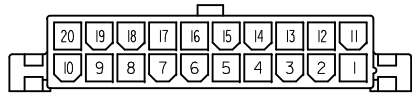

20 CKTS.

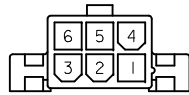

6 CKTS.

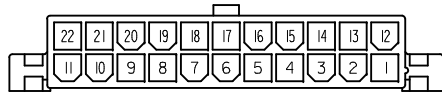

22 CKTS.

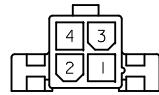

4 CKTS.

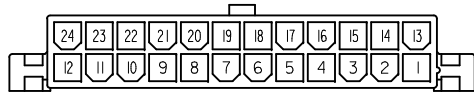

24 CKTS.

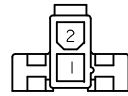

2 CKTS.

CIRCUIT SIZE LAYOUT
(SCALE 2:1)

39-29-4249	5569-24AG1-210	39-29-1247	5569-24A1-210	24
▲ -4229	▲ -22AG1-210	▲ -1227	▲ -22A1-210	22
-4209	-20AG1-210	-1207	-20A1-210	20
-4189	-18AG1-210	-1187	-18A1-210	18
-4169	-16AG1-210	-1167	-16A1-210	16
-4149	-14AG1-210	-1147	-14A1-210	14
-4129	-12AG1-210	-1127	-12A1-210	12
-4109	-10AG1-210	-1107	-10A1-210	10
-4089	-08AG1-210	-1087	-08A1-210	8
-4069	-06AG1-210	-1067	-06A1-210	6
▼ -4049	▼ -04AG1-210	▼ -1047	▼ -04A1-210	4
39-29-4029	5569-02AG1-210	39-29-1027	5569-02A1-210	2
EDP NO.	ENG. NO.	EDP NO.	ENG. NO.	CIRCUIT SIZE
5569-NAG1-210		5569-NA1-210		
39-29-5243	5569-24AG1	39-29-1248	5569-24A1	24
▲ -5223	▲ -22AG1	▲ -1228	▲ -22A1	22
-5203	-20AG1	-1208	-20A1	20
-5183	-18AG1	-1188	-18A1	18
-5163	-16AG1	-1168	-16A1	16
-5143	-14AG1	-1148	-14A1	14
-5123	-12AG1	-1128	-12A1	12
-5103	-10AG1	-1108	-10A1	10
-5083	-08AG1	-1088	-08A1	8
-5063	-06AG1	-1068	-06A1	6
▼ -5043	▼ -04AG1	▼ -1048	▼ -04A1	4
39-29-5023	5569-02AG1	39-29-1028	5569-02A1	2
EDP NO.	ENG. NO.	EDP NO.	ENG. NO.	CKT. SIZE
5569-NAG1		5569-NA1		

39-31-4249	5569-24AIS-210					39-34-7241	5569-24A1GS-210	24
▲ -4229	▲ -22AIS-210					▲ -7221	▲ -22A1GS-210	22
-4209	-20AIS-210					-7201	-20A1GS-210	20
-4189	-18AIS-210					-7181	-18A1GS-210	18
-4169	-16AIS-210					-7161	-16A1GS-210	16
-4149	-14AIS-210					-7141	-14A1GS-210	14
-4129	-12AIS-210					-7121	-12A1GS-210	12
-4109	-10AIS-210					-7101	-10A1GS-210	10
-4089	-08AIS-210					-7081	-08A1GS-210	8
-4069	-06AIS-210					-7061	-06A1GS-210	6
▼ -4049	▼ -04AIS-210	39-34-7045	5569-04A1GS3-210	39-34-7043	5569-04A1GS2-210	▼ -7041	▼ -04A1GS-210	4
39-31-4029	5569-02AIS-210	39-34-7025	5569-02A1GS3-210	39-34-7023	5569-02A1GS2-210	39-34-7021	5569-02A1GS-210	2
EDP NO.	ENG. NO.	EDP NO.	ENG. NO.	EDP NO.	ENG. NO.	EDP NO.	ENG. NO.	CKT. SIZE
5569-NAIS-210		5569-NA1GS3-210		5569-NA1GS2-210		5569-NA1GS-210		
39-31-4248	5569-24AIS					39-34-7240	5569-24A1GS	24
▲ -4228	▲ -22AIS					▲ -7220	▲ -22A1GS	22
-4208	-20AIS					-7200	-20A1GS	20
-4188	-18AIS					-7180	-18A1GS	18
-4168	-16AIS					-7160	-16A1GS	16
-4148	-14AIS					-7140	-14A1GS	14
-4128	-12AIS					-7120	-12A1GS	12
-4108	-10AIS					-7100	-10A1GS	10
-4088	-08AIS					-7080	-08A1GS	8
-4068	-06AIS					-7060	-06A1GS	6
▼ -4048	▼ -04AIS	39-34-7044	5569-04A1GS3	39-34-7042	5569-04A1GS2	▼ -7040	▼ -04A1GS	4
39-31-4028	5569-02AIS	39-34-7024	5569-02A1GS3	39-34-7022	5569-02A1GS2	39-34-7020	5569-02A1GS	2
EDP NO.	ENG. NO.	EDP NO.	ENG. NO.	EDP NO.	ENG. NO.	EDP NO.	ENG. NO.	CKT. SIZE
5569-NAIS		5569-NA1GS3		5569-NA1GS2		5569-NA1GS		

SEE SHEET 1 EC NO: UCP2012-1560 DRW: NGUYEN 2011/10/14 CHKD: JIBELL 2011/10/14 APPR: FSM/TH 2012/02/02	QUALITY SYMBOLS 	GENERAL TOLERANCES (UNLESS SPECIFIED)		DIMENSION STYLE MM ONLY		SCALE 2:1	DESIGN UNITS METRIC	THIRD ANGLE PROJECTION	
		4 PLACES ± --- ± --- 3 PLACES ± --- ± --- 2 PLACES ± 0.2 ± --- 1 PLACE ± 0.2 ± ---		DRAWN BY DATE H. HIRAMOTO '90/04/23		TITLE MINI FIT JR RIGHT ANGLE HEADER ASSY WITH FLANGES			
		ANGULAR ± 3 °		CHECKED BY DATE M. FUKUSHIMA '91/07/04		APPROVED BY DATE M. ENOMOTO '91/07/04			
		DRAFT WHERE APPLICABLE MUST REMAIN WITHIN DIMENSIONS		MATERIAL NO. SEE TABLE		DOCUMENT NO. SD-5569-002		SHEET NO. 2 OF 2	

THIS DRAWING CONTAINS INFORMATION THAT IS PROPRIETARY TO MOLEX INCORPORATED AND SHOULD NOT BE USED WITHOUT WRITTEN PERMISSION