

LOOSE PIECE		TAPE MOUNTED		SPECIFICATIONS		
MATERIAL NUMBER	ENGINEERING NUMBER	MATERIAL NUMBER	ENGINEERING NUMBER	STUD SIZE	"S" ±.005 [0.13]	"H" REF
190710188	E-657-10X	190710189	E-657-10XT	10	.198 [5.03]	1.172 [29.77]
190710190	E-657-14X	190710192	E-657-14XT	1/4	.265 [6.73]	
190710193	E-657-38X	190710195	E-657-38XT	3/8	.390 [9.91]	
190710196	E-657-56X	190710198	E-657-56XT	5/16	.328 [8.33]	

C1

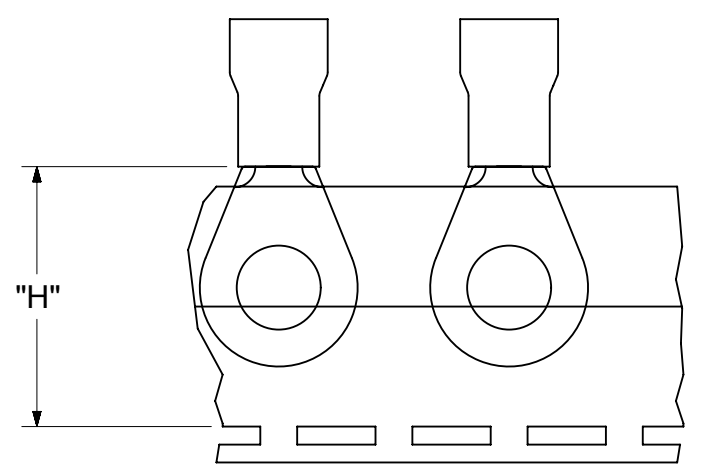
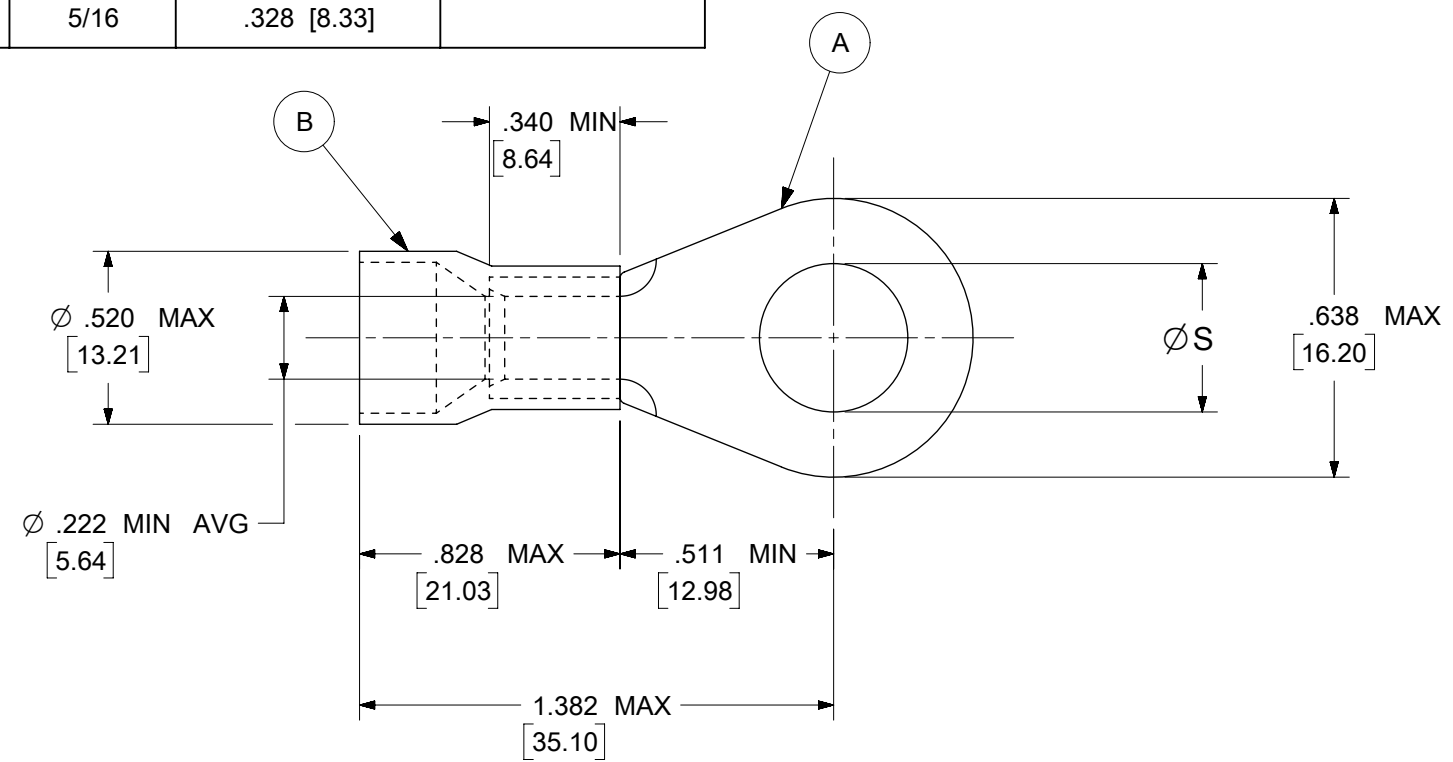

PARTS ON TAPE

- NOTES:
- MATERIAL:
 - (A). TERMINAL: COPPER ALLOY
 - PLATING: ELECTRO-TIN (.0003 MIN.)
 - (B). INSULATION: MOLDED PVC (BLUE)
 - MWID: MAXIMUM WIRE INSULATION DIAMETER
 - WIRE SIZE: 6 AWG
16 MM²
 - ALL COMPONENTS ARE ROHS COMPLIANT.
 - DIMS. SHOWN ARE FOR REFERENCE ONLY.

THIS DRAWING CONTAINS INFORMATION THAT IS PROPRIETARY TO MOLEX ELECTRONIC TECHNOLOGIES, LLC AND SHOULD NOT BE USED WITHOUT WRITTEN PERMISSION									
FUNCTIONAL SYMBOLS	DIMENSION UNITS	SCALE	CURRENT REV DESC: MIGRATED TO ECTR/NX AND ADDED TAPED P/NS						
$\frac{E}{A} = 0$	INCH/MM	NTS	EC NO: 636245 DRWN: ABENJAMINLW 2020/04/20 CHK'D: DMYRICK 2020/04/21 APPR: JMACNEIL 2020/04/21 INITIAL REVISION: DRWN: EHILE 2006/10/20 APPR: JMACNEIL 2006/10/20						
$\frac{E}{E} = 0$	GENERAL TOLERANCES (UNLESS SPECIFIED)								
$\frac{E}{P} = 0$	MM	INCH							
DIVISIONAL SYMBOLS	4 PLACES	± --- ± ---							
	3 PLACES	± --- ± ---							
	2 PLACES	± --- ± ---							
	1 PLACE	± --- ± ---							
	0 PLACES	± --- ± ---							
	ANGULAR TOL	± ---							
DRAFT WHERE APPLICABLE MUST REMAIN WITHIN DIMENSIONS	THIRD ANGLE PROJECTION	DRAWING	SERIES	MATERIAL NUMBER	CUSTOMER	DOCUMENT NUMBER	DOC TYPE	DOC PART	REVISION
		B-SIZE	19071	SEE CHART	GENERAL MARKET	SD-19071-013	PSD	001	C1
									SHEET NUMBER
									1 OF 1