

NOTES:

① MAT'L: COPPER (STOCK TKN. $\frac{.031}{.79}$) $\pm .001$
 PLATING: ELECTRO-TIN (.0003 MIN.)

STUD SIZES: ($\pm .005$)

- 02 = .094
- 04 = .119
- 06 = .146
- 08 = .173
- 10 = .198
- 14 = .265
- 56 = .328
- 38 = .390

"UL" LISTING *E32244
 "CSA" LISTING #18689

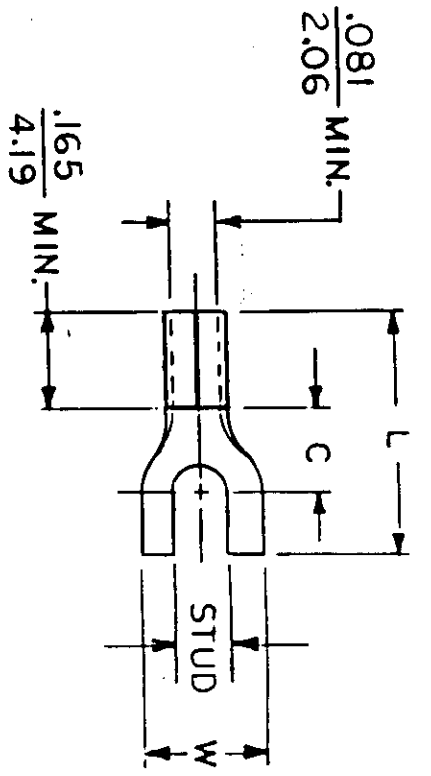

ALL DIMENSIONS = $\frac{\text{INCHES}}{\text{M M}}$

WIRE SIZE: 16 - 14 AWG
 1.0 - 2.5 MM²

PART NUMBER	"W" ±.010	"C" MIN.	"L" MAX.	AVAILABLE STUD SIZES	TITLE:	
					SPADE TONGUE TERMINAL	KRIMPTITE 100-SERIES
BB-107-	$\frac{.245}{6.22}$	$\frac{.209}{5.31}$	$\frac{.565}{14.35}$	04, 06	DRWN. BY: <i>KS</i>	DATE: 10-18-84
BB-124-	$\frac{.295}{7.49}$	$\frac{.211}{5.36}$	$\frac{.564}{14.33}$	04, 06, 08	CHKD. BY: <i>GT</i>	DATE: 11-2-84
BB-127-	$\frac{.362}{9.19}$	$\frac{.269}{6.83}$	$\frac{.687}{17.45}$	06, 08, 10	APPRD. BY:	
DIMENSIONAL TOLERANCES UNLESS OTHERWISE SPECIFIED					SCALE: NTS	
FRAC. DEC. ANG.						



DWG. NO. A CUSTOMER DWG.

10	9	8	7	6	5	
MATERIAL NUMBER	ALTERNATE NUMBER	STUD SIZE	"S" ±.005/(0.13)	"W" ±.010/(0.25)	"C" MIN (A1)	"L" MAX (A1)
191410050	BB-107-04	4	.119/(3.02)	.245/(6.22)	.209/(5.31)	.565/(14.35)
191410052	BB-107-06	6	.146/(3.71)	.245/(6.22)	.209/(5.31)	.565/(14.35)
191410054	BB-124-04	4	.119/(3.02)	.295/(7.49)	.211/(5.36)	.564/(14.33)
191410056	BB-124-06	6	.146/(3.71)	.295/(7.49)	.211/(5.36)	.564/(14.33)
191410058	BB-124-08	8	.173/(4.39)	.295/(7.49)	.211/(5.36)	.564/(14.33)
191410061	BB-127-06	6	.146/(3.71)	.362/(9.19)	.269/(6.83)	.687/(17.45)
191410063	BB-127-08	8	.173/(4.39)	.388/(9.85)	.269/(6.83)	.687/(17.45)
191410065	BB-127-10	10	.198/(5.03)	.388/(9.85)	.269/(6.83)	.687/(17.45)
191410051	BB-107-04T	4	.119/(3.02)	.245/(6.22)	.209/(5.31)	.565/(14.35)
191410053	BB-107-06T	6	.146/(3.71)	.245/(6.22)	.209/(5.31)	.565/(14.35)
191410055	BB-124-04T	4	.119/(3.02)	.295/(7.49)	.211/(5.36)	.564/(14.33)
191410057	BB-124-06T	6	.146/(3.71)	.295/(7.49)	.211/(5.36)	.564/(14.33)
191410059	BB-124-08T	8	.173/(4.39)	.295/(7.49)	.211/(5.36)	.564/(14.33)
191410062	BB-127-06T	6	.146/(3.71)	.362/(9.19)	.269/(6.83)	.687/(17.45)
191410064	BB-127-08T	8	.173/(4.39)	.388/(9.85)	.269/(6.83)	.687/(17.45)
191410066	BB-127-10T	10	.198/(5.03)	.388/(9.85)	.269/(6.83)	.687/(17.45)

PACKAGING

LOOSE PIECE

TAPE MOUNTED

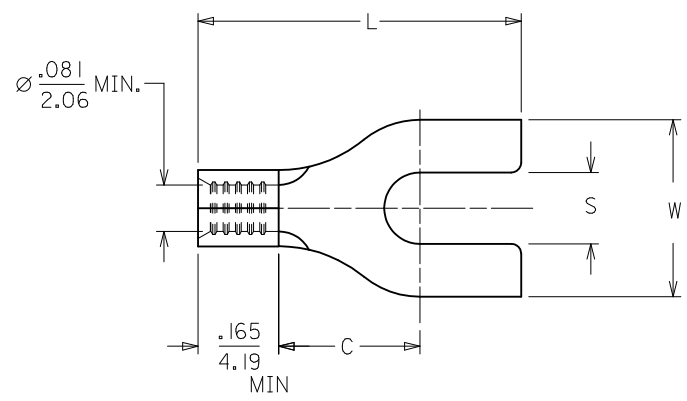
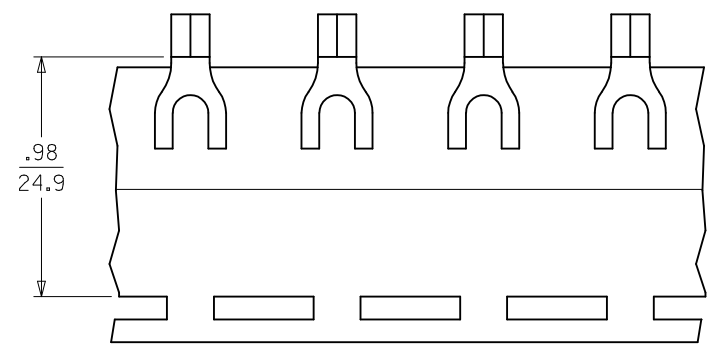

CUSTOMER DRAWING

NOTES:
 1. MATERIAL: COPPER .031/(.79) THICK.
 2. PLATING: ELECTRO-TIN.
 3. PARTS ARE ROHS COMPLIANT. (A1)

ADD MISSING TOLRNC EC NO: WNA2010-0362 DRAWN: THRODAHL 2009/12/21 CHKD: JMACNEIL 2009/12/21 APPR: JMACNEIL 2009/12/21 A1	QUALITY SYMBOLS ▽=0 ▽7=0	GENERAL TOLERANCES (UNLESS SPECIFIED)		DIMENSION STYLE IN/MM		SCALE ---	DESIGN UNITS INCH	THIRD ANGLE PROJECTION		
		4 PLACES ± --- ± ---	mm INCH	DRAWN BY HEB	DATE 1999/11/12	TITLE SPADE TONGUE TERMINAL 16-14 AWG KRIMPTITE SERIES				
		3 PLACES ± --- ± .005		CHECKED BY RWD	DATE 1999/11/12					
		2 PLACES ± 0.13 ± .01		APPROVED BY RWD		DATE 1999/11/12	MOLEX INCORPORATED DOCUMENT NO. SD-19141-001 SHEET NO. 1 OF 1			
1 PLACE ± 0.25 ± ---		MATERIAL NO. SEE CHART								
DRAFT WHERE APPLICABLE MUST REMAIN WITHIN DIMENSIONS		ANGULAR ± ---°		THIS DRAWING CONTAINS INFORMATION THAT IS PROPRIETARY TO MOLEX INCORPORATED AND SHOULD NOT BE USED WITHOUT WRITTEN PERMISSION						