

121 7033

- English
- Español
- Français
- Italiano
- Deutsch
- 中文显示
- 日本語
- 한국어

**Datasheet**  
**Terminals P/N**  
**Standard .062" Crimp Terminal 1560, 18-24 AWG, Bag, Brass Tin (Sn)**

[ Home > Products > Terminals P/N > Datasheet ]

[Help](#)

# 02-06-2103

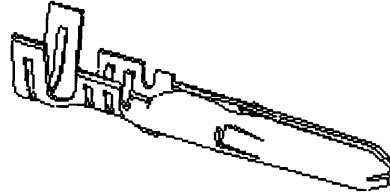

<u>Product Name</u>	<b>Standard .062"</b>
<u>Series</u>	<b>1560</b>
<u>Gender</u>	<b>Male</b>
<u>Wire Size [AWG]</u>	<b>18, 20, 24, 22</b>
<u>Insulation Diameter-max</u>	<b>3.05mm (.120")</b>
<u>Insulation Diameter-min</u>	<b>1.52mm (.060")</b>
<u>Packaging</u>	<b>Bag</b>
<u>Plating Contact</u>	<b>Tin (Sn)</b>
<u>Contact Material</u>	<b>Brass</b>
<u>Material Thickness</u>	<b>0.20mm (.008")</b>
<u>Termination</u>	<b>Link:Good Crimps</b>
<u>990 Catalog Page</u>	<b>K-61</b>
<u>MX01 Catalog Page</u>	<b>F-137</b>
<u>Marketing Series and Version</u>	<b>157mtm</b>

**Related Products**  
**Application Tooling**

Part Number	Region	Product Description
<a href="#">11-01-0008</a>	Americas	Hand Crimper
<a href="#">11-02-0001</a>	Americas	Insertion Tool
<a href="#">11-03-0002</a>	Americas	Extraction Tool
<a href="#">63811-1000</a>	Americas	Hand Crimper - DISTRIBUTION ONLY
<a href="#">69008-0952</a>	Europe	Parallel Action Handtool
		<a href="#">More Application Tooling</a>



[ © Copyright 2001 Molex Incorporated ]

# PART NO. ENG. NO.

02-06-2101	1560-(P90)1
02-06-2103	1560-(P90)1L
02-06-6101	1560-(56)1
02-06-6102	1560-(56)1L
02-06-6118	1560-(563)1
02-06-6119	1560-(563)1L
02-06-6116	1560-(575)1
02-06-6112	1560-(575)1L
02-06-6103	1560-(550)1
02-06-6105	1560-(59)1
02-06-6104	1560-(59)1L
<b>OBSELETE</b>	

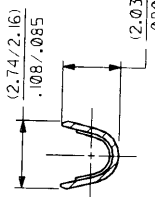

**SECT. "B-B"**

SCALE: 10X

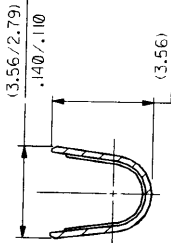

**SECT. "C-C"**

SCALE: 10X

**NOTES:**

1. TERMINAL FOR USE WITH (.157)/.062 DIA. SERIES HOUSINGS AND WILL ACCEPT 18 THRU 24 AWG WIRE WITH (.152/3.05)/.060/.120 INSULATION DIA.

2. THIS PART CONFORMS TO PRODUCT SPEC. 02-06.

**FINISH CODES:**

- 901 HOT TIN DIP (.0005)/.000020 MIN.
- 563 SELECT GOLD PLATE (.00076)/.000030 MIN. IN CONTACT AREA, SELECT TIN-LEAD (.00254)/.000100 MIN. IN CRIMP AREA OVER (.00127)/.000050 MIN. NICKEL OVERALL.
- 575 SELECT GOLD PLATE (.00127)/.000050 MIN. IN CONTACT AREA, SELECT TIN-LEAD (.00127)/.000050 MIN. IN CRIMP AREA OVER (.00127)/.000050 MIN. NICKEL OVERALL.
- 561 SELECT GOLD PLATE (.00076)/.000030 MIN. IN CONTACT AREA, OVER (.00127)/.000050 MIN. NICKEL OVERALL.
- 591 SELECT GOLD PLATE (.00127)/.000050 MIN. IN CONTACT AREA, OVER (.00127)/.000050 MIN. NICKEL OVERALL WITH (.000025)/.000010 MAX. GOLD FLASH OVERALL.
- 550 SELECT GOLD PLATE (.00038)/.000015 MIN. IN CONTACT AREA, OVER (.00076)/.000030 MIN. NICKEL OVERALL WITH (.000025)/.000010 MAX. GOLD FLASH OVERALL.

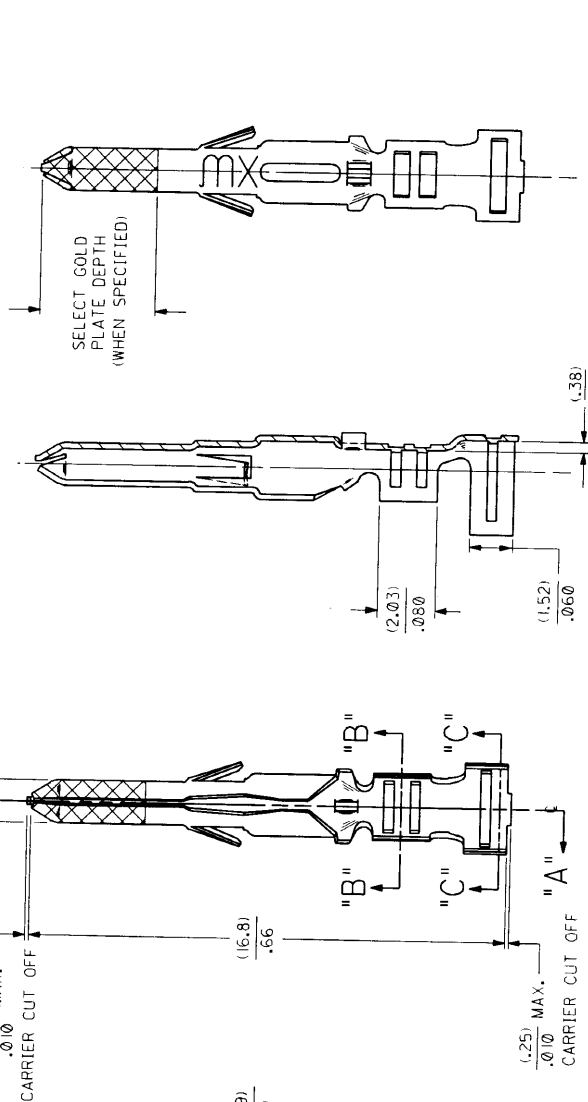
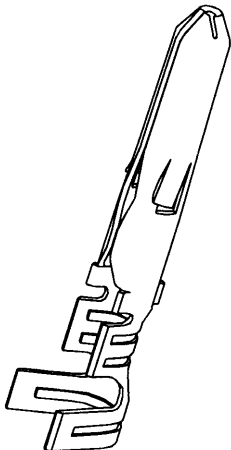

SELECT GOLD PLATE DEPTH (WHEN SPECIFIED)

**SECT. "A-A"**

**LEGEND**

1560-(\*\*\*\*)\*

P=PREPLATE  
BLANK=POSTPLATE

FINISH CODE

MATERIAL NOTE:  
CARTRIDGE BRASS, ALLOY #C26000,  
(.20)/.008 THICK, EXTRA SPRING TEMPER

FORM  
BLANK=CHAIN  
L=LOOSE

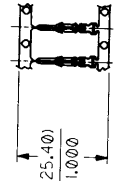

CARRIER VIEW  
ACTUAL SIZE

REVISIONS	
AN	OBSELETE P/N CONCEPT 07/9/75
AM1	ADDED 15G VIEW LCR1998-0248 WANG 56-05-21
AM	REV. A REDRAWN PER ECR 10/72 SEP 8-19-87 RW
LTR.	
<b>REVISE ONLY ON CAD SYSTEM</b>	
CRIMP TERMINAL, MALE (.157)/.062 DIA. FOR 18 THRU 24 GA. WIRE	
MOLEX INCORPORATED LITELLE, ILL. U.S.A.	
FORM NO.	6832
DWG. NO.	SD-1560
REV. NO.	1 OF 1
DATE	8/19/87
BY	RW
SCALE	8:1
APP'D.	RAS
CHK'D.	
THIS DRAWING CONTAINS INFORMATION THAT IS PROPRIETARY TO MOLEX AND IS TO BE KEPT CONFIDENTIAL	

**SEE CHART**

1560-(\*\*\*\*)\*