

Distributed by:



www.Jameco.com ♦ 1-800-831-4242

The content and copyrights of the attached material are the property of its owner.

Jameco Part Number 224451

The subject products should meet the following requirements when tested under the condition of involving all circuits with terminals crimped on the specified maximum size wire.

1. Electrical Performance

	Item	Test Condition	Requirement	
1-1	Rated voltage and current		1~15 CKTS.	AC&DC 250V 5A
			24 CKTS.	AC&DC 250V 4A
1-2	Contact resistance	Mate connectors measure by Dry Circuit, 20mV max., 10mA.	10 mΩ max.	
1-3	Dielectric strength	When applied AC 1500V 1 minute between adjacent terminals or ground	No breakdown	
1-4	Insulation resistance	When applied DC 500V between adjacent terminals or ground	1000 MΩ min.	

2. Mechanical Performance

	Item	Test Condition	Requirement	
2-1	Insertion force	Mating speed : 25±3mm/minute	See para 7	
2-2	Extraction force	Disengaging speed : 25±3mm/minute	See para 7	
2-3	Durability	When mated up to 30 cycles by the rate of 10 cycles per minute	Contact resistance	20 mΩ max.
			Insertion extraction force	See para 7
2-4	Terminal retention force	Pull speed : 25±3mm/minute	7.0 kg min.	
2-5	Terminal strength	When applied a load of 500gw, 1 minute	No damage	

3. Environmental Performance

	Item	Test Condition	Requirement	
3-1	Temperature rise	When carried the rated current	30 °C max.	
3-2	Vibration	1.5mm,10-55-10Hz/min.,each 2 hrs. for X,Y&Z directions, applying 1mA-DC current	Contact resistance	20 mΩ max.
			Discontinuity	1 μsec. max.
			Appearance	No damage
3-3	Shock	50G,each 3 times for X,Y,Z directions, applying 1mA-DC current	Discontinuity	1 μsec. max.
			Appearance	No damage

REV. B

Item	Test Condition	Requirement	
3-4 Solderability	Soldering time : 3 ± 0.5 sec. Soldering pot : 230 ± 5 °C	Min. 3/4 of immersed area	
3-5 Resistance to soldering heat	Soldering time : 5 ± 0.5 sec. Soldering pot : 260 ± 5 °C	No damage	
3-6 Heat resistance	85 ± 2°C, 96 hours	Contact resistance	20 mΩ max.
		Appearance	No damage
3-7 Humidity	Temperature : 40±2°C Relative Humidity: 90~95% Duration : 96 hours Measurement must be taken within 30 minute after tested	Contact resistance	20 mΩ max.
		Dielectric strength	To pass para 1-3
		Insulation resistance	100 MΩ min.
		Appearance	No damage
3-8 Temperature cycling (5 cycles)	One cycle consists of (1) -55±3°C, 30 minute (2) Room temp. 10~15 minute (3) 105±2°C, 30 minute (4) Room temp. 10~15 minute	Contact resistance	20 mΩ max.
		Appearance	No damage
3-9 Salt Spray	Temperature: 35±2°C Solution : 5±1% Spray time : 48±4 hours Measurement must be taken after water rinse.	Contact resistance	20 mΩ max.
		Appearance	No significant corrosion
3-10 SO ₂ Gas	24 hours in sulfur dioxide gas (SO ₂) 50±5ppm at 40±2°C	Contact resistance	20 mΩ max.

4. Terminal To Be Used

	Customer P/No	Molex P/No	Wire Size	Insulation Dia.
1.		1560,1561	AWG #18 ~ #24	φ (1.5) ~ 3.1
2.		1854,1855	AWG #22 ~ #28	φ (1.1) ~ 1.5
3.		1778,1779	-----	-----
4.				

5. Ambient Temperature Range : -40°C ~ 105°C

6. Construction, Dimension and Material : Specified by the attached drawing.

REV. B

7. Insertion and Extraction Force

No of Ckt.	Insertion Force (kgf, max.)			Extraction Force (kgf, min.)		
	1st	6th	30th	1st	6th	30th
1	5.0	4.5	4.5	0.8	0.5	0.5
2	7.0	6.0	6.0	1.5	1.0	1.0
3	10.0	9.0	8.0	1.8	1.2	1.2
4	13.0	12.0	10.0	2.0	1.4	1.4
5	15.5	14.0	11.0	2.3	1.5	1.5
6	18.0	16.0	12.0	2.5	1.6	1.6
9	26.0	23.0	17.0	3.5	2.5	2.5
12	34.0	30.0	23.0	4.5	3.5	3.5
15	40.0	35.0	30.0	5.5	4.5	4.5
24	60.0	55.0	50.0	6.5	5.5	5.5

REV. B

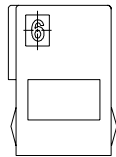
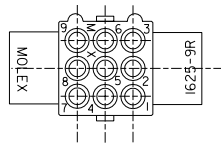

OPTIONAL MOUNTING EARS
SEE DETAIL 3 OR 4
FOR VERSIONS AVAILABLE

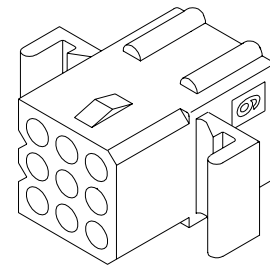
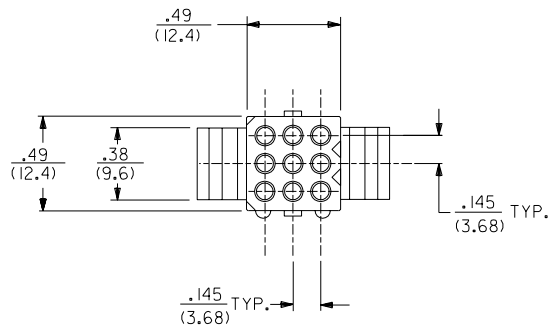
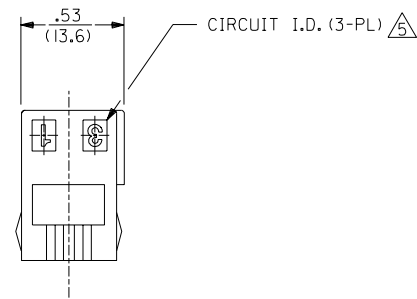
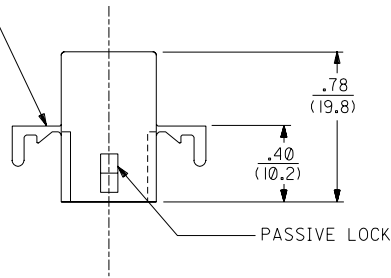

RECEPTACLE

1625-9

LTR.	REVISIONS	LTR.	REVISIONS

DIMENSIONS SHOWN (METRIC) INCH	
UNLESS OTHERWISE SPECIFIED TOLERANCES: ANGULAR ± 1/2°	
3 PLACE ± .010	---
2 PLACE ± .014	± 0.25
1 PLACE ---	± 0.36
DRAFT WHERE APPLICABLE MUST REMAIN WITHIN DIMENSIONS	
DRWG. BY: JJS	CHK'D. BY: RW
APP'D. BY: RAS	SCALE: 2:1

▽ = 0	▼ = 0	REVISE ONLY ON CAD SYSTEM	
TITLE: .062/(1.57)HOUSINGS PLUG & RECEPTACLE 9 CIRCUIT, .145/(3.68) CTRS.			
MOLEX LITSE,ILL.	MOLEX INCORPORATED	SHEET NO. 2	DATE 2 / 5 / 88
PART NO. SD-1625-9*		DRWG. NO.	
SEE CHART			
FILE NAME: S1625SK2		THIS DRAWING CONTAINS INFORMATION THAT IS PROPRIETARY TO MOLEX INC. AND SHOULD NOT BE USED WITHOUT WRITTEN PERMISSION	
CP	C	CP	C

PLUG	
PART NO.	ENG. NO.
03-06-2091	I625-9P
03-06-2092	I625-9P1
23-06-2091	I625-9P-C
23-06-2092	I625-9P1-C
04-06-6091	I625-9P1-B
03-06-7091	I625-9PBK
03-06-7092	I625-9P1BK
	OBSOLETE

RECEPTACLE	
PART NO.	ENG. NO.
03-06-1091	I625-9R
03-06-1092	I625-9R1
23-06-1091	I625-9R-C
23-06-1092	I625-9R1-C
03-06-6091	I625-9RBK
03-06-6092	I625-9R1BK
	OBSOLETE

LEGEND:

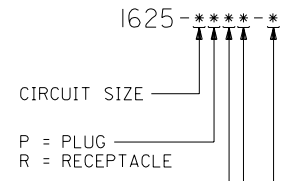

MOUNTING EAR & DETENT COMBINATIONS:
 BLANK=PLUG OR RECEPTACLE WITH STANDARD EARS
 I=PLUG OR RECEPTACLE WITHOUT EARS
 4=PLUG OR RECEPTACLE WITH PREBENT EARS

BLANK = NATURAL COLOR
 AM = AMBER BK = BLACK BU = BLUE
 BN = BROWN CY = GRAY GN = GREEN
 OR = ORANGE RD = RED YW = YELLOW

MATERIAL: A= MATERIAL CODE A
 B= MATERIAL CODE B
 C= MATERIAL CODE C

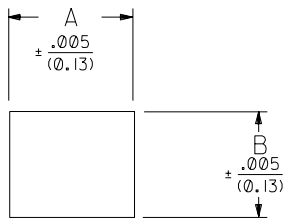
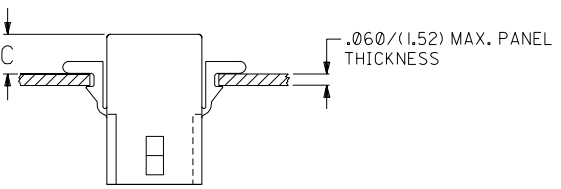

RECEP.	.650 (16.51)	.552 (14.02)	.21 (5.3)	.22 (5.6)
PLUG	.752 (19.10)	.615 (15.62)	.20 (5.1)	.21 (5.3)
PART	DIM. A	DIM. B	DIM. C (STANDARD EAR)	DIM. C (PREBENT EAR)

RECOMMENDED HOLE PATTERN

NOTES:

- MATERIAL CODES:
 A-NYLON TYPE 6/6, 94V-2
 B-NYLON TYPE 6/6, 94V-0
 C-POLYPROPYLENE, 94V-0
- THIS PRODUCT COMPLIES WITH MOLEX PRODUCT SPEC PS-02-06.
- HOUSINGS FOR USE WITH MOLEX .062 DIA. TERMINALS.
- SOME PARTS MAY HAVE THIS CORNER CHAMFERED.
- CIRCUIT I.D. NUMBERS APPEAR ONLY ON TOOLS BUILT AFTER 11/1/92.

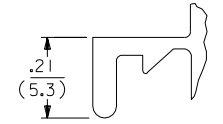

DETAIL 3
 STANDARD MOUNTING EAR
 (SCALE 4:1)

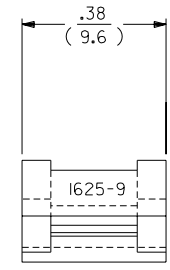

DETAIL 4
 PREBENT MOUNTING EAR
 (SCALE 4:1)

Q	SEE SHEET 1	DIMENSIONS SHOWN (METRIC) INCH		▽ = 0	▼ = 0	REVISE ONLY ON CAD SYSTEM
P	SEE SHT. 1	UNLESS OTHERWISE SPECIFIED TOLERANCES: ANGULAR ± .030 10		TITLE .062/(1.57) HOUSINGS PLUG & RECEPTACLE 9 CIRCUIT, .145/(3.68) CTRS		
OI	SEE SHT. 1	INCH METRIC		MOLEX INCORPORATED SHEET NO. DATE U.S.A. 3 2 / 12 / 88		
O	SEE SHT. 1	5 PLACE ± .010 ---		PART NO. DRWG. NO. SD-1625-9*		
N	SEE SHT. 1	2 PLACE ± .014 ± 0.25		SEE CHART		
M	SEE SHT. 1	1 PLACE --- ± 0.36		FILE NAME S1625P3		
L	SEE SHT. 1	DRAFT WHERE APPLICABLE MUST REMAIN WITHIN DIMENSIONS		THIS DRAWING CONTAINS INFORMATION THAT IS PROPRIETARY TO MOLEX INC. AND SHOULD NOT BE USED WITHOUT WRITTEN PERMISSION.		
LTR.	REVISIONS	LTR.	REVISIONS	DRWG. BY JJS	CHK'D. BY RW	SCALE 2 : 1