

## FEATURES AND SPECIFICATIONS

### Features and Benefits

- Meets the need for a connector system rated at greater than the industry-standard 12.0A per circuit. The HCS-125 is an enhanced version of Molex's proven .125" system
- Positive locks prevent accidental unmating
- Fully isolated terminals protect terminals
- Pull tabs
- 1, 2, 3 and 4 circuit housings

### Reference Information

Packaging: Bag  
 UL File No.: E29179  
 CSA File No.: LR19980  
 TUV License No.: R9151436  
 Use With: .125" terminals  
 Designed In: Inches

### Electrical

Voltage: 600V  
 Current: 20.0A  
 Dielectric Withstanding Voltage: 1500V AC rms

### Mechanical

Contact Retention to Housing: 20 lb min.

### Physical

Housing: Nylon, UL 94V-2  
 Temperature: -40 to +105°C  
 Wire Accommodation: 10 to 18 AWG

# molex® 3.18mm (.125") Diameter HCS-125 Pin and Socket Receptacle

## 42179 Single Row

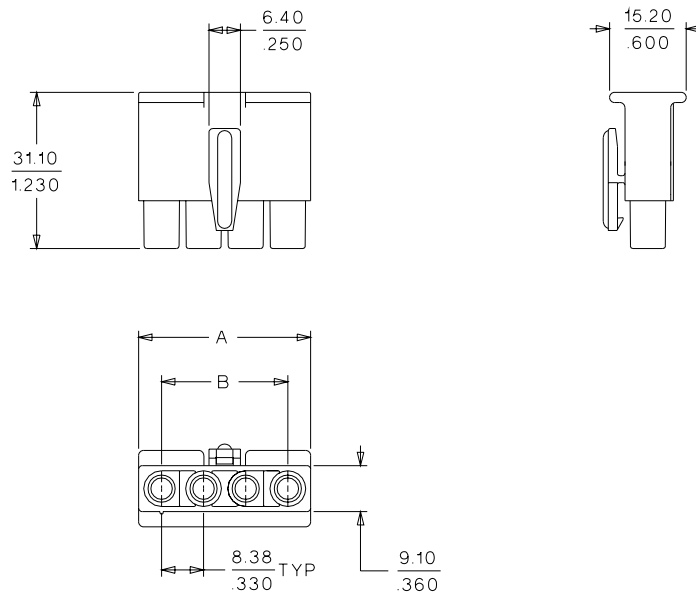
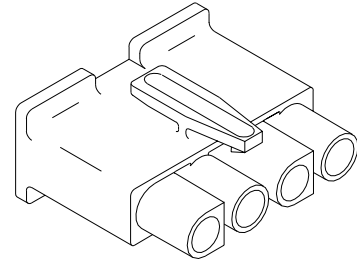

## ORDERING INFORMATION AND DIMENSIONS

Circuits	Order No.	Dimension	
		A	B
1	03-12-1016	9.10 (.360)	
2	03-12-1026	17.50 (.690)	8.38 (.330)
3	03-12-1036	25.90 (1.020)	16.76 (.660)
4	03-12-1046	34.30 (1.350)	25.14 (.990)