

ITEM NUMBER	CIRCUIT SIZE
42816-0211	2

LEGEND:

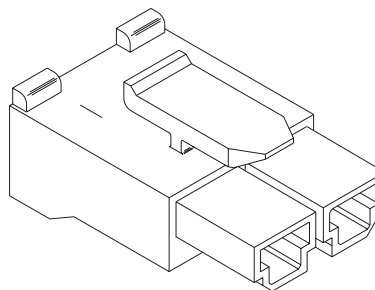
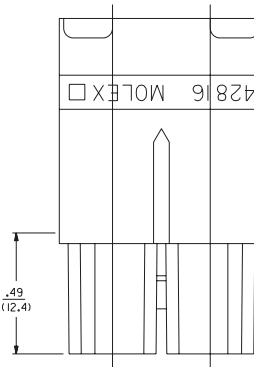
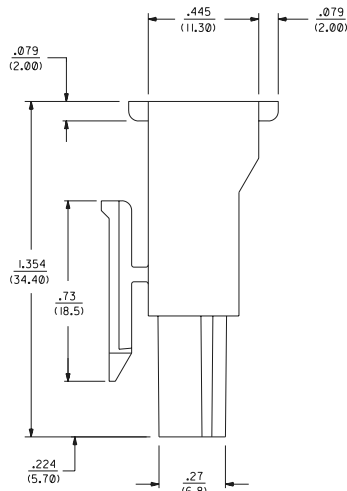
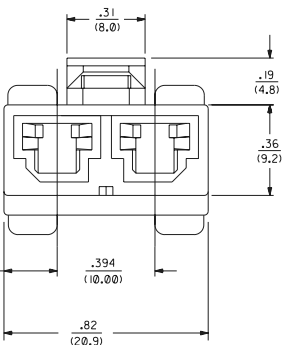
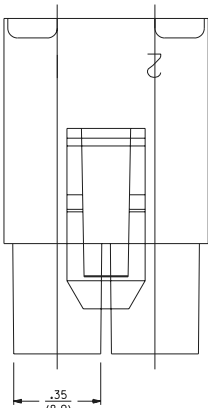
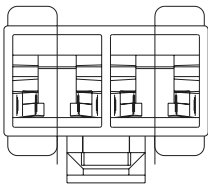
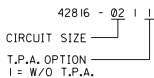

RECEPTACLE HOUSING ISO VIEW

NOTES:

- 1) MATERIAL:
I = POLYESTER, PBT, U.L. 94V-0, MOLDED BLACK.
- 2) PART IS FOR USE WITH FEMALE CRIMP TERMINAL *42815.
- 3) PART IS DESIGNED AND DIMENSIONED IN METRIC.
- 4) ITEM NUMBERS PRECEDED BY AN 'X' IN THE CHART ARE NOT AVAILABLE.
- 5) THIS PART MEETS I.E.C. 950 AND U.L. 1950 REQUIREMENTS FOR CREEPAGE AND CLEARANCE AT 600 VAC AND 840 VDC.
- 6) PART CONFORMS TO MOLEX PRODUCT SPEC. PS-42815-0001.

Mates with:

42819 Series Vertical,
Single Row SMC Header

42820 Series Right Angle,
Single Row SMC Header

For Use with:
42815 Series
Female Terminals

REV.	DATE	DESCRIPTION
J		REV. & FINAL REL. ECR *U70560 POLYGAR 96-11-13
I		REV. LEGEND ECR *U60718 GEP 12-19-95
H		REV. LEGEND ECR *U60537 GEP 11-1-95
G		REDESIGNED LATCH ECR *U50492 GEP 12-5-94
F		ADDED DIMS. PER ECR *U40568 94-5-2 RUF
E		REVISED 2-CRY. ECR *U40529 94-4-28 RUF
D		10mm WAS 7.5mm ECR *U40495 GEP 4-13-94
C		ADD ISO VIEW ECR *U3169 93-08-16 A.GUZZIK
B		REVISED PER ECR US-0849 93-06-07 A.GUZZIK
A1		ADDED NOTE 5 ECR U20761 5-18-93 RUF
A		FINAL RELEASE ECR U21218 10-29-92 RUF
2		REVISED PER ECR U20364 3-6-92 RUF
1		X-RELEASE PER ECR U20192 2-14-92 RUF

DIMENSIONS SHOWN IN METRIC UNLESS OTHERWISE SPECIFIED TOLERANCES IN MILLIMETERS		MFG. SH. REV. LTR. REVISIONS	
TITLE		REVISE ONLY ON CAD SYSTEM	
RECEPTACLE HOUSING			
10.00 mm CENTERS (MINI-FIT, SR. SERIES)			
MOLEX INCORPORATED		DATE	
2/13/92		2/13/92	
SEE CHART.		SD-42816-*	
SCALE 4 : 1		DRAWN BY RAS	

