

P/N: 46562-1117

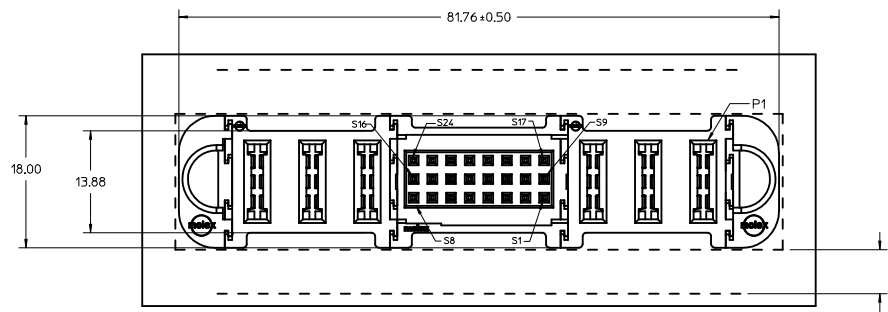

ALLOW EXTRA 6.00 PER SIDE (REQUIRED FOR RE-WORK)

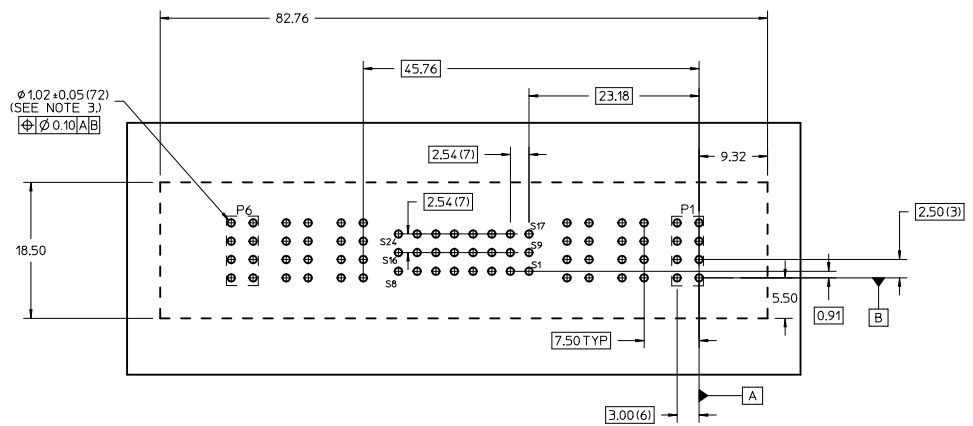
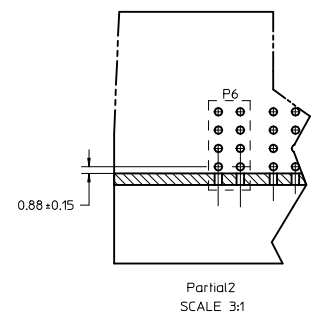
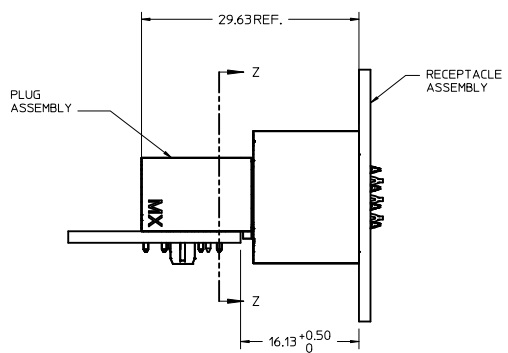

RECOMMENDED PCB LAYOUT AND KEEP-OUT ZONE

NOTES:

- MATERIAL:
 - HOUSINGS: LCP UL94 V-0, COLOR: BLACK.
 - TERMINALS: COPPER ALLOY.
 - PLATING: 0.000127 NICKEL OVERALL WITH 0.00254 SELECTIVE MATTE TIN ON COMPLIANT PINS.
- AND 0.000762 SELECTIVE GOLD ON CONTACT AREA.
- PACKAGING ASSEMBLIES TO BE TRAY PACKED. STD. QUANTITY: TBD.
- PC BOARD REQUIRES THRU HOLES. REFER TO PS-46436-100 FOR DETAILS.
- PRODUCT SPEC: PS-46436-100.
- APPLICATION SPEC: AS-46436-100.
- SEE PRODUCT SPEC FOR MEET ROHS REQUIREMENTS.
- ASSEMBLY MATES WITH MOLEX PLUG ASSEMBLY, P/N 46437-1117.

| | | | | | | | | |
|---|--|---|-------------|-----------------|------------|----------------------|----------------------|------------------------|
| RELEASED IEC NO. UCP2011-242 DRAWN: JUILLES 2011/01/19 CHYKHARADINAS 2011/01/19 APPR: APATEL 2011/01/31 | QUALITY SYMBOLS | GENERAL TOLERANCES (UNLESS SPECIFIED) | | DIMENSION STYLE | | SCALE | DESIGN UNITS | THIRD ANGLE PROJECTION |
| | | mm | INCH | MM ONLY | | 3:1 | METRIC | |
| | | 4 PLACES ±--- | ±--- | DRAWN BY | | DATE | TITLE | |
| | | 3 PLACES ±--- | ±--- | BKOSTIC | | 2010/03/23 | VERT. RECPTACLE ASSY | |
| | 2 PLACES ±0.13 | ±--- | CHECKED BY | | DATE | 3P-24S-3P, PRESS-FIT | | |
| | 1 PLACE ±0.25 | ±--- | APPROVED BY | | DATE | TEN60 POWER FAMILY | | |
| | | ANGULAR ±1/2° | APATEL | | 2010/04/29 | MOLEX INCORPORATED | | |
| | DRAFT WHERE APPLICABLE MUST REMAIN WITHIN DIMENSIONS | WATERIAL NO. | | DOCUMENT NO. | | SHEET NO. | | |
| | | 46562-1117 | | SD-46562-1117 | | 1 OF 1 | | |
| | SIZE D | THIS DRAWING CONTAINS INFORMATION THAT IS PROPRIETARY TO MOLEX INCORPORATED AND SHOULD NOT BE USED WITHOUT WRITTEN PERMISSION | | | | | | |

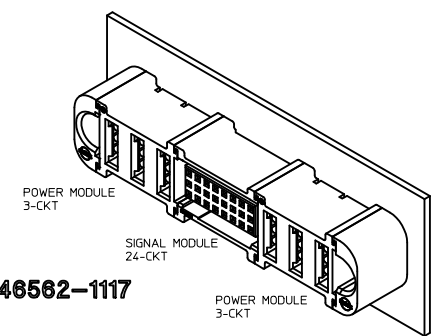
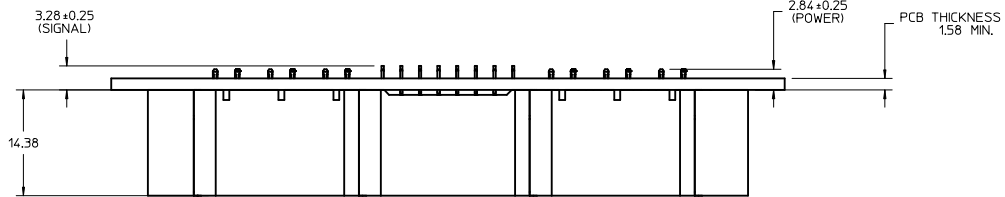

P/N: 46562-1117

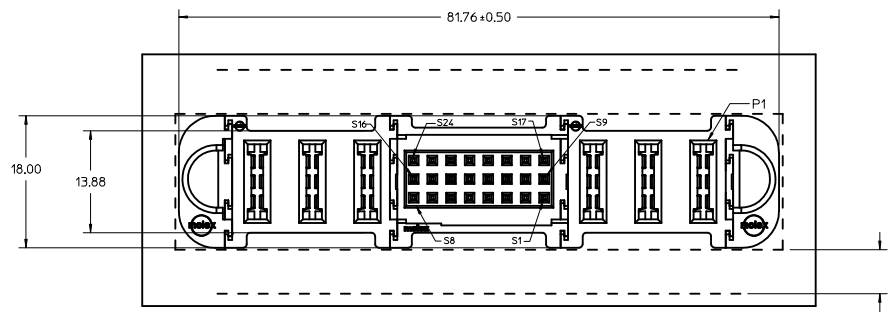

ALLOW EXTRA 6.00 PER SIDE (REQUIRED FOR RE-WORK)

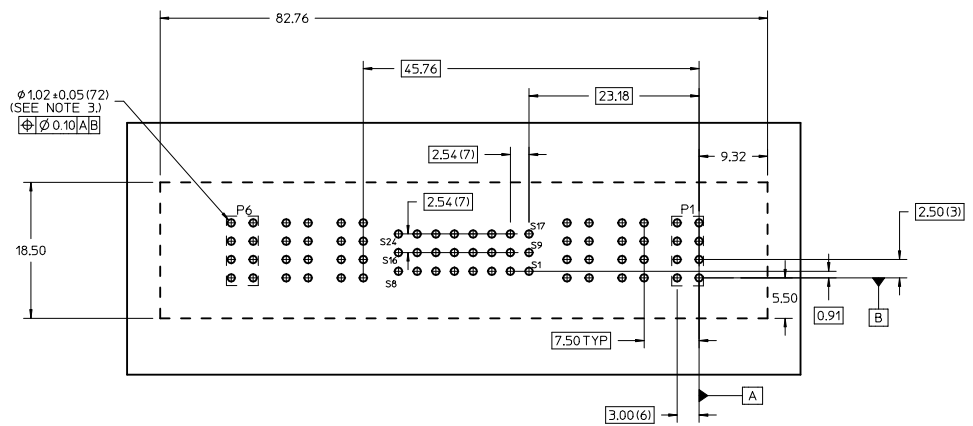
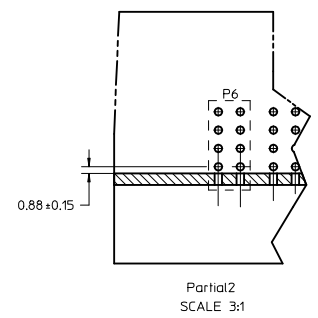
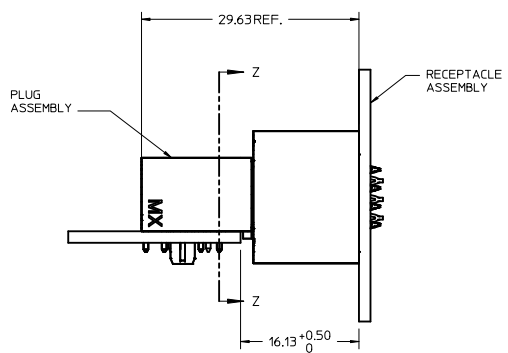

RECOMMENDED PCB LAYOUT AND KEEP-OUT ZONE

NOTES:

- MATERIAL:
 - HOUSINGS: LCP UL94 V-0, COLOR: BLACK.
 - TERMINALS: COPPER ALLOY.
 - PLATING: 0.000127 NICKEL OVERALL WITH 0.00254 SELECTIVE MATTE TIN ON COMPLIANT PINS.
- AND 0.000762 SELECTIVE GOLD ON CONTACT AREA.
- PACKAGING ASSEMBLIES TO BE TRAY PACKED. STD. QUANTITY: TBD.
- PC BOARD REQUIRES THRU HOLES. REFER TO PS-46436-100 FOR DETAILS.
- PRODUCT SPEC: PS-46436-100.
- APPLICATION SPEC: AS-46436-100.
- SEE PRODUCT SPEC FOR MEET ROHS REQUIREMENTS.
- ASSEMBLY MATES WITH MOLEX PLUG ASSEMBLY, P/N 46437-1117.

| | | | | | | | | |
|---|--|---|-------------|-----------------|------------|----------------------|----------------------|------------------------|
| RELEASED IEC NO. UCP2011-242 DRAWN: JUILLES 2011/01/19 CHYKHARADIMAS 2011/01/19 APPR: APATEL 2011/01/31 | QUALITY SYMBOLS | GENERAL TOLERANCES (UNLESS SPECIFIED) | | DIMENSION STYLE | | SCALE | DESIGN UNITS | THIRD ANGLE PROJECTION |
| | | mm | INCH | MM ONLY | | 3:1 | METRIC | ☉ |
| | | 4 PLACES ±--- | ±--- | DRAWN BY | | DATE | TITLE | |
| | | 3 PLACES ±--- | ±--- | BKOSTIC | | 2010/03/23 | VERT. RECPTACLE ASSY | |
| | 2 PLACES ±0.13 | ±--- | CHECKED BY | | DATE | 3P-24S-3P, PRESS-FIT | | |
| | 1 PLACE ±0.25 | ±--- | APPROVED BY | | DATE | TEN60 POWER FAMILY | | |
| | | ANGULAR ±1/2° | APATEL | | 2010/04/29 | MOLEX INCORPORATED | | |
| | DRAFT WHERE APPLICABLE MUST REMAIN WITHIN DIMENSIONS | MATERIAL NO. | | DOCUMENT NO. | | SHEET NO. | | |
| | | 46562-1117 | | SD-46562-1117 | | 1 OF 1 | | |
| | SIZE D | THIS DRAWING CONTAINS INFORMATION THAT IS PROPRIETARY TO MOLEX INCORPORATED AND SHOULD NOT BE USED WITHOUT WRITTEN PERMISSION | | | | | | |