

SECTION D-D

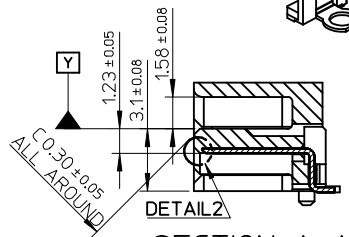

SECTION A-A

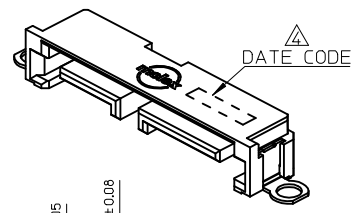
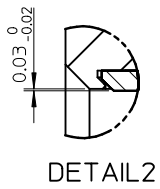
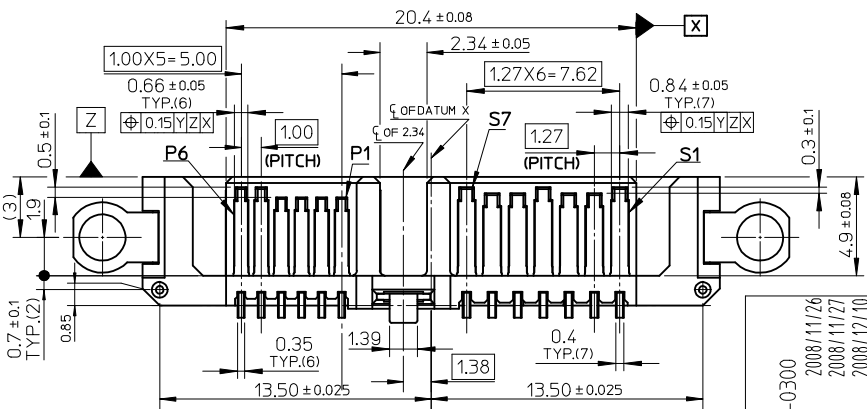
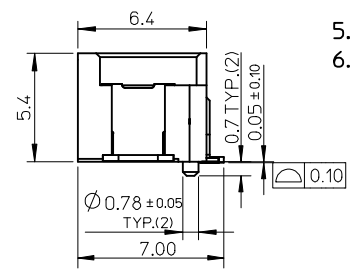
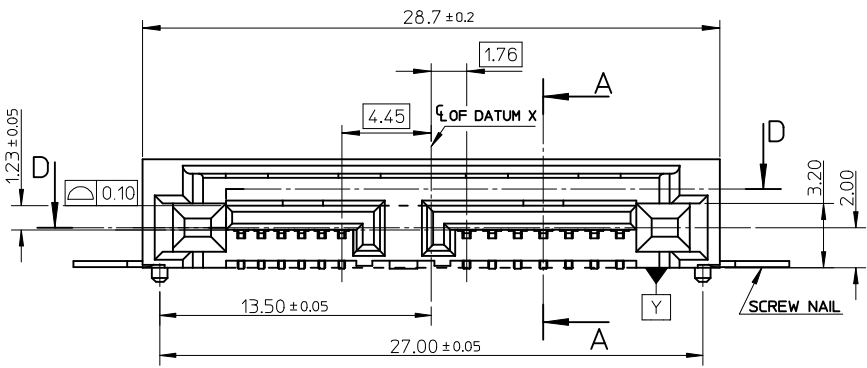

DETAIL2

NOTES :

- 1.MATERIAL :  
HOUSING : HIGH TEMPERATURE THERMOPLASTIC, 30% G.F., UL94V-0, BLACK  
TERMINAL : COPPER ALLOY, THICKNESS=0.25 MM  
SCREW NAIL : STAINLESS, THICKNESS=0.30 MM  
SOLDERING NAIL : COPPER ALLOY, THICKNESS=0.30 MM
- 2.PLATING :  
TERMINAL :  
CONTACT AREA : GOLD PLATING 0.1 MICRONS MIN.  
SOLDERING AREA : MATTE TIN PLATING 1.0 MICRONS MIN.  
UNDERPLATING : NICKEL PLATING 2.5 MICRONS MIN.  
SOLDERING NAIL : MATTE TIN PLATING 1.0 MICRONS MIN.  
OVER NICKEL PLATING 1.0 MICRONS MIN.
- 3.PRODUCT SPECIFICATION: PS-47300-001.
- DATE CODE FORMAT: YY/MM/DD/XX/S, 'XX' IS USED TO MARK TERMINAL GOLD PLATING SPEC, '05' IS FOR FL5H, '15' IS FOR 15u", '30' IS FOR 30u". 'S' IS A SPECIAL LETTER FOR FACTORY TO TRACK.
- 5.PRODUCT PACKAGE SPEC: PK-47300-001.
- 6.THE PRODUCT COMPLIANT TO RoSH DIRECTIVE 2002/95/EC AND ELV DIRECTIVE 2000/53/EC.

P/N	CONTACT PLATING	NAIL
47300-1000	GOLD FLASH	
47300-1002	GOLD 0.38 MICRONS MIN	STAINLESS STEEL, NO PLATING
47300-1004	GOLD 0.76 MICRONS MIN	
47300-1001	GOLD FLASH	
47300-1003	GOLD 0.38 MICRONS MIN	PHOSPHOR BRONZE, MATTE TIN PLATING
47300-1005	GOLD 0.76 MICRONS MIN	

REVISED EC NO: SH2009-0300 DRWN:XQZHANG 2008/11/26 CHKD:XJ SONG 2008/11/27 APPR:HWANG 2008/12/10	QUALITY SYMBOLS ▽=0 ▽=0	GENERAL TOLERANCES (UNLESS SPECIFIED)		DIMENSION STYLE MM ONLY		SCALE 1:1		DESIGN UNITS METRIC		THIRD ANGLE PROJECTION	
				mm	INCH	DRAWN BY DATE		TITLE		SLIMLINE SATA PLUG FOR OPTIC DISK DRIVER SCREW STANDARD TYPE MOLEX INCORPORATED SD-47300-100	
		4 PLACES ± --- ± ---				DIXON LI 04/04/2006					
		3 PLACES ± --- ± ---				CHECKED BY DATE					
2 PLACES ± 0.15 ± ---				JENNY ZENG 04/04/2006							
1 PLACE ± 0.20 ± ---				APPROVED BY DATE							
ANGULAR ± 3 °				GRATE MA 04/04/2006							
DRAFT WHERE APPLICABLE MUST REMAIN WITHIN DIMENSIONS				MATERIAL NO.		DOCUMENT NO.		SHEET NO.			
				SEE CHART				1 OF 7			
				SIZE A3		THIS DRAWING CONTAINS INFORMATION THAT IS PROPRIETARY TO MOLEX INCORPORATED AND SHOULD NOT BE USED WITHOUT WRITTEN PERMISSION					

10 9 8 7 6 5 4 3 2 1

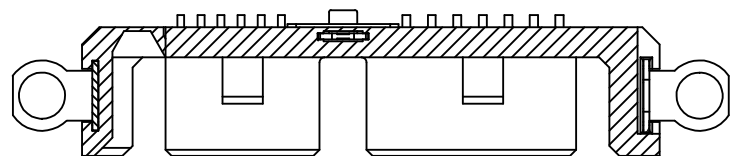

SECTION D1-D1

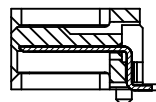

SECTION A1-A1

NOTES : OTHER DIMENSIONS AND NOTES REFER TO SHEET-1.

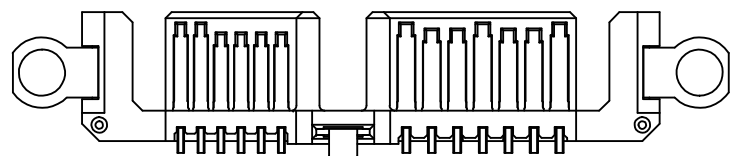
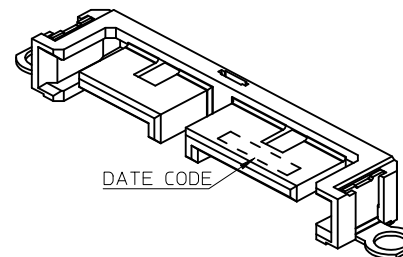
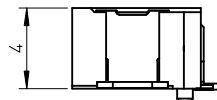
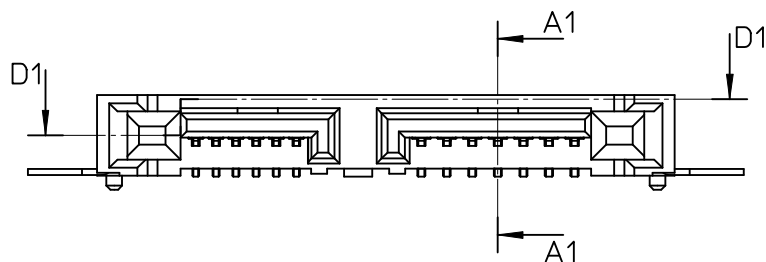

P/N	CONTACT PLATING	NAIL
47300-1014	GOLD FLASH	
47300-1012	GOLD 0.38 MICRONS MIN	STAINLESS STEEL, NO PLATING
47300-1010	GOLD 0.76 MICRONS MIN	
47300-1015	GOLD FLASH	
47300-1013	GOLD 0.38 MICRONS MIN	PHOSPHOR BRONZE, MATTE TIN PLATING
47300-1011	GOLD 0.76 MICRONS MIN	

<b>REVISED</b> EC NO: SH2009-0300 DRWN: XZHANG 2008/11/26 CHKD: XJSONG 2008/11/27 APPR: HWANG 2008/12/10	QUALITY SYMBOLS ▽=0 ▽=0	GENERAL TOLERANCES (UNLESS SPECIFIED)		DIMENSION STYLE <b>MM ONLY</b>	SCALE <b>1:1</b>	DESIGN UNITS <b>METRIC</b>	THIRD ANGLE PROJECTION	
				DRAWN BY DIXON LI	DATE 04/04/2006	TITLE <b>SLIMLINE SATA PLUG FOR OPTIC DISK DRIVER SCREW LOW TYPE</b>		
				CHECKED BY JENNY ZENG	DATE 04/04/2006	MOLEX INCORPORATED		
				APPROVED BY GRATE MA	DATE 04/04/2006	MATERIAL NO. <b>SEE CHART</b>	DOCUMENT NO. <b>SD-47300-100</b>	SHEET NO. <b>2 OF 7</b>
DRAFT WHERE APPLICABLE MUST REMAIN WITHIN DIMENSIONS		THIS DRAWING CONTAINS INFORMATION THAT IS PROPRIETARY TO MOLEX INCORPORATED AND SHOULD NOT BE USED WITHOUT WRITTEN PERMISSION						

9 8 7 6 5 4 3 2 1

F

E

D

C

B

A

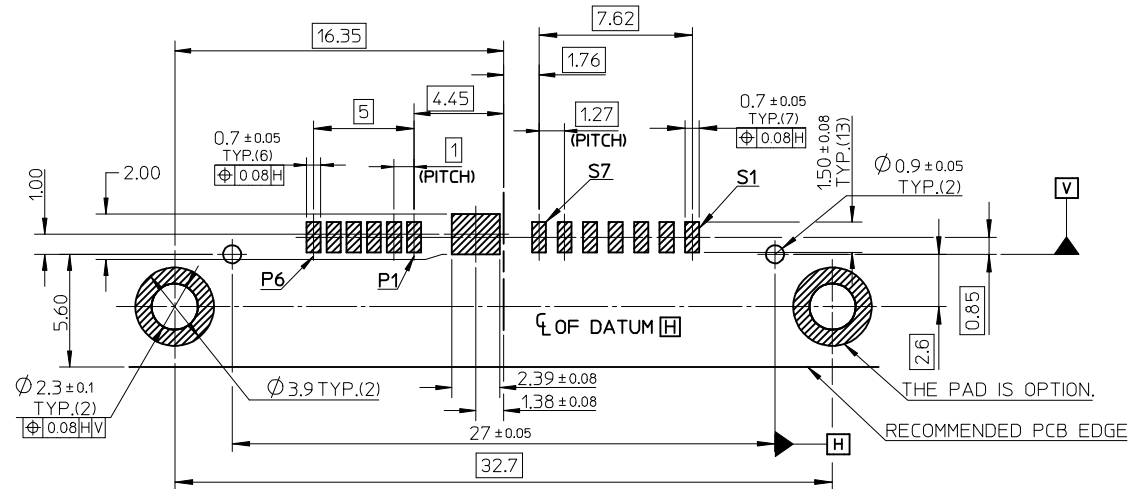

**RECOMMENDED PCB LAYOUT(CONNECTOR SIDE)**

**THICKNESS=0.8MM**

REMARK:

THE PCB LAYOUT IS ONLY FOR 47300-100X, 47300-1010, 47300-101X.

REVISED EC NO: SH2009-0300 DRWN: XZHZHANG 2008/11/26 CHKD: XJISONG 2008/11/27 APPR: HHWANG 2008/12/10	QUALITY SYMBOLS	GENERAL TOLERANCES (UNLESS SPECIFIED)		DIMENSION STYLE	SCALE	DESIGN UNITS	THIRD ANGLE PROJECTION		
	▽ = 0 ∇ = 0	4 PLACES	mm	INCH	MM ONLY	1:1	METRIC	SLIMLINE SATA PLUG FOR OPTIC DISK DRIVER SCREW TYPE	
		3 PLACES	± ---	± ---	DRAWN BY DATE	DIXON LI 04/04/2006	TITLE		
		2 PLACES	± 0.15	± ---	CHECKED BY DATE	JENNY ZENG 04/04/2006	MOLEX INCORPORATED		
		1 PLACE	± 0.20	± ---	APPROVED BY DATE	GRATE MA 04/04/2006			
	ANGULAR ± 3 °		DRAFT WHERE APPLICABLE MUST REMAIN WITHIN DIMENSIONS		MATERIAL NO.	DOCUMENT NO.		SHEET NO.	
	SEE REMARK				SD-47300-100		3 OF 7		

10 9 8 7 6 5 4 3 2 1

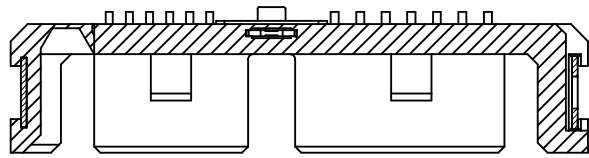

SECTION D-D

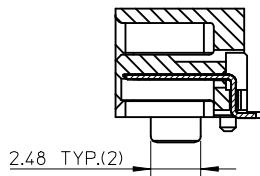

SECTION A-A

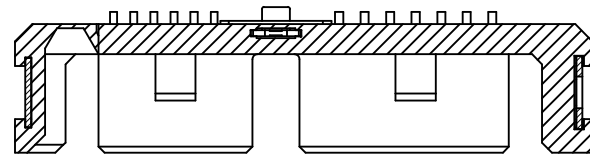

SECTION Z-Z

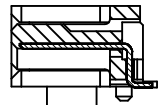

SECTION Y-Y

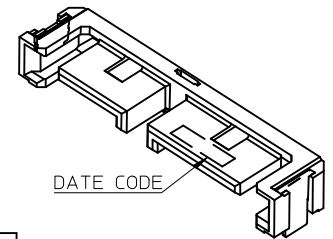
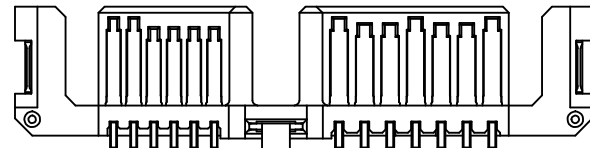
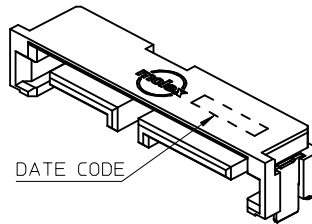
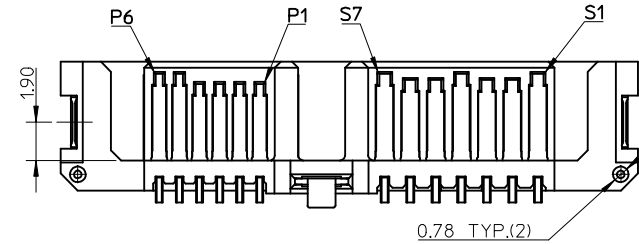
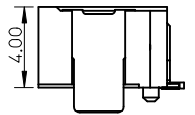
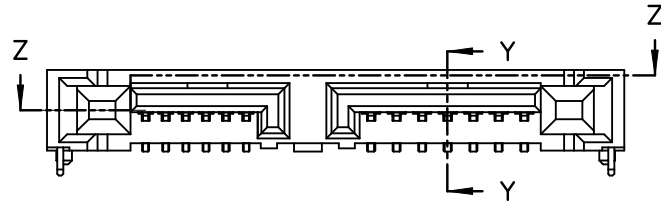
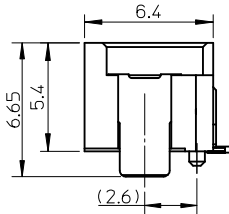
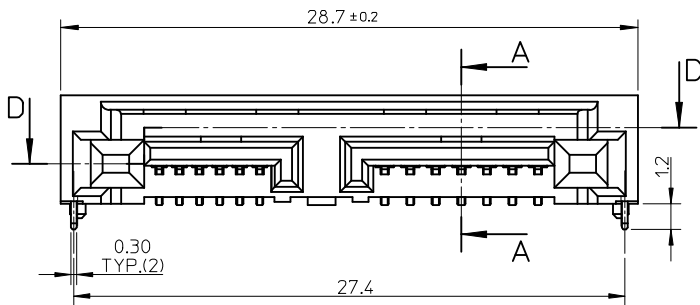

P/N	CONTACT PLATING
47300-1022	GOLD 0.76 MICRONS MIN
47300-1021	GOLD 0.38 MICRONS MIN
47300-1020	GOLD FLASH

P/N	CONTACT PLATING
47300-1032	GOLD 0.76 MICRONS MIN
47300-1031	GOLD 0.38 MICRONS MIN
47300-1030	GOLD FLASH

NOTES : OTHER DIMENSIONS AND NOTES REFER TO 47300-102X.

NOTES :

- MATERIAL :  
SOLDERING PEG : COPPER ALLOY
- PLATING :  
SOLDERING PEG :  
MATTE TIN PLATING 1.0 MICRONS MIN.  
OVER NICKEL PLATING 1.0 MICRONS MIN.
- PRODUCT PACKAGE SPEC: PK-47300-003.
- OTHER NOTES AND DIMENSIONS REFER TO SHEET-1.

REVISED EC NO: SH2009-0300 DRWN: QZHZHANG 2008/11/26 CHKD: XJSONG 2008/11/27 APPR: HWANG 2008/12/10	QUALITY SYMBOLS ▽=0 ⊕=0	GENERAL TOLERANCES (UNLESS SPECIFIED)		DIMENSION STYLE MM ONLY		SCALE 1:1	DESIGN UNITS METRIC	THIRD ANGLE PROJECTION	
		4 PLACES ± --- ± ---	3 PLACES ± --- ± ---	2 PLACES ± 0.15 ± ---	1 PLACE ± 0.20 ± ---	ANGULAR ± 3 °	DRAWN BY DIXON LI	DATE 04/04/2006	TITLE SLIMLINE SATA PLUG FOR OPTIC DISK DRIVER SOLDERING STANDARD TYPE
		DRAFT WHERE APPLICABLE MUST REMAIN WITHIN DIMENSIONS		SEE CHART	APPROVED BY GRATE MA	DATE 04/04/2006	MATERIAL NO.	DOCUMENT NO.	SHEET NO. 4 OF 7
		THIS DRAWING CONTAINS INFORMATION THAT IS PROPRIETARY TO MOLEX INCORPORATED AND SHOULD NOT BE USED WITHOUT WRITTEN PERMISSION							

9 8 7 6 5 4 3 2 1

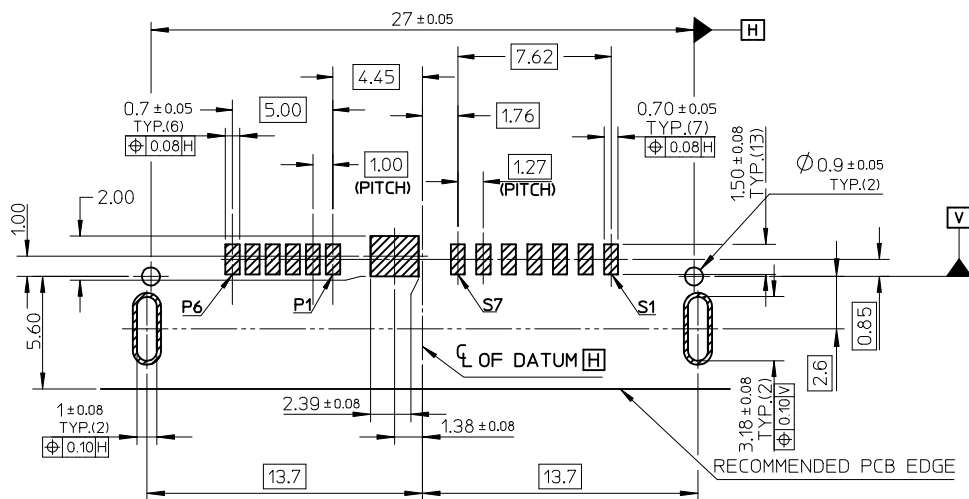

**RECOMMEND PCB LAYOUT (THICKNESS=0.8)**

REMARK:  
THE PCB LAYOUT IS ONLY FOR 47300-102X AND 47300-103X.

REVISED EC NO: SH2009-0300 DRW: XZhang 2008/11/26 CHKD: XJsong 2008/11/27 APPR: HWang 2008/12/10	QUALITY SYMBOLS ▽=0 ∇=0	GENERAL TOLERANCES (UNLESS SPECIFIED)		DIMENSION STYLE MM ONLY	SCALE 1:1	DESIGN UNITS METRIC	THIRD ANGLE PROJECTION
				DRAWN BY DIXON LI	DATE 04/04/2006	TITLE SLIMLINE SATA PLUG FOR OPTIC DISK DRIVER SOLDERING TYPE	
REV H	DESCRIPTION	4 PLACES	± ---	± ---	CHECKED BY JENNY ZENG	DATE 04/04/2006	MOLEX INCORPORATED
		3 PLACES	± ---	± ---	APPROVED BY GRATE MA	DATE 04/04/2006	
		2 PLACES	± 0.15	± ---	SHEET NO. 5 OF 7		
		1 PLACE	± 0.20	± ---	THIS DRAWING CONTAINS INFORMATION THAT IS PROPRIETARY TO MOLEX INCORPORATED AND SHOULD NOT BE USED WITHOUT WRITTEN PERMISSION		
		ANGULAR ± 3 °		SEE REMARK			
		DRAFT WHERE APPLICABLE MUST REMAIN WITHIN DIMENSIONS					

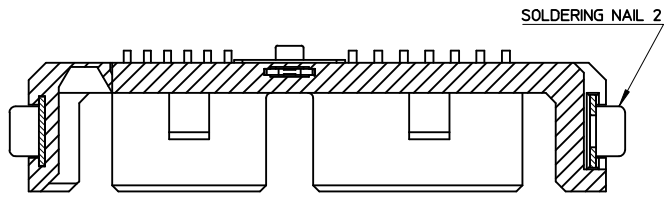

SECTION D-D

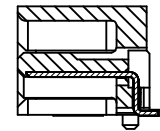

SECTION A-A

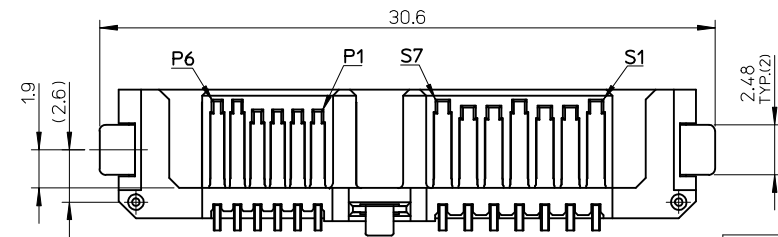
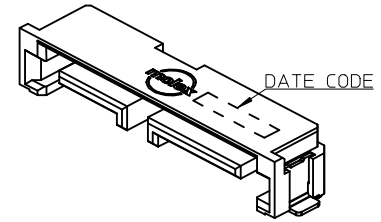
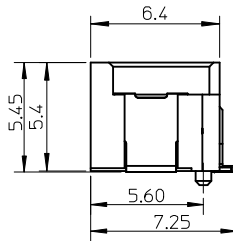
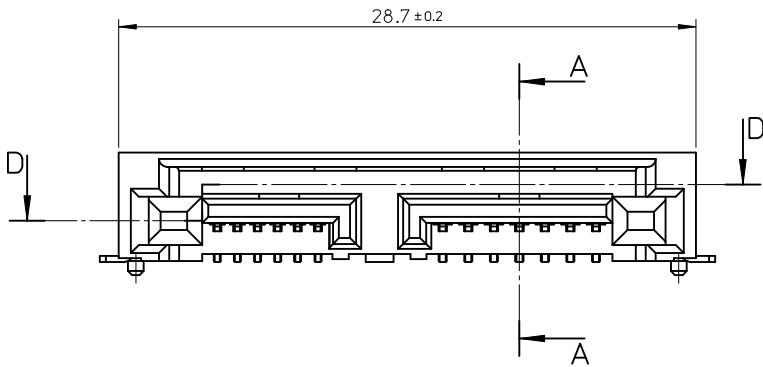

P/N	CONTACT PLATING
47300-1042	GOLD 0.76 MICRONS MIN
47300-1041	GOLD 0.38 MICRONS MIN
47300-1040	GOLD FLASH

NOTES :

- MATERIAL :  
SOLDERING NAIL 2 : COPPER ALLOY
- PLATING :  
SOLDERING NAIL 2 : MATTE TIN PLATING 1.0 MICRONS MIN.  
OVER NICKEL PLATING 1.0 MICRONS MIN.
- OTHER NOTES AND DIMENSIONS REFER TO SHEET-1.

REVISED EC NO: SH2009-0300 DRWN:XZHZHANG 2008/11/26 CHKD:XJSONG 2008/11/27 APPR:HWANG 2008/12/10	QUALITY SYMBOLS	GENERAL TOLERANCES (UNLESS SPECIFIED)	DIMENSION STYLE	SCALE	DESIGN UNITS	THIRD ANGLE PROJECTION
	▽=0 □=0	mm INCH 4 PLACES ± --- ± --- 3 PLACES ± --- ± --- 2 PLACES ± 0.15 ± --- 1 PLACE ± 0.20 ± --- ANGULAR ± 3 °	MM ONLY	1:1	METRIC	DRAWN BY DATE DIXON LI 04/04/2006 CHECKED BY DATE JENNY ZENG 04/04/2006 APPROVED BY DATE GRATE MA 04/04/2006 MATERIAL NO.
		DRAFT WHERE APPLICABLE MUST REMAIN WITHIN DIMENSIONS	SEE CHART	TITLE		SLIMLINE SATA PLUG FOR OPTIC DISK DRIVER FITTING STANDARD TYPE
				DOCUMENT NO.		MOLEX INCORPORATED SD-47300-100 SHEET NO. 6 OF 7

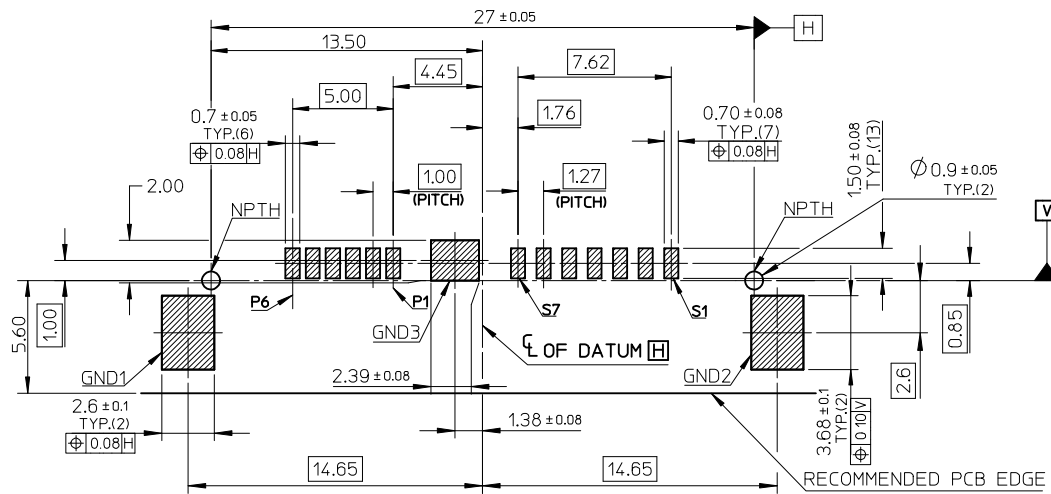

**RECOMMEND PCB LAYOUT**

REMARK:  
THE PCB LAYOUT IS ONLY FOR 47300-104X

<b>REVISED</b> EC NO: SH2009-0300 DRWN: XQZHANG 2008/11/26 CHKD: XJSONG 2008/11/27 APPR: HWANG 2008/12/10	QUALITY SYMBOLS ▽=0 Ⓢ=0	GENERAL TOLERANCES (UNLESS SPECIFIED) mm INCH 4 PLACES ± --- ± --- 3 PLACES ± --- ± --- 2 PLACES ± 0.15 ± --- 1 PLACE ± 0.20 ± --- ANGULAR ± 3 °	DIMENSION STYLE <b>MM ONLY</b> DRAWN BY DATE DIXON LI 04/04/2006 CHECKED BY DATE JENNY ZENG 04/04/2006 APPROVED BY DATE GRATE MA 04/04/2006 MATERIAL NO.	SCALE <b>1:1</b> DESIGN UNITS <b>METRIC</b> THIRD ANGLE PROJECTION	TITLE <b>SLIMLINE SATA PLUG FOR OPTIC DISK DRIVER FITTING TYPE</b> <b>MOLEX INCORPORATED</b> DOCUMENT NO.	SHEET NO. <b>7 OF 7</b>
	DRAFT WHERE APPLICABLE MUST REMAIN WITHIN DIMENSIONS	<b>SEE REMARK</b>	<b>SD-47300-100</b>	THIS DRAWING CONTAINS INFORMATION THAT IS PROPRIETARY TO MOLEX INCORPORATED AND SHOULD NOT BE USED WITHOUT WRITTEN PERMISSION		