

SECTION D-D

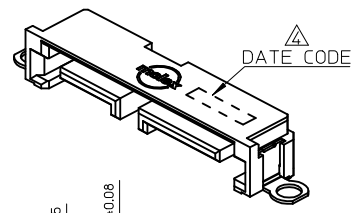

DATE CODE

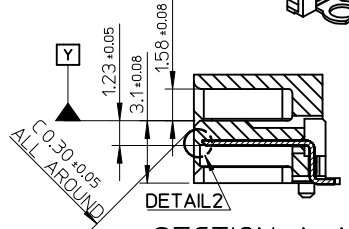

SECTION A-A

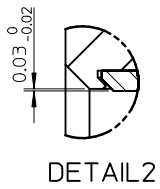
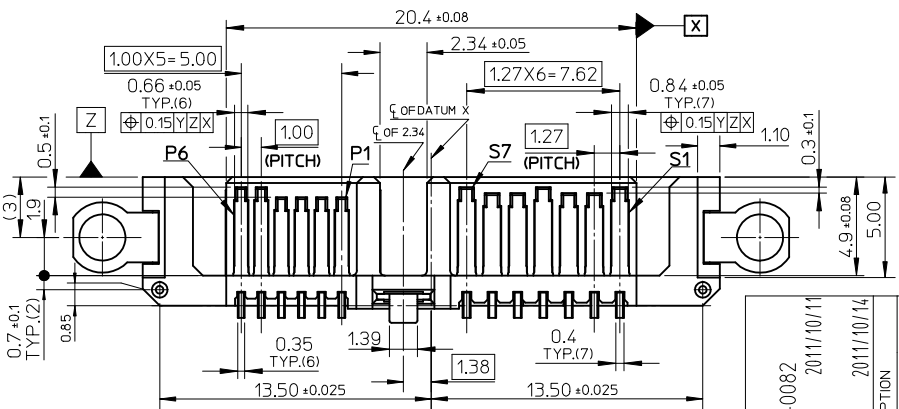
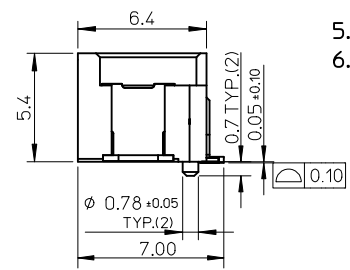
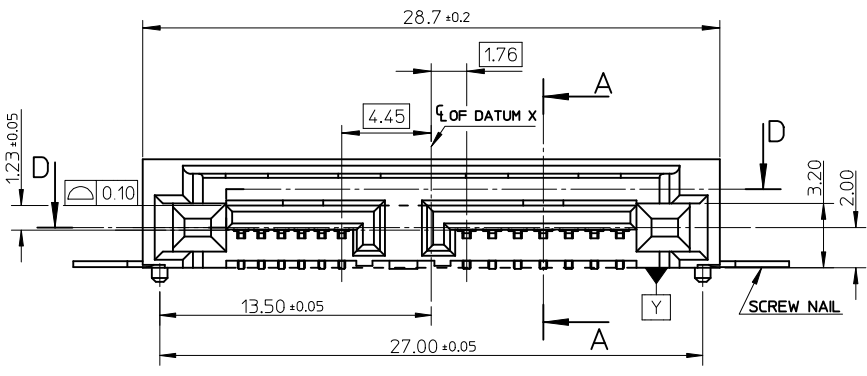

DETAIL 2

NOTES :

- MATERIAL :
HOUSING : HIGH TEMPERATURE THERMOPLASTIC, 30% G.F., UL94V-0, BLACK
TERMINAL : COPPER ALLOY, THICKNESS=0.25 MM
SCREW NAIL : STAINLESS, THICKNESS=0.30 MM
SOLDERING NAIL : COPPER ALLOY, THICKNESS=0.30 MM
- PLATING :
TERMINAL :
CONTACT AREA : SEE CHART.
SOLDERING AREA : MATTE TIN PLATING 1.0 MICRONS MIN.
UNDERPLATING : NICKEL PLATING 2.5 MICRONS MIN.
SOLDERING NAIL : MATTE TIN PLATING 1.0 MICRONS MIN.
OVER NICKEL PLATING 1.0 MICRONS MIN.
- PRODUCT SPECIFICATION: PS-47300-001.
DATE CODE FORMAT: YY/MM/DD/XX/S, 'XX' IS USED TO MARK TERMINAL GOLD PLATING SPEC, '05' IS FOR FLSH, '15' IS FOR 15u", '30' IS FOR 30u". 'S' IS A SPECIAL LETTER FOR FACTORY TO TRACK.
- PRODUCT PACKAGE SPEC: PK-47300-001.
- THE PRODUCT COMPLIANT TO RoSH DIRECTIVE 2002/95/EC AND ELV DIRECTIVE 2000/53/EC.

P/N	CONTACT PLATING	NAIL
47300-1000	GOLD FLASH	
47300-1002	GOLD 0.38 MICRONS MIN	STAINLESS STEEL, NO PLATING
47300-1004	GOLD 0.76 MICRONS MIN	
47300-1001	GOLD FLASH	
47300-1003	GOLD 0.38 MICRONS MIN	PHOSPHOR BRONZE, MATTE TIN PLATING
47300-1005	GOLD 0.76 MICRONS MIN	

REVISED EC NO: SH2012-0082 DRAWING: GLL1 CHKD: CHKD: APPR: XJ.SONG 2011/10/11 2011/10/14	QUALITY SYMBOLS F ₁ = 0 F ₂ = 0 F ₃ = 0	GENERAL TOLERANCES (UNLESS SPECIFIED)		DIMENSION STYLE MM ONLY		SCALE 4:1		DESIGN UNITS METRIC		THIRD ANGLE PROJECTION		
		4 PLACES ± --- ± --- 3 PLACES ± --- ± --- 2 PLACES ± --- ± --- 1 PLACE ± --- ± ---		DRAWN BY GLL1		DATE 2011/10/11		TITLE SLIMLINE SATA PLUG FOR OPTIC DISK DIVER SCREW STANDARD TYPE				
		ANGULAR ± 3 °		CHECKED BY		DATE		APPROVED BY				
		DRAFT WHERE APPLICABLE MUST REMAIN WITHIN DIMENSIONS		SEE TABLE		MATERIAL NO.		DOCUMENT NO.		MOLEX INCORPORATED		
SIZE A3		THIS DRAWING CONTAINS INFORMATION THAT IS PROPRIETARY TO MOLEX INCORPORATED AND SHOULD NOT BE USED WITHOUT WRITTEN PERMISSION										

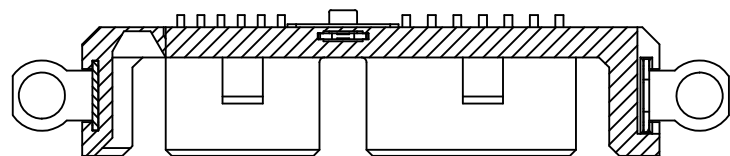

SECTION D1-D1

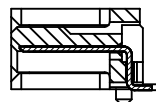

SECTION A1-A1

NOTES : OTHER DIMENSIONS AND NOTES REFER TO SHEET-1.

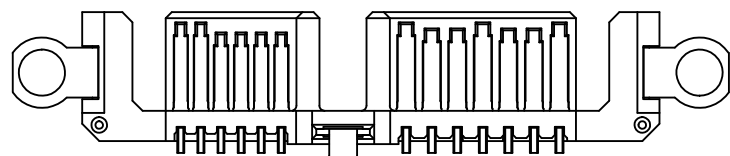
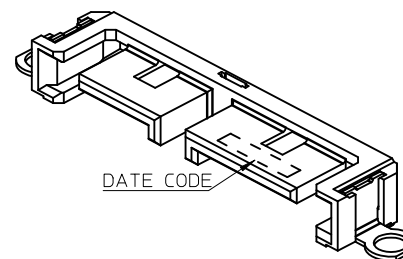
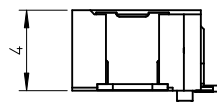
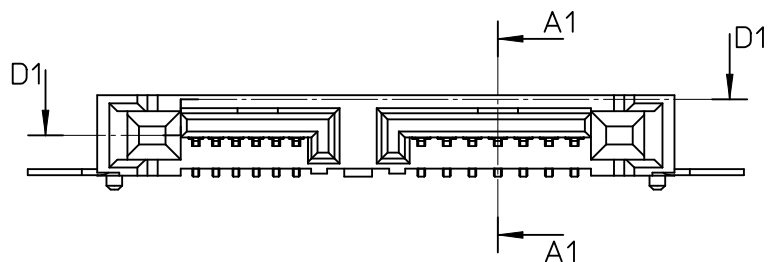

P/N	CONTACT PLATING	NAIL
47300-1014	GOLD FLASH	STAINLESS STEEL, NO PLATING
47300-1012	GOLD 0.38 MICRONS MIN	
47300-1010	GOLD 0.76 MICRONS MIN	PHOSPHOR BRONZE, MATTE TIN PLATING
47300-1015	GOLD FLASH	
47300-1013	GOLD 0.38 MICRONS MIN	
47300-1011	GOLD 0.76 MICRONS MIN	

REVISED EC NO: SH2012-0082 DRWNG: GLL1 CHKD: APPR: X.JSONG 2011/10/11 2011/10/14	QUALITY SYMBOLS $\nabla_F=0$ $\nabla_E=0$ $\nabla_D=0$	GENERAL TOLERANCES (UNLESS SPECIFIED)		DIMENSION STYLE MM ONLY	SCALE 4:1	DESIGN UNITS METRIC	THIRD ANGLE PROJECTION
		4 PLACES ± --- ± --- 3 PLACES ± --- ± --- 2 PLACES ± --- ± --- 1 PLACE ± --- ± ---	mm INCH DRAWN BY GLL1 DATE 2011/10/11 CHECKED BY DATE APPROVED BY DATE	TITLE SLIMLINE SATA PLUG FOR OPTIC DISK DIVER SCREW LOW TYPE			
		ANGULAR ± 3 °	MATERIAL NO. SEE TABLE		DOCUMENT NO. SD-47300-100	SHEET NO. 2 OF 7	
		DRAFT WHERE APPLICABLE MUST REMAIN WITHIN DIMENSIONS	THIS DRAWING CONTAINS INFORMATION THAT IS PROPRIETARY TO MOLEX INCORPORATED AND SHOULD NOT BE USED WITHOUT WRITTEN PERMISSION				

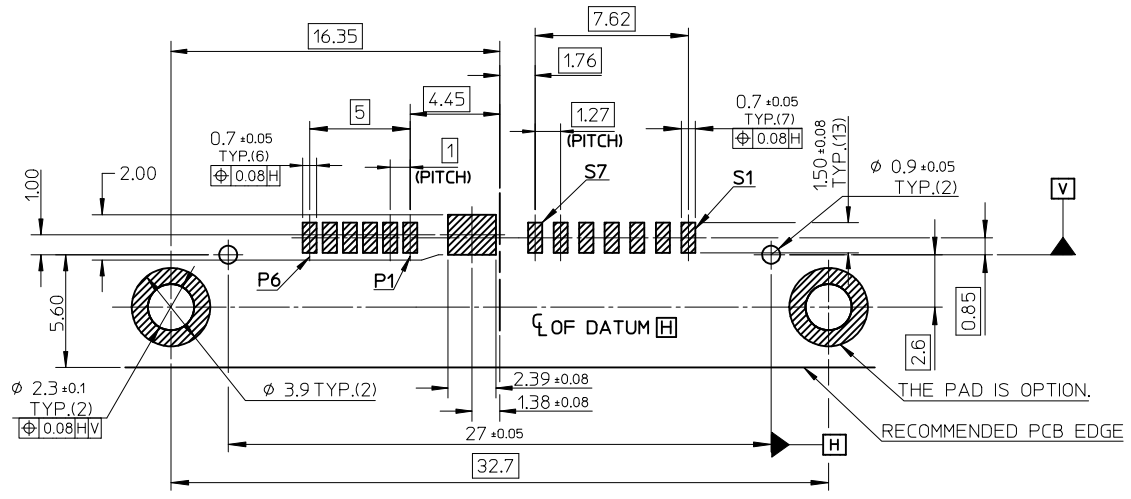

RECOMMENDED PCB LAYOUT(CONNECTOR SIDE)
THICKNESS=0.8MM

REMARK:
 THE PCB LAYOUT IS ONLY FOR 47300-100X, 47300-101X.

REVISED EC NO: SH2012-0082 DRWG: GLLI CHKD: APPR: XJ.SONG 2011/10/11 2011/10/14	REV DESCRIPTION	QUALITY SYMBOLS	GENERAL TOLERANCES (UNLESS SPECIFIED)	DIMENSION STYLE	SCALE	DESIGN UNITS	THIRD ANGLE PROJECTION	
		$\nabla = 0$ $\nabla = 0$ $\nabla = 0$	mm INCH 4 PLACES ± --- ± --- 3 PLACES ± --- ± --- 2 PLACES ± --- ± --- 1 PLACE ± --- ± --- ANGULAR ± 3 °	MM ONLY	4:1	METRIC	DRAWN BY: GLLI DATE: 2011/10/11 CHECKED BY: DATE: APPROVED BY: DATE:	SLIMLINE SATA PLUG FOR OPTIC DISK DIVER SCREW TYPE MOLEX INCORPORATED
		DRAFT WHERE APPLICABLE MUST REMAIN WITHIN DIMENSIONS	SEE REMARK	MATERIAL NO. DOCUMENT NO.	SHEET NO.			
		SIZE: A3	THIS DRAWING CONTAINS INFORMATION THAT IS PROPRIETARY TO MOLEX INCORPORATED AND SHOULD NOT BE USED WITHOUT WRITTEN PERMISSION					

10 9 8 7 6 5 4 3 2 1

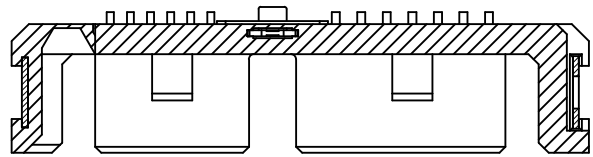

SECTION D-D

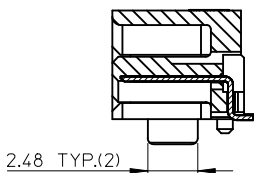

SECTION A-A

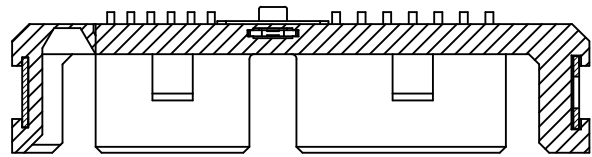

SECTION Z-Z

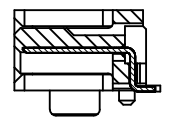

SECTION Y-Y

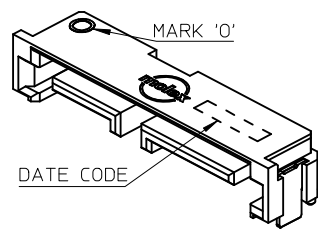
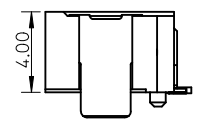
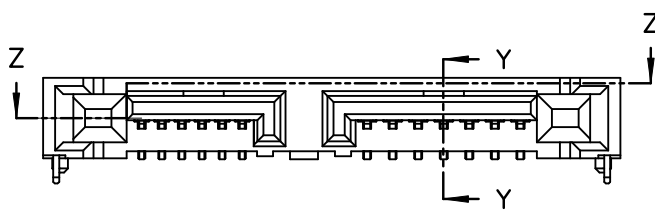
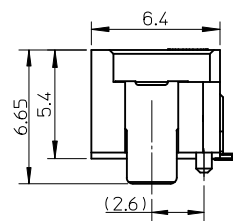
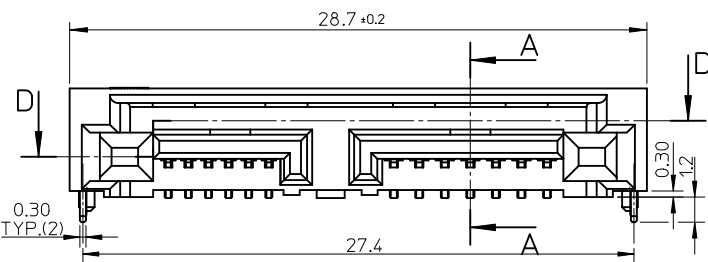

ONLY FOR 47300-1024/1025

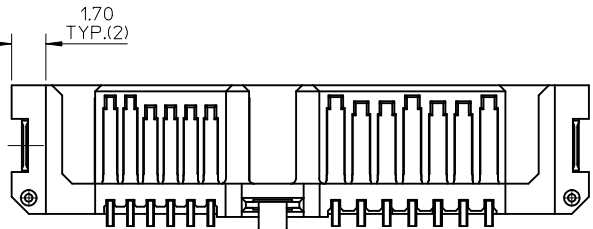
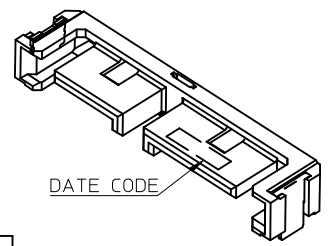
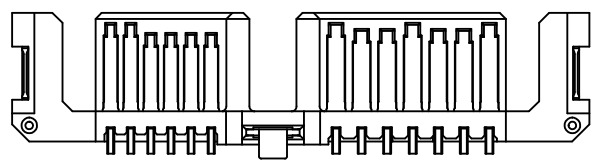

P/N	CONTACT PLATING	REMARK
47300-1026	GOLD FLASH	WITH MARK 'G'
47300-1025	GOLD 0.76 MICRONS MIN	WITH MARK 'O'
47300-1024	GOLD 0.38 MICRONS MIN	WITHOUT MARK 'O'
47300-1022	GOLD 0.76 MICRONS MIN	
47300-1021	GOLD 0.38 MICRONS MIN	
47300-1023	GOLD FLASH	
47300-1020	GOLD FLASH	

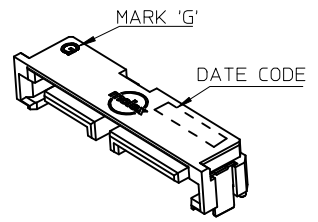

ONLY FOR 47300-1026

P/N	CONTACT PLATING
47300-1032	GOLD 0.76 MICRONS MIN
47300-1031	GOLD 0.38 MICRONS MIN
47300-1030	GOLD FLASH

NOTES : OTHER DIMENSIONS AND NOTES REFER TO 47300-102X.

- NOTES :
- MATERIAL :
SOLDERING PEG : COPPER ALLOY
 - PLATING :
SOLDERING PEG :
MATTE TIN PLATING 1.0 MICRONS MIN.
OVER NICKEL PLATING 1.0 MICRONS MIN.
 - PRODUCT PACKAGE SPEC: PK-47300-003.
 - OTHER NOTES AND DIMENSIONS REFER TO SHEET-1.

REVISED	DESCRIPTION	DATE
1	EC NO: SH2012-0082	2011/10/11
2	DRW:GLL1	2011/10/11
3	CHKD: APPR:XJ.SONG	2011/10/14

QUALITY SYMBOLS	GENERAL TOLERANCES (UNLESS SPECIFIED)	
	mm	INCH
F=0	4 PLACES ± ---	± ---
F=0	3 PLACES ± ---	± ---
F=0	2 PLACES ± ---	± ---
F=0	1 PLACE ± ---	± ---
	ANGULAR ± 3 °	
	DRAFT WHERE APPLICABLE MUST REMAIN WITHIN DIMENSIONS	

DIMENSION STYLE	
MM ONLY	
DRAWN BY	DATE
GLL1	2011/10/11
CHECKED BY	DATE
APPROVED BY	DATE
MATERIAL NO.	SEE TABLE OR NOTES
SIZE	A3

SCALE	DESIGN UNITS
4:1	METRIC

THIRD ANGLE PROJECTION	
TITLE	
SLIMLINE SATA PLUG FOR OPTIC DISK DIVER SOLDERING STANDARD TYPE	
MOLEX INCORPORATED	
DOCUMENT NO.	SHEET NO.
SD-47300-100	4 OF 7
THIS DRAWING CONTAINS INFORMATION THAT IS PROPRIETARY TO MOLEX INCORPORATED AND SHOULD NOT BE USED WITHOUT WRITTEN PERMISSION	

9 8 7 6 5 4 3 2 1

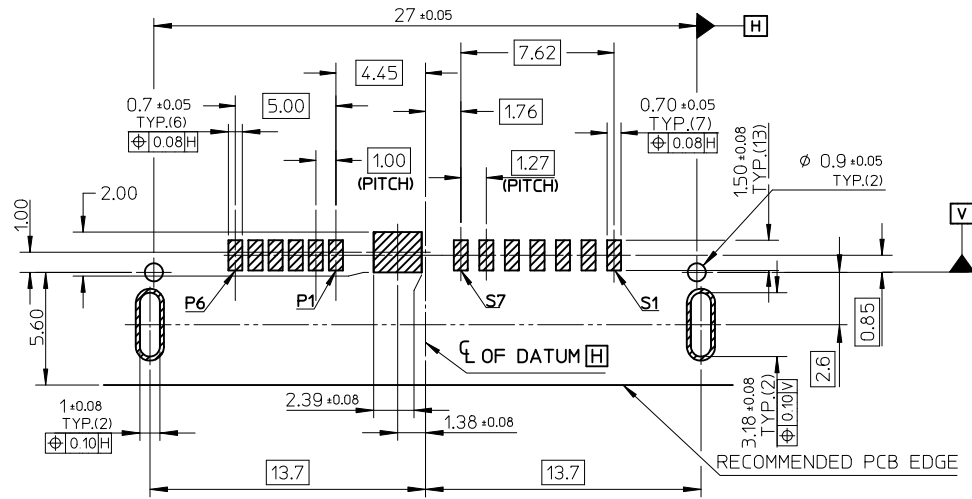

RECOMMEND PCB LAYOUT (THICKNESS=0.8)

REMARK:
THE PCB LAYOUT IS ONLY FOR 47300-102X AND 47300-103X.

REVISED EC NO: SH2012-0082 DRWNG: GLL I CHKD: APPR: X. J. SONG 2011/10/11 2011/10/14	QUALITY SYMBOLS	GENERAL TOLERANCES (UNLESS SPECIFIED)		DIMENSION STYLE	SCALE	DESIGN UNITS	THIRD ANGLE PROJECTION	
	▽=0	mm	INCH	MM ONLY	4:1	METRIC		
	▽=0	4 PLACES ± --- ± ---	3 PLACES ± --- ± ---	DRAWN BY GLL I	DATE 2011/10/11	TITLE		
	▽=0	2 PLACES ± --- ± ---	1 PLACE ± --- ± ---	CHECKED BY	DATE	SLIMLINE SATA PLUG FOR OPTIC DISK DIVER SOLDERING TYPE		
	ANGULAR ± 3 °	DRAFT WHERE APPLICABLE MUST REMAIN WITHIN DIMENSIONS		APPROVED BY	DATE	MOLEX INCORPORATED		
				MATERIAL NO.	SEE REMARK	DOCUMENT NO.	SHEET NO.	
				SIZE	A3	SD-47300-100	5 OF 7	
		THIS DRAWING CONTAINS INFORMATION THAT IS PROPRIETARY TO MOLEX INCORPORATED AND SHOULD NOT BE USED WITHOUT WRITTEN PERMISSION						

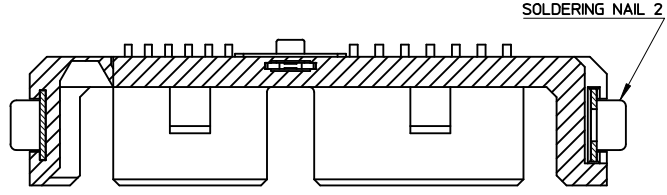

SECTION D-D

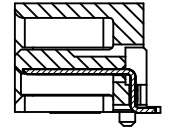

SECTION A-A

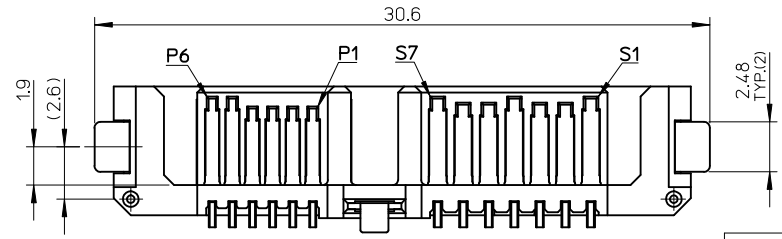
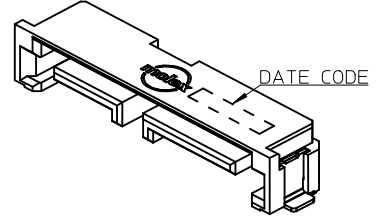
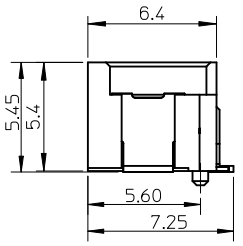
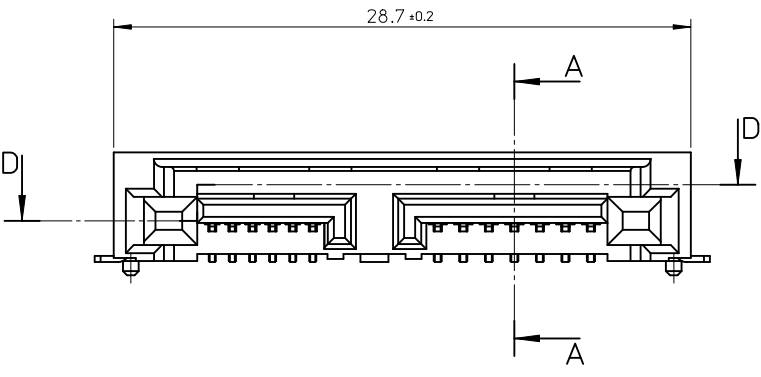

P/N	CONTACT PLATING
47300-1042	GOLD 0.76 MICRONS MIN
47300-1041	GOLD 0.38 MICRONS MIN
47300-1040	GOLD FLASH
47300-1046	GOLD FLASH

NOTES :

- 1.MATERIAL :
SOLDERING NAIL 2 : COPPER ALLOY
- 2.PLATING :
SOLDERING NAIL 2 : MATTE TIN PLATING 1.0 MICRONS MIN.
OVER NICKEL PLATING 1.0 MICRONS MIN.
3. PACKING SPEC OF 47300-1046 REFER TO PK-47300-004,
OTHER PACKING SPEC REFER TO PK-47300-001.
- 4.OTHER NOTES AND DIMENSIONS REFER TO SHEET-1.

REVISED EC NO: SH2012-0082 DRWN:GLL CHKD: APPR:XJSONG 2011/10/11 2011/10/14	QUALITY SYMBOLS	GENERAL TOLERANCES (UNLESS SPECIFIED)	DIMENSION STYLE	SCALE	DESIGN UNITS	THIRD ANGLE PROJECTION															
	$\nabla_A = 0$ $\nabla_C = 0$ $\nabla_P = 0$	<table border="1"> <thead> <tr> <th></th> <th>mm</th> <th>INCH</th> </tr> </thead> <tbody> <tr> <td>4 PLACES</td> <td>± ---</td> <td>± ---</td> </tr> <tr> <td>3 PLACES</td> <td>± ---</td> <td>± ---</td> </tr> <tr> <td>2 PLACES</td> <td>± ---</td> <td>± ---</td> </tr> <tr> <td>1 PLACE</td> <td>± ---</td> <td>± ---</td> </tr> </tbody> </table>		mm	INCH	4 PLACES	± ---	± ---	3 PLACES	± ---	± ---	2 PLACES	± ---	± ---	1 PLACE	± ---	± ---	MM ONLY	4:1	METRIC	
		mm	INCH																		
	4 PLACES	± ---	± ---																		
3 PLACES	± ---	± ---																			
2 PLACES	± ---	± ---																			
1 PLACE	± ---	± ---																			
DRAWN BY: GLL CHECKED BY: APPROVED BY: XJSONG DATE: 2011/10/11	DRAWN BY: GLL CHECKED BY: APPROVED BY: XJSONG DATE: 2011/10/11	DRAWN BY: GLL DATE: 2011/10/11 CHECKED BY: _____ DATE: _____ APPROVED BY: _____ DATE: _____	TITLE	SLIMLINE SATA PLUG FOR OPTIC DISK DIVER FITTING STANDARD TYPE																	
MATERIAL NO. SEE TABLE SIZE A3	DRAFT WHERE APPLICABLE MUST REMAIN WITHIN DIMENSIONS	MATERIAL NO. SEE TABLE SIZE A3	MOLEX INCORPORATED DOCUMENT NO. SD-47300-100	SHEET NO. 6 OF 7																	

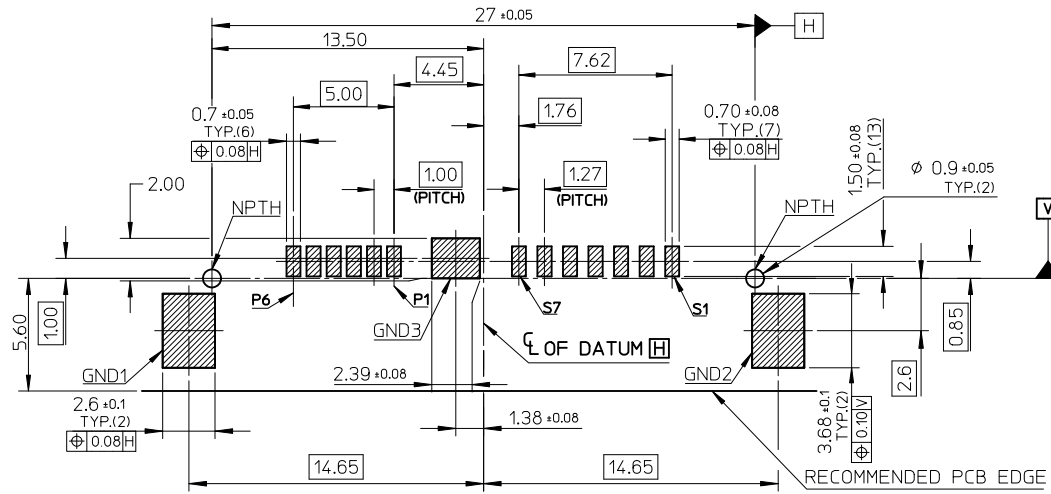

RECOMMEND PCB LAYOUT

REMARK:
THE PCB LAYOUT IS ONLY FOR 47300-104X

REVISED IEC NO: SH2012-0082 DRWNG: GLL1 CHYKD: APPR: X.J.SONG 2011/10/11 2011/10/14	QUALITY SYMBOLS $\nabla_F = 0$ $\nabla_E = 0$ $\nabla_A = 0$	GENERAL TOLERANCES (UNLESS SPECIFIED)		DIMENSION STYLE MM ONLY	SCALE 4:1	DESIGN UNITS METRIC	THIRD ANGLE PROJECTION		
		4 PLACES ± --- ± --- 3 PLACES ± --- ± --- 2 PLACES ± --- ± --- 1 PLACE ± --- ± ---	mm INCH	DRAWN BY GLL1	DATE 2011/10/11	TITLE SLIMLINE SATA PLUG FOR OPTIC DISK DIVER FITTING TYPE			
		ANGULAR ± 3 °		CHECKED BY	DATE	APPROVED BY			
		DRAFT WHERE APPLICABLE MUST REMAIN WITHIN DIMENSIONS		MATERIAL NO. SEE REMARK	DATE	MOLEX INCORPORATED		DOCUMENT NO. SD-47300-100	SHEET NO. 7 OF 7

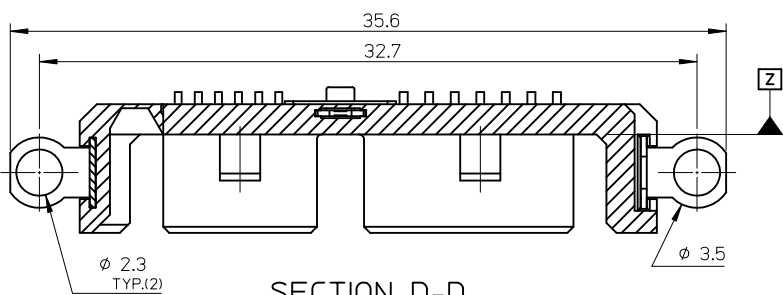

SECTION D-D

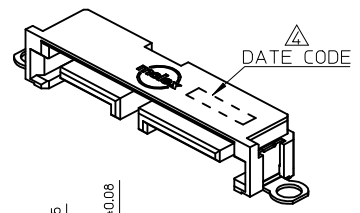

DATE CODE

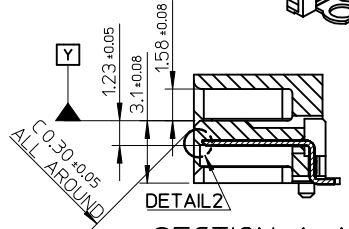

SECTION A-A

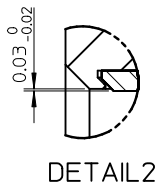
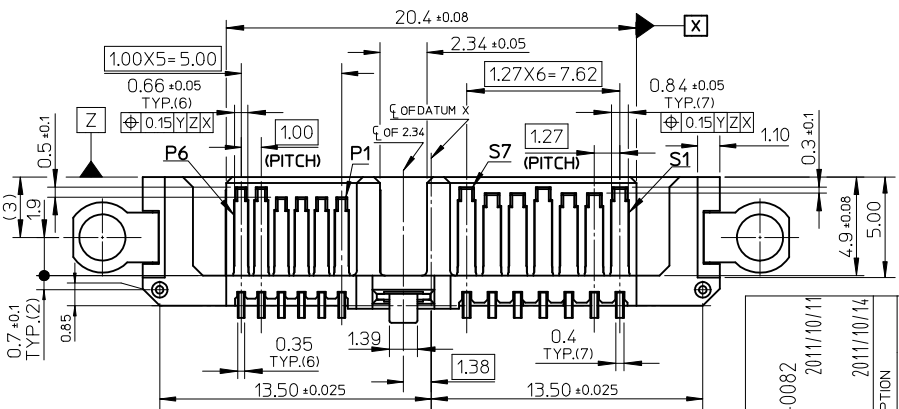
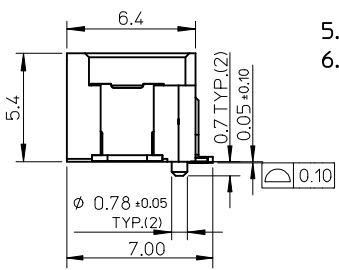
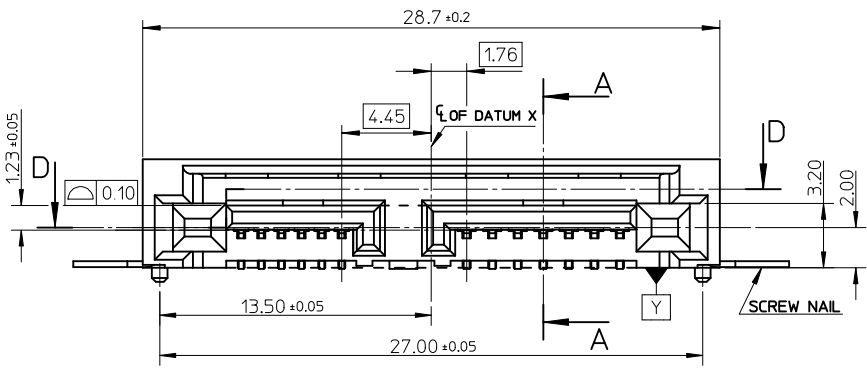

DETAIL2

NOTES :

- 1.MATERIAL :
 - HOUSING : HIGH TEMPERATURE THERMOPLASTIC, 30% G.F., UL94V-0, BLACK
 - TERMINAL : COPPER ALLOY, THICKNESS=0.25 MM
 - SCREW NAIL : STAINLESS, THICKNESS=0.30 MM
 - SOLDERING NAIL : COPPER ALLOY, THICKNESS=0.30 MM
- 2.PLATING :
 - TERMINAL :
 - CONTACT AREA : SEE CHART.
 - SOLDERING AREA : MATTE TIN PLATING 1.0 MICRONS MIN.
 - UNDERPLATING : NICKEL PLATING 2.5 MICRONS MIN.
 - SOLDERING NAIL : MATTE TIN PLATING 1.0 MICRONS MIN. OVER NICKEL PLATING 1.0 MICRONS MIN.
- 3.PRODUCT SPECIFICATION: PS-47300-001.
- DATE CODE FORMAT: YY/MM/DD/XX/S, 'XX' IS USED TO MARK TERMINAL GOLD PLATING SPEC, '05' IS FOR FLSH, '15' IS FOR 15u", '30' IS FOR 30u". 'S' IS A SPECIAL LETTER FOR FACTORY TO TRACK.
- 5.PRODUCT PACKAGE SPEC: PK-47300-001.
- 6.THE PRODUCT COMPLIANT TO RoSH DIRECTIVE 2002/95/EC AND ELV DIRECTIVE 2000/53/EC.

P/N	CONTACT PLATING	NAIL
47300-1000	GOLD FLASH	
47300-1002	GOLD 0.38 MICRONS MIN	STAINLESS STEEL, NO PLATING
47300-1004	GOLD 0.76 MICRONS MIN	
47300-1001	GOLD FLASH	
47300-1003	GOLD 0.38 MICRONS MIN	PHOSPHOR BRONZE, MATTE TIN PLATING
47300-1005	GOLD 0.76 MICRONS MIN	

REVISED EC NO: SH2012-0082 DRAWING: GLL1 CHK'D: APPR: X.J.SONG 2011/10/11 2011/10/14	QUALITY SYMBOLS F ₁ = 0 F ₂ = 0 F ₃ = 0	GENERAL TOLERANCES (UNLESS SPECIFIED)		DIMENSION STYLE MM ONLY		SCALE 4:1		DESIGN UNITS METRIC		THIRD ANGLE PROJECTION		
		4 PLACES ± --- ± --- 3 PLACES ± --- ± --- 2 PLACES ± --- ± --- 1 PLACE ± --- ± ---		DRAWN BY GLL1		DATE 2011/10/11		TITLE SLIMLINE SATA PLUG FOR OPTIC DISK DIVER SCREW STANDARD TYPE				
		ANGULAR ± 3 °		CHECKED BY		DATE		APPROVED BY				
		DRAFT WHERE APPLICABLE MUST REMAIN WITHIN DIMENSIONS		MATERIAL NO. SEE TABLE		DOCUMENT NO. SD-47300-100		SHEET NO. 1 OF 7				

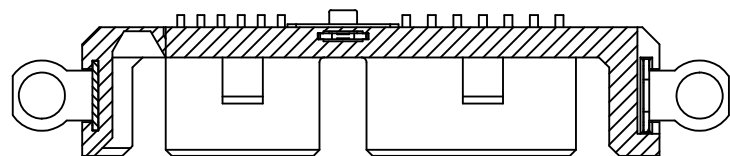

SECTION D1-D1

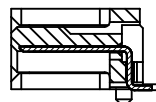

SECTION A1-A1

NOTES : OTHER DIMENSIONS AND NOTES REFER TO SHEET-1.

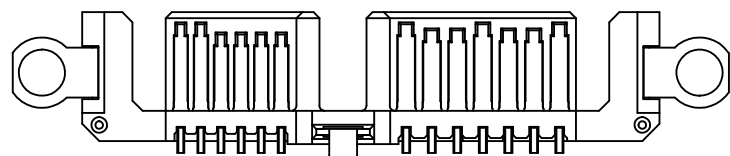
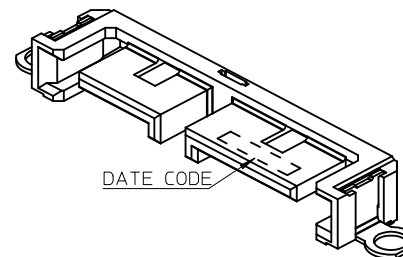
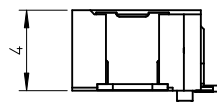
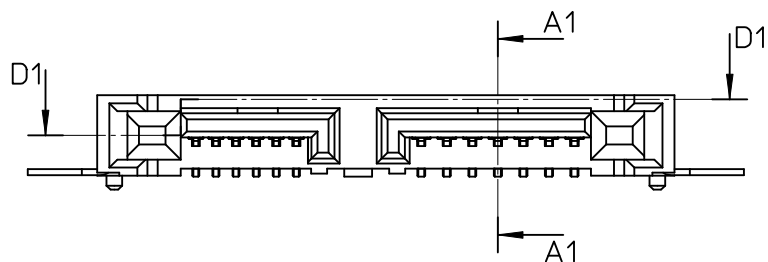

P/N	CONTACT PLATING	NAIL
47300-1014	GOLD FLASH	STAINLESS STEEL, NO PLATING
47300-1012	GOLD 0.38 MICRONS MIN	
47300-1010	GOLD 0.76 MICRONS MIN	PHOSPHOR BRONZE, MATTE TIN PLATING
47300-1015	GOLD FLASH	
47300-1013	GOLD 0.38 MICRONS MIN	
47300-1011	GOLD 0.76 MICRONS MIN	

REVISED EC NO: SH2012-0082 DRWNG: GLL1 CHKD: APPR: X.JSONG 2011/10/11 2011/10/14	QUALITY SYMBOLS $\nabla_F=0$ $\nabla_E=0$ $\nabla_D=0$	GENERAL TOLERANCES (UNLESS SPECIFIED)		DIMENSION STYLE MM ONLY	SCALE 4:1	DESIGN UNITS METRIC	THIRD ANGLE PROJECTION		
		4 PLACES ± --- ± --- 3 PLACES ± --- ± --- 2 PLACES ± --- ± --- 1 PLACE ± --- ± ---	mm INCH	DRAWN BY GLL1	DATE 2011/10/11	TITLE SLIMLINE SATA PLUG FOR OPTIC DISK DIVER SCREW LOW TYPE			
		ANGULAR ± 3 °	DRAFT WHERE APPLICABLE MUST REMAIN WITHIN DIMENSIONS		APPROVED BY DATE	MOLEX INCORPORATED			
		MATERIAL NO. SEE TABLE	DOCUMENT NO. SD-47300-100	SHEET NO. 2 OF 7	THIS DRAWING CONTAINS INFORMATION THAT IS PROPRIETARY TO MOLEX INCORPORATED AND SHOULD NOT BE USED WITHOUT WRITTEN PERMISSION				

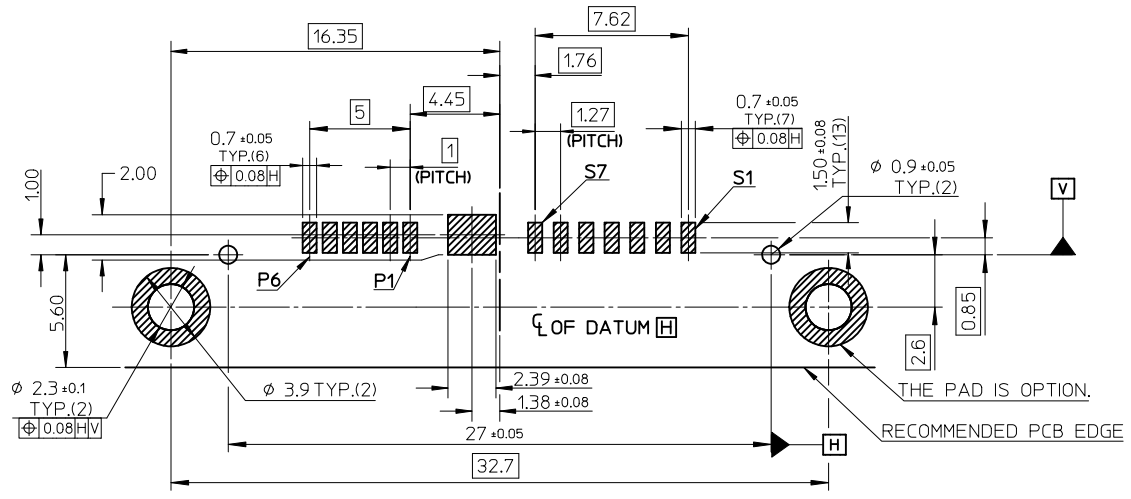

RECOMMENDED PCB LAYOUT(CONNECTOR SIDE)
THICKNESS=0.8MM

REMARK:
 THE PCB LAYOUT IS ONLY FOR 47300-100X, 47300-101X.

REVISED EC NO: SH2012-0082 DRWG: GLLI CHKD: APPR: XJ.SONG 2011/10/11 2011/10/14	REV DESCRIPTION	QUALITY SYMBOLS	GENERAL TOLERANCES (UNLESS SPECIFIED)	DIMENSION STYLE	SCALE	DESIGN UNITS	THIRD ANGLE PROJECTION	
		$\nabla = 0$ $\nabla = 0$ $\nabla = 0$	mm INCH 4 PLACES ± --- ± --- 3 PLACES ± --- ± --- 2 PLACES ± --- ± --- 1 PLACE ± --- ± --- ANGULAR ± 3 °	MM ONLY	4:1	METRIC	DRAWN BY: GLLI DATE: 2011/10/11 CHECKED BY: DATE: APPROVED BY: DATE:	TITLE: SLIMLINE SATA PLUG FOR OPTIC DISK DIVER SCREW TYPE MOLEX INCORPORATED
		DRAFT WHERE APPLICABLE MUST REMAIN WITHIN DIMENSIONS	MATERIAL NO. SEE REMARK SIZE: A3	DOCUMENT NO. SD-47300-100 SHEET NO. 3 OF 7	THIS DRAWING CONTAINS INFORMATION THAT IS PROPRIETARY TO MOLEX INCORPORATED AND SHOULD NOT BE USED WITHOUT WRITTEN PERMISSION			

10 9 8 7 6 5 4 3 2 1

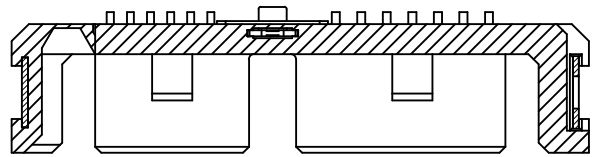

SECTION D-D

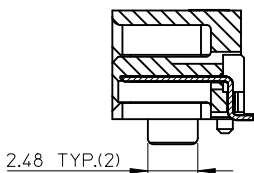

SECTION A-A

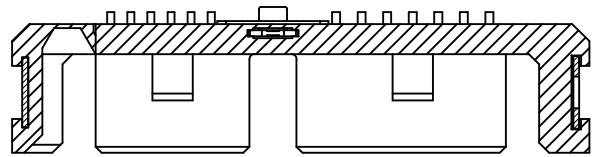

SECTION Z-Z

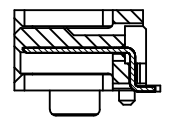

SECTION Y-Y

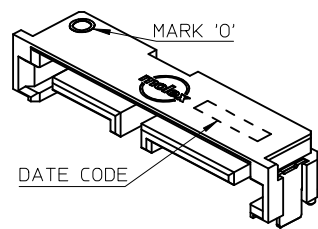
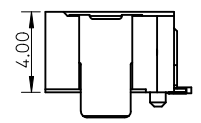
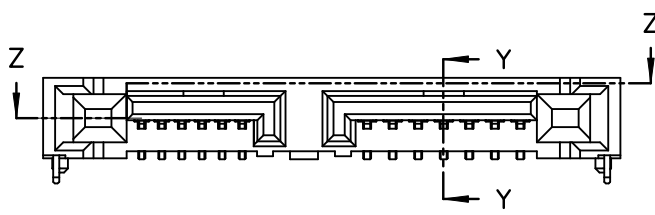
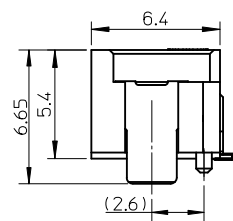
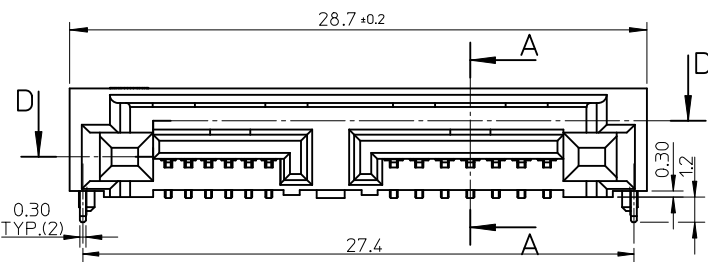

ONLY FOR 47300-1024/1025

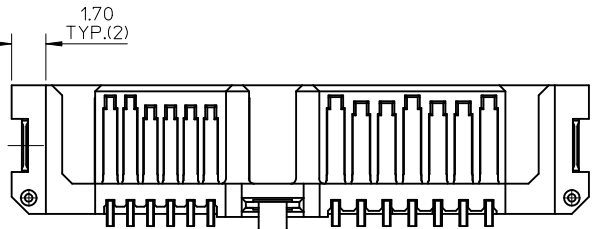
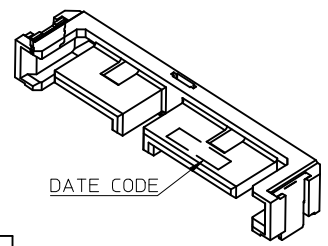
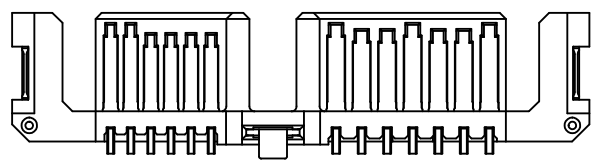

P/N	CONTACT PLATING	REMARK
47300-1026	GOLD FLASH	WITH MARK 'G'
47300-1025	GOLD 0.76 MICRONS MIN	WITH MARK 'O'
47300-1024	GOLD 0.38 MICRONS MIN	WITHOUT MARK 'O'
47300-1022	GOLD 0.76 MICRONS MIN	
47300-1021	GOLD 0.38 MICRONS MIN	
47300-1023	GOLD FLASH	
47300-1020	GOLD FLASH	

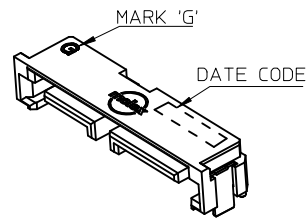

ONLY FOR 47300-1026

P/N	CONTACT PLATING
47300-1032	GOLD 0.76 MICRONS MIN
47300-1031	GOLD 0.38 MICRONS MIN
47300-1030	GOLD FLASH

NOTES : OTHER DIMENSIONS AND NOTES REFER TO 47300-102X.

- NOTES :
- MATERIAL :
SOLDERING PEG : COPPER ALLOY
 - PLATING :
SOLDERING PEG :
MATTE TIN PLATING 1.0 MICRONS MIN.
OVER NICKEL PLATING 1.0 MICRONS MIN.
 - PRODUCT PACKAGE SPEC: PK-47300-003.
 - OTHER NOTES AND DIMENSIONS REFER TO SHEET-1.

REVISED	EC NO: SH2012-0082	2011/10/11	QUALITY SYMBOLS
DRW:GLL1	CHKD:	2011/10/14	▽=0
APPR:XJ.SONG	DESCRIPTION		▽=0
REV			▽=0

GENERAL TOLERANCES (UNLESS SPECIFIED)	
	mm INCH
4 PLACES	± --- ± ---
3 PLACES	± --- ± ---
2 PLACES	± --- ± ---
1 PLACE	± --- ± ---
ANGULAR ± 3 °	
DRAFT WHERE APPLICABLE MUST REMAIN WITHIN DIMENSIONS	

DIMENSION STYLE	
MM ONLY	
DRAWN BY	DATE
GLL1	2011/10/11
CHECKED BY	DATE
APPROVED BY	DATE
MATERIAL NO.	
SEE TABLE OR NOTES	
SIZE	A3

SCALE	4:1
DESIGN UNITS	METRIC
THIRD ANGLE PROJECTION	
TITLE	
SLIMLINE SATA PLUG FOR OPTIC DISK DIVER SOLDERING STANDARD TYPE	
MOLEX INCORPORATED	
DOCUMENT NO.	SD-47300-100
SHEET NO.	4 OF 7

THIS DRAWING CONTAINS INFORMATION THAT IS PROPRIETARY TO MOLEX INCORPORATED AND SHOULD NOT BE USED WITHOUT WRITTEN PERMISSION	
---	--

9 8 7 6 5 4 3 2 1

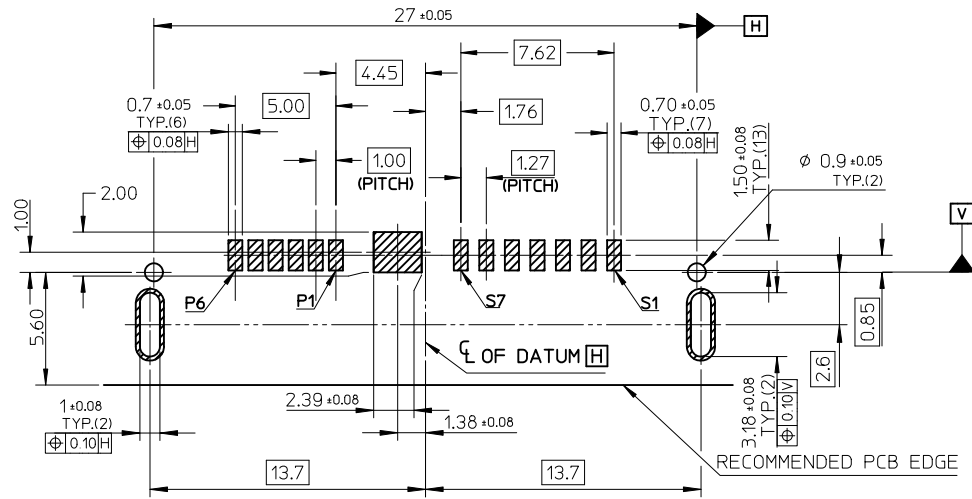

RECOMMEND PCB LAYOUT (THICKNESS=0.8)

REMARK:
THE PCB LAYOUT IS ONLY FOR 47300-102X AND 47300-103X.

REVISED EC NO: SH2012-0082 DRWNG: GLL I CHKD: APPR: X.J.SONG 2011/10/11 2011/10/14	QUALITY SYMBOLS	GENERAL TOLERANCES (UNLESS SPECIFIED)		DIMENSION STYLE	SCALE	DESIGN UNITS	THIRD ANGLE PROJECTION
	▽=0	mm	INCH	MM ONLY	4:1	METRIC	
	▽=0	4 PLACES ± --- ± ---	3 PLACES ± --- ± ---	DRAWN BY GLL I	DATE 2011/10/11	TITLE SLIMLINE SATA PLUG FOR OPTIC DISK DIVER SOLDERING TYPE	
	▽=0	2 PLACES ± --- ± ---	1 PLACE ± --- ± ---	CHECKED BY	DATE	MOLEX INCORPORATED	
	ANGULAR ± 3 °	DRAFT WHERE APPLICABLE MUST REMAIN WITHIN DIMENSIONS		APPROVED BY	DATE	DOCUMENT NO. SD-47300-100	SHEET NO. 5 OF 7
				MATERIAL NO.	SEE REMARK		
				SIZE A3	THIS DRAWING CONTAINS INFORMATION THAT IS PROPRIETARY TO MOLEX INCORPORATED AND SHOULD NOT BE USED WITHOUT WRITTEN PERMISSION		

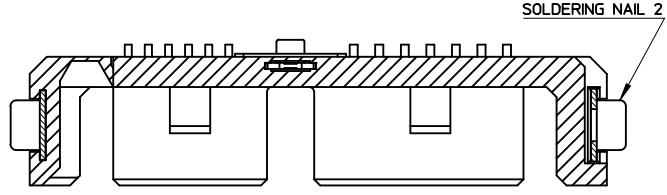

SECTION D-D

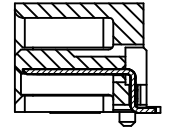

SECTION A-A

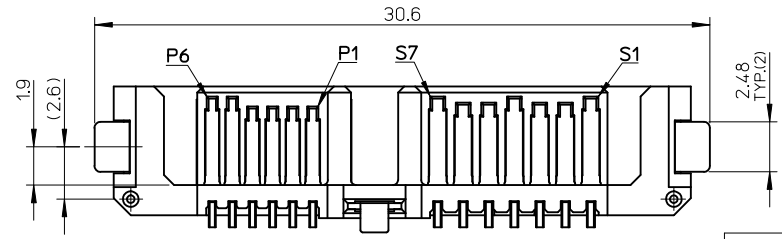
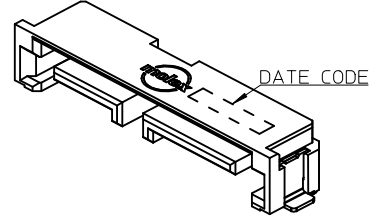
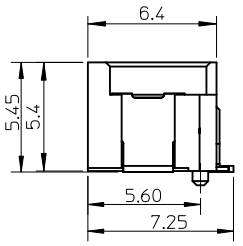
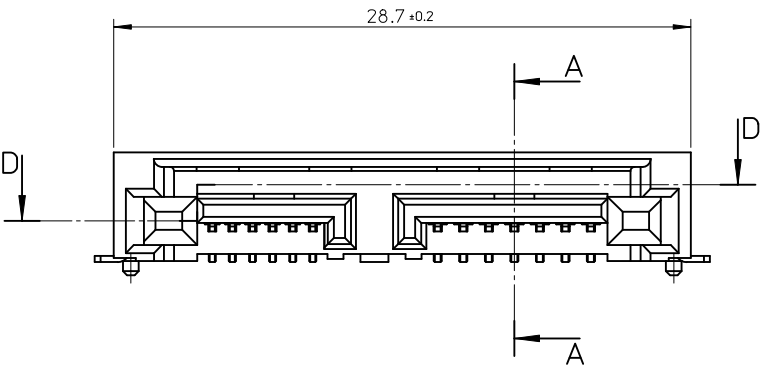

P/N	CONTACT PLATING
47300-1042	GOLD 0.76 MICRONS MIN
47300-1041	GOLD 0.38 MICRONS MIN
47300-1040	GOLD FLASH
47300-1046	GOLD FLASH

NOTES :

- 1.MATERIAL :
SOLDERING NAIL 2 : COPPER ALLOY
- 2.PLATING :
SOLDERING NAIL 2 : MATTE TIN PLATING 1.0 MICRONS MIN.
OVER NICKEL PLATING 1.0 MICRONS MIN.
3. PACKING SPEC OF 47300-1046 REFER TO PK-47300-004,
OTHER PACKING SPEC REFER TO PK-47300-001.
- 4.OTHER NOTES AND DIMENSIONS REFER TO SHEET-1.

REVISED EC NO: SH2012-0082 DRWN:GLL CHKD: APPR:XJSONG 2011/10/11 2011/10/14	QUALITY SYMBOLS	GENERAL TOLERANCES (UNLESS SPECIFIED)	DIMENSION STYLE	SCALE	DESIGN UNITS	THIRD ANGLE PROJECTION															
	$\nabla_A = 0$ $\nabla_C = 0$ $\nabla_P = 0$	<table border="1"> <thead> <tr> <th></th> <th>mm</th> <th>INCH</th> </tr> </thead> <tbody> <tr> <td>4 PLACES</td> <td>± ---</td> <td>± ---</td> </tr> <tr> <td>3 PLACES</td> <td>± ---</td> <td>± ---</td> </tr> <tr> <td>2 PLACES</td> <td>± ---</td> <td>± ---</td> </tr> <tr> <td>1 PLACE</td> <td>± ---</td> <td>± ---</td> </tr> </tbody> </table>		mm	INCH	4 PLACES	± ---	± ---	3 PLACES	± ---	± ---	2 PLACES	± ---	± ---	1 PLACE	± ---	± ---	MM ONLY	4:1	METRIC	
		mm	INCH																		
	4 PLACES	± ---	± ---																		
3 PLACES	± ---	± ---																			
2 PLACES	± ---	± ---																			
1 PLACE	± ---	± ---																			
DRAWN BY: GLL CHECKED BY: APPROVED BY: XJSONG DATE: 2011/10/11	DRAFT WHERE APPLICABLE MUST REMAIN WITHIN DIMENSIONS	SEE TABLE	DRAWN BY: GLL DATE: 2011/10/11 CHECKED BY: DATE: APPROVED BY: DATE:	TITLE: SLIMLINE SATA PLUG FOR OPTIC DISK DIVER FITTING STANDARD TYPE	MATERIAL NO. SEE TABLE	DOCUMENT NO. SD-47300-100															
SIZE: A3 THIS DRAWING CONTAINS INFORMATION THAT IS PROPRIETARY TO MOLEX INCORPORATED AND SHOULD NOT BE USED WITHOUT WRITTEN PERMISSION					MOLEX INCORPORATED	SHEET NO. 6 OF 7															

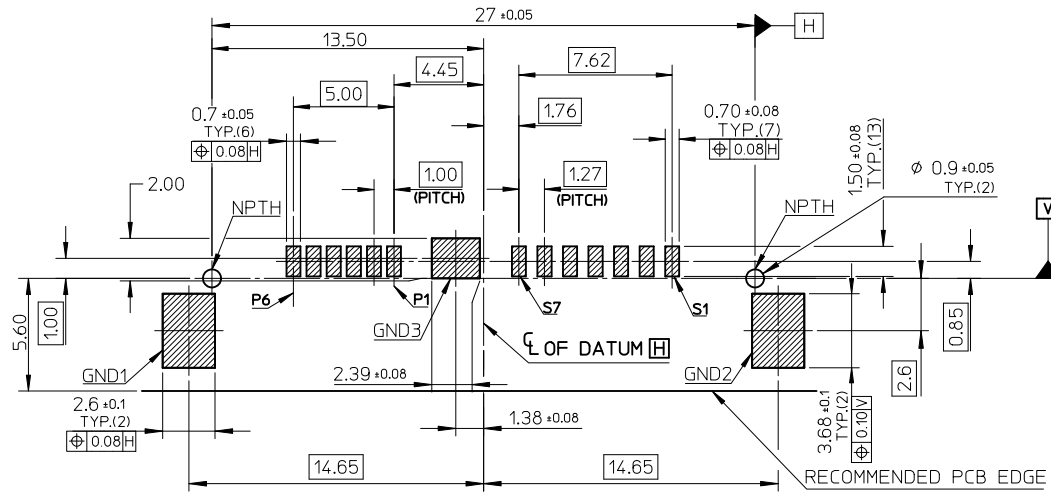

RECOMMEND PCB LAYOUT

REMARK:
THE PCB LAYOUT IS ONLY FOR 47300-104X

REVISED IEC NO: SH2012-0082 DRWG:GLL1 CH/KD: APPR:X.J.SONG 2011/10/11 2011/10/14	QUALITY SYMBOLS	GENERAL TOLERANCES (UNLESS SPECIFIED)		DIMENSION STYLE	SCALE	DESIGN UNITS	THIRD ANGLE PROJECTION
	$\nabla_F = 0$ $\nabla_E = 0$ $\nabla_A = 0$	4 PLACES ± --- ± --- 3 PLACES ± --- ± --- 2 PLACES ± --- ± --- 1 PLACE ± --- ± ---	MM ONLY	4:1	METRIC	TITLE SLIMLINE SATA PLUG FOR OPTIC DISK DIVER FITTING TYPE	
		ANGULAR ± 3 °	DRAWN BY DATE	CHECKED BY DATE	MOLEX MOLEX INCORPORATED		
		DRAFT WHERE APPLICABLE MUST REMAIN WITHIN DIMENSIONS	SEE REMARK	APPROVED BY DATE	MATERIAL NO.	DOCUMENT NO.	SHEET NO.