

**NOTES:**

- HOUSING MATERIAL : GLASS FILLED LIQUID CRYSTAL POLYMER (LCP);  
UL RATING: 94V-0; COLOR: WHITE  
TERMINAL MATERIAL: PHOSPHOR BRONZE  
VACUUM CAP MATERIAL: STAINLESS STEEL
- COPLANARITY OF SMT TAILS: 0.10 MAX.
- PACKAGING SPECIFICATIONS : REFER TO TABLE.
- THIS PART, WHEN MATED WITH MOLEX U.S.PART NO. 71742-0\*\*\* OR MOLEX JAPAN PART NO. 52841-0848, CONFORMS TO MOLEX PRODUCT SPECIFICATION PS-71741-9999.

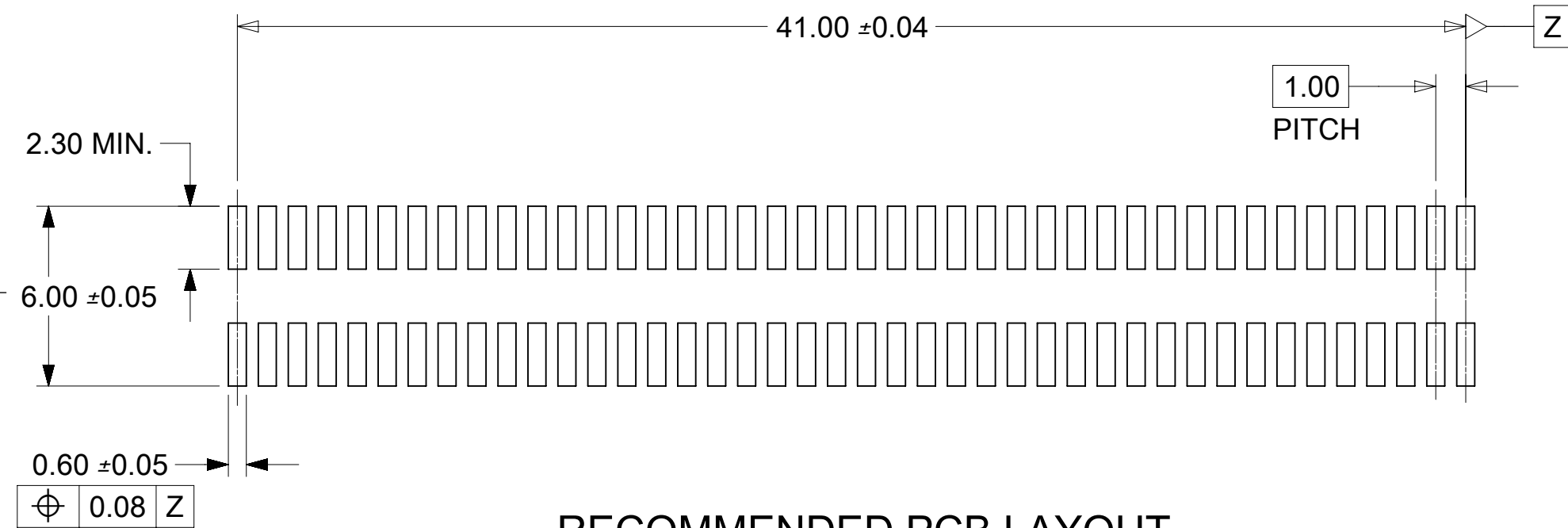
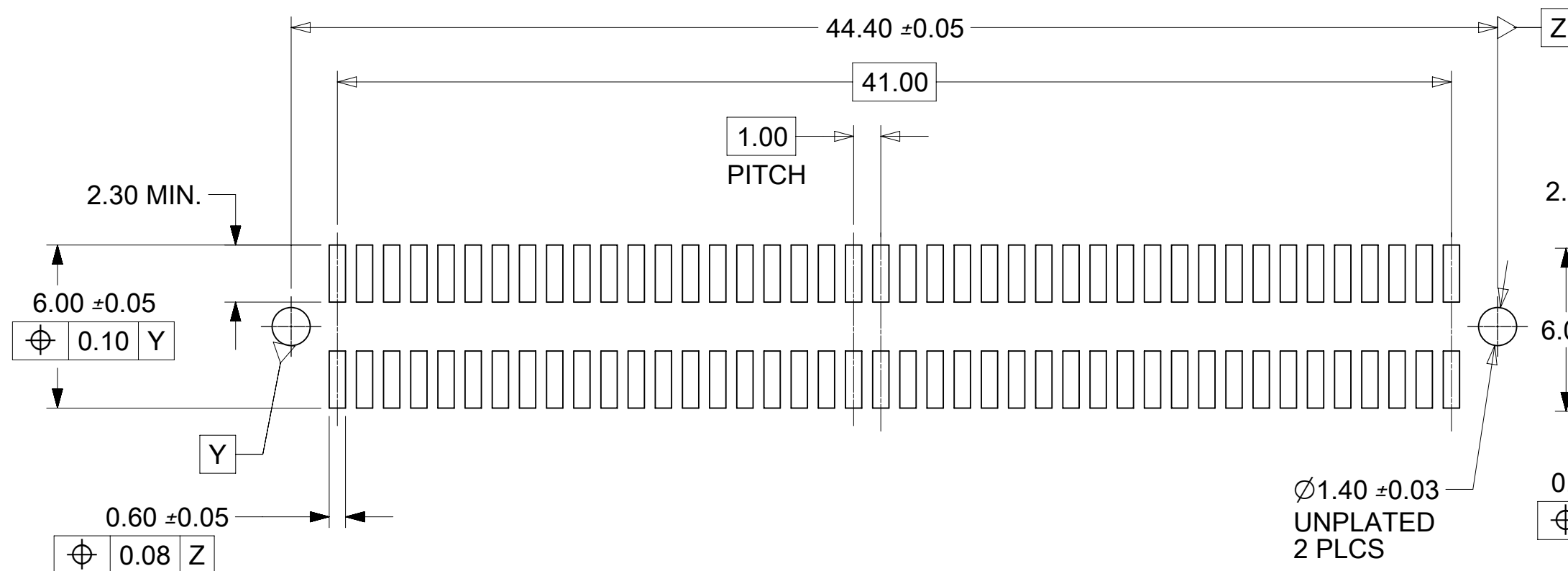
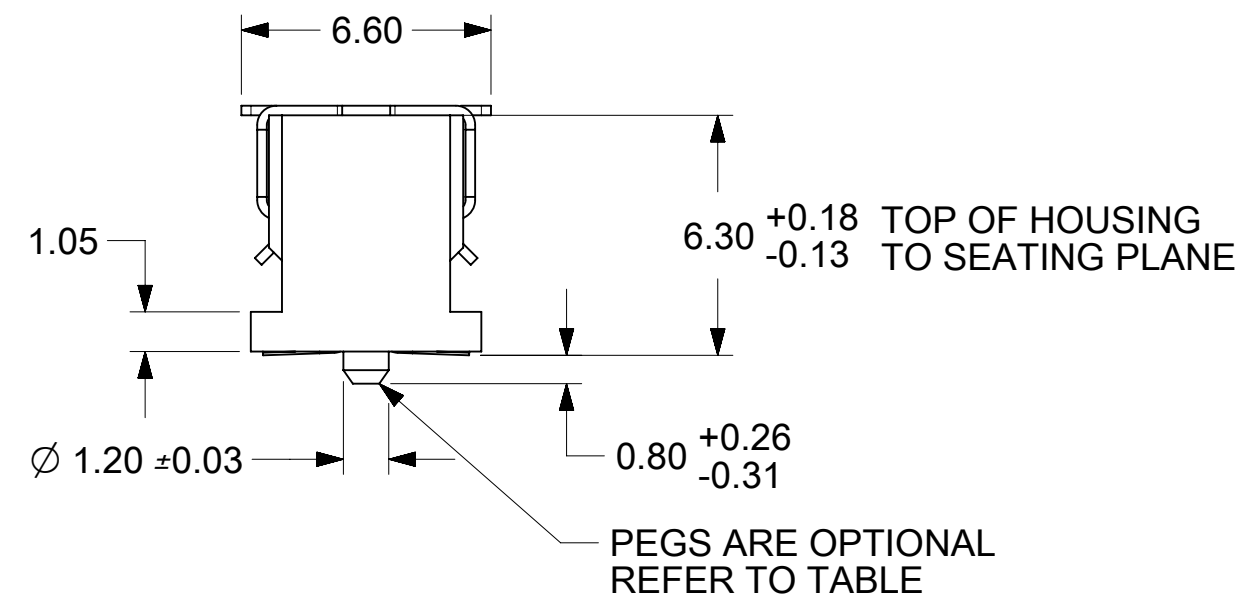
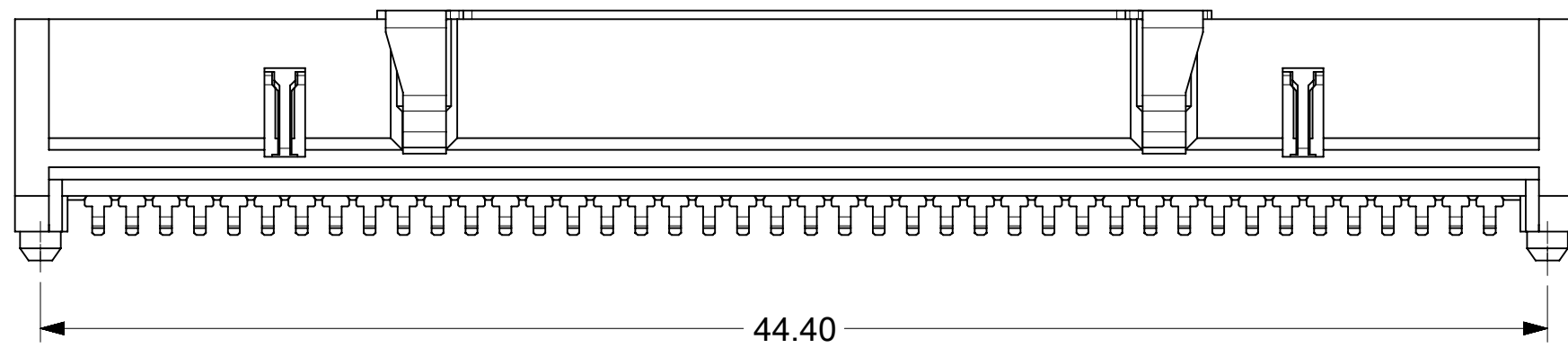

**RECOMMENDED PCB LAYOUT WITH PEGS**

RECOMMENDED PCB THICKNESS: 1.0±0.1 mm MIN.

**RECOMMENDED PCB LAYOUT**

RECOMMENDED PCB THICKNESS: 1.0±0.1 mm MIN.

**PLATINGS:**

- X21 - .76 MICROMETERS MINIMUM GOLD PLATE IN SELECT AREA, 1.91 MICROMETERS MINIMUM TIN PLATE IN SELECT AREA, OVER NICKEL UNDERPLATE.
- X71 - .25 MICROMETERS MINIMUM GOLD PLATE IN SELECT AREA, 1.02 MICROMETERS MINIMUM TIN PLATE IN SELECT AREA, OVER NICKEL UNDERPLATE.

SYMBOLS										THIS DRAWING CONTAINS INFORMATION THAT IS PROPRIETARY TO MOLEX ELECTRONIC TECHNOLOGIES, LLC AND SHOULD NOT BE USED WITHOUT WRITTEN PERMISSION									
DIMENSION UNITS					SCALE					CURRENT REV DESC: REDRAWN IN NX									
mm					5:1														
GENERAL TOLERANCES (UNLESS SPECIFIED)																			
ANGULAR TOL ± 0.5°																			
4 PLACES ±										EC NO: 610884									
3 PLACES ±										DRWN: TTAO03					2018/12/10				
2 PLACES ± 0.18										CHK'D: JKACHLIC					2019/02/01				
1 PLACE ± 0.33										APPR: JKACHLIC					2019/02/01				
0 PLACES ±										INITIAL REVISION:									
DRAFT WHERE APPLICABLE MUST REMAIN WITHIN DIMENSIONS					THIRD ANGLE PROJECTION					DRAWING					SERIES				
					C-SIZE					71741									
DOCUMENT STATUS										SALES ASSY, 1.0MM 84 CKT BTB PLUG 2.30 MM STACK HEIGHT									
P1										PRODUCT CUSTOMER DRAWING									
RELEASE DATE										DOCUMENT NUMBER									
2019/02/01 01:16:47										717412000									
										DOC TYPE					DOC PART				
										PSD					000				
										MATERIAL NUMBER					CUSTOMER				
										SEE TABLE					GENERAL MARKET				
										SHEET NUMBER					1 OF 2				

PART NUMBER	PEGS	PICK & PLACE CAP	PACKAGING SPEC. NUMBER	PACKAGING TYPE	TERMINAL PLATING SEE SHEET 1
71741-2001	YES	YES	PK-70873-063	TAPE & REEL	X21
71741-2002	NO	YES	PK-70873-063	TAPE & REEL	X21

RECOMMENDED PLUG/RECEPTACLE COMBINATION FOR MATED STACK HEIGHT PER EIA STANDARD 700 AAAB

MATED STACK HEIGHT	RECEPTACLE HEIGHT	RECEPTACLE SERIES NO.	PLUG HEIGHT	PLUG SERIES NO.
8.00	5.30	71742-0***	2.30	71741-2***
13.00	10.30	71742-3***		

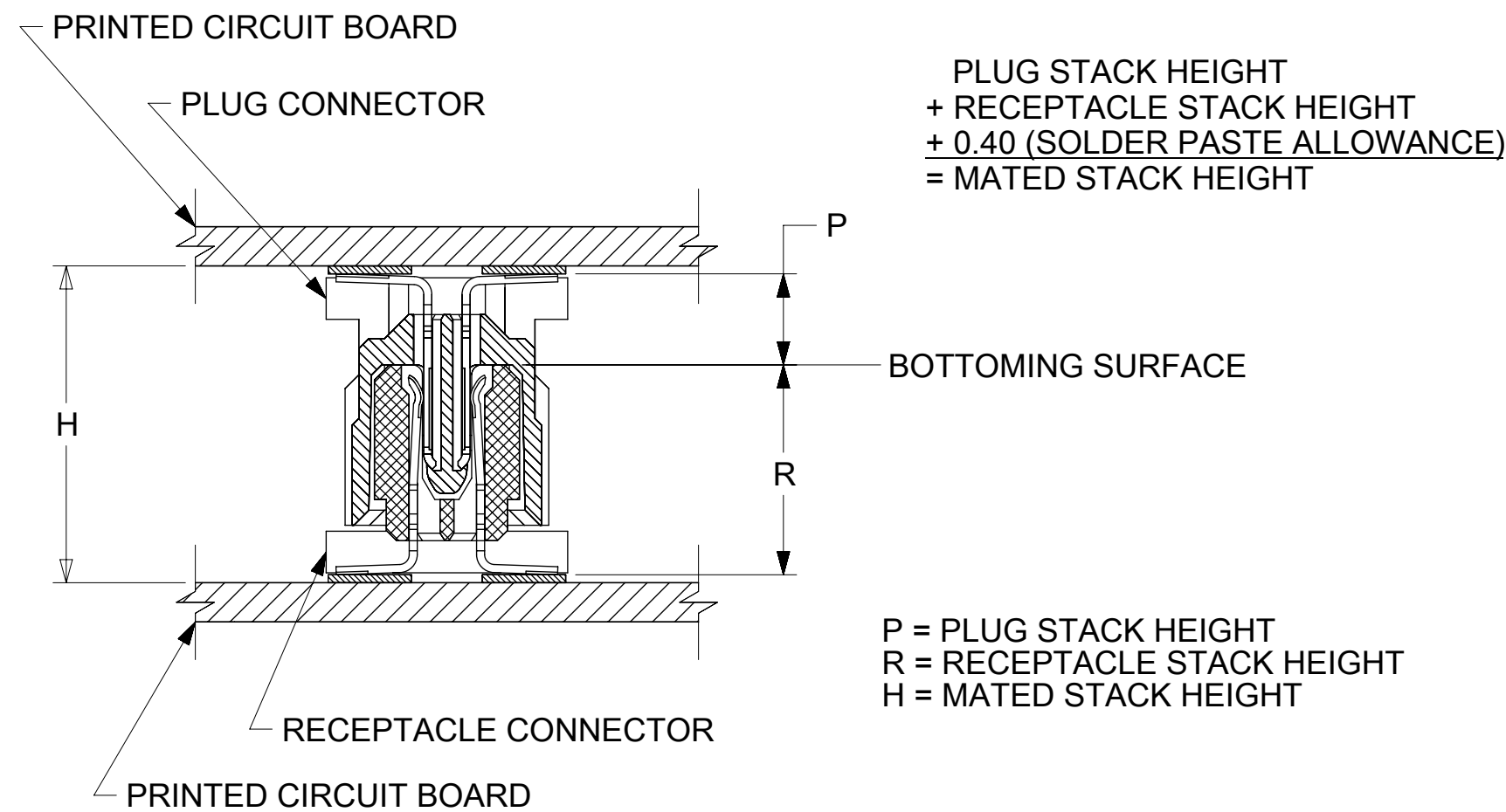

SYMBOLS	THIS DRAWING CONTAINS INFORMATION THAT IS PROPRIETARY TO MOLEX ELECTRONIC TECHNOLOGIES, LLC AND SHOULD NOT BE USED WITHOUT WRITTEN PERMISSION									
	DIMENSION UNITS	SCALE	CURRENT REV DESC: REDRAWN IN NX							
$\nabla = 0$	mm	EC NO: 610884			SALES ASSY, 1.0MM 84 CKT BTB PLUG 2.30 MM STACK HEIGHT					
$\nabla / = 0$	GENERAL TOLERANCES (UNLESS SPECIFIED)		DRWN: TTAO03 2018/12/10			PRODUCT CUSTOMER DRAWING				
$\nabla \setminus = 0$	ANGULAR TOL $\pm 0.5^\circ$		CHK'D: JKACHLIC 2019/02/01			DOCUMENT NUMBER				
$\nabla \setminus / = 0$	4 PLACES $\pm$		APPR: JKACHLIC 2019/02/01			717412000				
$\nabla \setminus \setminus = 0$	3 PLACES $\pm$		INITIAL REVISION:			DOC TYPE				
$\nabla \setminus \setminus / = 0$	2 PLACES $\pm 0.18$		DRWN: JRR 95/08/14			PSD				
$\nabla \setminus \setminus \setminus = 0$	1 PLACE $\pm 0.33$		APPR: CAB 95/08/14			000				
$\nabla \setminus \setminus \setminus / = 0$	0 PLACES $\pm$		THIRD ANGLE PROJECTION			A1				
$\nabla \setminus \setminus \setminus \setminus = 0$	DRAFT WHERE APPLICABLE MUST REMAIN WITHIN DIMENSIONS		DRAWING			SHEET NUMBER				
$\nabla \setminus \setminus \setminus \setminus / = 0$			C-SIZE			2 OF 2				
			SERIES			MATERIAL NUMBER				
			71741			SEE TABLE				
						CUSTOMER				
						GENERAL MARKET				

