

**MATERIALS AND FINISHES**

BODY: 303 SST  
 PLATED: PASSIVATED

CENTER CONTACT: BERYLLIUM COPPER  
 PLATED: GOLD

INSULATOR: TEFLON

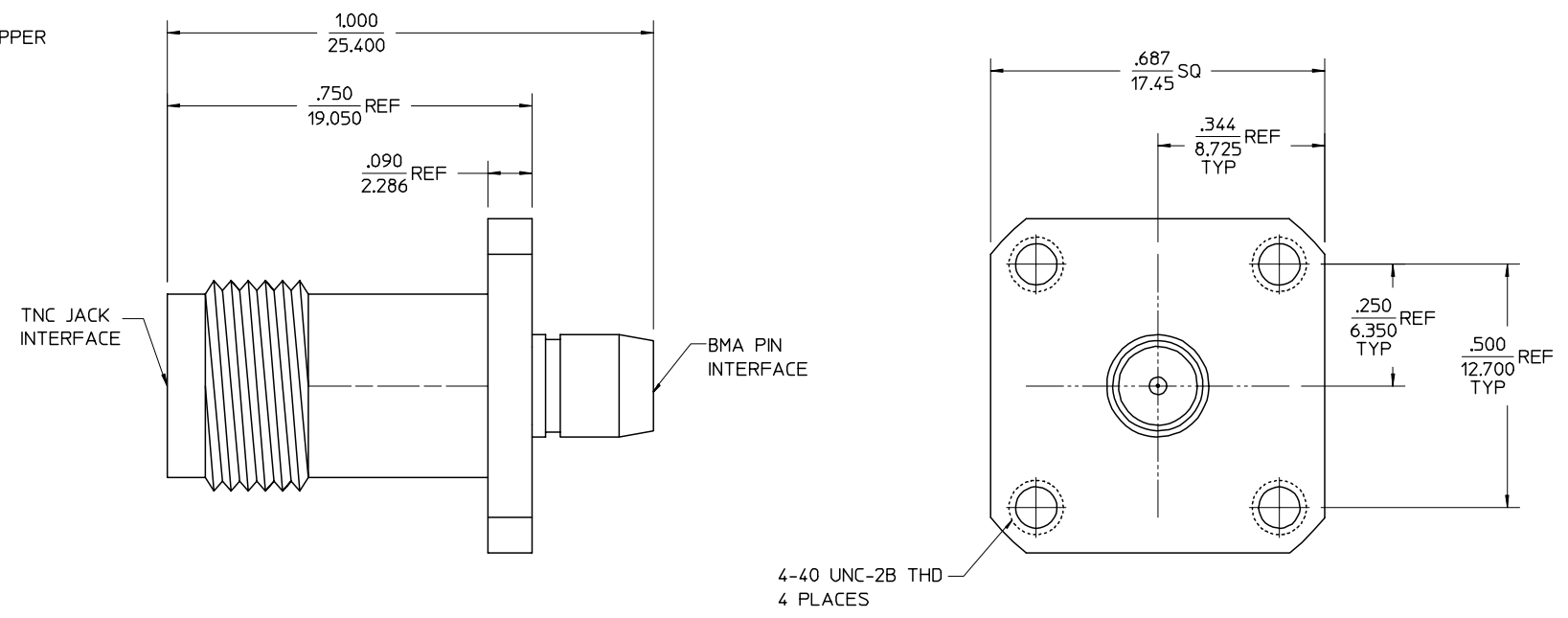

PART # 73386-0500

MIL-STD-348A, FIG 321-1	INTERFACE SPECIFICATION (BMA)
ES-89675-1780	INTERFACE SPECIFICATION (TNC)
SPECIFICATION	DESCRIPTION

CHG: NEW RELEASE P/N ES-89675-1780 WAS MIL-STD-348A, FIG 3132	EC NO. URF-1603 DRWN: SSS 11/19/02 CHK: TEF 11/19/02 APPR: GMH 11/19/02	CHG: 'MALE' IN TITLE WAS 'PIN'	APPR: SSS 11/18/02 CHG: XXXXX	EC NO. URF-XXXX DRWN: XXX 00/00/00 CHK: XXX 00/00/00 APPR: XXX 00/00/00	DESCRIPTION
A	2	1	REV		

UNLESS OTHERWISE SPECIFIED DIMS ARE INCHES AND ANGLES ARE DEGREES.

1.  $\sqrt{63}$  ALL OVER.
2. NO CHATTER OR NON-UNIFORM SURFACE FINISH ALLOWED.
3. PARTS TO BE FREE OF BURRS & SHARP EDGES .005 MAX BREAK.
4. EXTERNAL THREADS TO BE ROLLED OR SINGLE POINT.
5. DIAMETERS TO BE CONCENTRIC WITHIN .003 TIR.

QUALITY SYMBOLS

MAJOR

CRITICAL

GENERAL TOLERANCES: (UNLESS SPECIFIED)	
mm	INCH
4 PLACES * ———	±.0005
3 PLACES * ———	±.005
2 PLACES * ———	±.01
1 PLACE * ———	±.1
ANGULAR: ±2°	
DRAFT WHERE APPLICABLE MUST REMAIN WITHIN DIMENSIONS	

SCALE	DESIGN UNITS
SSS 10/21/02	<input type="checkbox"/> mm <input checked="" type="checkbox"/> INCH
DRAWN BY & DATE	
TEF 10/21/02	
CHECKED BY & DATE	
GMH 10/21/02	
APPROVED BY & DATE	
GMH 10/21/02	
CAD FILENAME	

THIRD ANGLE PROJECTION	DIMENSIONS:	1	A
<input type="checkbox"/> mm <input checked="" type="checkbox"/> INCH	<input type="checkbox"/> mm ONLY	SHT	REV
TITLE:			
BSA, TNC JACK, 4 HOLE FLANG/BMA, MALE			
50 OHM - BSA-TNC/BMA			
MOLEX MOLEX INCORPORATED			
MATERIAL NO.	DRAWING NO.	SHEET NO.	
SEE NOTE	SD-73386-050	1 of 1	
THIS DRAWING CONTAINS INFORMATION THAT IS PROPRIETARY TO MOLEX INCORPORATED AND SHOULD NOT BE USED WITHOUT WRITTEN PERMISSION.			SIZE
			B