

MATERIALS AND FINISHES

BODY: ZINC  
PLATED: NICKEL

CENTER CONTACT: PHOSPOR BRONZE  
PLATED: GOLD

OUTER CONTACT: BeCu  
PLATED: NICKEL

CRIMP TUBE: BRASS  
PLATED: NICKEL

OUTER CASING: NYLON  
KEYING: SEE TABLE  
COLOR: SEE TABLE

INSULATOR: TEFLON

CABLE: RG174, 188, & 316

RETENTION SPECIFICATION:

THE SHROUD WILL WITHSTAND A  
LONGITUDINAL FORCE OF 24.73 POUNDS (110N)

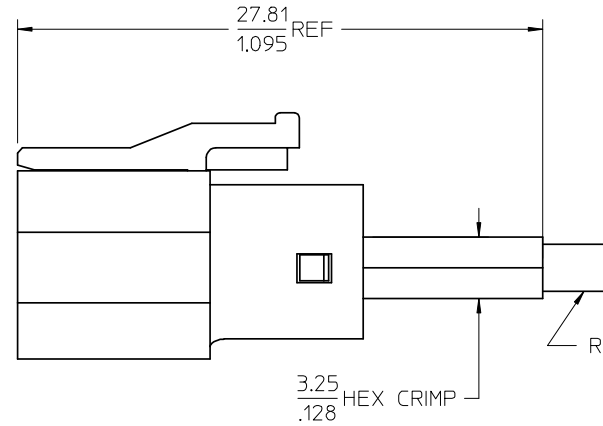
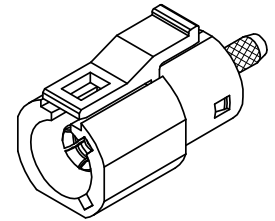

RG174, 187, 188, AND 316

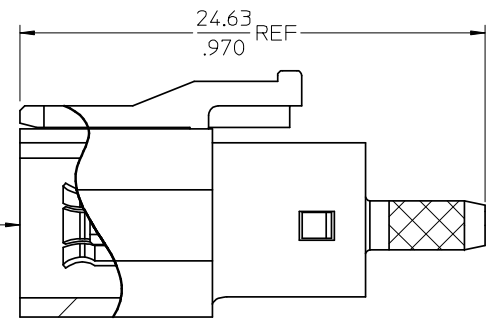

FAKRA  
CONNECTOR  
KEYING  
CODE D SHOWN

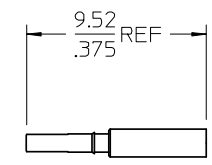

CONTACT

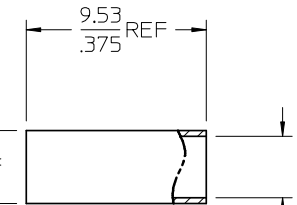

CRIMP BODY

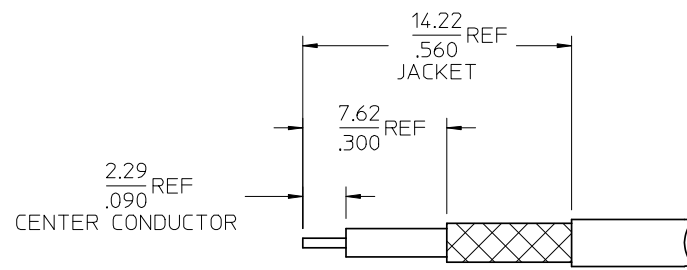

SUGGESTED STRIP DIMENSIONS

PART #SEE SHEET 2

PS-89675-331	PRODUCT SPECIFICATION
DIN 72594-1	INTERFACE SPECIFICATION
SPECIFICATION	DESCRIPTION

CHG: ADD STRIP DIMENSIONS  
ADD PS-89675-331  
DEL AS-89678-680  
DIN 72594-1 WAS  
MIL-STD-348A FIG 311-2  
EC NO: URF2009-0031  
DRWN:WIENER 2008/07/18  
CHKD:SSFAH 2008/07/18  
APPR:WIENER 2008/07/18

REV	DESCRIPTION
B2	

QUALITY SYMBOLS	GENERAL TOLERANCES (UNLESS SPECIFIED)
▽=0	mm INCH
▽=0	4 PLACES ± --- + ---
	3 PLACES ± --- ± ---
	2 PLACES ± --- ± ---
	1 PLACE ± --- ± ---
	ANGULAR ± 2 °
	DRAFT WHERE APPLICABLE MUST REMAIN WITHIN DIMENSIONS

DIMENSION STYLE MM/IN	
DRAWN BY SSS	DATE 2001/03/07
CHECKED BY TEF	DATE 2001/03/07
APPROVED BY GMH	DATE 2001/03/07
MATERIAL NO. SEE SHT 2	DOCUMENT NO. SD-73415-291
SIZE C	THIS DRAWING CONTAINS INFORMATION THAT IS PROPRIETARY TO MOLEX INCORPORATED AND SHOULD NOT BE USED WITHOUT WRITTEN PERMISSION

SCALE	DESIGN UNITS METRIC	THIRD ANGLE PROJECTION
TITLE SMB PLUG, FAKRA RG174,188,316 CABLE SMB-JC		
MOLEX MOLEX INCORPORATED		SHEET NO. 1 OF 2

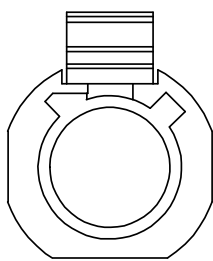

CODE - A

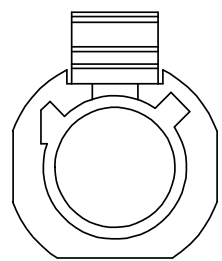

CODE - B

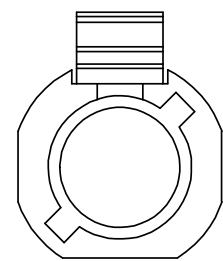

CODE - C

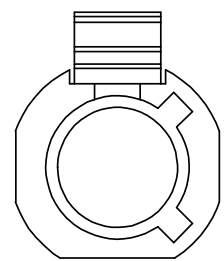

CODE - D

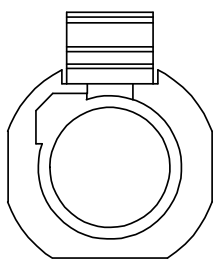

CODE - E

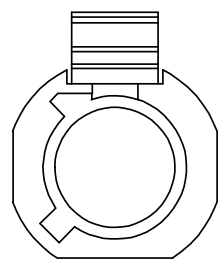

CODE - F

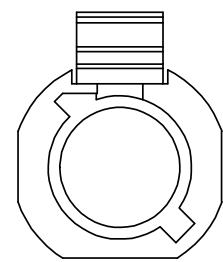

CODE - G

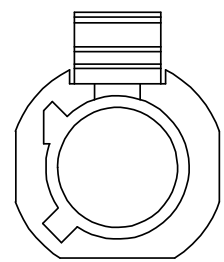

CODE - H

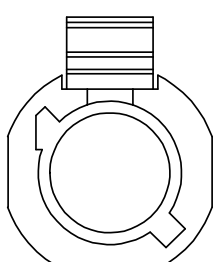

CODE - I

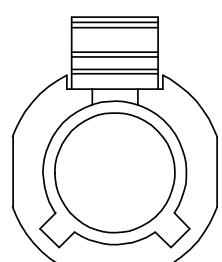

CODE - K

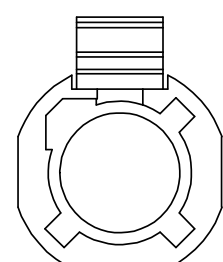

CODE - Z

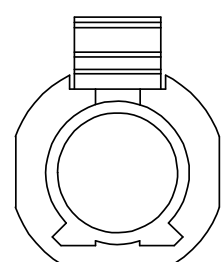

CODE - L

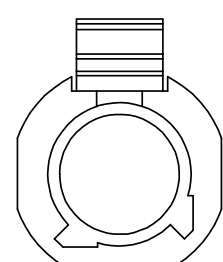

CODE - M

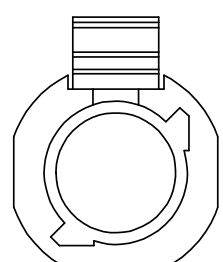

CODE - N

N	PASTEL GREEN	73415-2923
M	PASTEL ORANGE	73415-2922
L	CARMINE RED	73415-2921
Z	WATER BLUE	73415-2920
K	CURRY YELLOW	73415-2919
I	BEIGE	73415-2918
H	VIOLET	73415-2917
G	GRAY	73415-2916
F	BROWN	73415-2915
E	GREEN	73415-2914
D	BORDEAUXVIOLET	73415-2913
C	BLUE	73415-2912
B	CREAM WHITE	73415-2911
A	BLACK	73415-2910
KEYING CODE	COLOR	PART NO.

SEE SHEET 1 EC NO: URF2009-0031 DRWN: WIENER CHKD: SHAH APPR: WIENER	2008/07/18 2008/07/18 2008/07/18 2008/07/18	DESCRIPTION REV:	QUALITY SYMBOLS ▽=0 ▽=0	GENERAL TOLERANCES (UNLESS SPECIFIED) <table border="1"> <tr> <th></th> <th>mm</th> <th>INCH</th> </tr> <tr> <td>4 PLACES</td> <td>± .15</td> <td>± .005</td> </tr> <tr> <td>3 PLACES</td> <td>± .10</td> <td>± .004</td> </tr> <tr> <td>2 PLACES</td> <td>± .08</td> <td>± .003</td> </tr> <tr> <td>1 PLACE</td> <td>± .05</td> <td>± .002</td> </tr> </table> ANGULAR ± 2°		mm	INCH	4 PLACES	± .15	± .005	3 PLACES	± .10	± .004	2 PLACES	± .08	± .003	1 PLACE	± .05	± .002	DIMENSION STYLE MM/IN DRAWN BY: SSS DATE: 2001/03/07 CHECKED BY: TEF DATE: 2001/03/07 APPROVED BY: GMH DATE: 2001/03/07	SCALE DESIGN UNITS METRIC THIRD ANGLE PROJECTION	TITLE SMB PLUG, FAKRA RG174,188,316 CABLE SMB-JC	MATERIAL NO. SEE TABLE	DOCUMENT NO. SD-73415-291	SHEET NO. 2 OF 2
				mm	INCH																				
			4 PLACES	± .15	± .005																				
			3 PLACES	± .10	± .004																				
2 PLACES	± .08	± .003																							
1 PLACE	± .05	± .002																							
DRAFT WHERE APPLICABLE MUST REMAIN WITHIN DIMENSIONS				THIS DRAWING CONTAINS INFORMATION THAT IS PROPRIETARY TO MOLEX INCORPORATED AND SHOULD NOT BE USED WITHOUT WRITTEN PERMISSION		MOLEX MOLEX INCORPORATED																			
B2																									