

ASSEMBLY NUMBER	FINISH
73656-0000	SEE NOTE 2.
73656-0001	SEE NOTE 3.

**NOTES:**

1. MATERIALS: HOUSING - LIQUID CRYSTAL POLYMER (LCP), GLASS-FILLED, UL94V-0, COLOR: BLACK  
TERMINAL - BERYLLIUM COPPER
2. FINISH: SELECTIVE GOLD (Au) IN CONTACT AREA, 0.00076mm MINIMUM THICKNESS; NICKEL (Ni) AND GOLD FLASH OVERALL
3. FINISH: SELECTIVE GOLD (Au) IN CONTACT AREA, 0.00076mm MINIMUM THICKNESS; TIN / LEAD OVER NICKEL IN COMPLIANT AREA; NICKEL (Ni) OVERALL ON REMAINING WITH SEL. GOLD FLASH.
4. FOR MIXED CONTACT MATING LENGTHS, CONSULT FACTORY FOR AVAILABILITY.
5. THIS DIMENSION MUST BE A MULTIPLE OF 4.00mm.
6. DIMENSIONS ARE IN MILLIMETERS.
7. THIS PART CONFORMS TO MOLEX PRODUCT SPECIFICATION PS-73670-9999.

DATE CODE AND PART NUMBER ON THIS SURFACE OR SURFACE OPPOSITE.

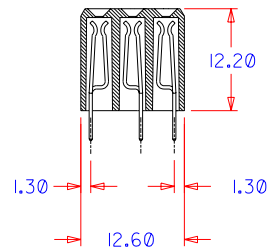
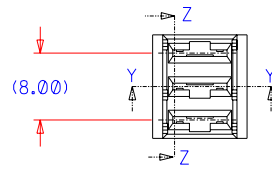
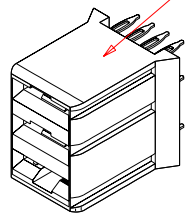

SECTION: Z-Z  
ROTATED 90° CW

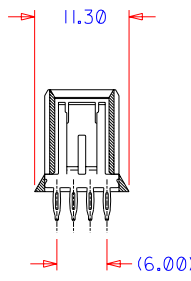

SECTION: Y-Y

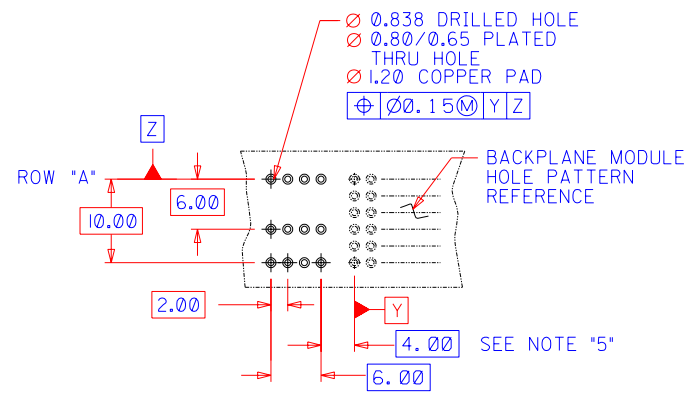

BACKPLANE MODULE HOLE PATTERN REFERENCE

SEE NOTE "5"

PCB LAYOUT: COMPONENT SIDE  
RECOMMENDED PCB THICKNESS: 2.50 MIN

3	B
2	B
1	B
SH	REV.

DIMENSIONS SHOWN (METRIC) INCH		UNLESS OTHERWISE SPECIFIED TOLERANCES: ANGULAR ± 1/2°		TITLE		REVISE ONLY ON CAD SYSTEM	
				SALES ASSY, HDM BACKPLANE POWER MODULE (PRESS FIT)			
3 PLACE ± N/A		---		MOLEX INCORPORATED		SHEET NO. DATE	
2 PLACE ± N/A		± 0.25		LISLE, ILL. 60532 U.S.A.		1 OF 3 98/05/21	
1 PLACE --- ± 0.25		DRAFT WHERE APPLICABLE MUST REMAIN WITHIN DIMENSIONS		PART NO.		DRWG. NO.	
DRWG. BY ELO		CHK'D. BY SMR		73656X1		SDA-73656-*00*	
APP'D. BY CAB		SCALE 2 : 1		FILE NAME		THIS DRAWING CONTAINS INFORMATION THAT IS PROPRIETARY TO MOLEX INC. AND SHOULD NOT BE USED WITHOUT WRITTEN PERMISSION.	
L.T.R.		REVISIONS		DA		SIZE B	

DATE CODE AND PART NUMBER ON THIS SURFACE OR SURFACE OPPOSITE.

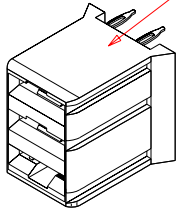

USE BACKPLANE MODULE HOLE REFERENCE PATTERN FROM SHEET 1

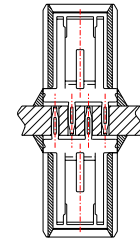
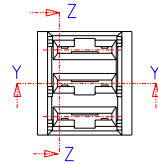

3.50  
MIN

BACK-TO-BACK MOUNTING APPLICATION

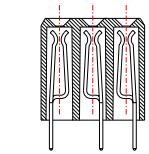

SECTION: Z-Z  
ROTATED 90° CW

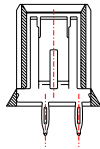
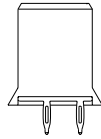

4.00

SECTION: Y-Y

### MIDPLANE OPTION

ASSEMBLY NUMBER	FINISH (SEE SHT 1)
73656-1000	SEE NOTE 2.
73656-1001	SEE NOTE 3.

DIMENSIONS SHOWN (METRIC) INCH

UNLESS OTHERWISE SPECIFIED TOLERANCES: ANGULAR ± 1/2°

	INCH	METRIC
3 PLACE	± N/A	---
2 PLACE	± N/A	± ---
1 PLACE	---	± ---

DRAFT WHERE APPLICABLE MUST REMAIN WITHIN DIMENSIONS

DRWG. BY: ELO  
CHK'D. BY: SMR  
APP'D. BY: CAB  
SCALE: 2 : 1

REVISE ONLY ON CAD SYSTEM

TITLE: SALES ASSY, HDM BACKPLANE POWER MODULE (PRESS FIT)

MOLEX INCORPORATED  
LISLE, ILL. 60532 U.S.A.

PART NO. SEE CHART  
DRWG. NO. SDA-73656-\*00\*

THIS DRAWING CONTAINS INFORMATION THAT IS PROPRIETARY TO MOLEX INC. AND SHOULD NOT BE USED WITHOUT WRITTEN PERMISSION.

		B	SEE SHEET 1
		A	SEE SHEET 1
LTR.	REVISIONS	LTR.	REVISIONS

ASSEMBLY NUMBER	FINISH (SHT 1)
73656-5000	SEE NOTE 2.

DATE CODE AND PART NUMBER ON THIS SURFACE OR SURFACE OPPOSITE.

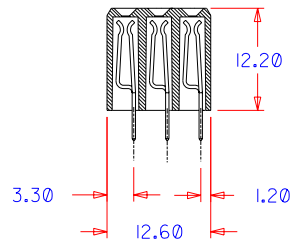
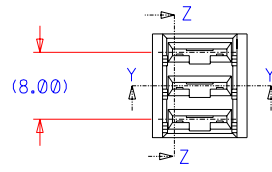
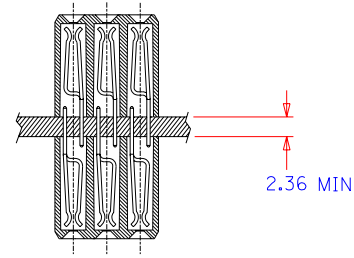
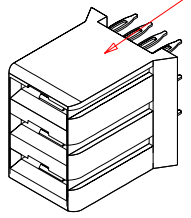

SECTION: Z-Z  
ROTATED 90° CW

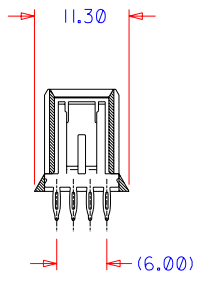

SECTION: Y-Y

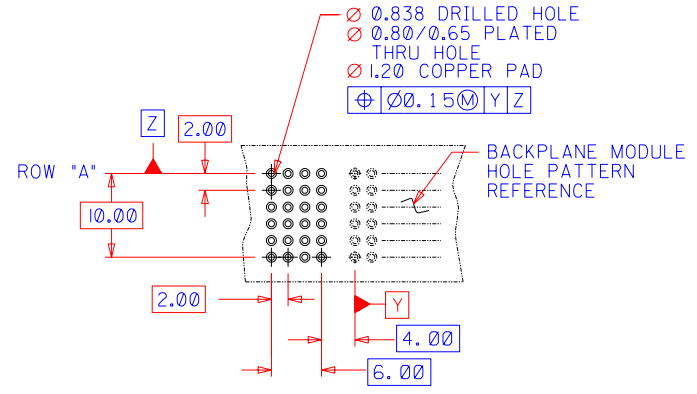

		B	SEE SHEET 1
		AI	SEE SHEET 1
		A	SEE SHEET 1
LTR.	REVISIONS	LTR.	REVISIONS

DIMENSIONS SHOWN (METRIC) INCH  
UNLESS OTHERWISE SPECIFIED  
TOLERANCES: ANGULAR ± 1/2°

	INCH	METRIC
3 PLACE	± N/A	---
2 PLACE	± N/A	± 0.15
1 PLACE	---	± 0.25

DRAFT WHERE APPLICABLE MUST REMAIN WITHIN DIMENSIONS

DRWG. BY: ELO    CHK'D. BY: SMR  
APP'D BY: BIXLER    SCALE: 2 : 1

REVISIONS ONLY ON CAD SYSTEM

TITLE: SALES ASSY, HDM BACKPLANE POWER MODULE (PRESS FIT)

MOLEX INCORPORATED  
LISLE, ILL. 60532 U.S.A.

PART NO. 73656-5000    SHEET NO. 3    DATE 98/05/21

DRWG. NO. SDA-73656-\*00\*

THIS DRAWING CONTAINS INFORMATION THAT IS PROPRIETARY TO MOLEX INC. AND SHOULD NOT BE USED WITHOUT WRITTEN PERMISSION.

FILE NAME: S73656X3.GBN    DIV. DA    SIZE B

MATERIAL NUMBER	DIM "P" ± 0.25
73659-0001	2.00
73659-0002	2.50
73659-0003	3.00
73659-0004	3.50

DATE CODE AND PART NUMBER ON THIS SURFACE OR SURFACE OPPOSITE.

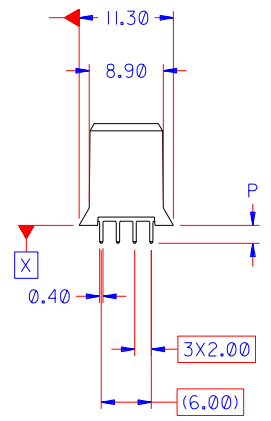
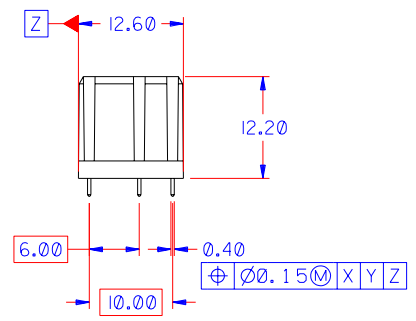
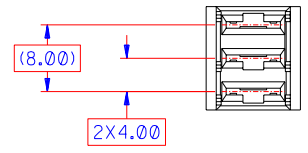
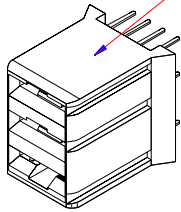

NOTES:

1. MATERIALS: HOUSING - LIQUID CRYSTAL POLYMER (LCP), GLASS-FILLED, UL94V-0, COLOR: BLACK  
TERMINAL - BERYLLIUM COPPER
2. FINISH: SELECTIVE GOLD (Au) IN CONTACT AREA, 0.00076mm MINIMUM THICKNESS; NICKEL (Ni) AND GOLD FLASH WITH TIN/LEAD TAILS.
3. THIS PART CONFORMS TO MOLEX PRODUCT SPECIFICATION PS-73670-9999.
4. THIS DIMENSION MUST BE A MULTIPLE OF 4.00mm.
5. DIMENSION ARE IN MILLIMETERS.

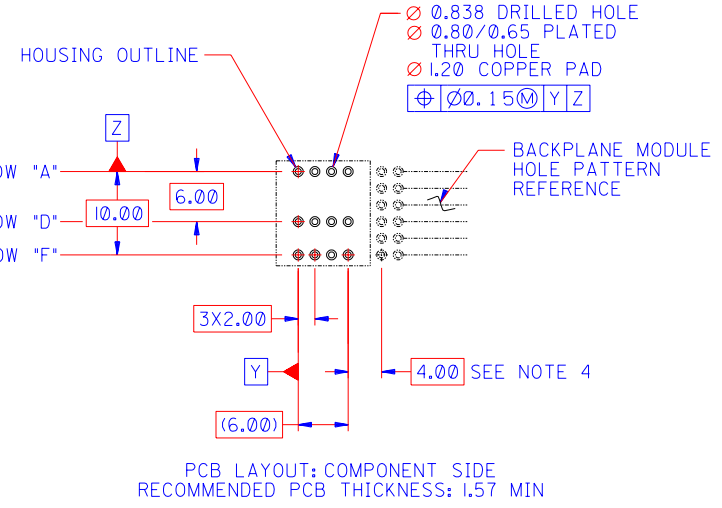

PCB LAYOUT: COMPONENT SIDE  
RECOMMENDED PCB THICKNESS: 1.57 MIN

DIMENSIONS SHOWN (METRIC) INCH

UNLESS OTHERWISE SPECIFIED TOLERANCES: ANGULAR ± 1/2°

	INCH	METRIC
3 PLACE	± N/A	---
2 PLACE	± N/A	± 0.10
1 PLACE	---	± 0.25

DRAFT WHERE APPLICABLE MUST REMAIN WITHIN DIMENSIONS

DRWG. BY REED BIXLER  
CHK'D BY BINGHAM  
SCALE 2 : 1

REVISIONS: 0 = 0 REVISE ONLY ON CAD SYSTEM

TITLE: SALES ASSY, HDM BACKPLANE POWER MODULE W/SOLDER TAILS

MOLEX INCORPORATED Lisle, Ill. 60532 U.S.A. SHEET NO. 1 OF 1 DATE 96/12/10

PART NO. SEE CHART DRWG. NO. SDA-73659-000\*

FILE NAME: 5736591.Dgn DIV. DA

LTR.	REVISIONS	LTR.	REVISIONS
B	ADD DATE CODE PER UDT2000-0399 ELO 99/10/26		
A	RPLC SDA-73659-00** PER EC # U81587 ELO 98/01/28		