

PLEASE CHECK WWW.MOLEX.COM FOR LATEST PART INFORMATION

Part Number: [74547-0106](#)
Status: **Active**
Overview: iPass™
Description: External iPass Mini Multi-Lane SAS X4 Cable Assembly, 26 Circuits, 24 AWG, 6.0m Length, Key 2, 4

Documents:

[Drawing \(PDF\)](#) [RoHS Certificate of Compliance \(PDF\)](#)
[Test Summary TS-74547-001 \(PDF\)](#)

Agency Certification

CSA LR64395
 UL E72548

General

Product Family Cable Assemblies
 Series [74547](#)
 Comments Table Routing (Out Port), SAS
 Connector to Connector Mini SAS-to-Mini SAS
 Overview iPass™
 Product Name iPass™, Mini Multi-Lane, SAS, X4
 UPC 822350246286

Physical

Cable Length 6.0m
 Circuits (Loaded) 26
 Gender Male-Male
 Lock to Mating Part Yes
 Material - Metal Stainless Steel
 Net Weight 977.000/g
 Packaging Type Bag
 Pitch - Mating Interface 0.80mm
 Single Ended No
 Wire Insulation Diameter N/A
 Wire Size AWG 28
 Wire/Cable Type Parallel Pair

Electrical

Current - Maximum per Contact 1A
 Shielded Yes
 Voltage - Maximum 30V

Material Info

Reference - Drawing Numbers

Sales Drawing SD-74547-100
 Test Summary TS-74547-001

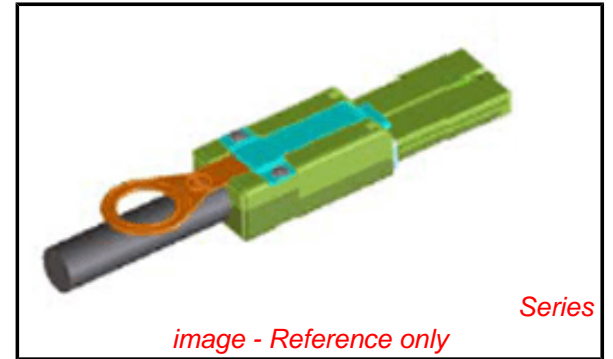

EU RoHS

**ELV and RoHS
Compliant**

REACH SVHC

Not Reviewed

Low-Halogen Status

Not Low-Halogen

China RoHS



**Need more information on product
environmental compliance?**

Email productcompliance@molex.com
 For a multiple part number RoHS Certificate of
 Compliance, [click here](#)

Please visit the [Contact Us](#) section for any
 non-product compliance questions.

Search Parts in this Series

[74547Series](#)

Mates With

[75586](#) iPass™ Receptacle. [74548](#) EMI
 Housing Assembly

Use With

[74735](#) X2 Transceiver. [74739](#) XPAK
 Transceiver. [74548](#) External iPass Mini
 Multi-Lane SAS Guide Frame