

PART NUMBER	DESCRIPTION	LIGHT PIPE OPTIONS	PLATING
76870-2003	NO LIGHT PIPES	A= NONE	TIN
76870-2005	WITH LIGHT PIPES	C= UP/DOWN	TIN

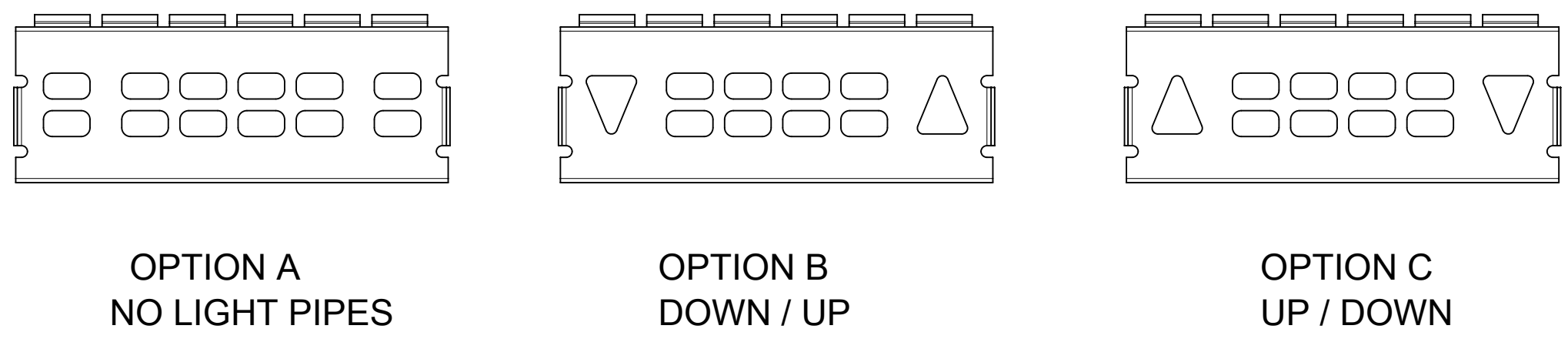

NOTES:

1. MATERIAL:

CAGE: NICKEL SILVER, 0.25mm THICK  
 EMI STRAPS: PHOS-BRONZE  
 AIR-VENT/LIGHT PIPE HOUSINGS: DIECAST ALLOY  
 LIGHT PIPES: POLYCARBONATE (OPTIONAL)  
 CONNECTOR HOUSING: HIGH TEMPERATURE THERMOPLASTIC  
 TERMINALS: COPPER ALLOY

2. FINISH:

CAGE: UNPLATED  
 EMI STRAPS: 2.5µm NICKEL OVERALL  
 AIR-VENT/LIGHT PIPE HOUSINGS: NICKEL OVER COPPER  
 TERMINALS: CONTACT AREA:  
 0.76-1.52 µm MIN. GOLD OVER 2.5 µm MIN. NICKEL.  
 COMPLIANT TAIL:  
 TIN/LEAD: 0.7-1.5 µm TIN/LEAD (90/10) OVER 1.3 µm NICKEL.  
 TIN: 0.7-1.5µm MIN. MATTE TIN OVER 1.3µm NICKEL.

3. PACKAGING: PRODUCT PACKAGED IN TRAYS AND CARTONS

4. ALL VISIBLE EXTERIOR SURFACES TO BE CLASS "B" OR BETTER, EXCEPT FOR THE UNDERSIDE OF THE CAGE AND SHOULD CONFORM TO THE MOLEX COSMETIC STANDARD PS-45499-002

5. CONNECTOR MATES WITH PLUG CABLE SERIES 74757 AND 74758

6. DATE CODE LOCATION IS SHOWN.  
 DATE CODE FORMAT: DDDY  
 DDD= DAY OF THE YEAR  
 Y= YEAR

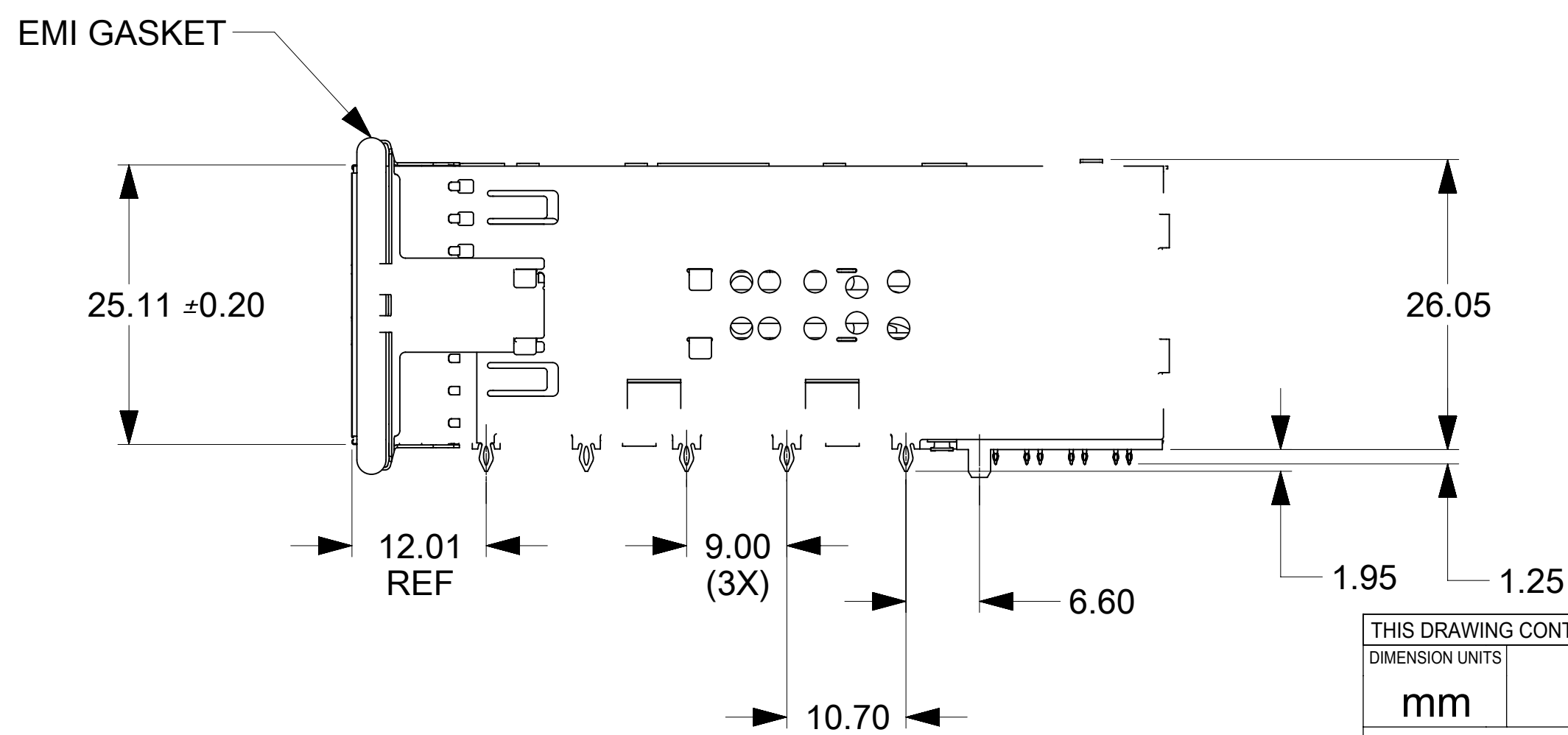
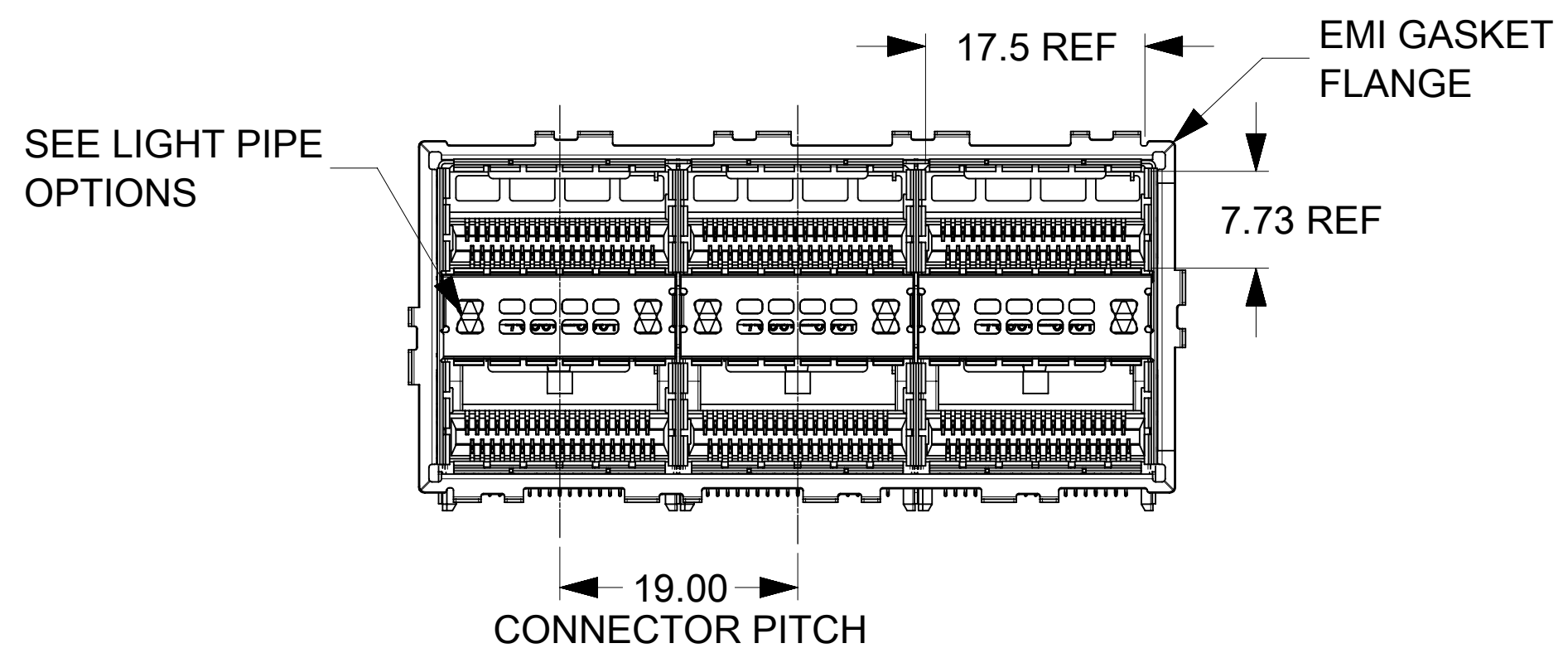
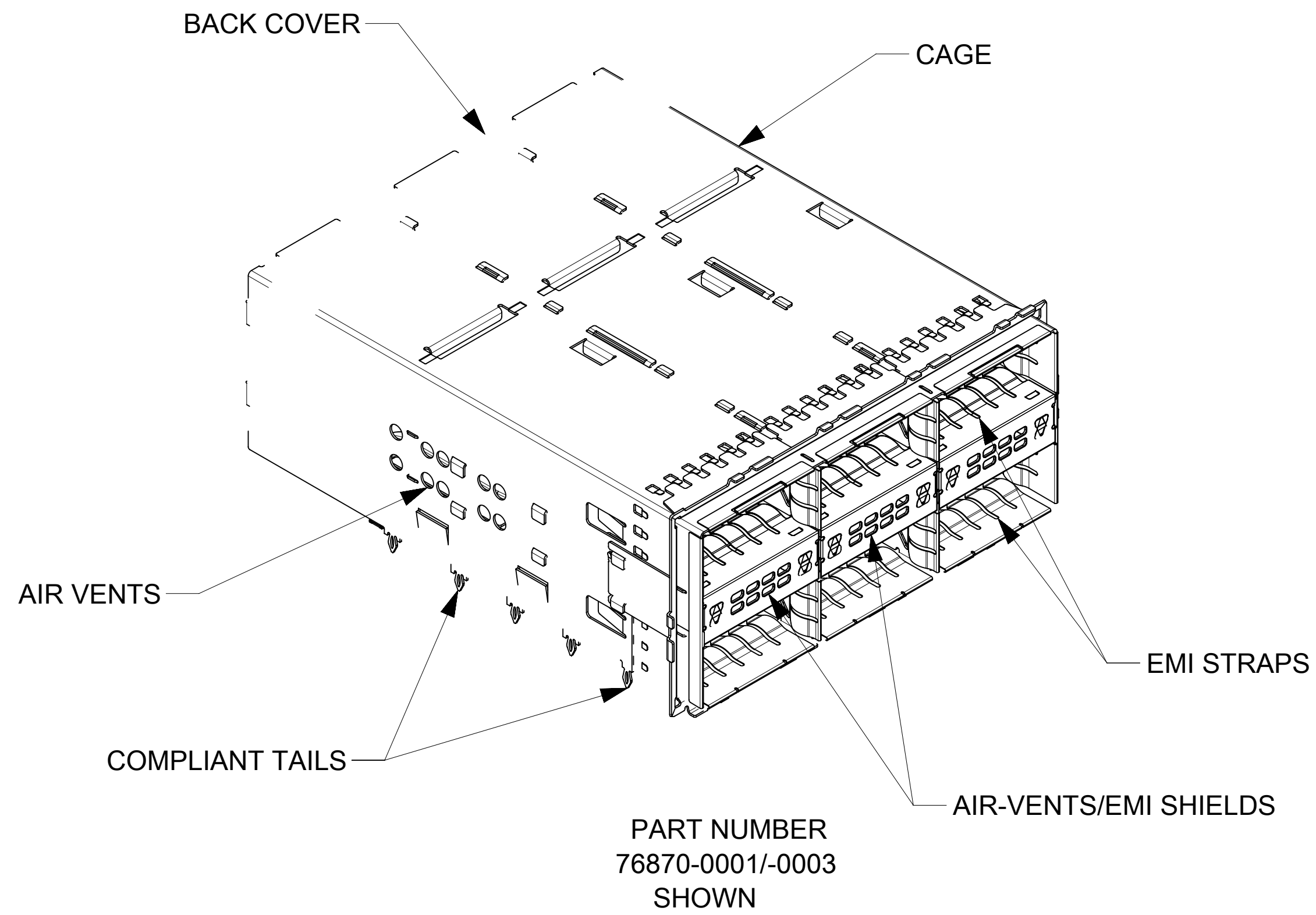
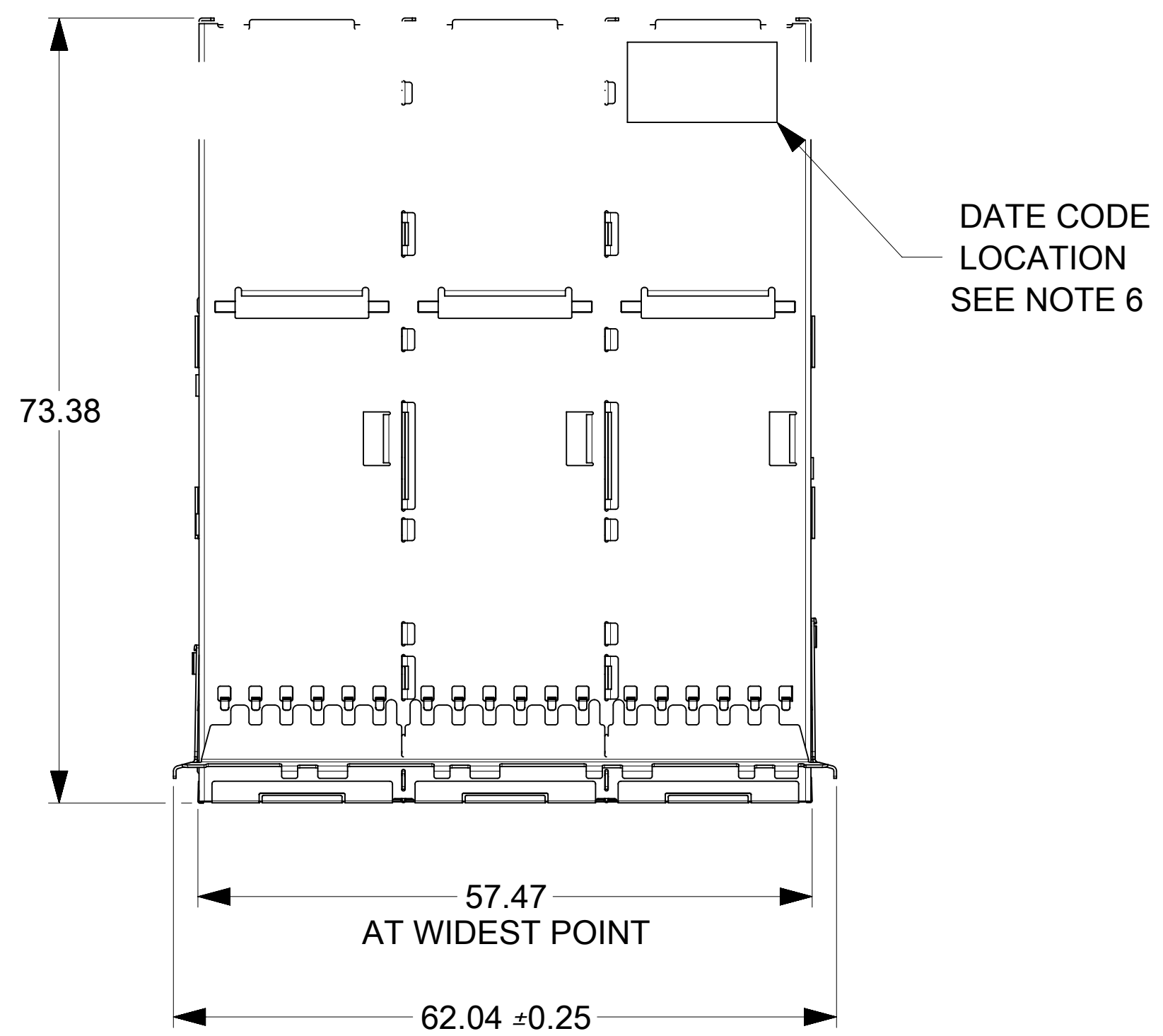

THIS DRAWING CONTAINS INFORMATION THAT IS PROPRIETARY TO MOLEX ELECTRONIC TECHNOLOGIES, LLC AND SHOULD NOT BE USED WITHOUT WRITTEN PERMISSION

DIMENSION UNITS	SCALE	CURRENT REV DESC: OBSOLETE PART NO	
mm	2:1		
GENERAL TOLERANCES (UNLESS SPECIFIED)			
	MM	INCH	
4 PLACES	±	±	EC NO: 625872
3 PLACES	±	±	DRWN: VLOKESHA 2019/08/30
2 PLACES	±	0.13	CHK'D: GB 2019/11/06
1 PLACE	±	0.25	APPR: GGA 2019/11/12
0 PLACES	±		INITIAL REVISION:
ANGULAR TOL	±	0.5°	DRWN: HAVERY 2012/06/08
DRAFT WHERE APPLICABLE MUST REMAIN WITHIN DIMENSIONS		THIRD ANGLE PROJECTION	APPR: MBANAKIS 2012/07/31
		DRAWING	SERIES
		D-SIZE	76870
DOCUMENT NUMBER		MATERIAL NUMBER	CUSTOMER
SD-76870-2000		SEE CHART	GENERAL MARKET
DOC TYPE	DOC PART	REVISION	SHEET NUMBER
PSD	001	A	1 OF 1