

"SIMM" P.C. BOARD LAYOUT

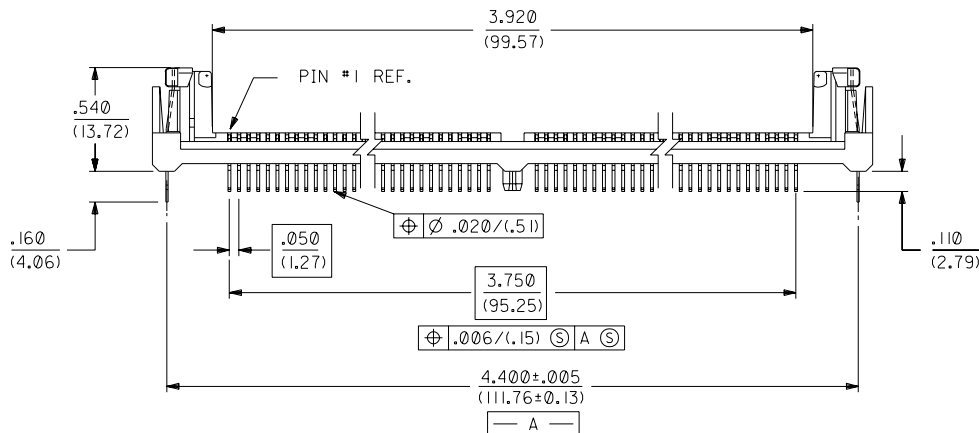
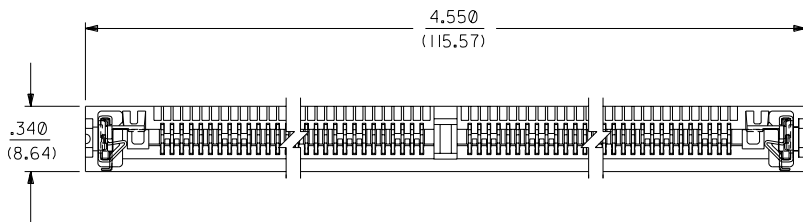

\*THE PRIMARY SHIPPING CARTON WILL BE LABELED "COMPLIANT TO RoHS DIRECTIVE 2002/95/EC AND ELV ANNEX II OF DIRECTIVE 2000/53/EC" CARTONS WITHOUT THIS LABEL MAY CONTAIN PRODUCT WITH LEAD.

- NOTES:
1. CARD SLOT ACCEPTS  $.050 + .004 / -.003$  P.C. BOARDS (MEASURED OVER P.C. PADS).
  2. PRODUCT SPEC PS-78954 APPLIES
  3. CENTER PEG IS AN INTERFERENCE FIT TO PCB UNLESS NOTED ON THE DWG. (APPLICABLE ONLY IF PART HAS A CENTER PEG FEATURE)

MATERIALS:

- HOUSING- LCP, GLASS FILLED, 94V-0, COLOR: BLACK
- TERMINAL- PHOSPHOR BRONZE
- PLATING- POST PLATED  $200 \mu\text{in}$  (5.08  $\mu\text{m}$ ) MINIMUM TIN IN CONTACT AREA AND  $150 \mu\text{in}$  (3.81  $\mu\text{m}$ ) MINIMUM TIN IN TAIL AREA OVER  $50 \mu\text{in}$  (1.27  $\mu\text{m}$ ) MINIMUM NICKEL OVERALL
- \* REFERENCE NOTE IN LOWER LEFT CORNER OF DRAWING.

METAL LATCH- STAINLESS STEEL

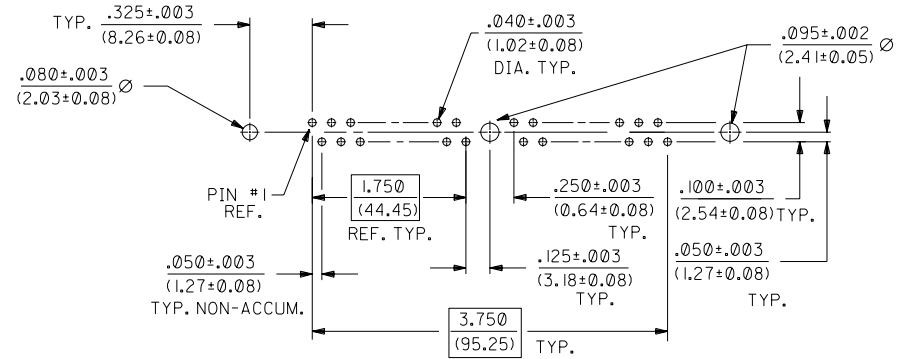

RECOMMENDED SOCKET P.C. BOARD HOLE PATTERN

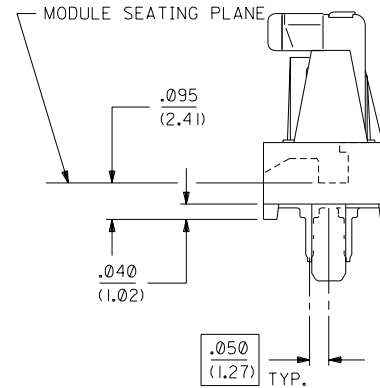

END VIEW SCALE 4:1

|   |   |
|---|---|
| G | LEAD FREE<br>UCP2004-1582<br>RWHITE 04/02/24        |
| F | REVISED<br>PER ECR U51309<br>GMY 8-18-95            |
| E | CHG. TAIL LENGTH<br>PER ECR U6-0102<br>DRS 07/28/95 |
| D | CHG. TAIL LENGTH<br>PER ECR U5-1246<br>DRS 06/13/95 |
| C | REDRAWN<br>PER ECR U20649<br>AMD 6-10-92            |
| B | REVISED/UPDATED<br>PER ECR U0-0647<br>SEC 9-21-90   |
| A | ADDED EDP<br>PER ERO 30152<br>KER 7-23-90           |
| I | X-RELEASE<br>PER ERO 30151<br>KER 7-13-90           |

|   |            |   |            |
|---|------------|---|------------|
| DIMENSIONS SHOWN (METRIC) INCH  |            | UNLESS OTHERWISE SPECIFIED TOLERANCES: ANGULAR ± 1/2° |            |
| 3 PLACE   | ± .010     | ---   | ---        |
| 2 PLACE   | ± .014     | ± 0.25  | ---        |
| 1 PLACE   | ---        | ± 0.35  | ---        |
| DRAFT WHERE APPLICABLE MUST REMAIN WITHIN DIMENSIONS  |            |   |            |
| DRWG. BY: KER   | CHK'D. BY: | FILE NAME: S70562K39                                  | SCALE: 2:1 |
| PART NO. 15-82-0775   |            | DRWG. NO. SDA-78962-7231                              |            |
| MOLEX INCORPORATED  |            | SHEET NO. 1 OF 1                                      |            |
| LITSE, ILL. 60532   |            | DATE 07/13/90   |            |
| THIS DRAWING CONTAINS INFORMATION THAT IS PROPRIETARY TO MOLEX INC. AND SHOULD NOT BE USED WITHOUT WRITTEN PERMISSION |            | DIV. DA   |            |

# Mouser Electronics

Authorized Distributor

Click to View Pricing, Inventory, Delivery & Lifecycle Information:

[Molex:](#)

[15-82-0775](#)