

170071-101*
APPEARANCE

- NOTES:
- MATERIAL:
 - CAGE: NICKEL SILVER
 - CONNECTOR HOUSING: GLASS FILLED THERMOPLASTIC, UL: 94V-0, COLOR: BLACK
 - LIGHT PIPES: POLYCARBONATE, 94 HB, COLOR: CLEAR (WEIGHT OF INDIVIDUAL LIGHT PIPE LESS THAN 1 GRAM)
 - TERMINALS: HIGH PERFORMANCE COPPER ALLOY
 - FRONT SHIELD WALL: COPPER ALLOY
 - LIGHT PIPE HOUSING: ZINC ALLOY
 - ELASTOMERIC GASKET: SILVER IMPREGNATED SILICONE
 - FINISH
 - TERMINALS: CONTACT AREA: 0.76 μm MIN. HARD GOLD OVER 3.8 μm MIN. NICKEL
3.8 μm MIN NICKEL
 - COMPLIANT TAIL: 0.7-1.5 μm MATTE TIN OVER 0.7-1.5 μm NICKEL
 - FRONT SHIELD WALL: 0.7-1.5 μm NICKEL OVERALL
 - LIGHT PIPE HOUSING: 2.0 μm NICKEL OVER 0.7 μm COPPER
 - 2X4 CONFIGURATION SHOWN FOR REFERENCE, SEE CHART FOR AVAILABLE OPTIONS
 - REFER TO PS-170071-0001 FOR ALL ELECTRICAL, MECHANICAL AND ENVIRONMENTAL SPECIFICATIONS.
 - REFER TO AS-170071-0001 FOR CONNECTOR MOUNTING AND REWORK INFORMATION.
 - REFER TO AS-170071-0002 FOR PCB ROUTING RECOMMENDATIONS.
 - ALL VISIBLE EXTERIOR SURFACES TO BE CLASS "B" (BOTTOM OF CONNECTOR IS CLASS "C")
CAGE SURFACES TO CONFORM TO THE MOLEX COSMETIC DOC PS-45499-002.
 - DATE CODE FORMAT: YYDDDX
YY: LAST TWO DIGITS OF THE YEAR
DDD: DAY OF THE YEAR
X: MOLEX INTERNAL CONTROL

NUMBER OF PORTS	PART NUMBER	DIM X	DIM Y
2X1	170071101*	14.50	15.10
2X2	170071201*	28.75	29.35
2X4	170071401*	57.25	57.85
2X6	170071601*	85.75	86.35
2X8	170071801*	114.25	114.85
2X8	170071121*	171.25	171.85

* DESIGNATES LIGHT PIPE CONFIGURATIONS, SEE SHEET 2.

170071-40** SHOWN FOR REFERENCE
APPEARANCE MAY VARY WITH SIZE

THIS DRAWING CONTAINS INFORMATION THAT IS PROPRIETARY TO MOLEX ELECTRONIC TECHNOLOGIES, LLC AND SHOULD NOT BE USED WITHOUT WRITTEN PERMISSION		CURRENT REV DESC: SEE REVISION HISTORY		molex	
DIMENSION UNITS	SCALE	EC NO: 623968			
mm	NTS	DRWN: JWALLACE01 2019/02/12		ZSFP+ STACKED ASSY W/ ELASTOMERIC GASKET	
GENERAL TOLERANCES (UNLESS SPECIFIED)		CHK'D: CWANG67 2019/09/12			
ANGULAR TOL	± 0.5°	APPR: RNELSON 2019/09/17		PRODUCT CUSTOMER DRAWING	
4 PLACES	±	INITIAL REVISION:		DOCUMENT NUMBER	
3 PLACES	±	DRWN: DTAN10 2018/03/01		1700710002	
2 PLACES	± 0.13	APPR: SHONG 2018/03/06		DOC TYPE	
1 PLACE	± 0.25	DRAFT WHERE APPLICABLE MUST REMAIN WITHIN DIMENSIONS		PSD	
0 PLACES	±	THIRD ANGLE PROJECTION		DOC PART	
DRAWING		SERIES		REVISION	
A3-SIZE		170071		000 A1	
MATERIAL NUMBER		CUSTOMER		SHEET NUMBER	
SEE TABLE		GENERAL MARKET		1 OF 5	

9 8 7 6 5 4 3 2 1

E

D

C

B

A

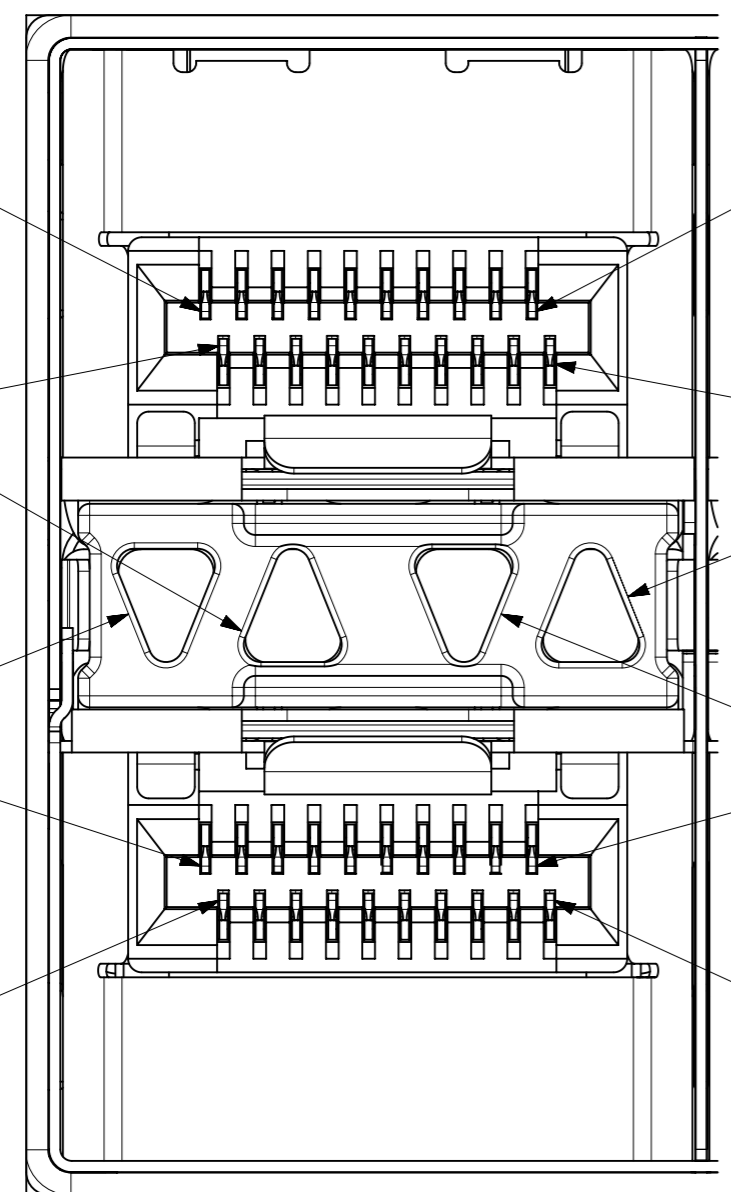

T20 T11
T1 T10
INNER LIGHT PIPE OUTER LIGHT PIPE
L10 L1
L11 L20

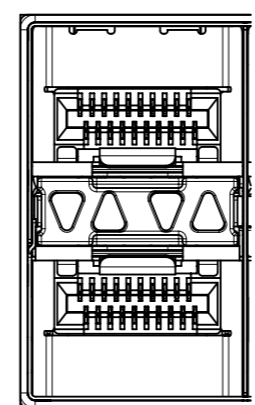

4 LIGHT PIPES
170071-**11

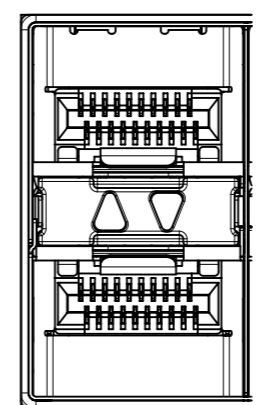

INNER 2 LIGHT PIPES
170071-**12

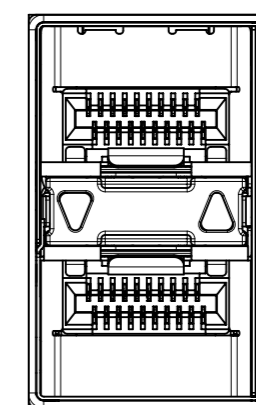

OUTER 2 LIGHT PIPES
DOWN / UP
170071-**13

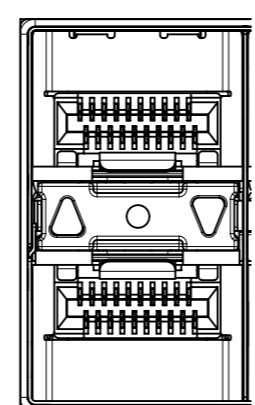

OUTER 2 LIGHT PIPES
UP / DOWN
170071-**14

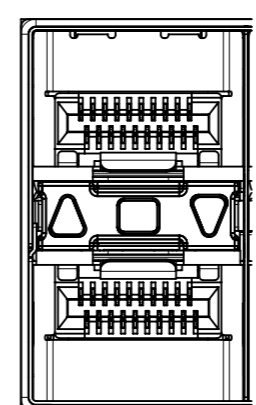

3 LIGHT PIPES
UP / MIDDLE / DOWN
170071-**15

PART NUMBER	DESCRIPTION
170071-**11	4 LIGHT PIPES
170071-**12	INNER 2 PORTS
170071-**13	OUTER DOWN/UP
170071-**14	OUTER UP/DOWN
170071-**15	3 LIGHT PIPES

** DESIGNATES PORT SIZE

THIS DRAWING CONTAINS INFORMATION THAT IS PROPRIETARY TO MOLEX ELECTRONIC TECHNOLOGIES, LLC AND SHOULD NOT BE USED WITHOUT WRITTEN PERMISSION		CURRENT REV DESC: SEE REVISION HISTORY			
DIMENSION UNITS	SCALE	EC NO: 623968			
mm	NTS	DRWN: JWALLACE01 2019/02/12		ZSFP+ STACKED ASSY W/ ELASTOMERIC GASKET	
GENERAL TOLERANCES (UNLESS SPECIFIED)		CHK'D: CWANG67 2019/09/12			
ANGULAR TOL	± 0.5°	APPR: RNELSON 2019/09/17		PRODUCT CUSTOMER DRAWING	
4 PLACES	±	INITIAL REVISION:		DOCUMENT NUMBER	
3 PLACES	±	DRWN: DTAN10 2018/03/01		1700710002	
2 PLACES	± 0.13	APPR: SHONG 2018/03/06		DOC TYPE	DOC PART
1 PLACE	± 0.25	THIRD ANGLE PROJECTION		PSD	000
0 PLACES	±	DRAWING		REVISION	
DRAFT WHERE APPLICABLE MUST REMAIN WITHIN DIMENSIONS		SERIES		A1	
		A3-SIZE		MATERIAL NUMBER	CUSTOMER
		170071		SEE TABLE	GENERAL MARKET
				SHEET NUMBER	
				2 OF 5	

9 8 7 6 5 4 3 2 1

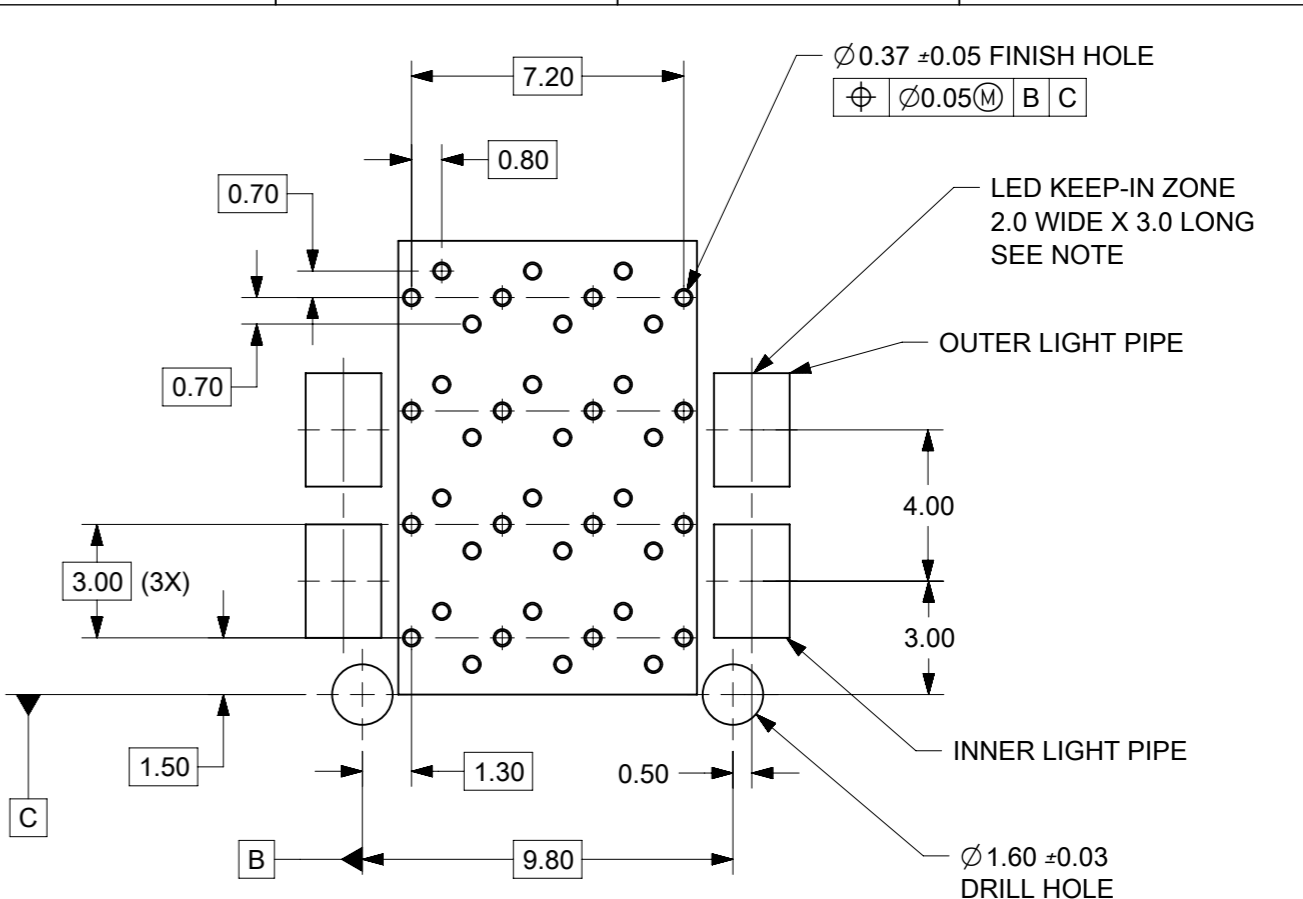
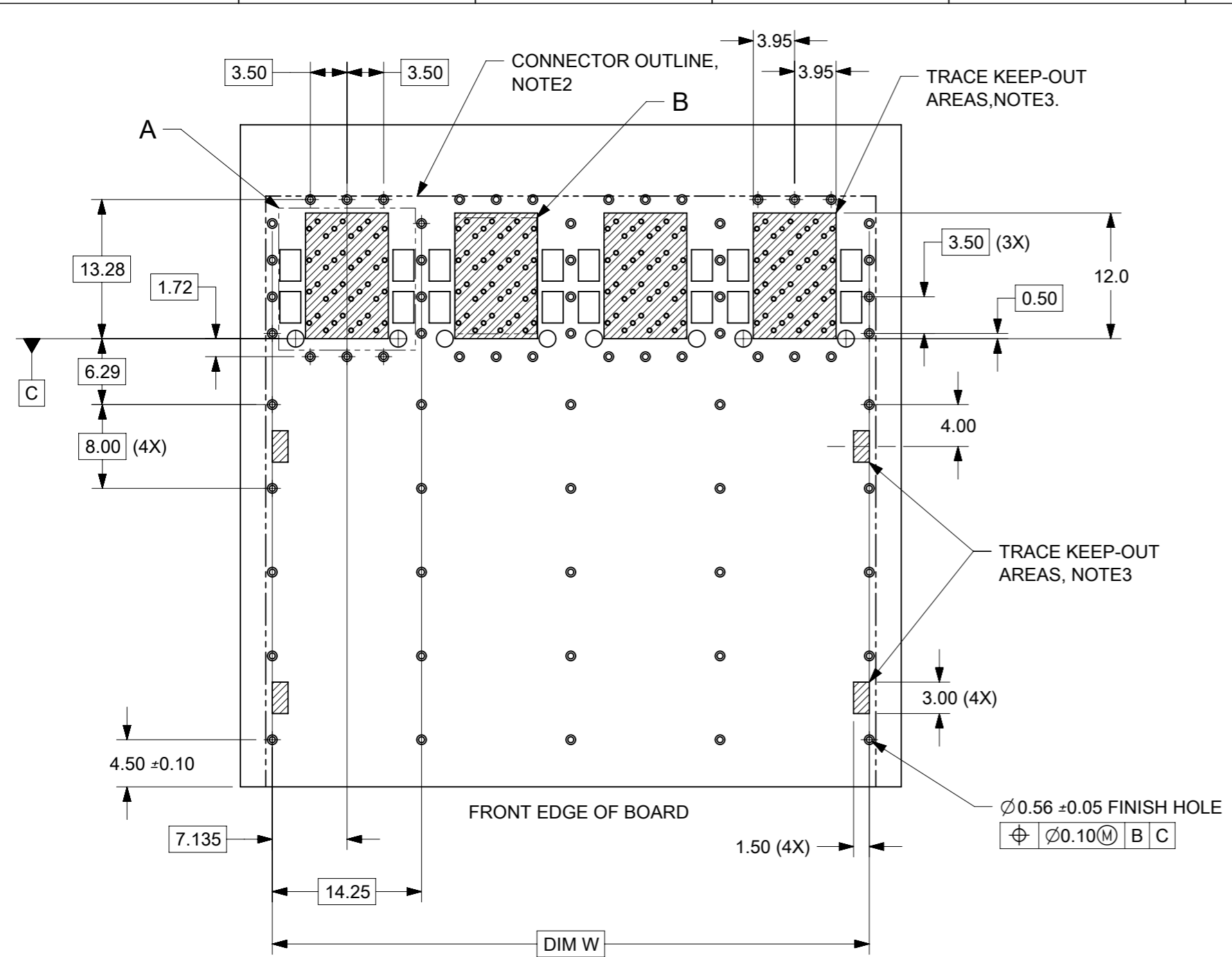

DETAIL A
SCALE 5:1

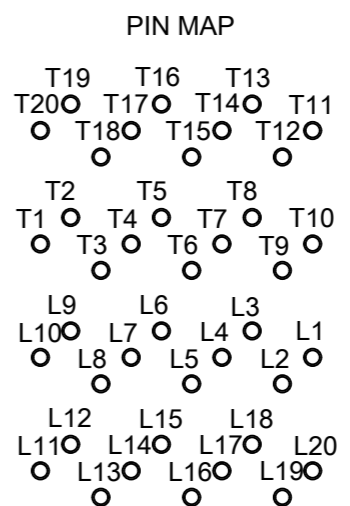

DETAIL B
SCALE 5:1

PORT SIZE	DIM W	HOLE CHART		
		SIGNALS (Ø0.37)	EMI CAGE (Ø0.56)	LOCATING PEG (Ø1.60)
2X1	14.25	40	24	2
2X2	28.50	80	39	4
2X4	57.00	160	69	8
2X6	85.50	240	99	12
2X8	114.00	320	129	16
2X12	171.00	480	189	24

NOTE:
 1. LED PACKAGE SIZE AND POSITION SHALL NOT VIOLATE THE KEEP IN ZONE. LED PLACEMENT SHOULD BE CENTERED WITHIN THE ZONE FOR OPTIMAL LIGHT TRANSMISSION BUT MAY BE SAFELY OFFSET ±0.50.
 2. 1. THE ENTIRE AREA UNDER THE CONNECTOR IS A KEEP OUT ZONE FOR COMPONENTS AND TRACES, TOP LAYER ONLY, EXCEPT FOR CHASSIS GROUND.
 3. CROSS-HATCHED AREAS INDICATE PLACES WHERE THE PLASTIC HOUSING AND METAL CAGE MAY CONTACT PCB SURFACE. THESE AREAS ARE KEEP OUT ZONES. CROSS-HATCHED AREA UNDER THE CONNECTOR ARE TRACE AND VIA KEEP OUT AREAS FOR THE TOP LAYER.

THIS DRAWING CONTAINS INFORMATION THAT IS PROPRIETARY TO MOLEX ELECTRONIC TECHNOLOGIES, LLC AND SHOULD NOT BE USED WITHOUT WRITTEN PERMISSION											
DIMENSION UNITS mm		SCALE NTS		CURRENT REV DESC: SEE REVISION HISTORY						ZSFP+ STACKED ASSY W/ ELASTOMERIC GASKET	
GENERAL TOLERANCES (UNLESS SPECIFIED)		ANGULAR TOL ± 0.5°		EC NO: 623968							
4 PLACES ±		3 PLACES ±		DRWN: JWALLACE01		2019/02/12		DRWN: DTAN10		2018/03/01	
2 PLACES ± 0.13		1 PLACE ± 0.25		CHK'D: CWANG67		2019/09/12		APPR: RNELSON		2019/09/17	
0 PLACES ±		DRAFT WHERE APPLICABLE MUST REMAIN WITHIN DIMENSIONS		THIRD ANGLE PROJECTION		DRAWING		SERIES		MATERIAL NUMBER	
DOCUMENT STATUS		P1		RELEASE DATE		2019/09/17 07:52:23		A3-SIZE		170071	
SEE TABLE		GENERAL MARKET		CUSTOMER		3 OF 5		1700710002		PSD 000 A1	

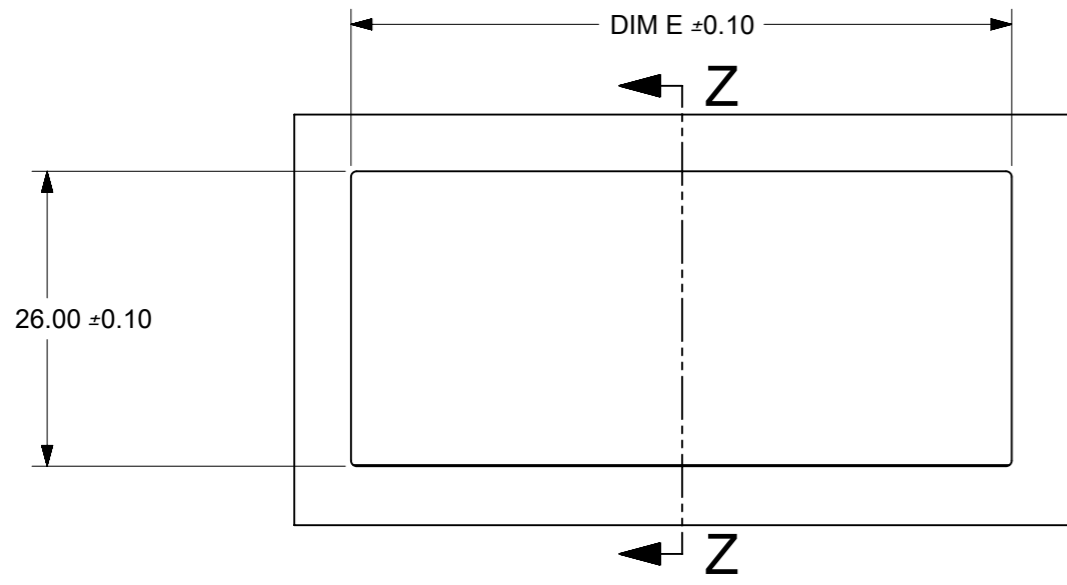

BEZEL CUT OUT DETAIL
BEZEL THICKNESS 0.8~2.6

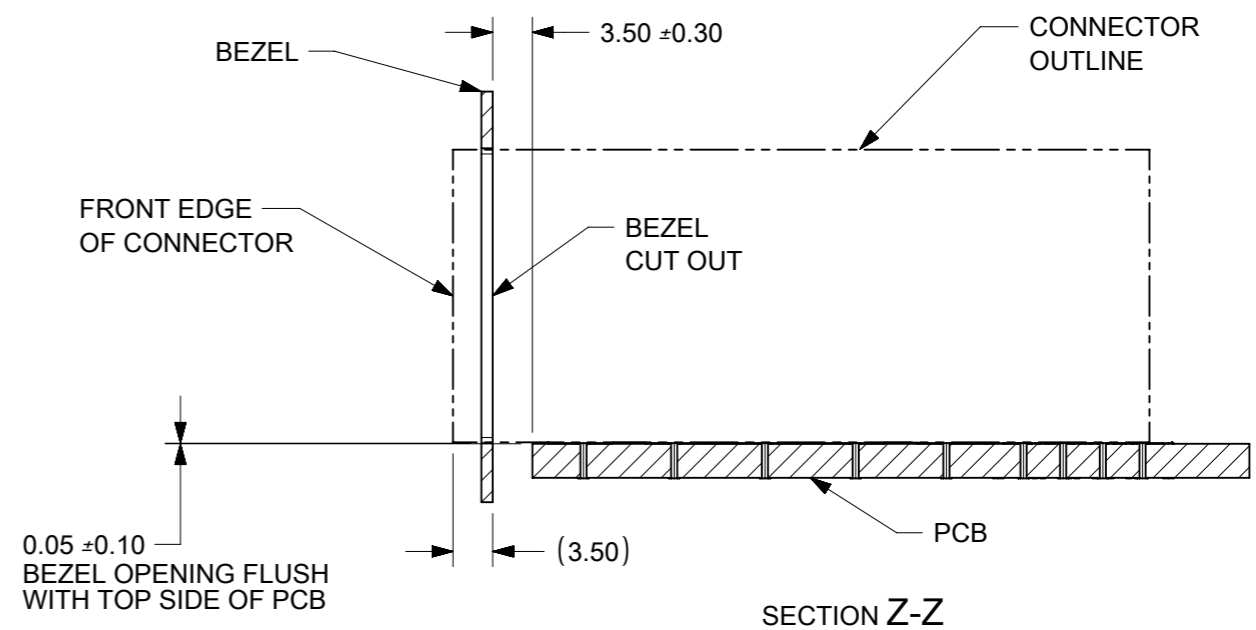

SECTION Z-Z

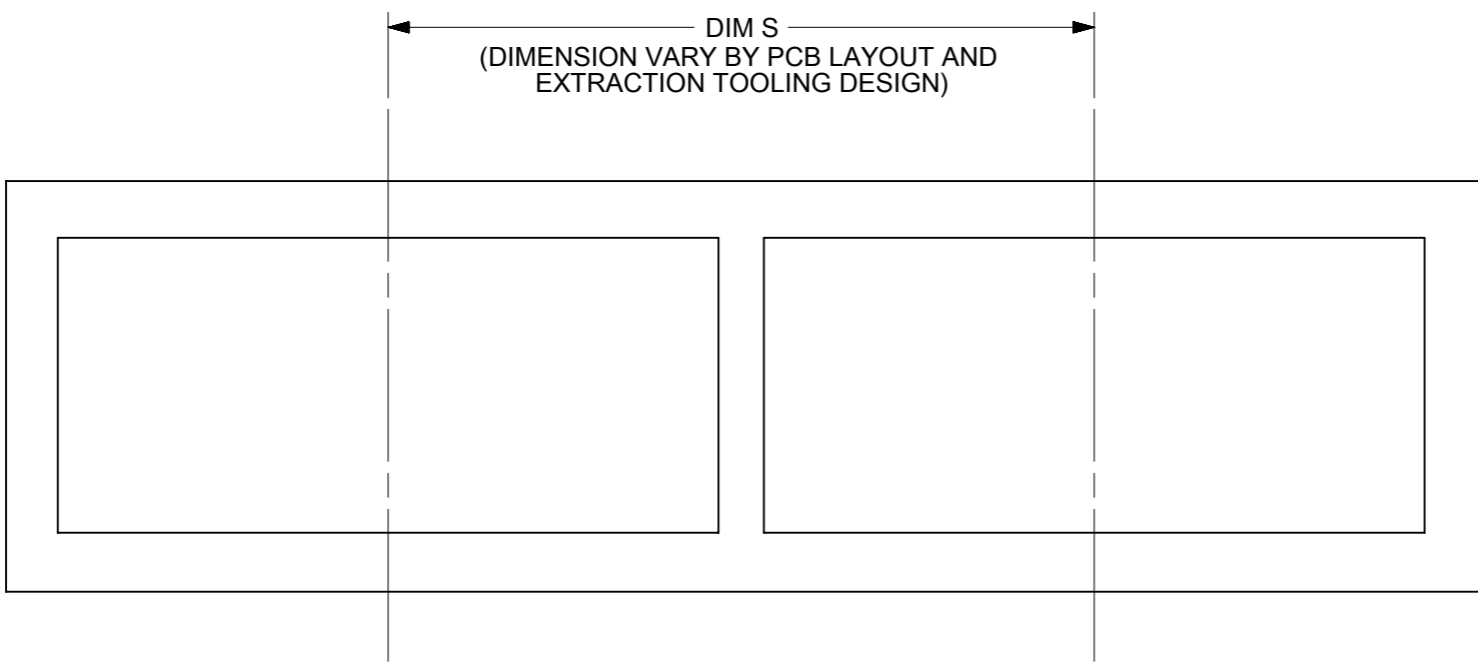

BEZEL CUT OUT FOR
CONNECTOR STACKING

CONFIGURATION	DIM E	DIM S
2X1	15.50	20.40 MINIMUM
2X2	29.75	34.65 MINIMUM
2X4	58.25	63.15 MINIMUM
2X5	72.50	77.40 MINIMUM
2X6	86.75	91.65 MINIMUM
2X8	115.25	120.15 MINIMUM
2X12	172.25	177.15 MINIMUM

THIS DRAWING CONTAINS INFORMATION THAT IS PROPRIETARY TO MOLEX ELECTRONIC TECHNOLOGIES, LLC AND SHOULD NOT BE USED WITHOUT WRITTEN PERMISSION

DIMENSION UNITS mm	SCALE NTS	CURRENT REV DESC: SEE REVISION HISTORY	molex		
GENERAL TOLERANCES (UNLESS SPECIFIED)					
ANGULAR TOL	± 0.5°	EC NO: 623968	PRODUCT CUSTOMER DRAWING		
4 PLACES	±	DRWN: JWALLACE01 2019/02/12	DOCUMENT NUMBER		
3 PLACES	±	CHK'D: CWANG67 2019/09/12	1700710002		
2 PLACES	± 0.13	APPR: RNELSON 2019/09/17	DOC TYPE	DOC PART	REVISION
1 PLACE	± 0.25	INITIAL REVISION:	PSD	000	A1
0 PLACES	±	DRWN: DTAN10 2018/03/01	MATERIAL NUMBER		
DRAFT WHERE APPLICABLE MUST REMAIN WITHIN DIMENSIONS		APPR: SHONG 2018/03/06	SEE TABLE	CUSTOMER	
THIRD ANGLE PROJECTION		DRAWING	SERIES	SHEET NUMBER	
		A3-SIZE	170071	GENERAL MARKET 4 OF 5	

9 8 7 6 5 4 3 2 1

REVISION HISTORY		
DATE	REV.	DESCRIPTION
2019/09/12	A1	1.ADDED REVISION HISTORY. 2.ADDED DATE CODE FORMAT IN NOTE8, SHEET1. 3.ADDED SIGNAL TAIL LENGTH OF SHORT, SHEET1.
		4.ADDED NOTE2&3, SHEET3

E
D
C
B
A

E
D
C
B
A

THIS DRAWING CONTAINS INFORMATION THAT IS PROPRIETARY TO MOLEX ELECTRONIC TECHNOLOGIES, LLC AND SHOULD NOT BE USED WITHOUT WRITTEN PERMISSION										
DIMENSION UNITS	SCALE	CURRENT REV DESC: SEE REVISION HISTORY				molex				
mm	NTS									
GENERAL TOLERANCES (UNLESS SPECIFIED)		EC NO: 623968				ZSFP+ STACKED ASSY W/ ELASTOMERIC GASKET				
ANGULAR TOL	± 0.5 °	DRWN: JWALLACE01 2019/02/12								
4 PLACES	±	CHK'D: CWANG67 2019/09/12				PRODUCT CUSTOMER DRAWING				
3 PLACES	±	APPR: RNELSON 2019/09/17								
2 PLACES	± 0.13	INITIAL REVISION:				DOCUMENT NUMBER				
1 PLACE	± 0.25	DRWN: DTAN10 2018/03/01				1700710002				
0 PLACES	±	APPR: SHONG 2018/03/06				DOC TYPE		DOC PART		REVISION
DRAFT WHERE APPLICABLE MUST REMAIN WITHIN DIMENSIONS		THIRD ANGLE PROJECTION		DRAWING	SERIES	MATERIAL NUMBER		CUSTOMER		SHEET NUMBER
				A3-SIZE	170071			GENERAL MARKET		5 OF 5

DOCUMENT STATUS	P1	RELEASE DATE	2019/09/17 07:52:23
-----------------	----	--------------	---------------------

9 8 7 6 5 4 3 2 1

FORMAT: master-b-prod-A3
REVISION: 11
DATE: 2018/01/18