

PLEASE CHECK WWW.MOLEX.COM FOR LATEST PART INFORMATION

Part Number: [0191930375](#)
Status: **Active**
Overview: [VersaKrimp™ Terminals and Splices](#)
Description: [VersaKrimp™ Ring Tongue Terminal for 4/0 AWG Wire](#)

Documents:

[Drawing \(PDF\)](#) [Product Specification PS-19902-013 \(PDF\)](#)
[Product Specification PS-19902-011 \(PDF\)](#) [RoHS Certificate of Compliance \(PDF\)](#)

Agency Certification

CSA LR18689
 UL E32244

General

Product Family Ring and Spade Terminals
 Series [19193](#)
 Crimp Quality Equipment Yes
 Mil-Spec N/A
 Overview [VersaKrimp™ Terminals and Splices](#)
 Product Name VersaKrimp™
 Type Ring
 UPC 800755052718

Physical

Barrel Type Closed - Brazed
 Insulation None
 Material - Plating Mating Tin
 Net Weight 44.271/g
 Packaging Type Bag
 Plating min - Mating 2.540µm
 Plating min - Termination 2.540µm
 Stud Size 3/8" (M9)
 Termination Interface: Style Crimp or Compression
 Wire Size AWG 4/0

Solder Process Data

Lead-freeProcess Capability N/A

Material Info

Engineering Number L-395-38

Reference - Drawing Numbers

Product Specification PS-19902-011, PS-19902-013
 Sales Drawing SD02051

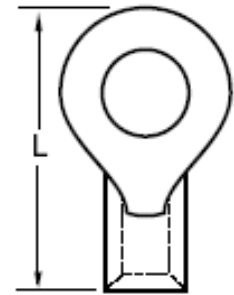

Series image - Reference only

EU ELV

Not Relevant

EU RoHS

Compliant

China RoHS

REACH SVHC

Not Contained Per -
 ED/21/2016 (20 June
 2016)

Halogen-Free

Status

Low-Halogen

**Need more information on product
 environmental compliance?**

Email productcompliance@molex.com
 Please visit the [Contact Us](#) section for any
 non-product compliance questions.

China ROHS

Green Image

ELV

Not Relevant

RoHS Phthalates

Not Contained

Search Parts in this Series

[19193 Series](#)

Application Tooling | [FAQ](#)

*Tooling specifications and manuals are
 found by selecting the products below.
 Crimp Height Specifications are then
 contained in the Application Tooling
 Specification document.*

Global

Description	Product #
Die Set (large) for the HHLS Hydraulic Crimper	0192900031
Manual tool for Crimping non-insulated 8AWG thru 4/0 Terminals	0192940008

This document was generated on 10/21/2016

PLEASE CHECK WWW.MOLEX.COM FOR LATEST PART INFORMATION