

## FEATURES AND SPECIFICATIONS

### Features and Benefits

- Environmentally sealed to IP67
- Integrated mat wire seal and terminal position assurance (TPA)
- Simple crimp-and-poke application
- Field serviceable contact removal system
- Tactile and audible mating feedback

### Reference Information

UL File No.: E152602  
 Designed In: Inches  
 Mates With: 19418

### Electrical

Dielectric Withstanding Voltage: 2200V AC min.  
 Insulation Resistance: 1000 Megohms  
 Voltage: 600V

### Mechanical

Mating force: 75N max.  
 Unmating force: 75N max.

### Physical:

Housing: SPS Glass-Filled Crystalline Polymer  
 Operating Temperature: -40 to +125°C



## 5.84mm (.230") Pitch MX150L™ Plug

### 19419

## Single Row

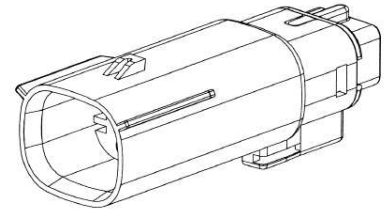

## CATALOG DRAWING (FOR REFERENCE ONLY)

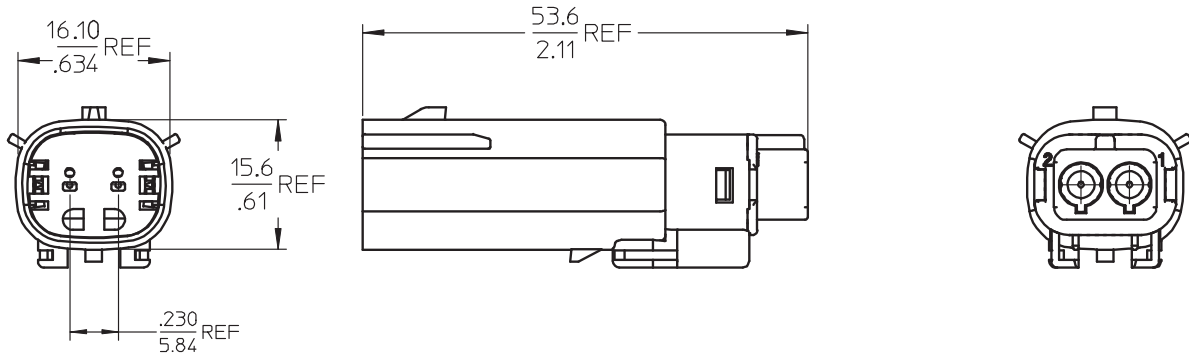

## ORDERING INFORMATION

Circuits	Wire Range (AWG)	Mat Seal Color	Order No.
2	18-22	Red	19419-0008
	14-16	Blue	19419-0007



**MX150L™**

## Product Overview

### 14 TO 22 AWG WIRE-TO-WIRE, PANEL MOUNT AND PCB

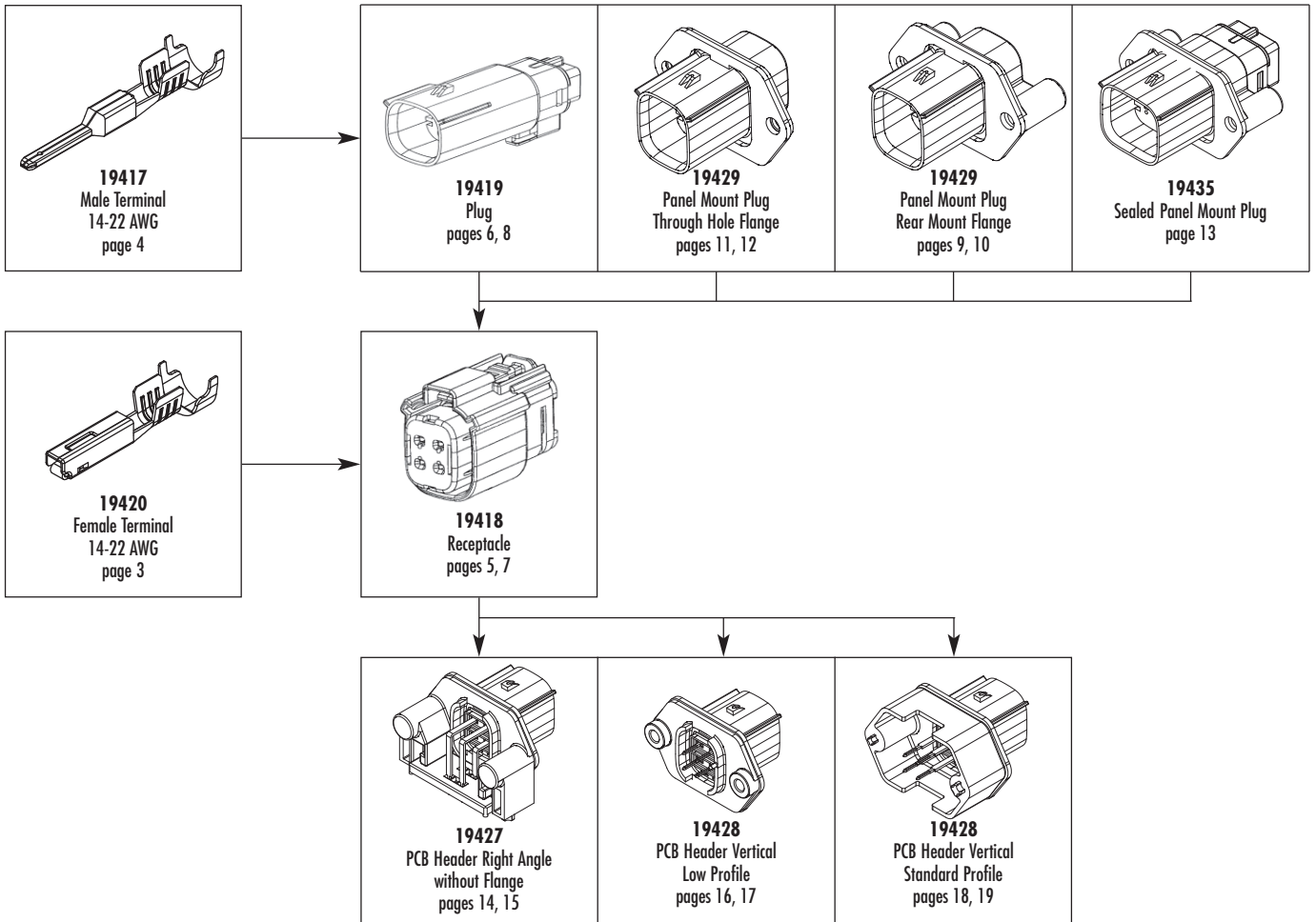

### 8, 10 AND 12 AWG WIRE-TO-WIRE

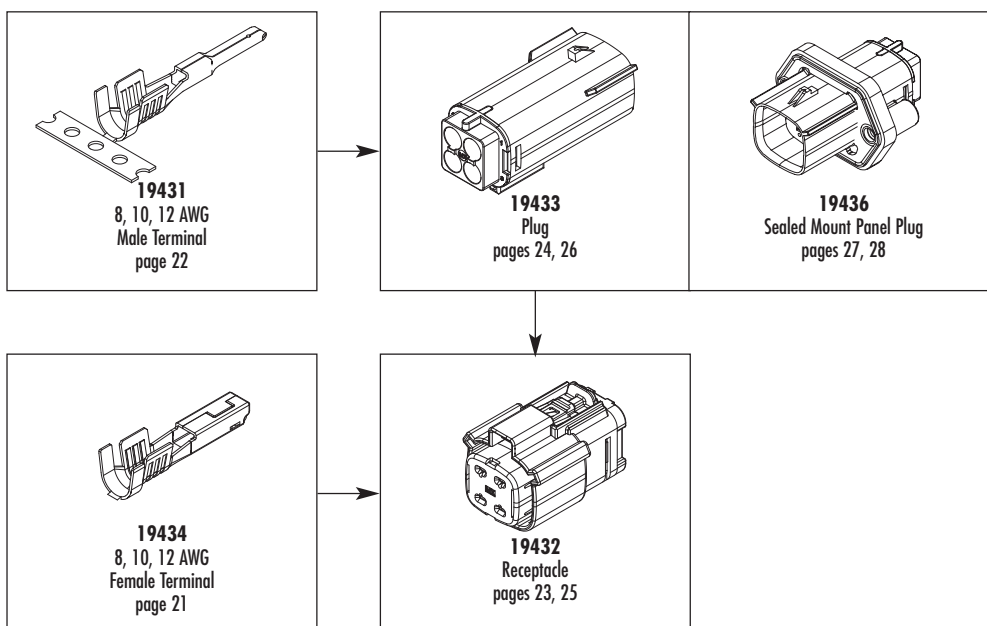

## SEALED RECEPTACLE ASSEMBLY - SERVICEABILITY



### 1) Return TPA to pre-lock position

- Carefully insert a standard screw driver into slot on top of TPA.
- Carefully pry TPA forward and listen for audible click.
- TPA is now in pre-lock position.

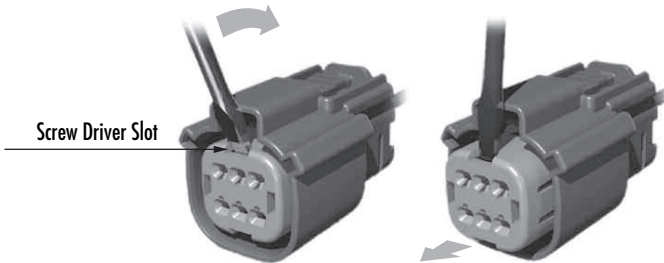

### 2) Release terminal from connector assembly

- Insert and drive forward extractor tool to release terminal.
- Pull terminal from rear of connector.

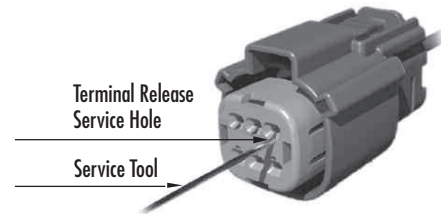

## SEALED BLADE ASSEMBLY - SERVICEABILITY

### 1) Return TPA to pre-lock position

- Use standard needle nose pliers to return TPA to pre-lock position.
- Insert needle nose pliers into service hole and carefully pull TPA.
- Listen for loud audible click.
- TPA is now in pre-lock position.

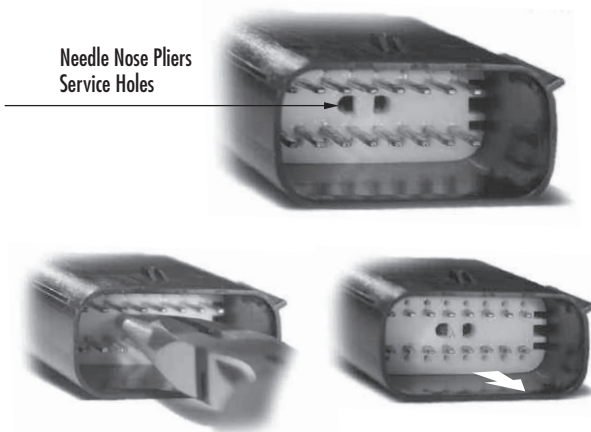

### 2) Release terminal from connector assembly

- Insert and drive forward extractor tool to release terminal.
- Pull terminal from rear of connector.

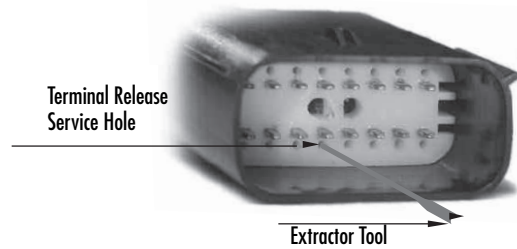

## TERMINAL INSTALLATION

Assure housing TPA is in pre-lock position. Align polarization feature on terminal with keyway in seal cap. Insert terminal and push until seated. Push receptacle TPA back to locked position. Plug TPA will return to locked position when mated with receptacle housing.

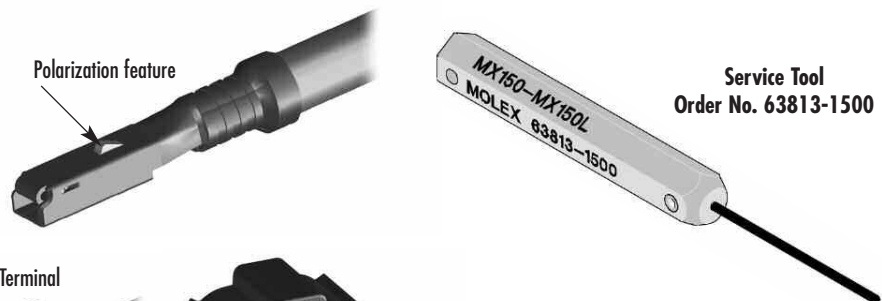

### 90° Mis-oriented Terminal

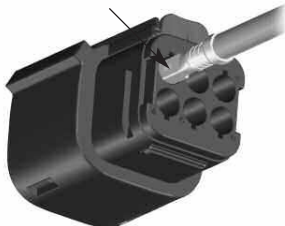

### 180° Mis-oriented Terminal



### Correctly oriented Terminal



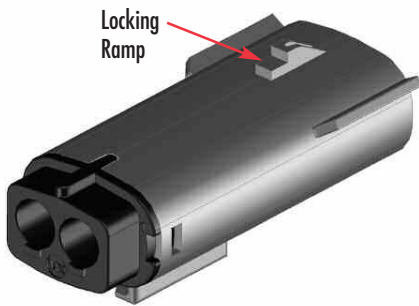

Locking Ramp

Plug

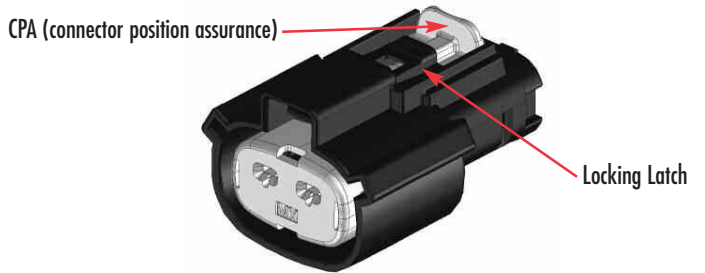

CPA (connector position assurance)

Locking Latch

Receptacle

**To Mate:**

1. Firmly push connectors together until you feel them snap together, you should hear a click. This audible and tactile confirmation ensures the connectors are properly and fully mated.

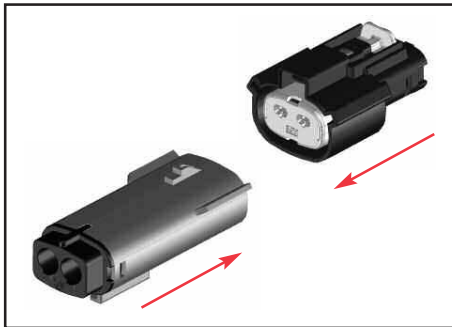

2. Press CPA towards plug to engage the secondary lock.

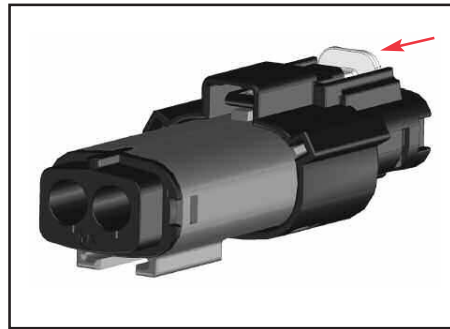

**To Unmate:**

1. Pull back CPA

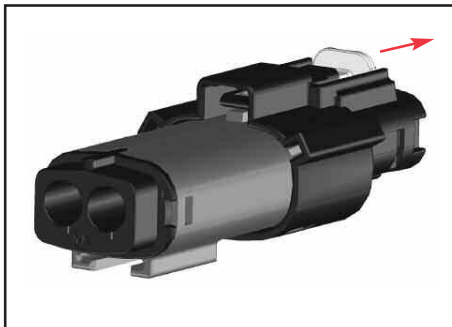

2. Fully depress locking latch

*Locking latch must be fully depressed to release the locking ramp on the plug and allow the connectors to be separated!*

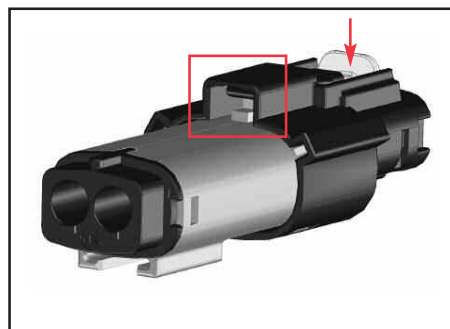

3. Pull connectors apart

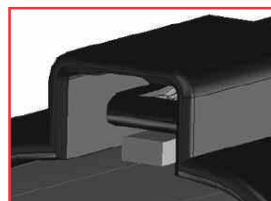
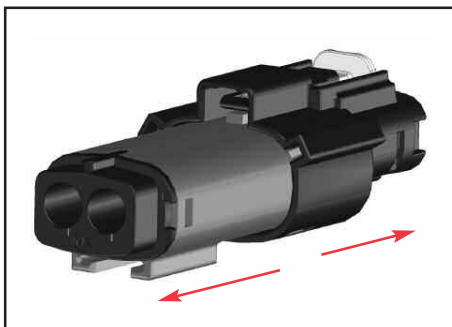

Locking latch shown down, cannot unmate connectors

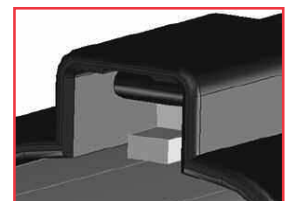

Locking latch shown fully depressed, latch releases locking ramp