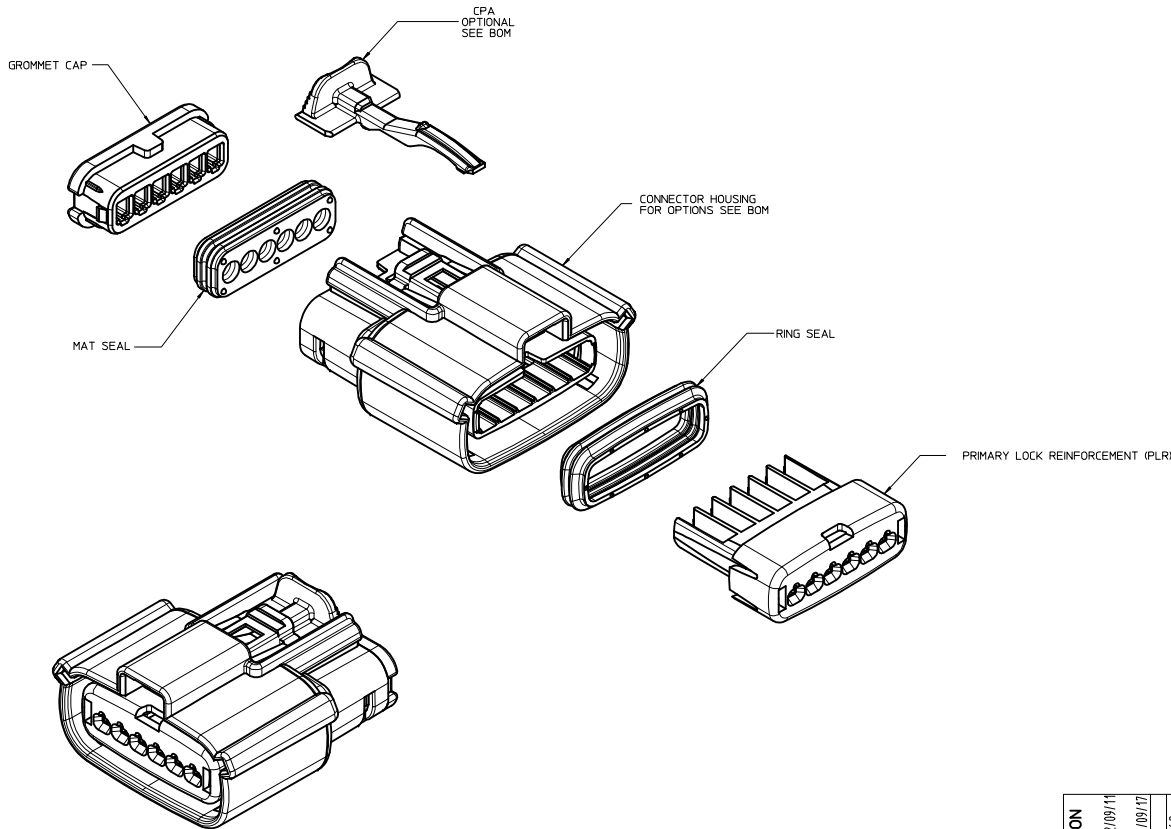

TABLE OF CONTENTS	
SHEET NO.	SHEET DESCRIPTION
1	NOTES
2	KEY CONFIGURATIONS
3	RECEPTACLE SEALED ASSEMBLY
4	BOM



NOTES: VALID UNLESS OTHERWISE SPECIFIED

1. GENERAL:
 - a. APPLICATION SPECIFICATION SEE: AS-33472-100
 -CONTAINS: PRODUCT INTRODUCTION, PRODUCT SUMMARY, CONNECTOR ASSEMBLY, PACKAGING INFORMATION, CONNECTOR MATING, SERVICE INSTRUCTIONS, ELECTRICAL CONTINUITY CHECKING, CRIMPING, AND TROUBLESHOOTING.
 -DESIGNED TO MATE WITH DEVICE CONNECTION AS SPECIFIED IN DRAWING EWCAP 150-S-006-1-Z03, AVAILABLE AT <http://ewcap.uscorp.com>
 -DESIGNED TO MATE WITH BLADE SEALED ASSEMBLY AS SPECIFIED IN DRAWING SD-33481-061
 -FOR 15mm RECEPTACLE TERMINALS TO BE USED WITH THIS ASSEMBLY. SEE MOLEX DRAWING SD-33012-002.
 -SYSTEM TO BE USED WITH WIRE WITHIN DIAMETER RANGE OF 1.2 mm TO 2.69 mm.
 -ASSEMBLY SHIPPED WITH PLR AND CPA IN PRE-LOCK POSITION (SEE SECTION 2-2 PRE-LOCK).
 -IN THE EVENT THAT THE PLR IS FOUND IN THE SEATED (FINAL LOCK) POSITION, REFER TO MOLEX SPECIFICATION PS-34646-001, AVAILABLE AT www.molex.com <http://www.molex.com>.
 -ASSEMBLY CONFORMS TO SAE/J59CAR-2 REV.4 WITH THE FOLLOWING EXCEPTIONS:
 ENGAGEMENT FORCE TO MOVE CPA FROM PRE-LOCK TO FINAL LOCK POSITION WHEN UNMATED: 40N MIN.
 DISENGAGEMENT FORCE TO MOVE CPA FROM FINAL LOCK TO PRE-LOCK POSITION: 3N MIN. 40N MAX.
 TERMINAL INSERTION FORCE FOR WIRE DIAMETER ABOVE 2.5mm NOT EXCEEDING 2.69mm SHALL NOT EXCEED 40 NEWTONS.
 - b. PRODUCT SPECIFICATION SEE: PS-33471-000
 CONTAINS: PRODUCT INTRODUCTION, PRODUCT SUMMARY, RATINGS (CURRENT, TEMPERATURE, SEALING, AND FLAMMABILITY), AND PRODUCT VALIDATION.
 - c. PACKAGING SPECIFICATION PER MOLEX DRAWING: PK-31300-903
 - d. PARTS MUST BE IN COMPLIANCE TO MOLEX CHEMICAL SUBSTANCES FOR PRODUCTS AND PACKAGING SPECIFICATION: ES-40000-5016
 - e. DATA MUST BE SUBMITTED UNDER THE MOLEX PART NUMBER TO IMDS (COMPANY ID=12255)
2. DESIGN - MATERIALS:
 - a. CONNECTOR HOUSING, GROMMET CAP, PLR: SPS/NYLON BLEND 20% GLASS FILLED
 - b. CPA: PBT 20% GLASS FILLED
 - c. MAT SEAL AND RING SEAL: INHERENTLY LUBRICATED SILICONE
3. DESIGN - GEOMETRY:
 - a. THIS IS A 100% CAD GENERATED PART. THE CAD MATHEMATICAL DATA IS THE MASTER FOR THIS PART. FOR DIMENSIONAL OR ANY INFORMATION NOT SHOWN ON THIS DRAWING, ANALYZE THE CAD MODEL.
 - b. GEOMETRIC DIMENSIONS AND TOLERANCES PER ASME Y14.5M - 1994.
 - c. EDGES AND UNDIMENSIONED DETAILS PER ISO13715
 - d. CORNERS SHOWN AS SHARP TO BE R 0.2 MAX.
 - e. LETTERING SHALL BE 0.15 MAX RAISED IN 0.25 MAX RECESS PAD. THIS INCLUDES RECYCLING CODE, CAVITY ID, VENDOR IDENTIFICATION, AND CUSTOMER MATERIAL NUMBER.
 - f. VISUAL DEFECTS SHALL MEET COSMETIC STANDARD PS-45499-002 (Class B)
 - g. LASER MARKING: TBD

INSPECTION NUMBER LOG
 LAST NUMBER USED: 5
 ADDED:
 REMOVED:

S1	UPDATED CONFIGURATIONS SHEET 3
S	REDRAWN
REV	DESCRIPTION
SCALE	3:1
DESIGN UNITS	METRIC
THIRD ANGLE PROJECTION	

ENTER DESCRIPTION IEC NO: UAU2013-0423 DRAWN/CHECKED/APP: 2012/09/11 CHYK: / APPR: IKOSHY	QUALITY SYMBOLS	GENERAL TOLERANCES (UNLESS SPECIFIED)	DIMENSION STYLE	SCALE	DESIGN UNITS	THIRD ANGLE PROJECTION
	▽=0	4 PLACES ± mm ± INCH	MM ONLY	3:1	METRIC	
	▽=0	3 PLACES ± 0.10 ± 0.003	DRAWN BY DATE			
	▽=0	2 PLACES ± 0.3 ± 0.003	CHECKED BY DATE			
		1 PLACE ± 0.3 ± 0.003	APPROVED BY DATE			
		0 PLACE ± ±	DRAWN BY DATE			
		ANGULAR ± 3 °	APPROVED BY DATE			
		DRAFT WHERE APPLICABLE MUST REMAIN WITHIN DIMENSIONS	MATERIAL NO.			
			SEE BOM			
			SIZE D			

TITLE
MX150 1X6 RECEPTACLE SEALED ASSEMBLY MAT SEAL



DOCUMENT NO. SD-33471-061 SHEET NO. 1 OF 4

THIS DRAWING CONTAINS INFORMATION THAT IS PROPRIETARY TO MOLEX INCORPORATED AND SHOULD NOT BE USED WITHOUT WRITTEN PERMISSION

KEY CONFIGURATIONS

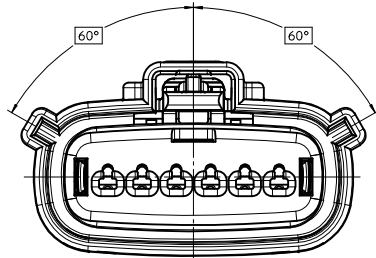

KEY A

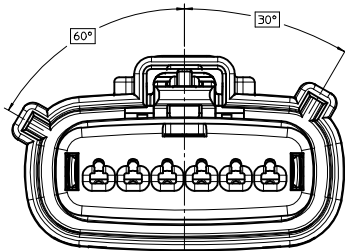

KEY B

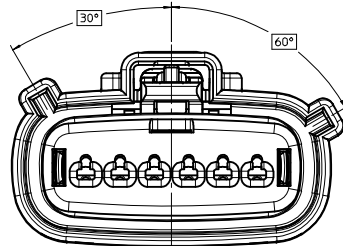

KEY C

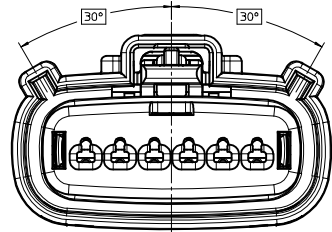

KEY D

ENTER DESCRIPTION IEC NO. UAU2013-0423 DRAWN: CUNNINGHAM 2012/09/11 CHKD: APPR: WOSHY 2012/09/17 REV DESCRIPTION	QUALITY SYMBOLS ▽=0 ▽=0 ▽=0		GENERAL TOLERANCES (UNLESS SPECIFIED) mm INCH 4 PLACES ± --- ± --- 3 PLACES ± --- ± --- 2 PLACES ± 0.10 ± --- 1 PLACE ± 0.3 ± --- 0 PLACE ± ±		DIMENSION STYLE MM ONLY		SCALE 4:1	DESIGN UNITS METRIC	THIRD ANGLE PROJECTION
	DRAFT WHERE APPLICABLE MUST REMAIN WITHIN DIMENSIONS		ANGULAR ± 3 °		DRAWN BY DATE DGRIFITHS 06-03-03		CHECKED BY DATE DGRIFITHS 06-03-03		TITLE MX150 1X6 RECEPTACLE SEALED ASSEMBLY MAT SEAL
	MATERIAL NO. SEE BOM		APPROVED BY DATE DGRIFITHS 06-03-03		DOCUMENT NO. SD-33471-061		SHEET NO. 2 OF 4		molex
	THIS DRAWING CONTAINS INFORMATION THAT IS PROPRIETARY TO MOLEX INCORPORATED AND SHOULD NOT BE USED WITHOUT WRITTEN PERMISSION								

LASER MARKING THIS SURFACE
SEE NOTE 3g.

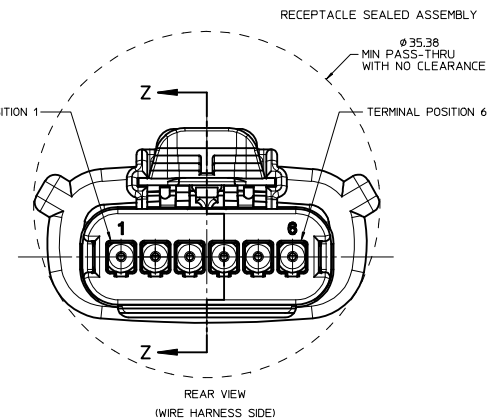
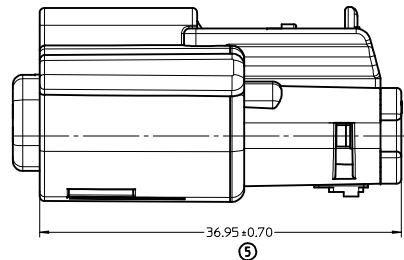
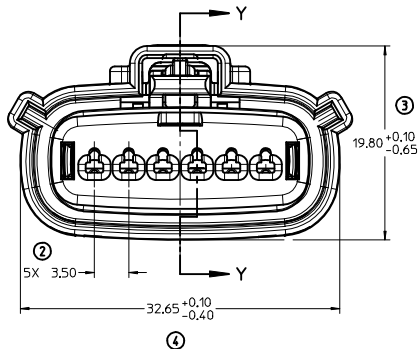
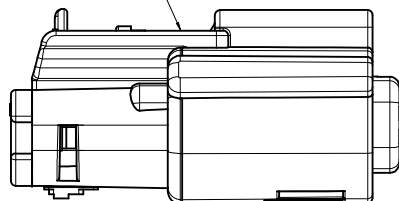

MOLD CAVITY CODE RECYCLE CODE

LOCATION CODE

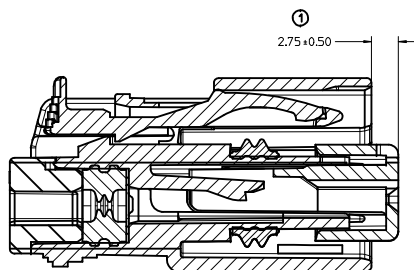
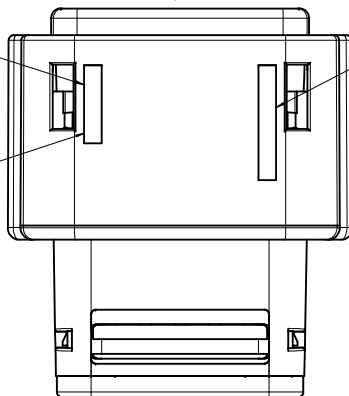

PRIMARY LOCK REINFORCEMENT (PLR) SHOWN
IN PRE-STAGED POSITION

SECTION Z-Z

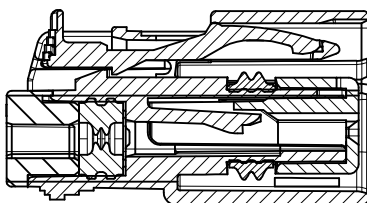

PRIMARY LOCK REINFORCEMENT (PLR) SHOWN
IN FINAL-LOCK POSITION

SECTION Y-Y

ENTER DESCRIPTION IEC NO: UAU2013-0423 DRAWN/CUNNINGHAM 2012/09/11 CHKD: APPR: WOSHY 2012/09/17	QUALITY SYMBOLS ▽=0 ▽=0 ▽=0	GENERAL TOLERANCES (UNLESS SPECIFIED) mm INCH 4 PLACES ± --- ± --- 3 PLACES ± --- ± --- 2 PLACES ± 0.10 ± --- 1 PLACE ± 0.3 ± --- 0 PLACE ± ±	DIMENSION STYLE MM ONLY	SCALE 4:1	DESIGN UNITS METRIC	THIRD ANGLE PROJECTION	
	DRAWN BY DGRIFITHS	DATE 06-03-03	CHECKED BY DGRIFITHS	DATE 06-03-03	TITLE MX150 1X6 RECEPTACLE SEALED ASSEMBLY MAT SEAL		
	APPROVED BY DGRIFITHS	DATE 06-03-03	MATERIAL NO. SEE BOM		DOCUMENT NO. SD-33471-061	SHEET NO. 3 OF 4	
	DRAFT WHERE APPLICABLE MUST REMAIN WITHIN DIMENSIONS						THIS DRAWING CONTAINS INFORMATION THAT IS PROPRIETARY TO MOLEX INCORPORATED AND SHOULD NOT BE USED WITHOUT WRITTEN PERMISSION

ASSEMBLY PART NUMBER	COLOR	KEYING OPTION	CAVITY TYPE & STATUS (X = PLUGGED)						CPA	STATUS
			1	2	3	4	5	6		
33471-0601	BLACK	A							-	SALEABLE
33471-0602	LT. GRAY	B							-	
33471-0603	BROWN	C							-	
33471-0604	GREEN	D							-	
33471-0605	YELLOW	A							-	SALEABLE
33471-0606	BLACK	A							YES	SALEABLE
33471-0607	LT. GRAY	B							YES	
33471-0608	BROWN	C							YES	
33471-0609	GREEN	D							YES	
33471-0610	YELLOW	A							YES	SALEABLE
33471-0611	BLACK	A						X	-	SALEABLE
33471-0612	LT. GRAY	B						X	-	
33471-0613	BROWN	C						X	-	
33471-0614	GREEN	D						X	-	
33471-0615	YELLOW	A						X	-	SALEABLE
33471-0616	BLACK	A						X	YES	SALEABLE
33471-0617	LT. GRAY	B						X	YES	
33471-0618	BROWN	C						X	YES	
33471-0619	GREEN	D						X	YES	
33471-0620	YELLOW	A						X	YES	SALEABLE
33471-0621	BLACK	A	X					X	-	SALEABLE
33471-0622	LT. GRAY	B	X					X	-	
33471-0623	BROWN	C	X					X	-	
33471-0624	GREEN	D	X					X	-	
33471-0625	YELLOW	A	X					X	-	SALEABLE
33471-0626	BLACK	A	X					X	YES	SALEABLE
33471-0627	LT. GRAY	B	X					X	YES	
33471-0628	BROWN	C	X					X	YES	
33471-0629	GREEN	D	X					X	YES	
33471-0630	YELLOW	A	X					X	YES	SALEABLE
33471-0631	BLACK	A	X	X	X	X	X	X	-	SALEABLE
33471-0632	LT. GRAY	B	X	X	X	X	X	X	-	
33471-0633	BROWN	C	X	X	X	X	X	X	-	
33471-0634	GREEN	D	X	X	X	X	X	X	-	
33471-0635	YELLOW	A	X	X	X	X	X	X	-	SALEABLE
33471-0650	BLACK	A				X			-	SALEABLE
33471-0651	BLACK	A	X	X	X	X	X	X	YES	SALEABLE
33471-0652	BLACK	A				X			YES	SALEABLE
33471-0653	BLACK	A			X				YES	SALEABLE
33471-0654	BLACK	A			X				-	SALEABLE
33471-0655	BLACK	A			X	X	X		-	SALEABLE
33471-0656	BLACK	A				X			-	SALEABLE
33471-0657	BLACK	A			X				-	SALEABLE

ENTER DESCRIPTION IEC NO. UAU2013-0423 DRAWN/CUNNINGHAM 2012/09/11 CHKD: APPR:VKOSHY 2012/09/17 REV:	QUALITY SYMBOLS	GENERAL TOLERANCES (UNLESS SPECIFIED)	DIMENSION STYLE	SCALE	DESIGN UNITS	THIRD ANGLE PROJECTION
	▽=0	mm INCH	MM ONLY		METRIC	
	▽=0	4 PLACES ± 0.10	DRAWN BY DATE	DGRIFITHS 06-03-03	TITLE	
	▽=0	3 PLACES ± 0.03	CHECKED BY DATE	DGRIFITHS 06-03-03	MX150 1X6 RECEPTACLE SEALED ASSEMBLY MAT SEAL	
		ANGULAR ± 3°	APPROVED BY DATE	DGRIFITHS 06-03-03	DOCUMENT NO.	
		DRAFT WHERE APPLICABLE MUST REMAIN WITHIN DIMENSIONS	MATERIAL NO.	SEE BOM		SHEET NO.
			SIZE	SD-33471-061		4 OF 4
				THIS DRAWING CONTAINS INFORMATION THAT IS PROPRIETARY TO MOLEX INCORPORATED AND SHOULD NOT BE USED WITHOUT WRITTEN PERMISSION		