

注記

- 適用ターミナル：5556 シリーズ
 - 嵌合相手：5559 シリーズ
5566 シリーズ
5569 シリーズ
- △ D 面の位置にて維持すること。

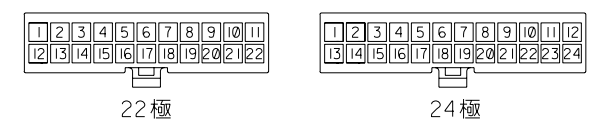
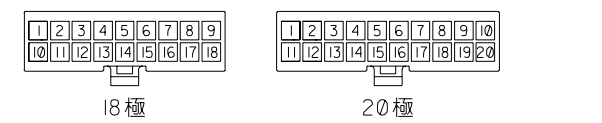
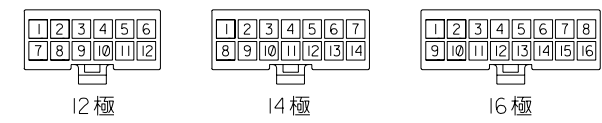
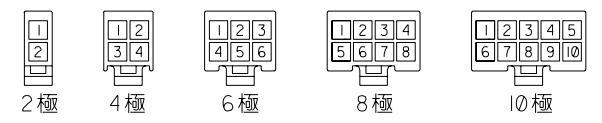

回路レイアウト図
(SCALE: 1-1)

	C	B	A	EDP. NO.	ENG. NO.	極数
3.6	51.6	46.2	39-01-2245	5557-24R-210	24	24
	47.4	42	-2225	-22R-210	22	22
	43.2	37.8	-2205	-20R-210	20	20
	39	33.6	-2185	-18R-210	18	18
3.3	34.8	29.4	-2165	-16R-210	16	16
	30.6	25.2	-2145	-14R-210	14	14
	26.4	21	-2125	-12R-210	12	12
	22.2	16.8	-2105	-10R-210	10	10
	18	12.6	-2085	-08R-210	8	8
	13.8	8.4	-2065	-06R-210	6	6
	9.6	4.2	-2045	-04R-210	4	4
	5.4	—	39-01-2025	5557-02R-210	2	2

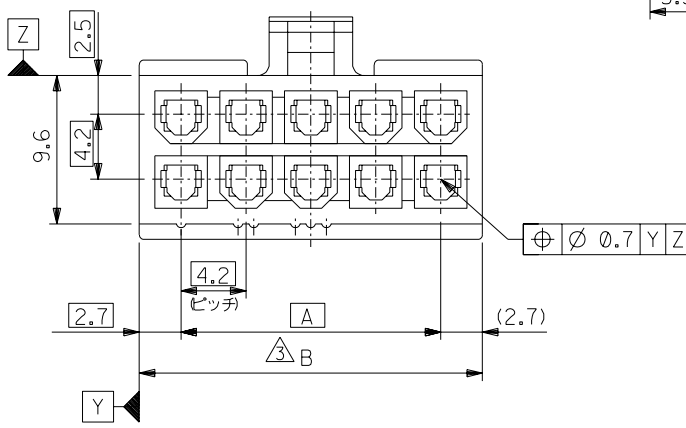
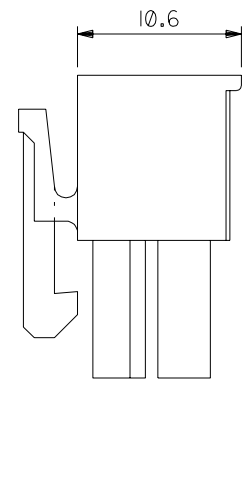
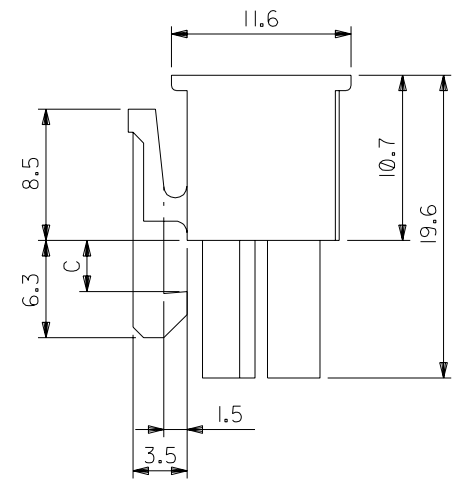
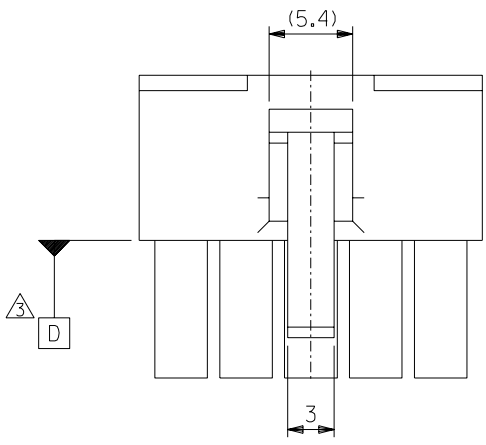

角度 ANGLE	±3°
30°以上 OVER	±0.1
10°以上 OVER 30°未滿 UNDER	±0.3
未滿 10° UNDER	±0.2

記号 LTR	変更内容 REVISION RECORD	日付 DATE	DR. CHK.
G	変更 (JC70586)	97/1/8	S.A. M.F.
F	変更 (J20850)	92/9/19	H.H. M.F.
E	変更 (J20158)	92/4/20	H.H. Y.Y.
D	変更 (J01160)	90/11/8	H.H. Y.Y.
C	変更及び再作図 (J00192)	90/2/22	S.M. H.H.

材料 MATERIAL
66 ナイロン (UL94V-0)
色: オフホワイト

仕上げ FINISH ————

適用電線範囲 WIRE RANGE ————

被覆外径 INS. RANGE ————

DRAWN BY '90/2/22 S.MOCHIZUKI
CHK'D BY '97/1/8 M.FUKUSHIMA

APP'D BY '97/1/8 M.FUKUSHIMA
尺度 SCALE 3 - 1

MOLEX-JAPAN CO.,LTD.
日本モレックス株式会社

REVISE ONLY ON CAD SYSTEM

TITLE 名称
NEW MINI FIT CONN.
REC. HOUSING

DWG. NO. SD-5557-NR-210
REV G

ENG. NO.
SD-5557-NR-210

EDP NO.
39-01-2**5

:MM DIMENSIONS IN METRIC DO NOT SCALE DRAWING

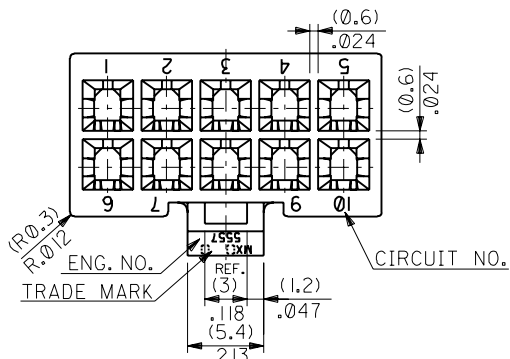

NOTES

1. TERMINAL : 5556 SERIES
2. MATE WITH : 5559 SERIES
5566 SERIES
5569 SERIES
3. (METRIC) VALUES SHOWN GOVERN OVER ENGLISH CONVERSION VALUES.
△ TO BE MEASURED AT POSITION OF □ SURFACE.

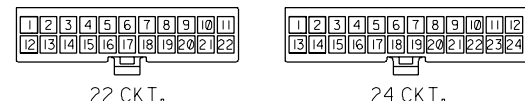
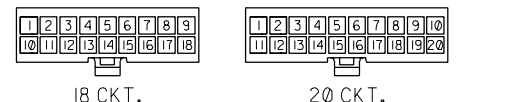
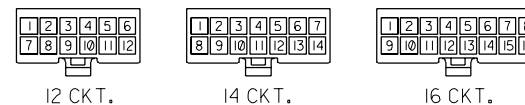
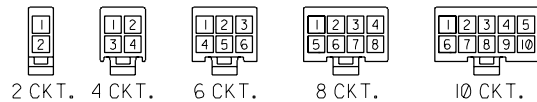

CIRCUIT SIZE LAYOUT
(SCALE: 1-1)

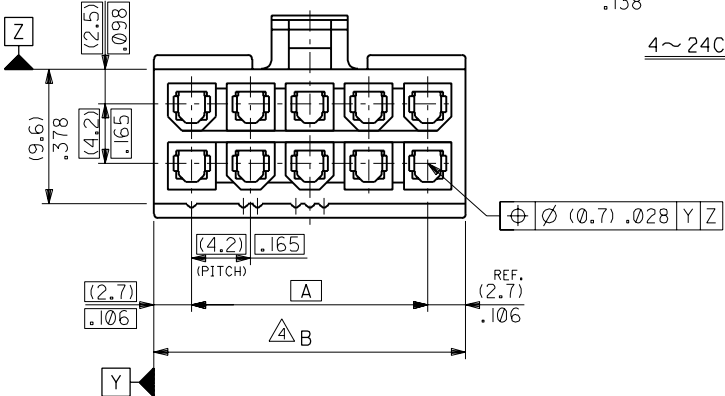
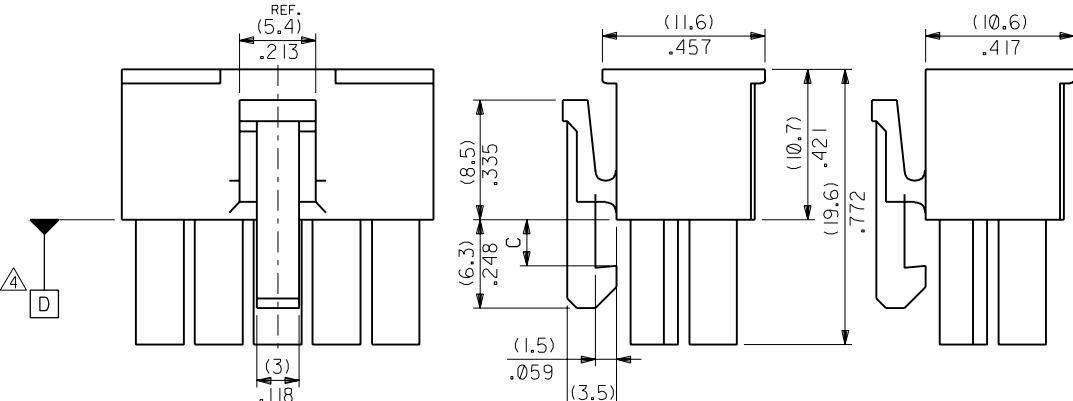

4~24CKT.

2CKT.

	(51.6)	2.031	(46.2)	1.819	39-01-2245	5557-24R-210	24
(3,6)	(47.4)	1.866	(42)	1.654	↑ -2225	↑ -22R-210	22
.142	(43.2)	1.701	(37.8)	1.488	-2205	-20R-210	20
	(39)	1.535	(33.6)	1.323	-2185	-18R-210	18
	(34.8)	1.37	(29.4)	1.158	-2165	-16R-210	16
	(30.6)	1.205	(25.2)	.992	-2145	-14R-210	14
	(26.4)	1.039	(21)	.827	-2125	-12R-210	12
(3,3)	(22.2)	.874	(16.8)	.661	-2105	-10R-210	10
.129	(18)	.709	(12.6)	.496	-2085	-08R-210	8
	(13.8)	.543	(8.4)	.331	-2065	-06R-210	6
	(9.6)	.378	(4.2)	.165	↓ -2045	↓ -04R-210	4
	(5.4)	.213	+	+	39-01-2025	5557-02R-210	2
					A		
	C	B	A		EDP. NO.	ENG. NO.	NO. OF CKTS.

材料 MATERIAL 66NYLON (UL94V-0)		MOLEX JAPAN CO.,LTD. 日本モレックス株式会社	
F	REVISED (JC70586)	S.A. M.F.	9/11/8
E	REVISED (J20158)	H.H.	9/24/20
D	REVISED (J01160)	H.H. Y.Y.	9/01/18
C	REVISED & REDRAWN (J00192)	S.M. H.H.	9/02/22
DRAWN BY 9/02/22 S.MOCHIZUKI		CHK'D BY 9/10/08 M.FUKUSHIMA	
APP'D BY 9/07/08 M.FUKUSHIMA		尺度 SCALE 3 - 1	
REVISION RECORD		DATE	
LTR 変更内容		DR. CHK. 日付	
REVISION RECORD			
GENERAL TOLERANCES			
角度 ANGLE	±3°		
30° 以上 OVER	±0.3		
10° 以上 30° 未満 OVER	±0.25		
10° 未満 UNDER	±0.2		
一般公差 GENERAL TOLERANCES			

EDP. NO. 39-01-2**5	
ENG. NO. SD-5557-NR-210	
REV F	
TITLE 名称 NEW MINI FIT CONN. REC. HOUSING	

THIS DRAWING CONTAINS INFORMATION THAT IS PROPRIETARY TO MOLEX(JAPAN) AND SHOULD NOT BE USED WITHOUT WRITTEN PERMISSION
本図面は日本モレックス(株)の所有する情報を含むもので 会社の許可なく複製を禁止する。

MXJ-8