

FEATURES AND SPECIFICATIONS

Features and Benefits

- RJ-45 version meets Category 5 for Fast Ethernet
- Plug latch on top
- Shortened leads with bottom contacts
- Pin and paste solderability
- Shielding meets IEC 950, UL 1863 and CSA 233
- Enhanced panel grounding tabs on shield
- Continuity

Reference Information

Product Specification: PS-43860-001

Packaging:

Unshielded—Tube

Shielded—Tray

UL File No.: E107635

CSA File No.: LR19980

Mates With: FCC 68 plugs

Designed In: Inches

Electrical

Voltage: 125V

Current: 1.5A

Contact Resistance: 10mΩ max.

Dielectric Withstanding Voltage: 1000V AC

Insulation Resistance: 500 MΩ min.

Mechanical

Durability: 500 cycles min.

Physical

Housing: Black glass-filled, high-temperature nylon, UL 94V-0

Contact: Gold per FCC 68.5 specification

Plating: 1.27μm (50μ") min. Gold in contact area and 1.27μm (50μ") Tin/Lead on solder tails both over Nickel overall

Operating Temperature: -40 to +80°C

molex® Modular Jack

43860

**Right Angle, Low Profile
Inverted, Shielded and
Unshielded Versions**

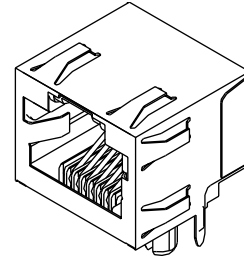

CATALOG DRAWING (FOR REFERENCE ONLY)

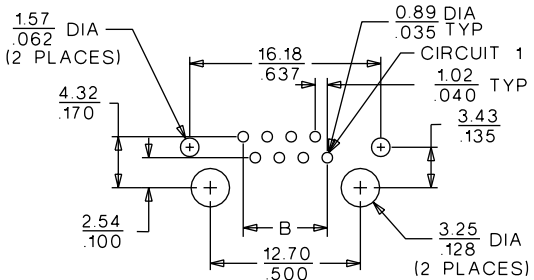
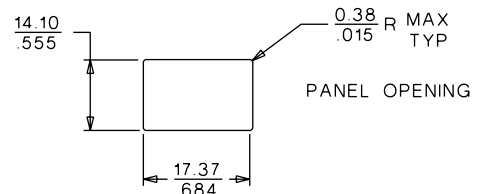
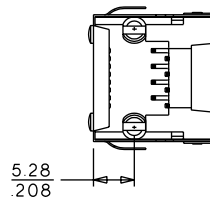
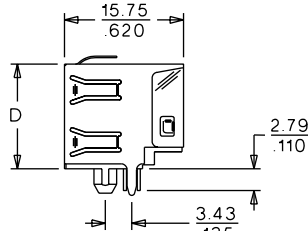
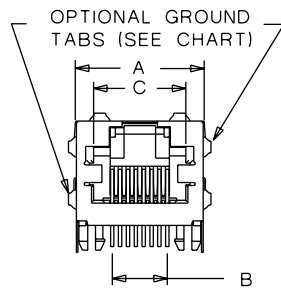

PCB LAYOUT : COMPONENT SIDE
RECOMMENDED PCB THICKNESS : 1.57 / .062

ORDERING INFORMATION AND DIMENSIONS

Circuits	Loaded Contacts	Order No.		Dimension				
		Unshielded	Shielded		A	B	C	D
			With All Panel Grounding Tabs	With Offset Panel Grounding Tabs				
6	2	43860-0020			15.75 (.620)	1.02 (.040)	9.88 (.389)	13.21 (.520)
6	4	43860-0003			15.75 (.620)	3.05 (.120)	9.88 (.389)	13.21 (.520)
6	4		43860-0006		16.38 (.645)	3.05 (.120)	9.88 (.389)	13.54 (.533)
6	4			43860-0015	16.38 (.645)	3.05 (.120)	9.88 (.389)	13.54 (.533)
6	6	43860-0002			15.75 (.620)	5.08 (.200)	9.88 (.389)	13.21 (.520)
6	6		43860-0005		16.38 (.645)	5.08 (.200)	9.88 (.389)	13.54 (.533)
6	6			43860-0014	16.38 (.645)	5.08 (.200)	9.88 (.389)	13.54 (.533)
8	8	43860-0001			15.75 (.620)	7.11 (.280)	11.91 (.469)	13.21 (.520)
8	8		43860-0004		16.38 (.645)	7.11 (.280)	11.91 (.469)	13.54 (.533)
8	8			43860-0013	16.38 (.645)	7.11 (.280)	11.91 (.469)	13.54 (.533)