

CIRCUIT SIZE	44428		
	A	B	C
04	.512 13.00	.118 3.00	NA
06	.630 16.00	.236 6.00	NA
08	.748 19.00	.354 9.00	.184 4.68
10	.866 22.00	.472 12.00	.302 7.68
12	.984 25.00	.590 15.00	.420 10.68
14	1.102 28.00	.709 18.00	.539 13.68
16	1.220 31.00	.827 21.00	.657 16.68
18	1.338 34.00	.945 24.00	.775 19.68
20	1.457 37.00	1.063 27.00	.893 22.68
22	1.575 40.00	1.181 30.00	1.011 25.68
24	1.693 43.00	1.299 33.00	1.129 28.68

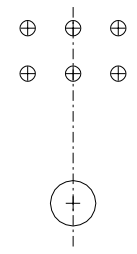
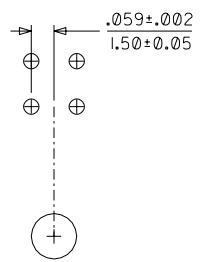
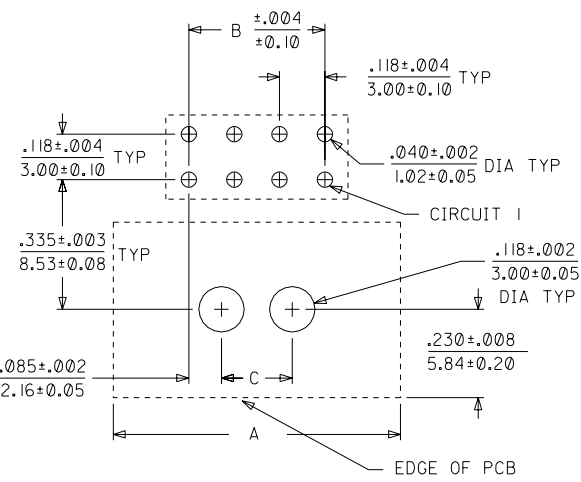
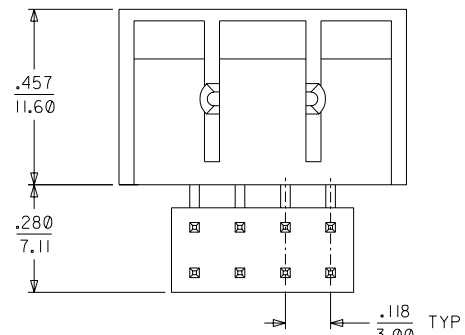

PCB LAYOUT: COMPONENT SIDE  
4 CIRCUIT ONLY

PCB LAYOUT: COMPONENT SIDE  
6 CIRCUIT ONLY

PCB LAYOUT: COMPONENT SIDE  
RECOMMENDED PCB THICKNESS .062/1.57  
8 THRU 24 CIRCUITS

NOTES :

- MATERIALS -  
HOUSING : NYLON , GLASS-FILLED, UL94V-0 COLOR - BLACK  
TERMINAL : BRASS ALLOY  
TERMINAL POSITIONING STRIP : MYLAR, COLOR - NATURAL
- FINISH:  
A= .000200/(0.0051) TIN OVER .000050/(0.0013) NICKEL.  
B= .000015/(0.00038) MIN GOLD IN SELECTIVE AREA;  
.000050/(0.0013) MIN TIN-LEAD (90/10) ON SOLDER TAILS  
BOTH OVER .000050/(0.0013) NICKEL.  
C= .000030/(0.00076) MIN GOLD IN SELECTIVE AREA;  
.000050/(0.0013) MIN TIN-LEAD (90/10) ON SOLDER TAILS  
BOTH OVER .000050/(0.0013) NICKEL.
- PRODUCT SPECIFICATION : PS-44300-001
- PACKAGING SPECIFICATION : PK-44428-001
- THIS ASSEMBLY MATES WITH MOLEX BMI PANEL MOUNT RECEPTACLE  
(SEE DRAWING SD-44133-001) & FEMALE CRIMP TERMINAL (SEE DRAWING SD-43030-\*\*\*\*)

ADD 4-24 CKT VIEW  
EC NO. UCP2003-1965  
DRAWN: MUELLER 03/03/74  
CHK: MUELLER 03/03/74  
APPR: MARGULIS 03/03/74

REV	DESCRIPTION
1	MAJOR
2	CRITICAL

QUALITY SYMBOLS  
MAJOR = 0  
CRITICAL = 0

GENERAL TOLERANCES: (UNLESS SPECIFIED)

	mm	INCH
4 PLACES	±0.	±.
3 PLACES	±0.	±.010
2 PLACES	±0.25	±.015
1 PLACE	±0.38	±.

ANGULAR: ±2 °

DRAFT WHERE APPLICABLE MUST REMAIN WITHIN DIMENSIONS

SCALE 4 : 1  
DESIGN UNITS  mm  INCH

DRAWN BY & DATE  
MUELLER 99/11/29

CHECKED BY & DATE  
MUELLER 99/11/29

APPROVED BY & DATE  
R EDGLEY 99/11/30

CAD FILENAME

DIMENSIONS:  
 mm  INCH  mm ONLY

THIRD ANGLE PROJECTION

TITLE: MICRO-FIT (3.0)  
DUAL ROW RIGHT ANGLE  
BMI HEADER - ASS'Y

MOLEX MOLEX INCORPORATED

MATERIAL NO. SEE CHART	DRAWING NO. SD-44428-001	SHEET NO. 1 OF 2
---------------------------	-----------------------------	---------------------

THIS DRAWING CONTAINS INFORMATION THAT IS PROPRIETARY TO MOLEX INCORPORATED AND SHOULD NOT BE USED WITHOUT WRITTEN PERMISSION.

MATERIAL NUMBER	NUMBER OF CIRCUITS	FINISH OPTION	RETENTION PEG OPTION
44428-0401	04	A	YES
44428-0402	04	B	YES
44428-0403	04	C	YES
44428-0404	04	A	NO
44428-0405	04	B	NO
44428-0406	04	C	NO
44428-0601	06	A	YES
44428-0602	06	B	YES
44428-0603	06	C	YES
44428-0604	06	A	NO
44428-0605	06	B	NO
44428-0606	06	C	NO
44428-0801	08	A	YES
44428-0802	08	B	YES
44428-0803	08	C	YES
44428-0804	08	A	NO
44428-0805	08	B	NO
44428-0806	08	C	NO
44428-1001	10	A	YES
44428-1002	10	B	YES
44428-1003	10	C	YES
44428-1004	10	A	NO
44428-1005	10	B	NO
44428-1006	10	C	NO
44428-1201	12	A	YES
44428-1202	12	B	YES
44428-1203	12	C	YES
44428-1204	12	A	NO
44428-1205	12	B	NO
44428-1206	12	C	NO
44428-1401	14	A	YES
44428-1402	14	B	YES
44428-1403	14	C	YES
44428-1404	14	A	NO
44428-1405	14	B	NO
44428-1406	14	C	NO

MATERIAL NUMBER	NUMBER OF CIRCUITS	FINISH OPTION	RETENTION PEG OPTION
44428-1601	16	A	YES
44428-1602	16	B	YES
44428-1603	16	C	YES
44428-1604	16	A	NO
44428-1605	16	B	NO
44428-1606	16	C	NO
44428-1801	18	A	YES
44428-1802	18	B	YES
44428-1803	18	C	YES
44428-1804	18	A	NO
44428-1805	18	B	NO
44428-1806	18	C	NO
44428-2001	20	A	YES
44428-2002	20	B	YES
44428-2003	20	C	YES
44428-2004	20	A	NO
44428-2005	20	B	NO
44428-2006	20	C	NO
44428-2201	22	A	YES
44428-2202	22	B	YES
44428-2203	22	C	YES
44428-2204	22	A	NO
44428-2205	22	B	NO
44428-2206	22	C	NO
44428-2401	24	A	YES
44428-2402	24	B	YES
44428-2403	24	C	YES
44428-2404	24	A	NO
44428-2405	24	B	NO
44428-2406	24	C	NO

POLARIZATION LAYOUT  
4-24 CIRCUITS

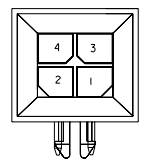

4 CIRCUIT

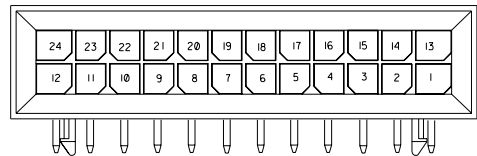

24 CIRCUIT

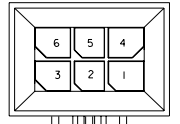

6 CIRCUIT

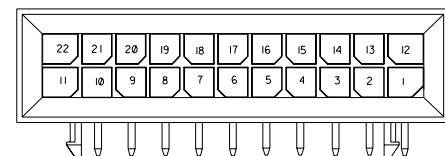

22 CIRCUIT

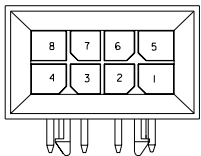

8 CIRCUIT

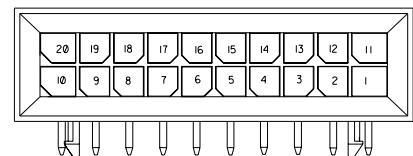

20 CIRCUIT

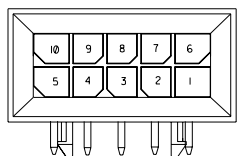

10 CIRCUIT

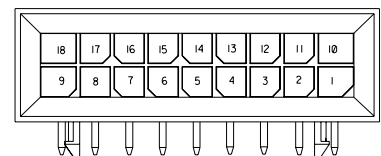

18 CIRCUIT

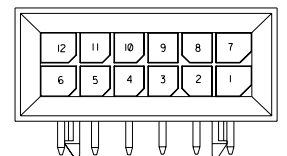

12 CIRCUIT

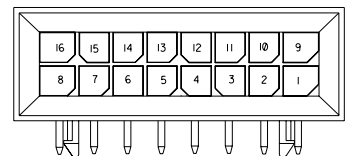

16 CIRCUIT

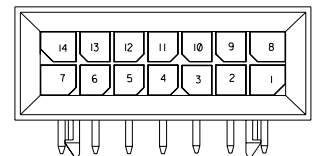

14 CIRCUIT

SEE SHEET 1 EC NO. / DRWN: / CHK: / APPR: / REV: /	DESCRIPTION MAJOR / CRITICAL / C /	QUALITY SYMBOLS	GENERAL TOLERANCES: (UNLESS SPECIFIED)	SCALE 4 : 1	DESIGN UNITS <input checked="" type="checkbox"/> mm <input type="checkbox"/> INCH	DIMENSIONS: <input type="checkbox"/> mm <input checked="" type="checkbox"/> INCH <input type="checkbox"/> mm <input type="checkbox"/> INCH SHT REV REVISE ON CAD ONLY	
		DRAWN BY & DATE MUELLER 99/11/29	CHECKED BY & DATE MUELLER 99/11/29	TITLE: MICRO-FIT (3.0) DUAL ROW RIGHT ANGLE BMI HEADER - ASS'Y			
		APPROVED BY & DATE R EDGLEY 99/11/30	MOLEX MOLEX INCORPORATED		MATERIAL NO. SEE CHART	DRAWING NO. SD-44428-001	SHEET NO. 2
		DRAFT WHERE APPLICABLE MUST REMAIN WITHIN DIMENSIONS		THIS DRAWING CONTAINS INFORMATION THAT IS PROPRIETARY TO MOLEX INCORPORATED AND SHOULD NOT BE USED WITHOUT WRITTEN PERMISSION.			