

CIRCUIT SIZE	44432		
	"A"	"B"	C
04	$\frac{.512}{13.00}$	$\frac{.118}{3.00}$	$\frac{.472}{12.00}$
06	$\frac{.630}{16.00}$	$\frac{.236}{6.00}$	$\frac{.590}{15.00}$
08	$\frac{.748}{19.00}$	$\frac{.354}{9.00}$	$\frac{.709}{18.00}$
10	$\frac{.866}{22.00}$	$\frac{.472}{12.00}$	$\frac{.827}{21.00}$
12	$\frac{.984}{25.00}$	$\frac{.590}{15.00}$	$\frac{.945}{24.00}$
14	$\frac{28.00}{1.102}$	$\frac{18.00}{.709}$	$\frac{27.00}{1.063}$
16	$\frac{1.220}{31.00}$	$\frac{.827}{21.00}$	$\frac{1.181}{30.00}$
18	$\frac{1.338}{34.00}$	$\frac{.945}{24.00}$	$\frac{1.299}{33.00}$
20	$\frac{1.457}{37.00}$	$\frac{1.063}{27.00}$	$\frac{1.417}{36.00}$
22	$\frac{1.575}{40.00}$	$\frac{1.181}{30.00}$	$\frac{1.535}{39.00}$
24	$\frac{1.693}{43.00}$	$\frac{1.299}{33.00}$	$\frac{1.653}{42.00}$

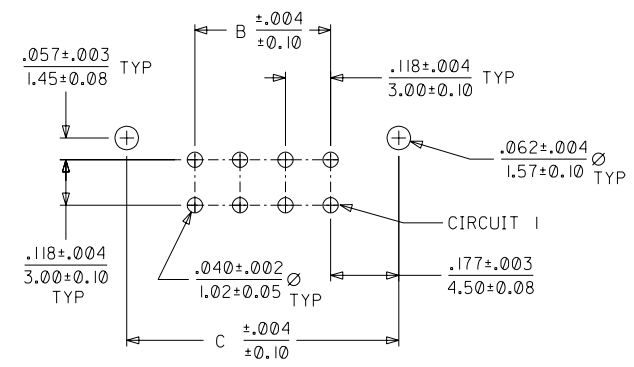
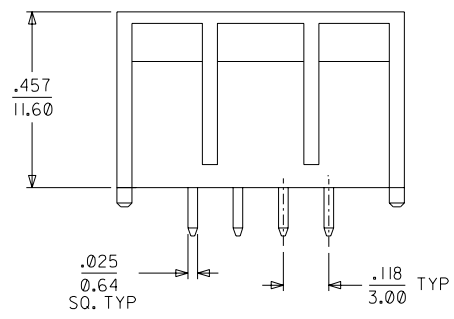
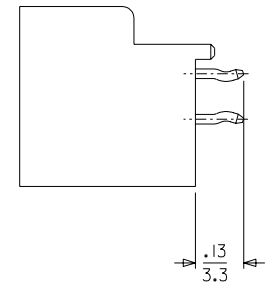
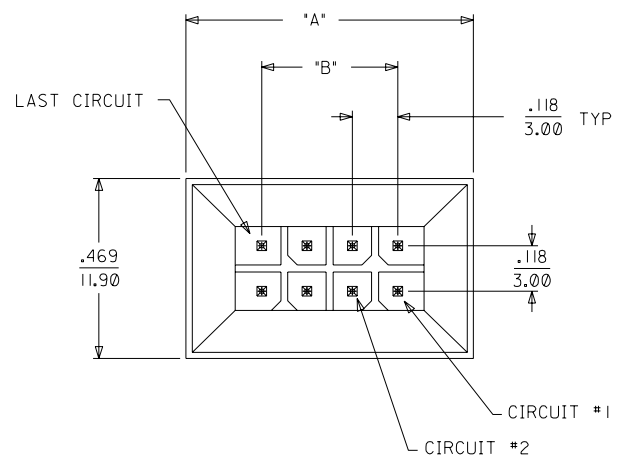

PCB LAYOUT: COMPONENT SIDE
RECOMMENDED PCB THICKNESS .062/1.57

NOTES :

- MATERIALS -
HOUSING : NYLON , GLASS-FILLED, UL94V-0 COLOR - BLACK
TERMINAL : BRASS ALLOY
- FINISH:
A= .000200/(0.0051) TIN OVER .000050/(0.0013) NICKEL.
B= .000015/(0.00038) MIN GOLD IN SELECTIVE AREA;
.000050/(0.0013) MIN TIN-LEAD (90/10) ON SOLDER TAILS
BOTH OVER .000050/(0.0013) NICKEL.
C= .000030/(0.00076) MIN GOLD IN SELECTIVE AREA;
.000050/(0.0013) MIN TIN-LEAD (90/10) ON SOLDER TAILS
BOTH OVER .000050/(0.0013) NICKEL.
- PRODUCT SPECIFICATION : PS-44300-001
- PACKAGING SPECIFICATION : PK-44432-001
- THIS ASSEMBLY MATES WITH MOLEX BMI PANEL MOUNT RECEPTACLE
(SEE DRAWING SD-44133-001) & FEMALE CRIMP TERMINAL (SEE DRAWING SD-43030-****)
- SEE SHEET 2 FOR PART NUMBER CHART.

ADD POARIZATION EC NO. UCP2003-1965 DRWN: MUELLER 03/03/14 CHK: MUELLER 03/03/14 APPR: MARGULIS 02/06/14	DESCRIPTION MAJOR QUALITY SYMBOLS CRITICAL	GENERAL TOLERANCES: (UNLESS SPECIFIED)	SCALE 4 : 1	DESIGN UNITS <input checked="" type="checkbox"/> mm <input type="checkbox"/> INCH	DIMENSIONS: <input type="checkbox"/> mm <input checked="" type="checkbox"/> INCH <input type="checkbox"/> mm ONLY		SHT	REV
		4 PLACES ±0. ±.	DRAWN BY & DATE MUELLER 99/11/29	THIRD ANGLE PROJECTION		2	C	
		3 PLACES ±0. ±.010	CHECKED BY & DATE MUELLER 99/11/29	TITLE: MICRO-FIT (3.0) DUAL ROW VERTICAL BMI HEADER - ASS'Y		1	C	
		2 PLACES ±0.25 ±.015	APPROVED BY & DATE R EDGLEY 99/11/30	MATERIAL NO. SEE CHART		1	C	
		1 PLACE ±0.38 ±.	CAD FILENAME	DRAWING NO. SD-44432-001		1	OF 2	
		ANGULAR: ±1 °	THIS DRAWING CONTAINS INFORMATION THAT IS PROPRIETARY TO MOLEX INCORPORATED AND SHOULD NOT BE USED WITHOUT WRITTEN PERMISSION.		SIZE C			

MATERIAL NUMBER	NUMBER OF POSITIONS	PLATING OPTION
44432-0401	04	A
44432-0402	04	B
44432-0403	04	C
44432-0601	06	A
44432-0602	06	B
44432-0603	06	C
44432-0801	08	A
44432-0802	08	B
44432-0803	08	C
44432-1001	10	A
44432-1002	10	B
44432-1003	10	C
44432-1201	12	A
44432-1202	12	B
44432-1203	12	C
44432-1401	14	A
44432-1402	14	B
44432-1403	14	C
44432-1601	16	A
44432-1602	16	B
44432-1603	16	C
44432-1801	18	A
44432-1802	18	B
44432-1803	18	C
44432-2001	20	A
44432-2002	20	B
44432-2003	20	C
44432-2201	22	A
44432-2202	22	B
44432-2203	22	C
44432-2401	24	A
44432-2402	24	B
44432-2403	24	C

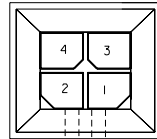

4 CIRCUIT

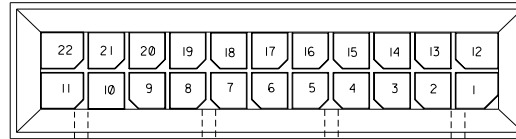

22 CIRCUIT

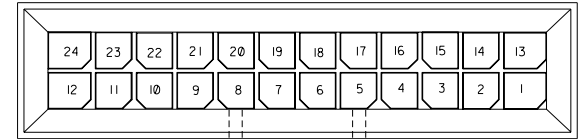

24 CIRCUIT

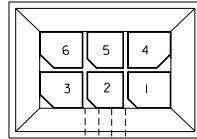

6 CIRCUIT

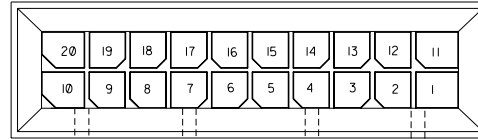

20 CIRCUIT

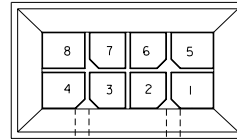

8 CIRCUIT

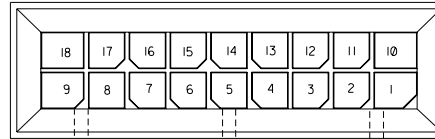

18 CIRCUIT

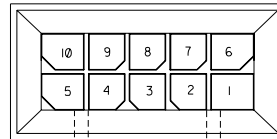

10 CIRCUIT

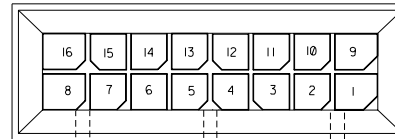

16 CIRCUIT

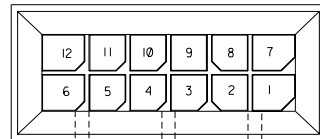

12 CIRCUIT

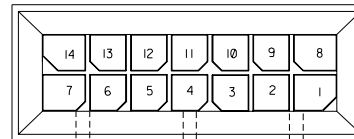

14 CIRCUIT

POLARIZATION LAYOUT
4-24 CIRCUITS

SEE SHEET 1 EC NO. / DRWN: / CHK: / APPR: / REV C	QUALITY SYMBOLS MAJOR $\blacktriangledown = 0$ CRITICAL $\blacktriangledown / C = 0$	GENERAL TOLERANCES: (UNLESS SPECIFIED) mm INCH 4 PLACES $\pm 0.$ $\pm .$ 3 PLACES $\pm 0.$ $\pm .010$ 2 PLACES ± 0.25 $\pm .015$ 1 PLACE ± 0.36 $\pm .$ ANGULAR: $\pm 1^\circ$	SCALE 4 : 1 DESIGN UNITS <input checked="" type="checkbox"/> mm <input type="checkbox"/> INCH THIRD ANGLE PROJECTION <input type="checkbox"/> mm <input checked="" type="checkbox"/> INCH <input type="checkbox"/> ONLY	DIMENSIONS: <input type="checkbox"/> mm <input checked="" type="checkbox"/> INCH <input type="checkbox"/> ONLY SHT / REV REVISE ON CAD ONLY	
	DRAWN BY & DATE MUELLER 99/11/29 CHECKED BY & DATE MUELLER 99/11/29 APPROVED BY & DATE R EDGLEY 99/11/30	TITLE: MICRO-FIT (3.0) DUAL ROW VERTICAL BMI HEADER - ASS'Y	MATERIAL NO. SEE CHART	DRAWING NO. SD-44432-001	SHEET NO. 2
	CAD FILENAME	MOLEX INCORPORATED	THIS DRAWING CONTAINS INFORMATION THAT IS PROPRIETARY TO MOLEX INCORPORATED AND SHOULD NOT BE USED WITHOUT WRITTEN PERMISSION.	SIZE C	
	DRAFT WHERE APPLICABLE MUST REMAIN WITHIN DIMENSIONS				