

6

5

4

3

2

1

D

D

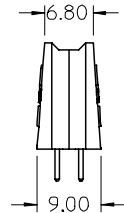
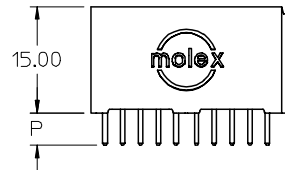
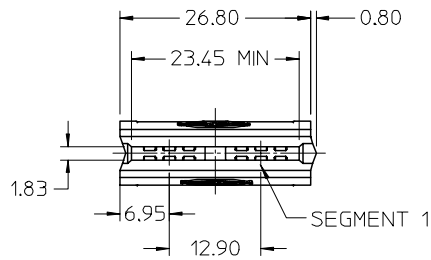

## NOTES:

- HOUSING MATL: LCP, UL94V-0, COLOR BLACK  
TERMINAL MATL: COPPER ALLOY
- FINISH: SELECT GOLD: 30 M.I. MIN IN CONTACT AREA  
SELECT TIN: 150 M.I. MIN IN SOLDER AREA  
OVERALL NICKEL UNDERPLATE.
- PRODUCT SPECIFICATION: PS-45719-001.
- PACKAGING SPECIFICATION: PK-45714-001.
- PCB THICKNESS: SEE CHART
- EDGE CARD THICKNESS: 1.57
- DIMENSIONS GIVEN ACROSS CENTERLINES ARE SYMMETRICAL  
ABOUT THOSE CENTERLINES WITHIN HALF TOTAL TOLERANCE.
- VOIDED SEGMENTS DO NOT HAVE TERMINALS IN THE TOP OR BOTTOM ROW

C

C

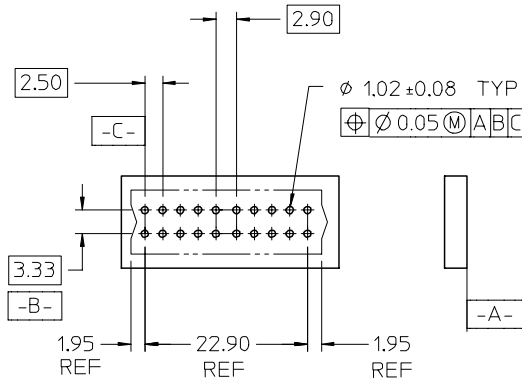

PCB LAYOUT: COMPONENT SIDE

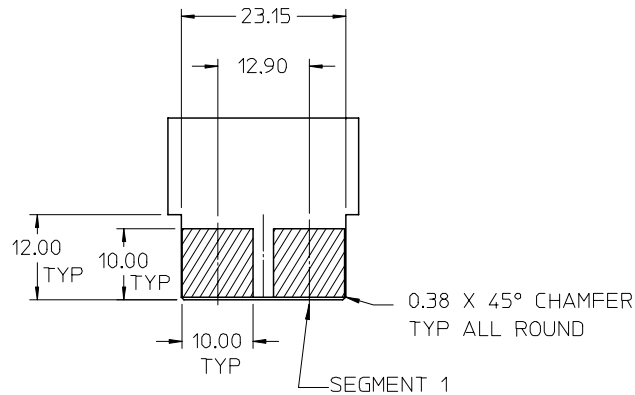
RECOMMENDED EDGE CARD LAYOUT  
TOLERANCE:  $\pm 0.05$ 

MATERIAL NUMBER	VOIDED SEGMENT	P	PCB THK
45719-0001	NONE		
45719-2001	1	4.50	3.18
45719-2002	2		
45719-0004	NONE		
45719-2003	1	3.63	2.36
45719-2004	2		
45719-0007	NONE		
45719-2005	1	2.92	1.57
45719-2006	2		

B

B

A

A

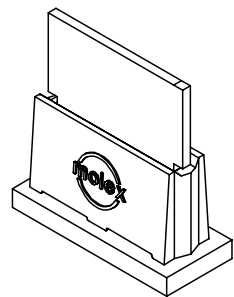

EC NO: UCP2005-2109 DRWN:KSAMIEC 2005/06/30 CHKD: 2005/06/30 APPR:APATEL 2005/07/07 DESCRIPTION	GENERAL TOLERANCES (UNLESS SPECIFIED)		DIMENSION STYLE MM ONLY		SCALE 1:1	DESIGN UNITS METRIC	THIRD ANGLE PROJECTION
		mm	INCH	DRAWN BY MARGUL IS	DATE 2003/11/11	TITLE POWER EDGE ASSEMBLY POWER VERTICAL SOLDER TAIL MOLEX INCORPORATED	
	4 PLACES	$\pm$ ---	$\pm$ ---	CHECKED BY	DATE		
	3 PLACES	$\pm$ ---	$\pm$ ---	MARGUL IS	2003/11/11		
2 PLACES	$\pm 0.25$	$\pm$ ---	APPROVED BY	DATE			
	1 PLACE	$\pm 0.25$	$\pm$ ---	MARGUL IS	2003/11/11	DOCUMENT NO. SD-45719-001	SHEET NO. 1 OF 3
	ANGULAR $\pm 1/2^\circ$		DRAFT WHERE APPLICABLE MUST REMAIN WITHIN DIMENSIONS		THIS DRAWING CONTAINS INFORMATION THAT IS PROPRIETARY TO MOLEX INCORPORATED AND SHOULD NOT BE USED WITHOUT WRITTEN PERMISSION		

5

4

3

2

1

6 5 4 3 2 1

NOTES:  
1. FOR ALL OTHER DIMENSIONS AND NOTES SEE SHEET 1.

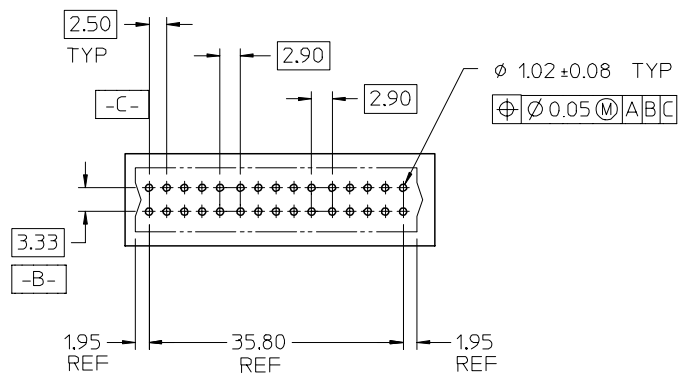
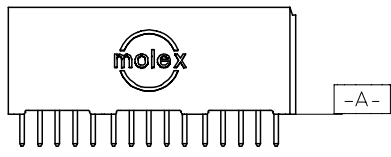
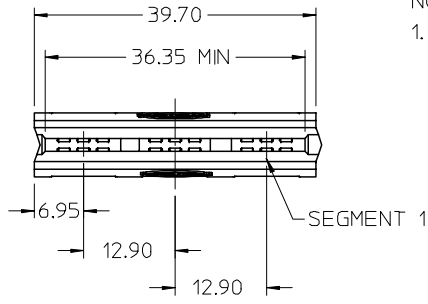

PCB LAYOUT: COMPONENT SIDE

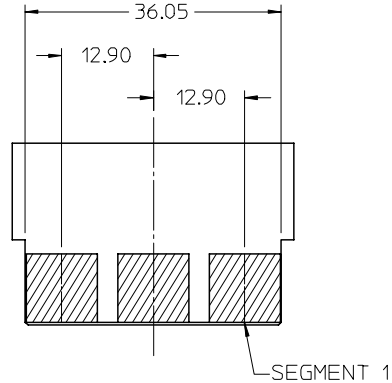

RECOMMENDED EDGE CARD LAYOUT  
EDGE CARD TOLERANCE:  $\pm 0.05$

MATERIAL NUMBER	VOIDED SEGMENT	P	PCB THK
45719-0002	NONE	4.50	3.18
45719-3001	1		
45719-3002	2		
45719-3003	3		
45719-3004	1,2		
45719-3005	1,3		
45719-3006	2,3	3.63	2.36
45719-0005	NONE		
45719-3007	1		
45719-3008	2		
45719-3009	3		
45719-3010	1,2		
45719-3011	1,3	2.92	1.57
45719-3012	2,3		
45719-0008	NONE		
45719-3013	1		
45719-3014	2		
45719-3015	3		
45719-3016	1,2		
45719-3017	1,3		
45719-3018	2,3		

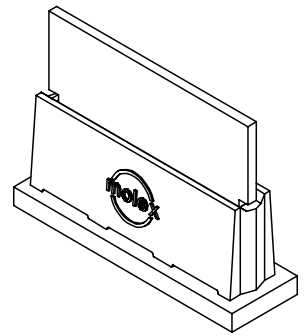

EC NO: UCP2005-2109 DRWN:KSAMIEC 2005/06/30 CHKD: 2005/06/30 APPR:APATEL 2005/07/07 DESCRIPTION	GENERAL TOLERANCES (UNLESS SPECIFIED)		DIMENSION STYLE MM ONLY		SCALE 1:1	DESIGN UNITS METRIC	THIRD ANGLE PROJECTION
		mm	INCH	DRAWN BY MARGUL IS	DATE 2003/11/11	TITLE POWER EDGE ASSEMBLY POWER VERTICAL SOLDER TAIL MOLEX INCORPORATED DOCUMENT NO. SD-45719-001 SHEET NO. 2	
	4 PLACES	$\pm$ ---	$\pm$ ---	CHECKED BY	DATE		
	3 PLACES	$\pm$ ---	$\pm$ ---	MARGUL IS	2003/11/11		
	2 PLACES	$\pm 0.25$	$\pm$ ---	APPROVED BY	DATE		
1 PLACE	$\pm 0.25$	$\pm$ ---	MARGUL IS	2003/11/11			
	ANGULAR $\pm 1/2^\circ$		DRAFT WHERE APPLICABLE MUST REMAIN WITHIN DIMENSIONS		SIZE A	THIS DRAWING CONTAINS INFORMATION THAT IS PROPRIETARY TO MOLEX INCORPORATED AND SHOULD NOT BE USED WITHOUT WRITTEN PERMISSION	

5 4 3 2 1

6 5 4 3 2 1

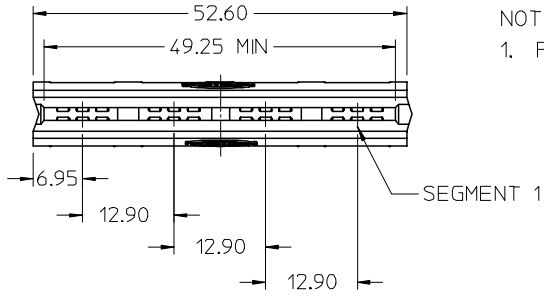

NOTES:  
1. FOR ALL OTHER DIMENSIONS AND NOTES SEE SHEET 1.

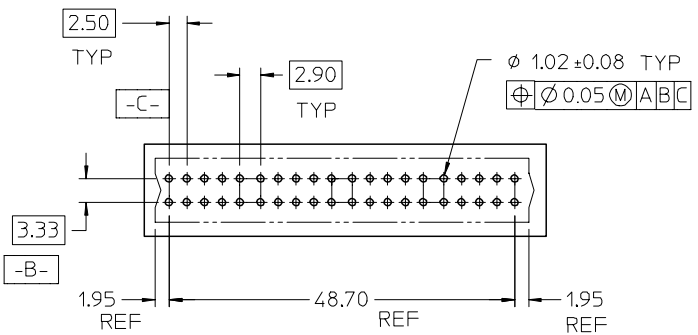
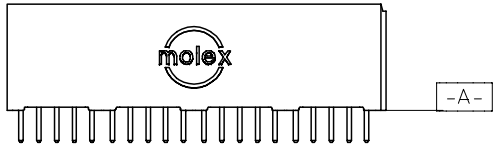

PCB LAYOUT: COMPONENT SIDE

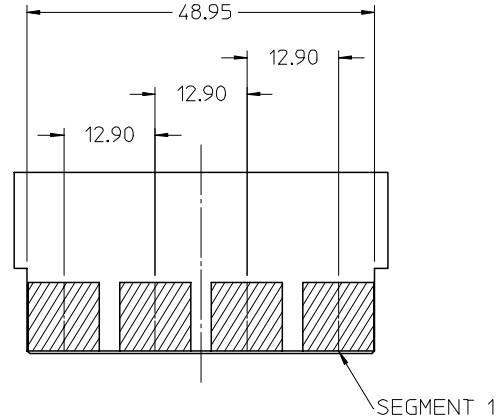

RECOMMENDED EDGE CARD LAYOUT  
EDGE CARD TOLERANCE:  $\pm 0.05$

MATERIAL NUMBER	VOIDED SEGMENT	P	PCB THK
45719-0003	NONE	4.50	3.18
45719-4001	1		
45719-4002	2		
45719-4003	3		
45719-4004	4		
45719-4005	1,2		
45719-4006	1,3		
45719-4007	1,4		
45719-4008	2,3		
45719-4009	2,4		
45719-4010	3,4		
45719-0006	NONE	3.63	2.36
45719-4011	1		
45719-4012	2		
45719-4013	3		
45719-4014	4		
45719-4015	1,2		
45719-4016	1,3		
45719-4017	1,4		
45719-4018	2,3		
45719-4019	2,4		
45719-4020	3,4		
45719-0009	NONE	2.92	1.57
45719-4021	1		
45719-4022	2		
45719-4023	3		
45719-4024	4		
45719-4025	1,2		
45719-4026	1,3		
45719-4027	1,4		
45719-4028	2,3		
45719-4029	2,4		
45719-4030	3,4		

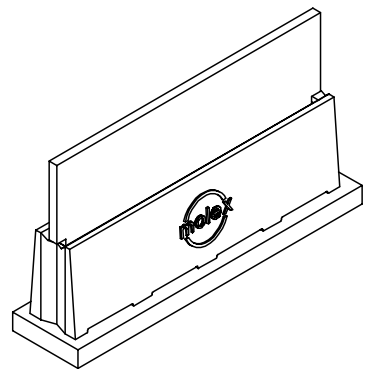

EC NO: UCP2005-2109	2005/06/30	2005/07/07	DESCRIPTION
DRWN:KSAMIEC	2005/06/30		
CHKD:			
APPR:APATEL			
REV			

GENERAL TOLERANCES (UNLESS SPECIFIED)			DIMENSION STYLE MM ONLY	
	mm	INCH	DRAWN BY	DATE
4 PLACES	$\pm$ ---	$\pm$ ---	MARGUL IS	2003/11/11
3 PLACES	$\pm$ ---	$\pm$ ---	CHECKED BY	DATE
2 PLACES	$\pm 0.25$	$\pm$ ---	MARGUL IS	2003/11/11
1 PLACE	$\pm 0.25$	$\pm$ ---	APPROVED BY	DATE
	ANGULAR $\pm 1/2^\circ$		MARGUL IS	2003/11/11

SCALE 1:1	DESIGN UNITS METRIC	THIRD ANGLE PROJECTION
TITLE POWER EDGE ASSEMBLY POWER VERTICAL SOLDER TAIL		
molex MOLEX INCORPORATED		
DOCUMENT NO. SD-45719-001	SHEET NO. 3	

DRAFT WHERE APPLICABLE  
MUST REMAIN  
WITHIN DIMENSIONS

SIZE A THIS DRAWING CONTAINS INFORMATION THAT IS PROPRIETARY TO MOLEX INCORPORATED AND SHOULD NOT BE USED WITHOUT WRITTEN PERMISSION

5 4 3 2 1