

NOTES:

1. MATERIAL: COPPER ALLOY
2. PLATING: BRIGHT TIN  
2.54 MICROMETERS TIN (MIN)  
OVER 0.76 MICROMETERS (MIN) NICKEL
3. FOR DETAILS OF PCB AND BEZEL LAYOUT REFER  
TO DOCUMENT SD-73927-100.
4. THIS PRODUCT NOT INTENDED FOR LEAD FREE, (RoHS). REFLOW PROCESS.  
REFLOW TEMPERATURE SHOULD NOT EXCEED 180°C
5. FOR RoHS COMPLIANT REPLACEMENTS REFER TO MOLEX SERIES 74737.

ENTER DESCRIPTION IEC NO. LIST 2004-0264 DRWNSHMONSON 2006/07/03 CHROBRUSSELL 2006/07/04 APPROVED DESCRIPTION A	QUALITY SYMBOLS	GENERAL TOLERANCES (UNLESS SPECIFIED)	DIMENSION STYLE	SCALE	DESIGN UNITS	THIRD ANGLE PROJECTION
	$\nabla=0$ $\nabla=0$	mm INCH 4 PLACES ± --- ± --- 3 PLACES ± --- ± .005 2 PLACES ± 0.13 ± .01 1 PLACE ± 0.25 ± --- ANGULAR ± 1 °	DRAWN BY DATE KS MONSON 2005/10/12 CHECKED BY DATE BRUSSELL 2005/10/12 APPROVED BY DATE BRUSSELL 2005/10/12	4:1	METRIC	<input checked="" type="checkbox"/> THIRD ANGLE <input type="checkbox"/> PROJECTION
	DRAFT WHERE APPLICABLE MUST REMAIN WITHIN DIMENSIONS	MATERIAL NO. 739270020	DOCUMENT NO. SD-73927-0020	MOLEX INCORPORATED		SHEET NO. 1 OF 1
	THIS DRAWING CONTAINS INFORMATION THAT IS PROPRIETARY TO MOLEX INCORPORATED AND SHOULD NOT BE USED WITHOUT WRITTEN PERMISSION					

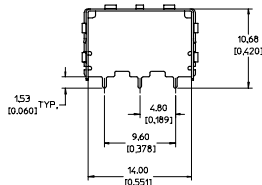
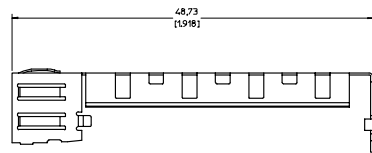
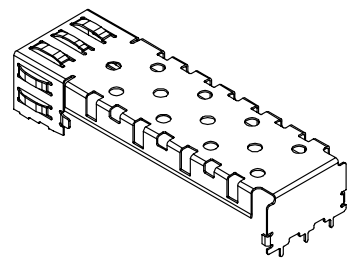
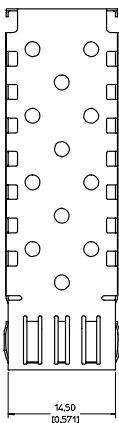

NOTES:

1. MATERIAL: COPPER ALLOY
2. PLATING: BRIGHT TIN  
2.54 MICROMETERS TIN (MIN)  
OVER 0.76 MICROMETERS (MIN) NICKEL
3. FOR DETAILS OF PCB AND BEZEL LAYOUT REFER  
TO DOCUMENT SD-73927-100.
4. THIS PRODUCT NOT INTENDED FOR LEAD FREE, REFLOW PROCESS.  
REFLOW TEMPERATURE SHOULD NOT EXCEED 180°C. FOR  
REFLOW PROCESSES GREATER THAN 180°C, REFER TO MOLEX  
SERIES 74737.

ENTER DESCRIPTION EC NO: CDR: APPR: DATE:	QUALITY SYMBOLS 	GENERAL TOLERANCES (UNLESS SPECIFIED) mm INCH 4 PLACES ± --- ± --- 3 PLACES ± --- ± .005 2 PLACES ± 0.13 ± .01 1 PLACE ± 0.25 ± --- ANGULAR ± 1 °	DIMENSION STYLE MM/IN DRAWN BY: KS MONSON DATE: 2005/10/12 CHECKED BY: BRUSSELL DATE: 2005/10/12 APPROVED BY: BRUSSELL DATE: 2005/10/12 MATERIAL NO: 739270020	SCALE 4:1 DESIGN UNITS METRIC THIRD ANGLE PROJECTION	TITLE SFP CAGE COVER	
	DRAFT WHERE APPLICABLE MUST REMAIN WITHIN DIMENSIONS		MATERIAL NO: 739270020	MOLEX INCORPORATED	DOCUMENT NO: SD-73927-020	
	THIS DRAWING CONTAINS INFORMATION THAT IS PROPRIETARY TO MOLEX INCORPORATED AND SHOULD NOT BE USED WITHOUT WRITTEN PERMISSION		SIZE: D	SHEET NO: 1 OF 1		
	ENTER DESCRIPTION: SFP CAGE COVER					