

PART NO. 85511-0001
 DWG. NO. SD-85511-001

NOTES :

1- MATERIAL:

-HOUSING: POLYESTER FIBER GLASS FILLED UL 94-V0
 COLOR BLACK.

-TERMINAL: PHOSPHOR BRONZE.

PLATING :

POST PLATE 0.00127-0.00152/.000050-.000060 GOLD IN
 CONTACT AREA , 0.00190/.000075 MIN (90/10) TIN/LEAD
 IN TAIL AREA BOTH OVER 0.00127/.000050 MIN NICKEL
 OVERALL.

- 2- JACK FOR MATING WITH F.C.C. 68 PLUGS (90075 MOLEX SERIES).
- 3- PRODUCT SPECIFICATION PS-95003 AND PS-85505 (SECTION 5.2).
- 4- APPLICATION SPECIFICATION AS-95001.
- 5- PACKAGING SPECIFICATION PK-95003 SHEET 1:
 (TRAY PACKAGING).
- 6- EXCEEDS CATEGORY 5 PERFORMANCE.

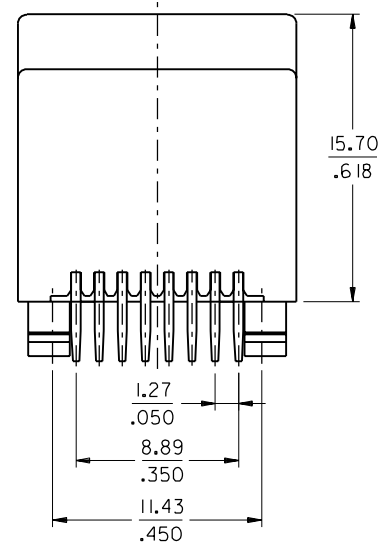
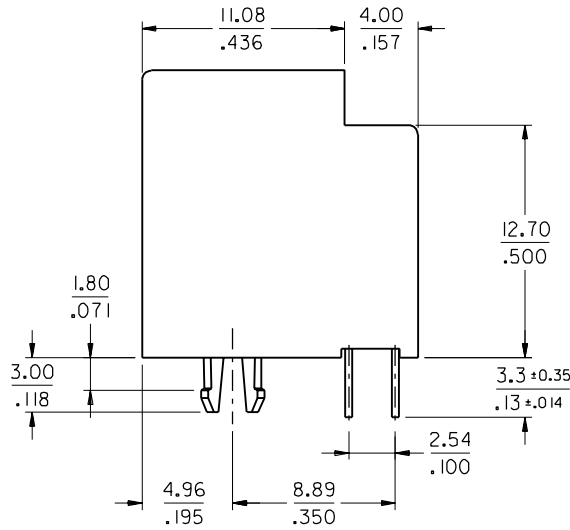
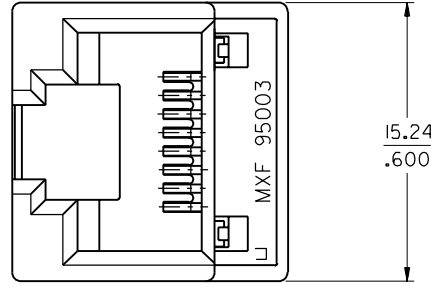

P.C.B. MOUNTING PATTERN
 (see from component side)

SCALE 2:1

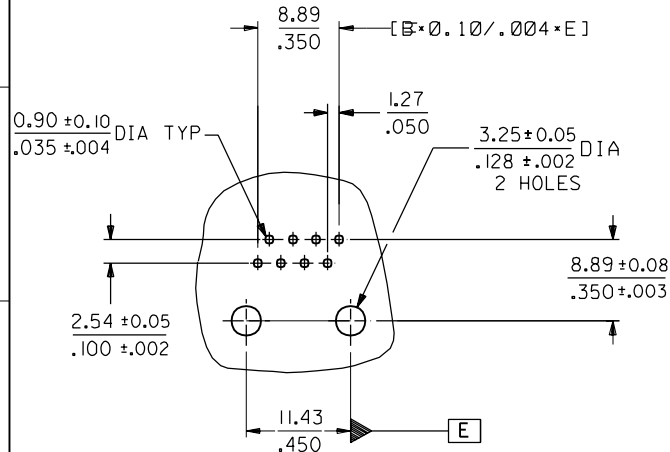

EC NO. MC2000-0059 DRWN: HB 99/08/99 CHK: Er APPR: FB	DESCRIPTION MAJOR = CRITICAL = C =	QUALITY SYMBOLS	GENERAL TOLERANCES: (UNLESS SPECIFIED)		SCALE 4:1	DESIGN UNITS <input checked="" type="checkbox"/> mm <input type="checkbox"/> INCH	THIRD ANGLE PROJECTION <input type="checkbox"/> mm <input type="checkbox"/> INCH <input checked="" type="checkbox"/> mm ONLY	SHT REV
			4 PLACES ±0. ±. 3 PLACES ±0. ±.006 2 PLACES ±0.15 ±.010 1 PLACE ±0.25 ±. ANGULAR: ± 1/2°	DRAWN BY & DATE HB 99/08/18	CHECKED BY & DATE Er / /	APPROVED BY & DATE FB / /	TITLE: HIGH SPEED MODULAR JACK TOP ENTRY LOW PROFILE THROUGH HOLE 8 CIRCUITS MOLEX INCORPORATED	REVISE ON CAD ONLY
A	REV	DRAFT WHERE APPLICABLE MUST REMAIN WITHIN DIMENSIONS	THIS DRAWING CONTAINS INFORMATION THAT IS PROPRIETARY TO MOLEX INCORPORATED AND SHOULD NOT BE USED WITHOUT WRITTEN PERMISSION.		CAD FILENAME	MATERIAL NO. 85511-0001	DRAWING NO. SD-85511-001	SHEET NO. 1 OF 1