

10 9 8 7 6 5 4 3 2 1

F

E

D

C

B

A

F

E

D

C

B

A

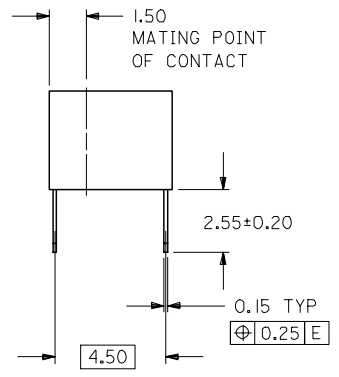
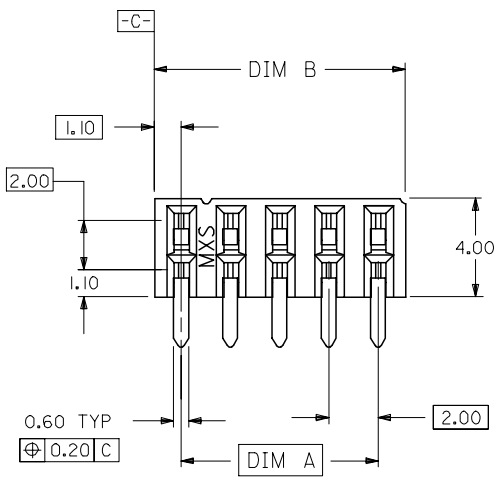

PART NO. LEGEND

87264- * * 5 *
 CIRCUIT SIZE PLATING
 POST-PLATED

- 2 - 0.38um/15uin MIN. GOLD PLATE IN SELECTED AREA AND 2.54um/100uin MIN. TIN IN SELECTED AREA OVER 1.27um/50uin NICKEL OVERALL (IN TUBE).
- 3 - 0.76um/30uin MIN. GOLD PLATE IN SELECTED AREA AND 2.54um/100uin MIN. TIN IN SELECTED AREA OVER 1.27um/50uin NICKEL OVERALL (IN TUBE).
- 8 - 0.38um/15uin MIN. GOLD PLATE IN SELECTED AREA AND 2.54um/100uin MIN. TIN IN SELECTED AREA OVER 1.27um/50uin NICKEL OVERALL. (IN TAPE/REEL)
- 9 - 0.76um/30uin MIN. GOLD PLATE IN SELECTED AREA AND 2.54um/100uin MIN. TIN IN SELECTED AREA OVER 1.27um/50uin NICKEL OVERALL. (IN TAPE/REEL)

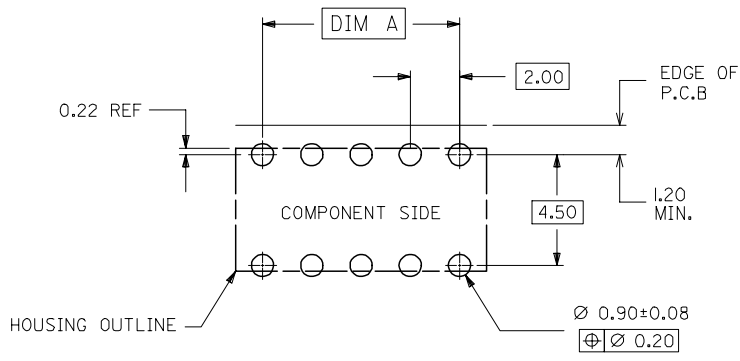
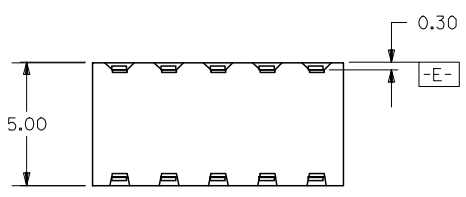

RECOMMENDED P.C. BOARD LAYOUT

- NOTES:
1. IO CIRCUIT SIZE SHOWN FOR ILLUSTRATION ONLY. SEE CHART FOR AVAILABLE PART SIZES.
 2. PLATING FINISH : TERMINAL - AS PER LEGEND
 3. RECOMMENDED PC BOARD THICKNESS IS 1.60 +/- 0.10mm.
 4. PRODUCT SPECIFICATION PS-87264 APPLIES.
 5. PART IS MATEABLE TO ALL MILLI-GRID HEADERS WITH MATING PIN LENGTH BETWEEN 2.50mm AND 4.20mm.
 6. TAPE & REEL OPTION IS SHOWN ON SHT 3 WITH 8 CKT ILLUSTRATION.
 7. PARTS SHALL BE PACKED IN MOISTURE BARRIER BAG.

| | | | | | | | | | |
|--|--|--------------------|---|---|--------------------------------|--------------------------------|---------------------|--|---|
| ADD NOTE 7. EC NO: S2008-0422 DRWN:SKANG CHKD:ATSEE APPR:MLONG | 2007/11/20 2007/11/20 2007/11/22 | DESCRIPTION REV | QUALITY SYMBOLS | GENERAL TOLERANCES (UNLESS SPECIFIED) | DIMENSION STYLE | SCALE | DESIGN UNITS | THIRD ANGLE PROJECTION | |
| | | | ▽=0 ▽=0 | mm INCH 4 PLACES ± --- ± --- 3 PLACES ± --- ± --- 2 PLACES ± 0.2 ± --- 1 PLACE ± --- ± --- ANGULAR ± 3 ° | MM ONLY | NTS | METRIC | DRAWN BY DATE JWAN 1992/02/25 CHECKED BY DATE MLA1 1992/02/25 APPROVED BY DATE RWONG 1992/02/25 | TITLE MGRID, 2MM DUAL ROW HDR. SIDE ENTRY RECEPTACLE T/H |
| | | | DRAFT WHERE APPLICABLE MUST REMAIN WITHIN DIMENSIONS | SEE TABLE | MATERIAL NO. SD-87264-***50 | DOCUMENT NO. SD-87264-***50 | SHEET NO. 1 OF 3 | | |
| | | | THIS DRAWING CONTAINS INFORMATION THAT IS PROPRIETARY TO MOLEX INCORPORATED AND SHOULD NOT BE USED WITHOUT WRITTEN PERMISSION | | | | | | |

9 8 7 6 5 4 3 2 1

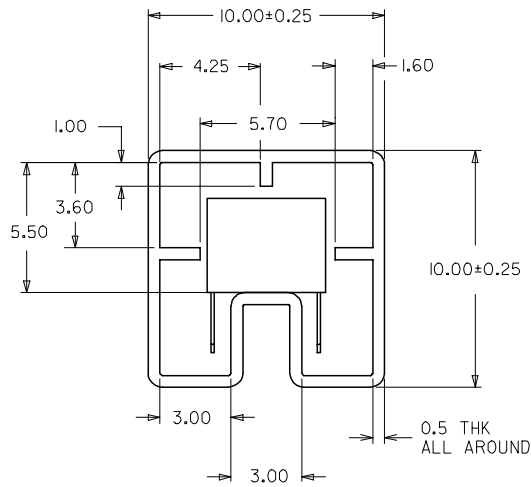
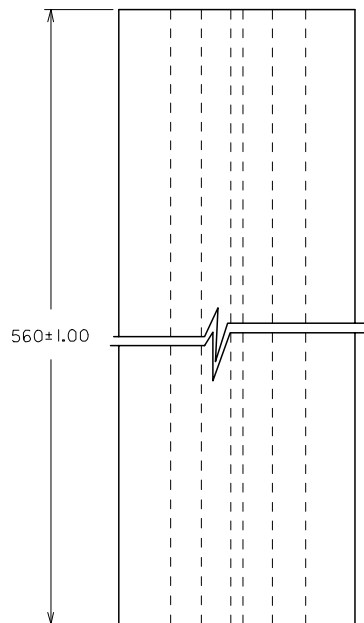

PART IN TUBE ORIENTATION.

| PART NUMBER 0.38um GOLD PLATING \triangle_2 | PART NUMBER 0.76um GOLD PLATING \triangle_2 | CKT. SIZE | DIM A | DIM B |
|---|---|--------------|-------|-------|
| 87264-065* | 87264-065* | 6 | 4.00 | 6.20 |
| 87264-085* | 87264-085* | 8 | 6.00 | 8.20 |
| 87264-105* | 87264-105* | 10 | 8.00 | 10.20 |
| 87264-125* | 87264-125* | 12 | 10.00 | 12.20 |
| 87264-145* | 87264-145* | 14 | 12.00 | 14.20 |
| 87264-165* | 87264-165* | 16 | 14.00 | 16.20 |
| 87264-185* | 87264-185* | 18 | 16.00 | 18.20 |
| 87264-205* | 87264-205* | 20 | 18.00 | 20.20 |
| 87264-225* | 87264-225* | 22 | 20.00 | 22.20 |
| 87264-245* | 87264-245* | 24 | 22.00 | 24.20 |
| 87264-265* | 87264-265* | 26 | 24.00 | 26.20 |
| 87264-285* | 87264-285* | 28 | 26.00 | 28.20 |
| 87264-305* | 87264-305* | 30 | 28.00 | 30.20 |
| 87264-325* | 87264-325* | 32 | 30.00 | 32.20 |
| 87264-345* | 87264-345* | 34 | 32.00 | 34.20 |
| 87264-365* | 87264-365* | 36 | 34.00 | 36.20 |
| 87264-385* | 87264-385* | 38 | 36.00 | 38.20 |
| 87264-405* | 87264-405* | 40 | 38.00 | 40.20 |
| 87264-425* | 87264-425* | 42 | 40.00 | 42.20 |
| 87264-445* | 87264-445* | 44 | 42.00 | 44.20 |
| 87264-465* | 87264-465* | 46 | 44.00 | 46.20 |
| 87264-485* | 87264-485* | 48 | 46.00 | 48.20 |
| 87264-505* | 87264-505* | 50 | 48.00 | 50.20 |

| ADD NOTE 7. EC NO: S2008-0422 DRWNS:KANG 2007/11/20 CHKD:ATSEE 2007/11/20 APPR:MLONG 2007/11/22 | QUALITY SYMBOLS | GENERAL TOLERANCES (UNLESS SPECIFIED) | DIMENSION STYLE | SCALE | DESIGN UNITS | THIRD ANGLE PROJECTION | | | | | | | | | | | | | | | | | | | |
|---|-----------------------------|---|-----------------|-------|--------------|------------------------|-------|--|----------|------------|-------------|----------|--------------------|-------|------------|--------------|--------------|-----------|-----------|----------------|--------|--|---------|---|--|
| | $\nabla=0$ $\triangle=0$ | <table border="1"> <thead> <tr> <th></th> <th>mm</th> <th>INCH</th> </tr> </thead> <tbody> <tr><td>4 PLACES</td><td>± ---</td><td>± ---</td></tr> <tr><td>3 PLACES</td><td>± ---</td><td>± ---</td></tr> <tr><td>2 PLACES</td><td>± 0.2</td><td>± ---</td></tr> <tr><td>1 PLACE</td><td>± ---</td><td>± ---</td></tr> </tbody> </table> | | mm | INCH | 4 PLACES | ± --- | ± --- | 3 PLACES | ± --- | ± --- | 2 PLACES | ± 0.2 | ± --- | 1 PLACE | ± --- | ± --- | MM ONLY | NTS | METRIC | | | | | |
| | | mm | INCH | | | | | | | | | | | | | | | | | | | | | | |
| | 4 PLACES | ± --- | ± --- | | | | | | | | | | | | | | | | | | | | | | |
| 3 PLACES | ± --- | ± --- | | | | | | | | | | | | | | | | | | | | | | | |
| 2 PLACES | ± 0.2 | ± --- | | | | | | | | | | | | | | | | | | | | | | | |
| 1 PLACE | ± --- | ± --- | | | | | | | | | | | | | | | | | | | | | | | |
| <table border="1"> <tr><td>DRAWN BY</td><td>DATE</td><td rowspan="2">TITLE</td></tr> <tr><td>JWAN</td><td>1992/02/25</td></tr> <tr><td>CHECKED BY</td><td>DATE</td><td rowspan="2">MGRID, 2MM DUAL ROW HDR. SIDE ENTRY RECEPTACLE T/H</td></tr> <tr><td>MLA1</td><td>1992/02/25</td></tr> <tr><td>APPROVED BY</td><td>DATE</td><td rowspan="2">MOLEX INCORPORATED</td></tr> <tr><td>RWONG</td><td>1992/02/25</td></tr> <tr><td>MATERIAL NO.</td><td>DOCUMENT NO.</td><td>SHEET NO.</td></tr> <tr><td>SEE TABLE</td><td>SD-87264-***50</td><td>2 OF 3</td></tr> </table> | DRAWN BY | DATE | TITLE | JWAN | 1992/02/25 | CHECKED BY | DATE | MGRID, 2MM DUAL ROW HDR. SIDE ENTRY RECEPTACLE T/H | MLA1 | 1992/02/25 | APPROVED BY | DATE | MOLEX INCORPORATED | RWONG | 1992/02/25 | MATERIAL NO. | DOCUMENT NO. | SHEET NO. | SEE TABLE | SD-87264-***50 | 2 OF 3 | DRAFT WHERE APPLICABLE MUST REMAIN WITHIN DIMENSIONS | SIZE A3 | THIS DRAWING CONTAINS INFORMATION THAT IS PROPRIETARY TO MOLEX INCORPORATED AND SHOULD NOT BE USED WITHOUT WRITTEN PERMISSION | |
| DRAWN BY | DATE | TITLE | | | | | | | | | | | | | | | | | | | | | | | |
| JWAN | 1992/02/25 | | | | | | | | | | | | | | | | | | | | | | | | |
| CHECKED BY | DATE | MGRID, 2MM DUAL ROW HDR. SIDE ENTRY RECEPTACLE T/H | | | | | | | | | | | | | | | | | | | | | | | |
| MLA1 | 1992/02/25 | | | | | | | | | | | | | | | | | | | | | | | | |
| APPROVED BY | DATE | MOLEX INCORPORATED | | | | | | | | | | | | | | | | | | | | | | | |
| RWONG | 1992/02/25 | | | | | | | | | | | | | | | | | | | | | | | | |
| MATERIAL NO. | DOCUMENT NO. | SHEET NO. | | | | | | | | | | | | | | | | | | | | | | | |
| SEE TABLE | SD-87264-***50 | 2 OF 3 | | | | | | | | | | | | | | | | | | | | | | | |

| | | | | | |
|---|---|-------------|-------|-------|--------|
| PART NUMBER 0.38um GOLD PLATING \triangle_2 (IN TAPE/REEL) | PART NUMBER 0.76um GOLD PLATING \triangle_2 (IN TAPE/REEL) | CKT SIZE | DIM W | DIM F | DIM Bo |
| 87264-085* | 87264-085* | 8 | 24.00 | 11.50 | 8.80 |

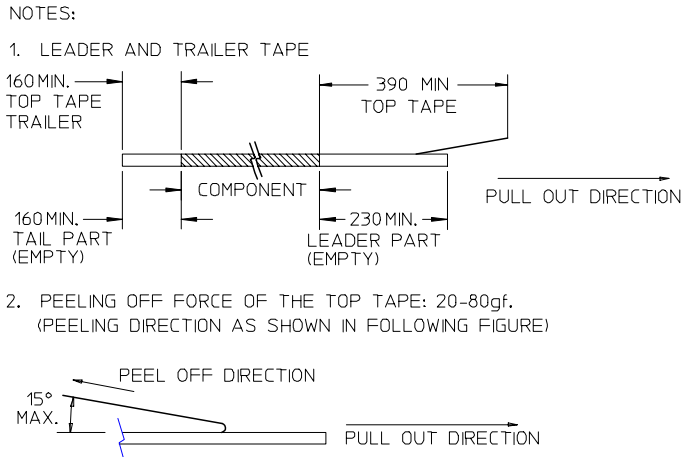
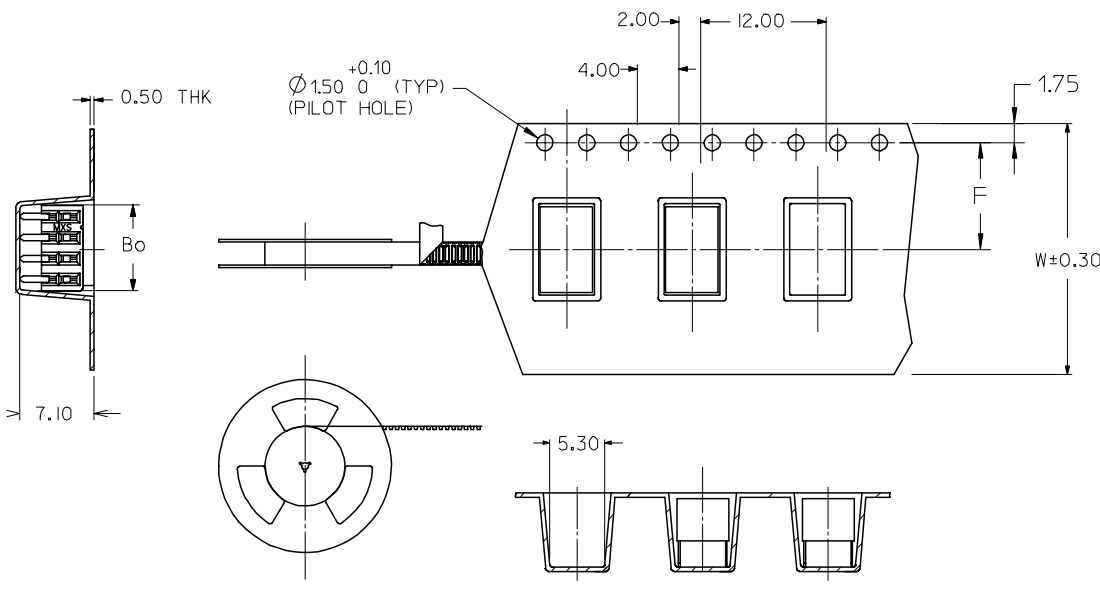

- PACKAGING STANDARD IS AS PER EIA-481.
- TAPE & REEL QUANTITY = 600PCS/REEL

CUSTOMER PULL OUT DIRECTION →

| ADD NOTE 7. EC NO: S2008-0422 DRWNS:KANG 2007/11/20 CHKD:ATSEE 2007/11/20 APPR:MLONG 2007/11/22 | QUALITY SYMBOLS | GENERAL TOLERANCES (UNLESS SPECIFIED) | DIMENSION STYLE | SCALE | DESIGN UNITS | THIRD ANGLE PROJECTION | | | | | | | | | | | | | | | |
|---|-----------------------------|---|--|-------|--|------------------------|-------|-------|----------|-------|-------|----------|-------|-------|---------|-------|-------|---------|-----|--------|--|
| | $\nabla=0$ $\triangle=0$ | <table border="1"> <tr> <th></th> <th>mm</th> <th>INCH</th> </tr> <tr> <td>4 PLACES</td> <td>± ---</td> <td>± ---</td> </tr> <tr> <td>3 PLACES</td> <td>± ---</td> <td>± ---</td> </tr> <tr> <td>2 PLACES</td> <td>± 0.2</td> <td>± ---</td> </tr> <tr> <td>1 PLACE</td> <td>± ---</td> <td>± ---</td> </tr> </table> | | mm | INCH | 4 PLACES | ± --- | ± --- | 3 PLACES | ± --- | ± --- | 2 PLACES | ± 0.2 | ± --- | 1 PLACE | ± --- | ± --- | MM ONLY | NTS | METRIC | |
| | | mm | INCH | | | | | | | | | | | | | | | | | | |
| | 4 PLACES | ± --- | ± --- | | | | | | | | | | | | | | | | | | |
| 3 PLACES | ± --- | ± --- | | | | | | | | | | | | | | | | | | | |
| 2 PLACES | ± 0.2 | ± --- | | | | | | | | | | | | | | | | | | | |
| 1 PLACE | ± --- | ± --- | | | | | | | | | | | | | | | | | | | |
| | | | DRAWN BY: JWAN DATE: 1992/02/25 CHECKED BY: MLA1 DATE: 1992/02/25 APPROVED BY: RWONG DATE: 1992/02/25 | TITLE | MGRID, 2MM DUAL ROW HDR. SIDE ENTRY RECEPTACLE T/H | | | | | | | | | | | | | | | | |
| | | DRAFT WHERE APPLICABLE MUST REMAIN WITHIN DIMENSIONS | SEE TABLE | | MOLEX INCORPORATED | SHEET NO. 3 OF 3 | | | | | | | | | | | | | | | |