

DESCRIPTION: **983 SERIES D-SUB BACKSHELL**

983-XXX-XXXRXX1

SERIES _____
 POSITIONS _____
 009
 015
 025
 037
 050
 MATERIAL _____
 010 = PLASTIC
 020 = METALIZED PLASTIC
 COLOR: _____
 01 = BLACK
 03 = Grey
 12 = NICKEL OVER COPPER
 PUT-UPS _____
 1 = KIT
 2 = BULK

BACKSHELL KIT INCLUDES:

- (2) BACKSHELL HALVES
- (1) YOKE
- (2) STRAIN RELIEF CLAMP
- (2) STRAIN RELIEF SCREWS
- (2) SADDLE WASHERS
- (2) 4-40 MOUNTING SCEWS (ROUND HEAD)

NOTE: 9 & 15 POSITION HAVE FINGER RIDGES AT TOP AND BOTTOM OF LOGO AREA

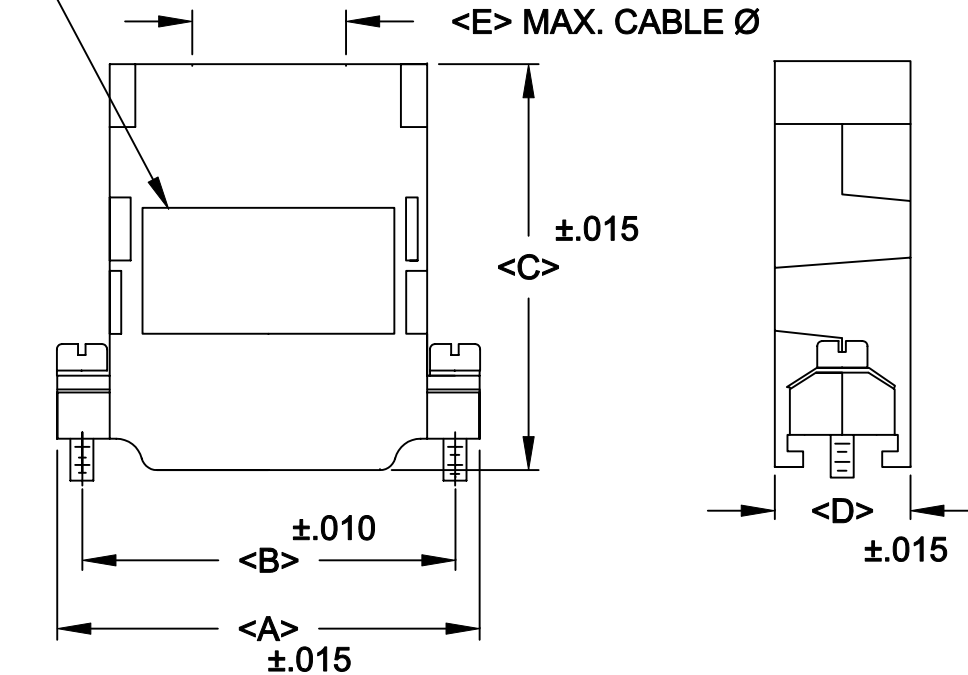

POS.	A	B	C	D	E
9	1.250	.984	1.929	.654	.270
	31.8	24.99	49.00	16.60	6.86
15	1.567	1.312	1.929	.630	.470
	39.8	33.32	49.00	16.00	11.94
25	2.122	1.852	1.925	.630	.470
	53.9	47.04	48.9	16.00	11.94
37	2.756	2.500	1.929	.638	.470
	70.00	63.50	49.00	16.20	11.94
50	2.756	2.406	1.929	.750	.470
	70.00	61.11	49.00	19.05	11.94

MATERIAL: THERMOPLASTIC
U/L 94V-0
(BLACK OR GREY)
IF PLATED: NICKEL OVER COPPER
RoHS COMPLIANT



THESE DRAWINGS AND SPECIFICATIONS ARE THE PROPERTY OF NorComp AND SHALL NOT BE REPRODUCED, COPIED OR USED AS THE BASIS FOR THE MANUFACTURE OR SALE OF APPARATUS WITHOUT WRITTEN PERMISSION.

DRAWN:
PAM JENKINS

DATE:
7-28-05

CHECKED:

DATE:

NorComp

SCALE _____ SHEET _____ OF _____ REV **1**

DWG NO. **983-XXX-0X0RXX1**