

# Type 151 Series Auto Reset Circuit Breaker Automotive Type I High Current - Waterproof



www.optifuse.com (619) 593-5050

## Specifications:

Voltage: 42 VDC Maximum  
Amperage: 25A, 30A, 40A, 50A, 60A, 70A, 80A, 90A, 100A,  
120A, 135A, 140A, 150A, 180A, 200A

Interrupt Rating: 3000A @ 30VDC

### Material:

Frame: Thermoset Plastic, UL rated 94-V0  
Stud Insulators: EPDM plastic

Mounting Torque: 40in-lb Max.  
Stud Torque: 50in-lb Max.

Designed to meet: SAE J1625; SAE J1171 (Ignition Protected)

**Part number format**  
**151xxx**

**Where xxx = Amperage**  
**025 through 200**



## Mechanical Dimensions: Inches [mm]

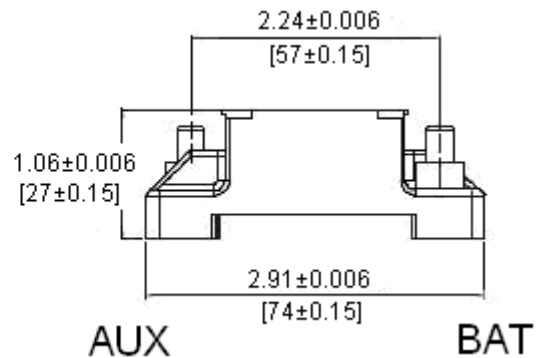
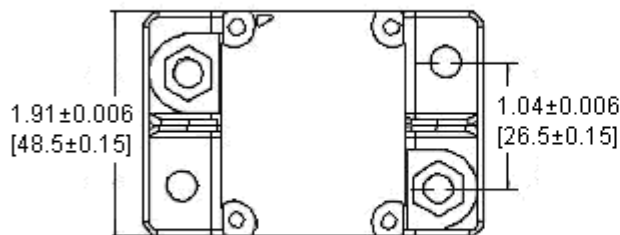

Stud size: 1/4", 28 thread per inch

### Warning:



-Operation beyond the specified maximum ratings or improper use may result in damage and possible electrical arcing and/or flame.  
-Device are intended for occasional overcurrent protection. Application for repeated overcurrent condition and/or prolonged trip are not anticipated.  
-Avoid contact of device with chemical solvent. Prolonged contact will damage the device performance.

**Type 151 Series  
Auto Reset Circuit Breaker  
Automotive Type I  
High Current - Waterproof**



www.optifuse.com (619) 593-5050

Time Characteristics:		
% of Rated Current	Min Hold Time	Max Hold Time
100%	No Trip	
135%		30m
200%	12s	45s
300%	3.5s	15s

