

THIS COPY IS PROVIDED ON A RESTRICTED BASIS AND IS NOT TO BE USED IN ANY WAY DETRIMENTAL TO THE INTERESTS OF PANDUIT CORP.

PANDUIT PART NUMBER	STUD SIZE	DIMENSIONS in.				
		A ±.03	W ±.01	C ±.02	M ±.03	H ±.01
PNF14-6FN-3K*	#6	.78 (19.81)	.24 (6.10)	.19 (4.83)	.64 (16.26)	.15 (3.81)
PNF14-6F-3K	#6	.78 (19.81)	.28 (7.11)	.19 (4.83)	.64 (16.26)	.15 (3.81)
PNF14-8F-3K	#8	.84 (21.33)	.31 (7.87)	.23 (5.84)	.68 (17.27)	.17 (4.32)
PNF14-10FN-3K*	#10	.86 (21.84)	.31 (7.87)	.24 (6.10)	.70 (17.78)	.20 (5.08)
PNF14-10F-3K	#10	.86 (21.84)	.34 (8.64)	.24 (6.10)	.70 (17.78)	.20 (5.08)
PNF14-14F-3K	1/4"	1.03 (26.16)	.44 (11.18)	.32 (8.13)	.78 (19.81)	.27 (6.86)

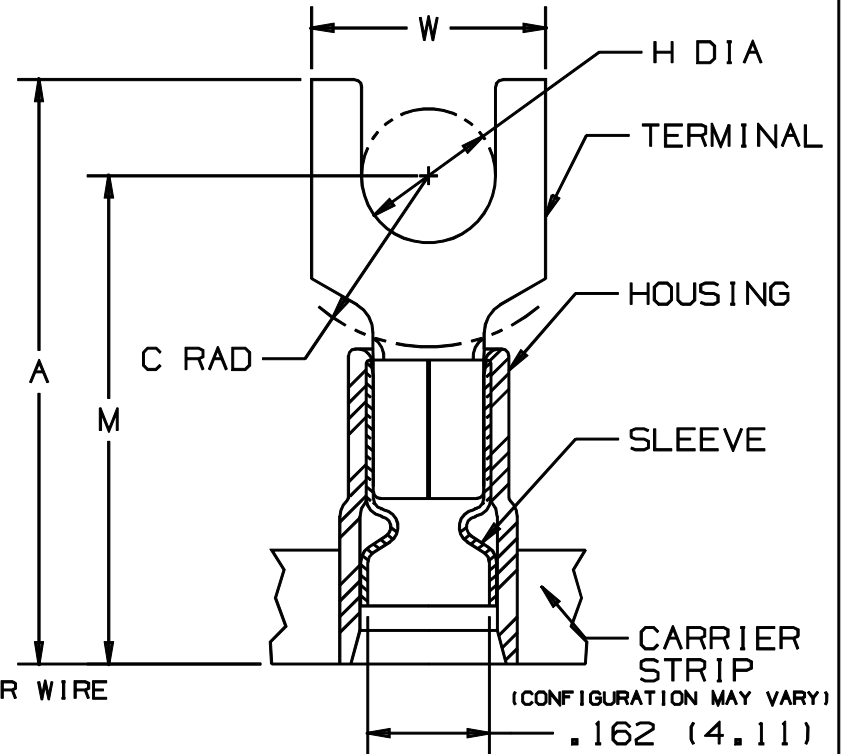

NOTES :

- UL LISTED AND CSA CERTIFIED FOR :
  - 600 V MAX. VOLTAGE RATING
  - 221°F (105°C) MAX. TEMP. RATING
  - #16-14 AWG (1.5-2.5 mm<sup>2</sup>) SOLID OR STRANDED, COPPER WIRE
- PACKAGE QTY. : 3K = 3000 PCS.  
CONTINUOUS MOLDED CARRIER STRIP

- MATERIAL :
  - STAMPING - .03" THK COPPER, TIN PLATED
  - HOUSING - BLUE NYLON
  - SLEEVE - BRASS, TIN PLATED
- DIMENSIONS IN BRACKETS ARE IN MILLIMETERS
- INSTALLATION TOOLS :
  - PRESSES - CP-851, CP-860, CP-861
  - APPLICATOR - CA-800
  - DIE INSERTS - CD-800-2

6. WIRE STRIP LENGTH: 1/4 <sup>+1/32</sup><sub>-0</sub> (6.4 <sup>+0.8</sup><sub>-0</sub>)

\* PNF14-6FN-3K & PNF14-10FN-3K ARE NOT UL LISTED OR CSA CERTIFIED

MAX WIRE INSUL DIA .080 (2.03)  
MIN. WIRE INSUL. DIA.

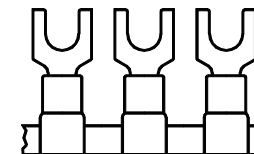

A41140\_04

04	12/00	ED		FILESPEC WAS: N41140AA_PCD_03	08925				TINLEY PARK, ILLINOIS
03	1/97	JAMB		ADDED DIM., "MIN. WIRE INSULATION DIA."	05408				
02	1/96	ED	RLS	REV.S TO NOTES & TABLE \ FILESPEC WAS: A41140A.PRT	03903	LA	DRH	TERMO 3PC, CONTINUOUSLY MOLDED NYLON (FUNNEL) INSULATED, 16-14 BARREL, FORKS	
01	3/88	GM		REDRAWN WITH REVISIONS		LA	KS		
REV	DATE	BY	CHK	DESCRIPTION	ECN	QA	CUST	PM	DRAWN BY GRM    Ck'D FD    SCALE NONE    DRAWING NO. A41140