



DVR Security Lock Box

Quest Security Lock DVR Boxes are made from the safest and strongest materials and are designed to provide a professional solution for securely locking up security camera DVR equipment.

Designed for easy one person installation, these security boxes have easy equipment access from both front and top of the box, and include a 19" 1U internal mounting bracket, ideal for adding an AC power strip. With easy cable access, cables can be added and removed as needed through the rear rubber access grommets. If looking for a cost effective method of mounting security DVR equipment, Quest has your solution.

Item No. SE0920-21-02 With Locking Solid Hinged Door



Item No. SE0920-21-02A With Locking Clear PlexiGlass Hinged Door



Rear View

- Hinged locking front door
 - Reinforced Shatterproof clear PlexiGlass door or Solid Metal locking front door
- Table-top or wall mount (with optional brackets)
- Removable top panel for easy equipment access
- Rear cut-outs for cabling installation
- Constructed of 18AWG Cold Rolled Steel
- Ventilation provided by pre-installed 4" fan unit
- Electrostatic Black powder coat Micro-Finish
- Meets or exceeds EIA-310D standards
- Ships pre-assembled and ready for installation



Inside View

Optional Accessories

Item No. WB-SE-02 Set of Wall Mount Brackets



Item No. HPS-E12P Rack Mount 12 Outlet Surge Strip

- 19"w x 1.65" d x 1.75"h (1U)
- 120VAC/12A/1440W, 1050 Joules
- Reversible Swivel 6ft. Power Cord



QUEST MANUFACTURING COMPANY

11200 NW 138th Street Medley, FL 33178 www.qtii.com
PH 305.513.8583 TF 800.280.1067 FX 305.513.9675



Scan to go to
www.qtii.com

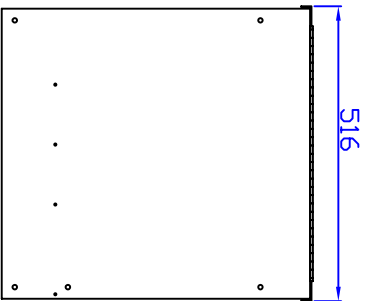

Base

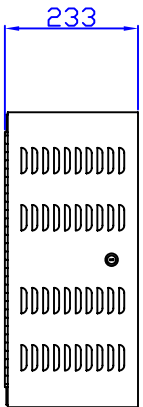

Front

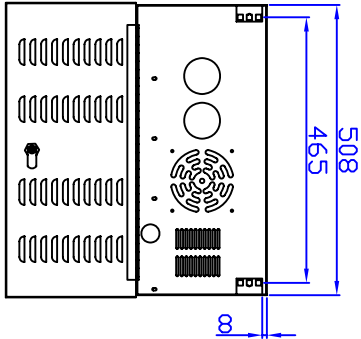

Front with door open

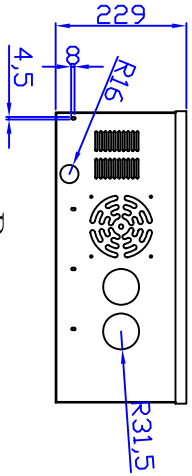

Rear

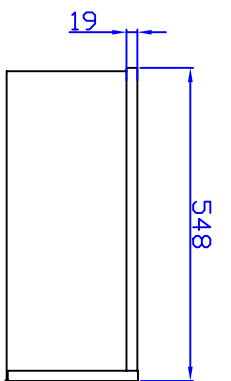

Side

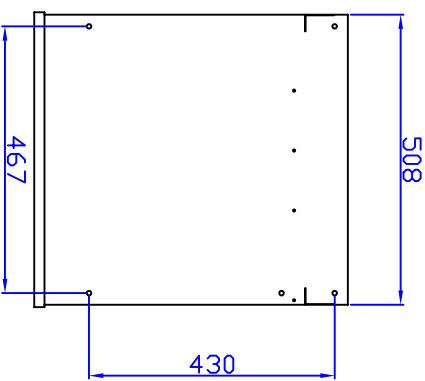

Top without cover

Quest Manufacturing Corp.

ITEM NO.		SE0920-21-02			
Drawed By	Date	Material	c.R.S.		
Checked By	Date	Unit	mm		
Approved By	Date	Surface Finish	Power Coat	Scale	1:1