

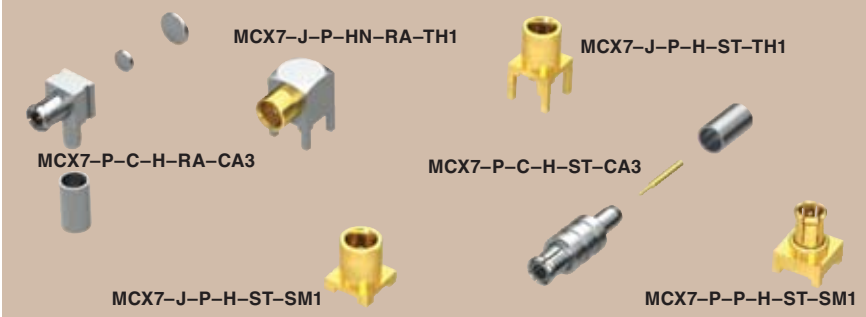

MCX7 SERIES



75Ω OPTIMIZED MCX JACKS & PLUGS

SPECIFICATIONS

For complete specifications and recommended PCB layouts see www.samtec.com?MCX7-SM or www.samtec.com?MCX7-TH

Shell Material: Brass
Contact Material: BeCu
Insulator Material: PTFE
Impedance: ST = 75Ω ±3Ω
 RA = 75Ω ±4Ω
Frequency Range: 0-6 GHz
V.S.W.R: 1.3 max (With optimized launch design)
Working Voltage: 170 Vrms max
Dielectric Withstanding: 500 Vrms min
Contact Resistance: Center Contact: 5mΩ max
 Outer Contact: 2.5mΩ max
Insulator Resistance: 1000 MΩ min
Engagement Force: 4.5 lbs max (-ST only)
Disengagement Force: 2.3 lbs max (-ST only)
Operating Temperature: -65°C to +125°C
RoHS Compliant: Yes
Processing: Lead-Free Solderable: Yes

MCX7 GENDER TYPE PLATING ORIENTATION TERMINATION

Mates with: RF179

-P
= Plug
-J
= Jack

-P
= PCB Mount

-H
= 30μ" (0,76 μm)
Gold center contact,
3μ" (0,08 μm)
Gold outer contact

-HN
= 30μ" (0,76 μm)
Gold center contact,
3μ" (0,08 μm)
Gold outer contact,
50μ" (1,27 μm)
Nickel body
(Available on -RA only)

-ST
= Straight
-RA
= Right Angle
(-J-TH1 only)

-SM1
= Surface Mount
(-ST only)
-TH1
= Through-hole
(-J only)

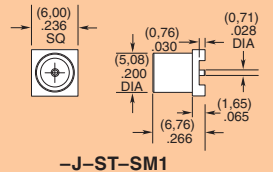

-J-ST-SM1

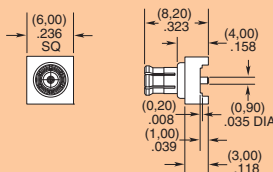

-P-ST-SM1

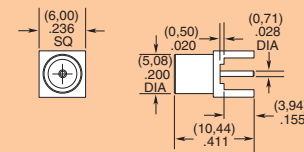

-J-ST-TH1

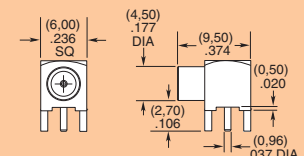

-J-RA-TH1

SPECIFICATIONS

For complete specifications and assembly instructions see www.samtec.com?MCX7-CA

Contact Material: Brass
Finger Shell Material: BeCu
Body Material: Brass
Insulator Material: PTFE
Center Contact: Soldered
Outer Ferrule: Crimped
Impedance: 75Ω
Frequency Range: 0-6 GHz (-ST)
 0-4.5 GHz (-RA)
V.S.W.R: 1.3 max
Working Voltage: 170 Vrms max
Dielectric Withstanding: 500 Vrms min
Contact Resistance: Center Contact: 5mΩ max
 Outer Contact: 2.5mΩ max
Insulator Resistance: 1,000 MΩ min
Operating Temperature: -65°C to +125°C

MCX7 GENDER TYPE PLATING ORIENTATION TERMINATION

-P
= Plug

-C
= Cable

-H
= 30μ" (0,76 μm)
Gold on contact,
Gold Flash on outer contact,
Nickel on body

-ST
= Straight
-RA
= Right Angle

-CA3
= RG 179 Cable

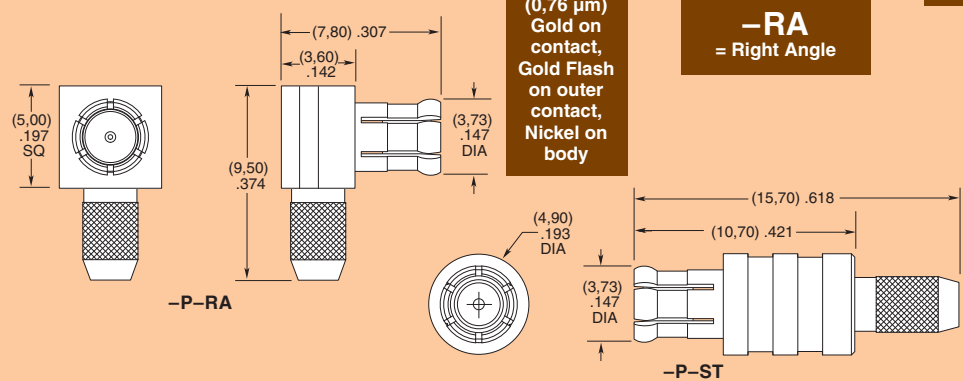

-P-RA

-P-ST

Supplied with pins and ferrules. See website for dimensions.

Due to technical progress, all designs, specifications and components are subject to change without notice.