

## MINIATURE, DUMMY PLUGS, HOLE PLUGS

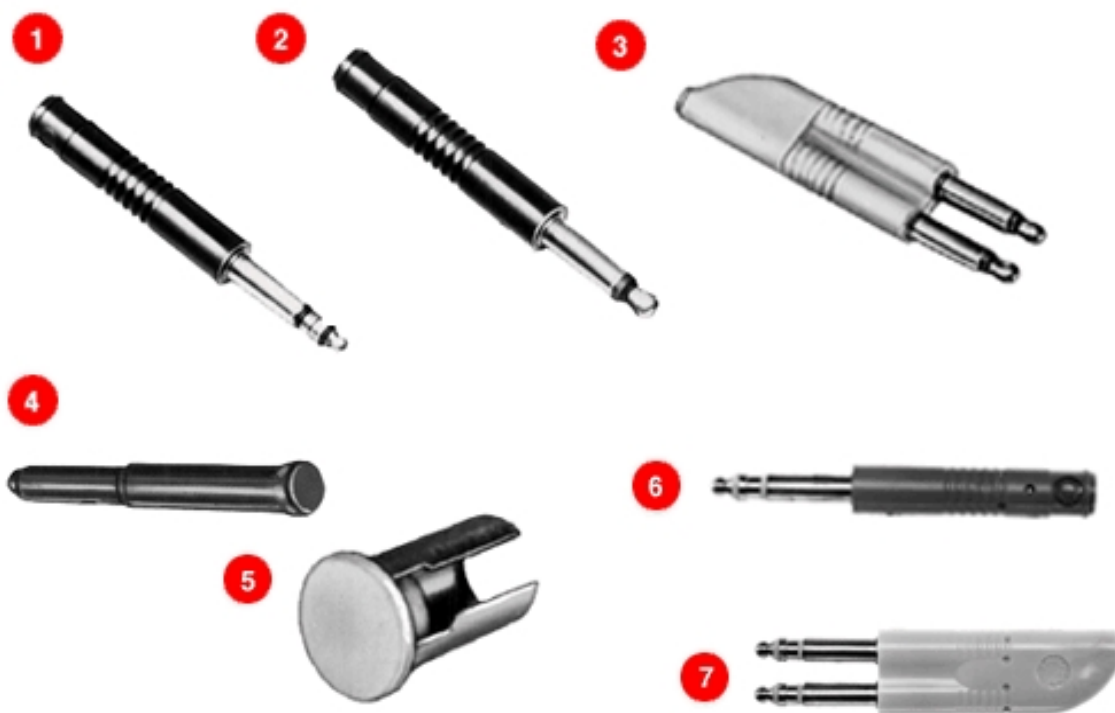

- 1. TT204 TT-Terminating Plug
- 4. TT515 TT-Dummy Plugs
- 5. TT510 Hole Plug
- 7. TT210

Terminating, dummy and looping plugs are designed for use with telephone® jacks. TT-Phone Plugs are also recommended for use on other miniature telephone jacks with same bushing inside diameter and compatible tip and/or ring spring configurations.

### TT-TERMINATING PLUGS

TT-Phone Plug terminating plugs are used to terminate a circuit with a specific resistive load. A precision 1/2 watt, ± 1% resistor is molded into the handle of each terminating plug. See "PLUG SCHEMATICS" for resistor wiring. Resistance value is marked on plug handle. Other resistance values are available on special order.

### TT-DUMMY PLUGS

TT-Phone Plug dummy plugs are designed to be inserted into phone jacks to actuate shunt and isolated switching circuits.

### TT-LOOPING PLUGS

TT-Phone Plug looping plugs are used to loop or patch adjacent jack circuits. See "PLUG SCHEMATICS" for wiring.

### TT-HOLE PLUG

TT-Hole Plugs are used to close off unused openings in all Switchcraft Jack Panels. Molded of black plastic with brass sleeve.

### ORDERING

1. Order by part number from table.
2. Contact Switchcraft for any special order items.

### SPECIFICATIONS

Series **TT200**

**Tip Rod, Ring and Sleeve:** Brass per QQ-B-626.

**Handle:** Molded PVC, ivory or black.

Series **TT-510:**

See page 216 for specifications.

Series **TT515:**

Molded of dimensionally stable plastic in black, red or white.

Part No.	Description	Schematic	Color
TT204	3-conductor	terminating-60	0 2 Gray
TT208	3-conductor	twin looping 4	Gray
TT210	3-conductor	twin dummy 6	White
TT510	Hole Plug		Black
TT5151	2- or 3-conductor dummy		Red
TT5152	2- or 3-conductor dummy		Black
TT5155	2- or 3-conductor dummy		White

To search a category please click on the corresponding button:

[Connectors](#) | [Jacks and Plugs](#) |  
[Patch Panels, Patch Kits & Jackfields](#) | [Cable Assemblies and Patch Cords](#) | [Switches](#) |

**All products shown are covered by Switchcraft's limited lifetime warranty.**