

## 102548-6 Product Details

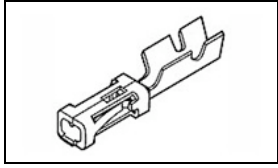

**102548-6**

TE Internal Number: 102548-6



### .100 AMPMODU Headers, Housings & Contacts

 Always EU RoHS/ELV Compliant (Statement of Compliance)

#### Product Highlights:

- Contact
- Contact Type = Socket
- Crimp Termination Method to Wire/Cable
- Applies To Wire/Cable
- Wire Insulation Diameter = 1.55 mm

### Documentation & Additional Information

#### Product Drawings:

- [CONTACT, CRIMP SNAP-IN, MOD IV 1/2](#) (PDF, English)

#### Catalog Pages/Data Sheets:

- [AMPMODU\\_INTERCONNECTION\\_SYSTEM\\_SECTION5\\_CONT](#) (PDF, English)

#### Product Specifications:

- [AMPMODU Mod 1/2 Wire to Board Standard Pressure Cont...](#) (PDF, English)

#### Application Specifications:

- [AMPMODU MOD IV, IV1/2, and V Receptacles and Housings](#) (PDF, English)

#### Instruction Sheets:

- None Available

#### CAD Files: (CAD Format & Compression Information)

- [2D Drawing](#) (DXF, Version J1)
- [3D Model](#) (IGES, Version J1)
- [3D Model](#) (STEP, Version J1)

#### Additional Information:

- [Product Line Information](#)

#### Related Products:

- [Tooling](#)

### Product Features (Please use the Product Drawing for all design activity)

#### Product Type Features:

- Product Type = Contact
- Termination Method to Wire/Cable = Crimp
- Wire Insulation Diameter (mm [in]) = 1.55 [0.061]
- Connector Series = Mod IV.v
- With Insulation Support = Yes
- Applied Pressure = Intermediate

#### Electrical Characteristics:

- Contact - Rated Current (A) = 3
- Voltage Rating (VAC) = 250
- Termination Resistance (mΩ) = 12
- Insulation Resistance (MΩ) = 5,000
- Dielectric Withstanding Voltage (V) = 750

#### Termination Features:

- Crimp Area Plating = Gold Flash

#### Body Features:

- Wire Range (mm [AWG]) = 0.12-0.40<sup>2</sup> [26-22]

#### Contact Features:

- Contact Type = Socket
- Contact Plating, Mating Area, Material = Gold (30)
- Contact Base Material = Beryllium Copper

#### Industry Standards:

- RoHS/ELV Compliance = RoHS compliant, ELV compliant
- Lead Free Solder Processes = Not relevant for lead free process
- RoHS/ELV Compliance History = Always was RoHS compliant
- Approved Standards = UL E28476, CSA LR7189

#### Environmental:

- Operating Temperature (°C) = -65 - +105

#### Conditions for Usage:

- Applies To = Wire/Cable

#### Packaging Features:

- Packaging Method = Loose Piece

#### Other:

- Brand = AMP
- Comment = (\*) For use with Model "K" machines. Call the Technical Assistance Center (1-800-522-6752) for part numbers of applicators for use with Model "G" machines, as well as other bench machines and fully automatic AMPOMATOR lead making machines.

THIS DRAWING IS UNPUBLISHED. RELEASED FOR PUBLICATION  
 © COPYRIGHT - By - ALL RIGHTS RESERVED.

LOC		DIST		REVISIONS					
AD		39		P	LTR	DESCRIPTION	DATE	DWN	APVD
				J2		REVISED PER ECO-11-004917	11MAR11	RK	HMR

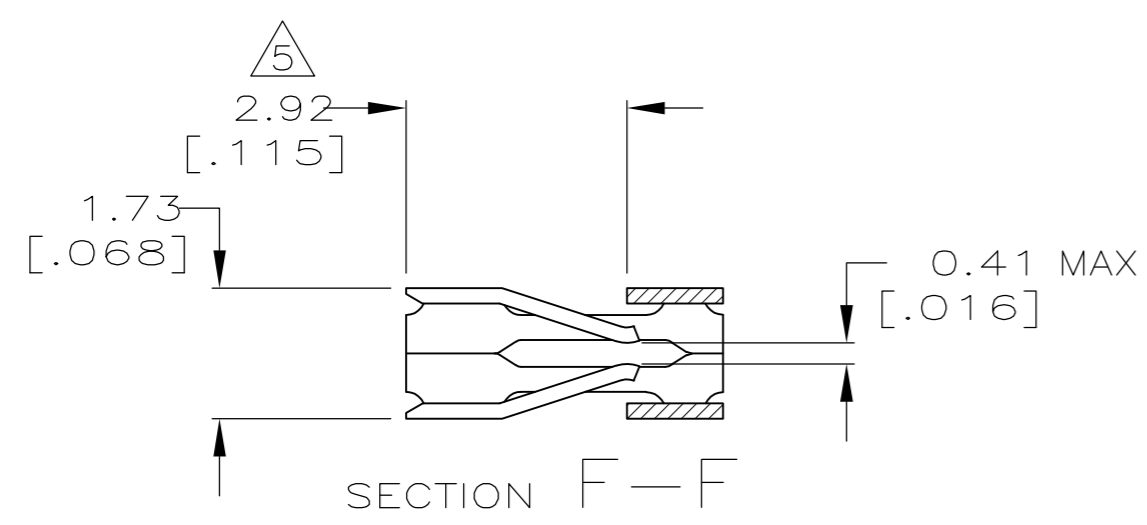
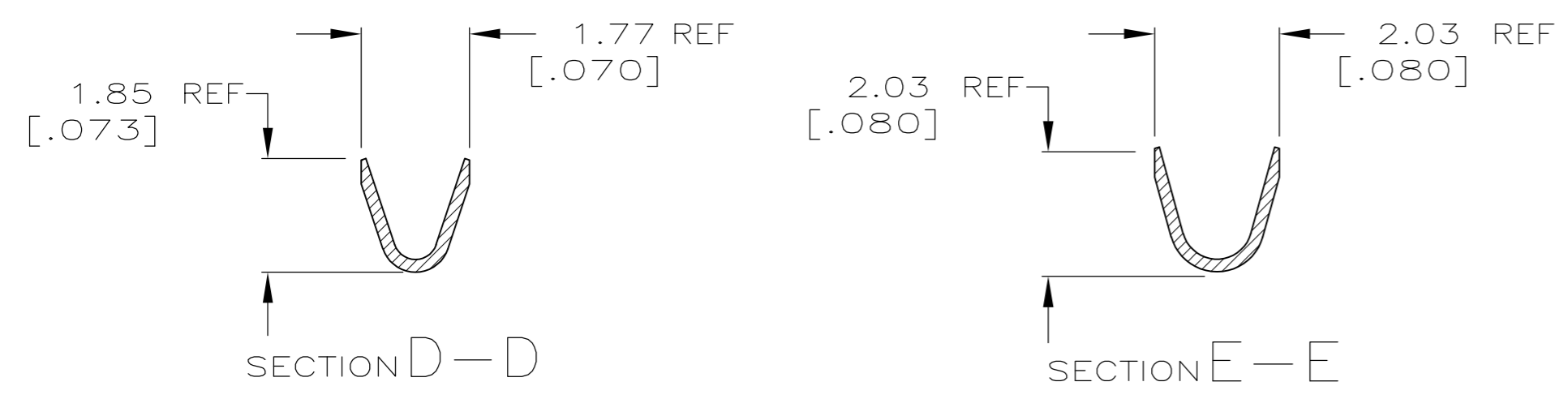
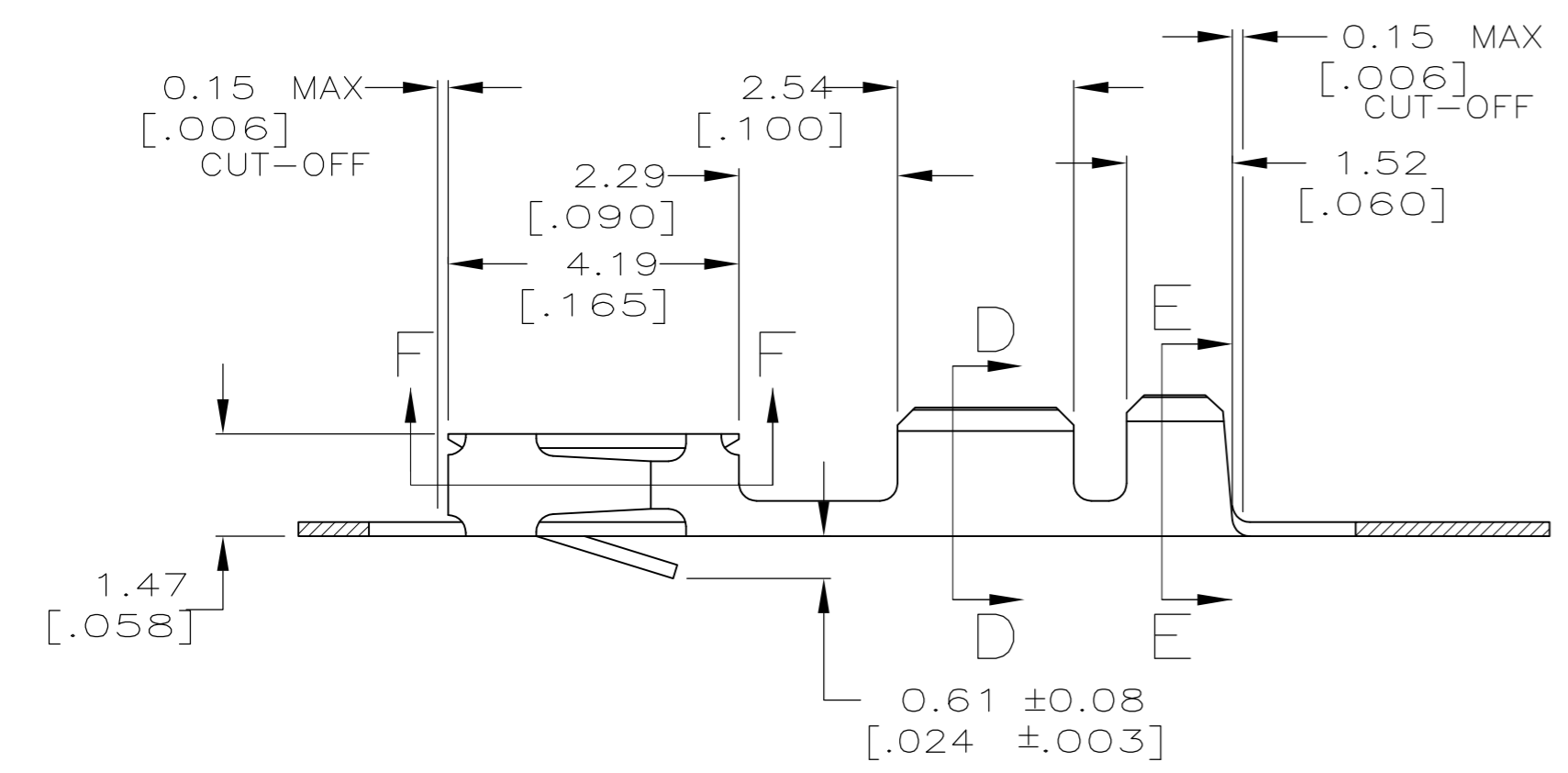
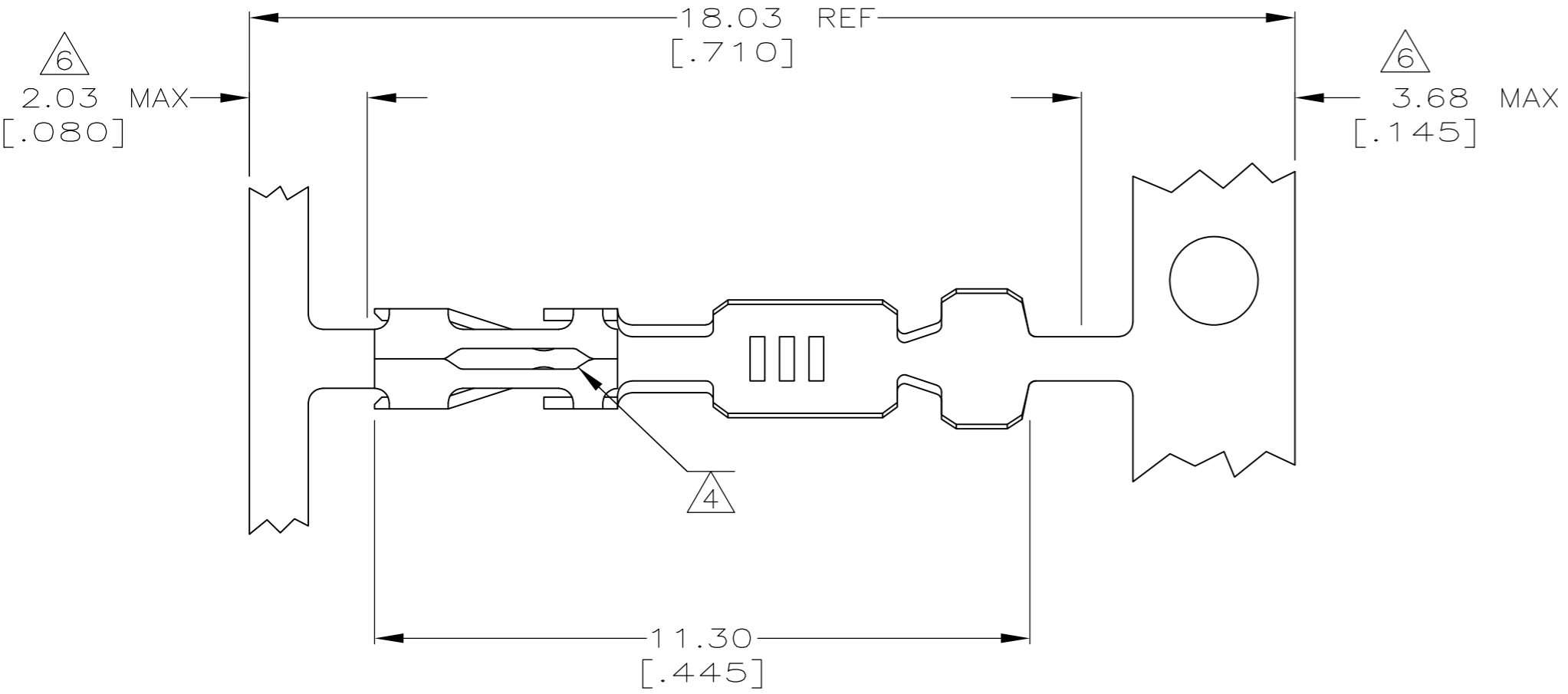

- ① REELED FOR MINI APPLICATOR.
  - ② FINISH: GOLD FLASH OVER 0.00127[.000050] NICKEL, 0.000381[.000015] GOLD IN CONTACT AREA.
  - ③ FINISH: GOLD FLASH OVER 0.00127[.000050] NICKEL, 0.00076[.000030] GOLD IN CONTACT AREA.
  - ④ CUT OUTS ON BOX AT MANUFACTURERS OPTION.
  - ⑤ POINT OF MEASUREMENT FOR PLATING THICKNESS (INSIDE BEAMS).
  - ⑥ GOLD PLATING NOT REQUIRED IN THIS AREA.
7. WIRE RANGE #22-#26, INSULATION RANGE Ø.061 MAX.

LOOSE PC.	③	102548-6
①	③	102548-5
LOOSE PC.	②	102548-3
①	②	102548-1
DESCRIPTION	FINISH	PART NUMBER

THIS DRAWING IS A CONTROLLED DOCUMENT.		DWN	S. SHUEY	5-6-92
DIMENSIONS: mm [INCHES]		CHK	J. GESFORD	5-20-92
TOLERANCES UNLESS OTHERWISE SPECIFIED:		APVD	-	-
0 PLC	± -	PRODUCT SPEC	-	-
1 PLC	± -	APPLICATION SPEC	-	-
2 PLC	± 0.13[.005]	WEIGHT	-	-
3 PLC	± -	SCALE	10:1	SHEET 1 of 1
4 PLC	± -	CUSTOMER DRAWING	-	REV J2
ANGLES	± -	TE Connectivity		
MATERIAL	BERYLLIUM COPPER	CONTACT, CRIMP SNAP-IN, MOD IV 1/2		
FINISH	SEE TABLE	SIZE	A2	CAGE CODE 00779
		DRAWING NO	C=102548	