

1052901-1 Product Details

[Live Product Chat](#)

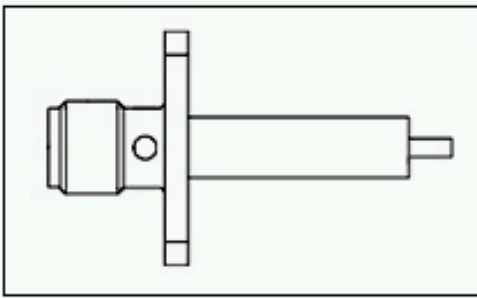

1052901-1

TE Part Number: 1052901-1

[Active](#)

[Add to Part List](#)

SMA/QMA RF Connectors

[Always EU RoHS/ELV Compliant](#) ([Statement of Compliance](#))

Product Highlights:

- Connector
- Jack
- Connector Type = SMA
- Without Snap-Lock
- Terminate To Printed Circuit Board

[View all Features](#) | [Find Similar Products](#)

Quick Links

- ▶ [Check Pricing & Availability](#)
- ▶ [Search for Tooling](#)
- ▶ [Product Feature Selector](#)
- ▶ [Contact Us About This Product](#)
- ▶ [Request Samples](#)

NEW!

Documentation & Additional Information

Product Drawings:

- [OSM 2 HOLE FLANGE MOUNT JACK RECEPTACLE-STRAIGHT TER...](#) (PDF, English)

Catalog Pages/Data Sheets:

- None Available

Product Specifications:

- None Available

Application Specifications:

- None Available

Instruction Sheets:

- None Available

CAD Files:

- None Available

Additional Information:

- [Product Line Information](#)

Related Products:

- [Tooling](#)

[List all Documents](#)

Product Features (Please use the Product Drawing for all design activity)

Product Type Features:

- [Product Type](#) = Connector
- [Gender](#) = Jack
- [Connector Type](#) = SMA
- [Body Style](#) = Straight
- [Number of Panel Mount Holes](#) = 2
- [PCB Mount Angle](#) = Vertical
- [Body Material](#) = Stainless Steel
- [Body Finish](#) = Gold
- [Center Contact](#) = With
- Terminal Type = Straight
- Dielectric Material = TFE Fluorocarbon

Mechanical Attachment:

- [Panel Attachment](#) = With
- [Panel Attachment Method](#) = Flange
- [Panel Attachment Style](#) = Front Mount

Electrical Characteristics:

- Impedance (Ω) = 50

Body Related Features:

- Snap-Lock = Without
- [Length \(mm \[in\]\)](#) = 13.87 [0.546]

Contact Related Features:

- Center Contact Material = Beryllium Copper
- Center Contact Plating = Gold

Industry Standards:

- Government/Industry Qualification = No
- [RoHS/ELV Compliance](#) = RoHS compliant, ELV compliant
- [Lead Free Solder Processes](#) = Wave solder capable to 240°C, Wave solder capable to 260°C, Wave solder capable to 265°C, Reflow solder capable to 245°C, Reflow solder capable to 260°C, Pin-in-Paste capable to 245°C, Pin-in-Paste capable to 260°C
- RoHS/ELV Compliance History = Always was RoHS compliant

Conditions for Usage:

- [Terminate To](#) = Printed Circuit Board

Other:

- Brand = AMP