

1106417-1 Product Details

[Share](#) [Print](#) [Email](#)

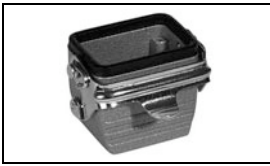

1106417-1

TE Internal Number: 1106417-1

Active

[View 3D PDF](#)

HTS Connectors and Accessories

Always EU RoHS/ELV Compliant (Statement of Compliance)

Product Highlights:

- HB Series
- Accessory
- Accessory Type = Hood
- Product Size = 3
- Locking Device Type = Side Clip at Housing Bottom

[View all Features](#)

Quick Links

- ▶ [Pricing & Availability](#)
- ▶ [Search for Tooling](#)
- ▶ [Product Feature Selector](#)
- ▶ [Contact Us About This Product](#)

[Add to My Part List](#) [Request Sample](#) [Find Similar Products](#) [Buy Product](#)

Documentation & Additional Information

Product Drawings:

- [Cable-to-cable hood](#) (PDF, English)

Catalog Pages/Data Sheets:

- None Available

Product Specifications:

- None Available

Application Specifications:

- None Available

Instruction Sheets:

- None Available

CAD Files: [\(CAD Format & Compression Information\)](#)

- [2D Drawing](#) (DXF, Version A)
- [3D Model](#) (IGES, Version A)
- [3D Model](#) (STEP, Version A)

[List all Documents](#)

Additional Information:

- [Product Line Information](#)

Related Products:

- [Tooling](#)

Product Features (Please use the Product Drawing for all design activity)

Product Type Features:

- Product Type = Accessory
- Accessory Type = Hood
- Product Size = 3
- Thread Size = M25
- Finish = Silver Gray

Body Features:

- Entry Style = Bottom - Cable-to-Cable
- Dimensions (L x H x W) (mm [in]) = 60.00 x 50.00 x 43.00 [2.362 x 1.969 x 1.693]
- Material = Die Cast Aluminum

Contact Features:

- Corrosion Protected = No

Configuration Features:

- Locking Device Type = Side Clip at Housing Bottom

Industry Standards:

- [RoHS/ELV Compliance](#) = RoHS compliant, ELV compliant
- [Lead Free Solder Processes](#) = Not relevant for lead free process
- [RoHS/ELV Compliance History](#) = Always was RoHS compliant

Packaging Features:

- Packaging Method = Loose Piece
- Packaging Quantity = 5

Other:

- Series = HB
- Brand = HTS

Corporate Information

- [About TE](#)
- [Investors](#)
- [News Room](#)
- [Supplier Portal](#)
- [Careers](#)
- [Terms & Conditions](#)
- [Privacy Policy](#)
- [AODA Accessibility Policy](#)

Quick Links

- [Distributor Inventory](#)
- [Product Cross Reference](#)
- [Documents & Drawings](#)
- [Product Compliance Support Center](#)
- [Site Map](#)

Customer Support

- [Email or Chat With Us](#)
- [Find a Phone Number](#)
- [Knowledge Base](#)
- [Manage Your Account](#)

Keep Me Informed

4

3

2

1

THIS DRAWING IS UNPUBLISHED. VERTRAULICHE UNVERÖFFENTLICHTE ZEICHNUNG
 RELEASED FOR PUBLICATION FREI FUER VERÖFFENTLICHUNG
 .1997
 MATED WITH: PASSEND ZU: Bg3
 LOC AI DIST - P LTR
 REVISIONS AENDERUNGEN
 DESCRIPTION BESCHREIBUNG
 DATE DATE
 DWN DWN
 APVD APVD

© COPYRIGHT 1997 BY AMP INCORPORATED. ALL RIGHTS RESERVED. ALLE RECHTE VORBEHALTEN
 PROJEKT NR.: - A3 ECR-05-011296
 16.09.05 SK TS

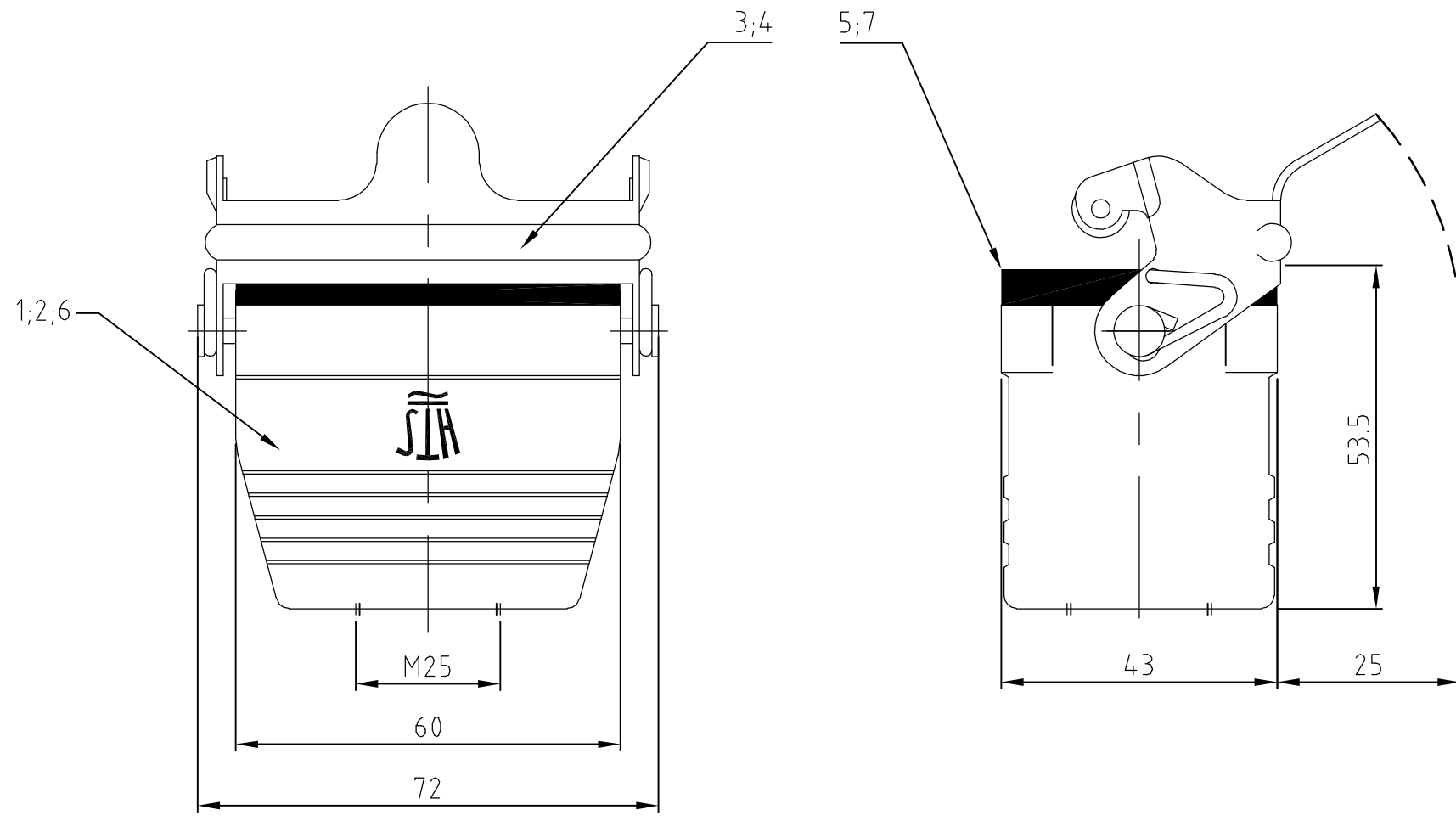

Bemerkungen:

- 1 Material: Gehäuse: Alu-Druckguß-Legierung
- 2 Oberfläche: Lackierung - grau
 - Aluminium-oxid-Schicht + Lackierung schwarz
 - chromitAL TCP passivation + Lackierung schwarz
- 3 Lackierung im Gehäuseinnere ist nicht notwendig

Notes:

- 1 Material: Housing: aluminium diecasting alloy
- 2 Surface: Varnish- grey
 - aluminium oxid + varnish black
 - chromitAL TCP passivation + varnish black
- 3 Varnish on the inside not necessarily

QTY	DESCRIPTION / BENENNUNG	MATERIAL	SURFACE / OBERFLÄCHE	COLOR / FARBE	ITEM NO. POS.	REMARKS / BEMERKUNGEN
1	Profildichtung/profile seal	Neoprene	leitfähig/conductive	schwarz/black	7	
1	Kupplungsgehäuse HB/cable-to-cable hood	Aluminium/ALU	SEE NOTE 2	grau/grey	6	
1	Profildichtung/profile seal	Neoprene	-	schwarz/black	5	
1	LB-Bügel/side clip	V2A/stainless steel	blank/even		4	
1	LB-Bügel/side clip	Stahl/steel	verzinkt/zink plated	blau/blue	3	
1	Kupplungsgehäuse HB-K/cable-to-cable hood	Aluminium/ALU	aluminiumoxid	schwarz/black	2	
1	Kupplungsgehäuse HB/cable-to-cable hood	Aluminium/ALU	-	grau/grey	1	

ORDERING TEXT / BESTELLTEXT HB-EMV-6.KDO-LB.1.M25.G HB-K-6.KDO-LB.1.M25.G HB-6.KDO-LB.1.M25.G	THIS DRAWING IS A CONTROLLED DOCUMENT FOR AMP INCORPORATED. IT IS SUBJECT TO CHANGE AND THE CONTROLLING ENGINEERING ORGANIZATION SHOULD BE CONTACTED FOR THE LATEST REVISION. DIESES ZEICHNUNGSDOKUMENT WIRD DURCH AMP INCORPORATED KONTROLLIERT. AENDERUNGEN, DIE DEM TECHNISCHEN FORTSCHRITT DIENEN, SIND VORBEHALTEN. DEN JEWEILS LETZTIGELTIGEN AENDERUNGSSTAND ERFAHREN SIE AUF ANFRAGE.		DWN Schneider 10.06.2003	HTS Elektrotechnik 53819 Neunkirchen, Germany
	DIMENSIONS: DIMENSIONEN: mm 		CHK Schweiger 10.06.2003	
	TOLERANCES UNLESS OTHERWISE SPECIFIED: ALLGEMEINTOLERANZEN ISO 8015 ISO 2768 - M H - E DIN 16901 - 140 0 PLC # 1 PLC # 2 PLC # 3 PLC # ANGLES / WINKEL # FINISH / OBERFLAECHE / FARBE		APVD -	
	MATERIAL		PRODUCT SPEC PRODUKTSPEZ. -	
APPLICATION SPEC VERARBEITUNGSSPEZ. -			NAME Cable-to-cable hood Kupplungsgehäuse HB.6	SIZE A3 CAGE CODE 00779 DRAWING NO ZEICHNUNGS-NR. C-1106417 RESTRICTED TO NUR FUER -
CUSTOMER DRAWING /KUNDENZEICHNUNG			MASSSTAB 1:1 BLATT 1 OF VON 1 REV A3	