

## PIDG (Pre-Insulated Diamond Grip) (Continued)

### Rectangular Tongue Terminals (Insulation Restricting)

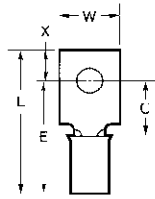

#### Material

**Insulation** — Nylon, UL 94V-2  
**Terminal Body** — Copper per ASTM B-152  
**Plating** — Tin per ASTM B-545  
**Metallic Sleeve** — Copper per ASTM B-152  
**Plating** — Nickel per QQ-N-290

#### Related Product Data

**Insulation Color Code** — pg. 4  
**Packaging Quantities** — pg. 4  
**Performance Specifications** — pgs. 4 & 5  
**Application Tooling** — pg. 72

Wire Size Circular Mills [mm <sup>2</sup> ]	Tongue Material Thickness Max.	Stud Size	Dimensions					Terminal Insulation Color Solid/Stripe	Wire Insulation Diameter Range	Part Numbers	
			W	C Min.	E Max.	L Max.	X			Loose Piece	Tape Mounted
24 475 [0.24]	.020 0.51	6	.312	.308	.683	.875	.187	Yellow/Blue	.031-.055 0.79-1.40	2 326876-2	
		M3.5	7.92	7.82	17.35	22.23	4.75				
10 12,066 [6.11]	.042 1.07	5	.277	.277	.934	1.087	.143	Yellow/Brown	.119-.200 3.02-5.08	53912-2	
		M3	7.04	7.04	23.72	27.61	3.63				
		8	.390	.621	1.276	1.596	.310	Yellow/Brown	.119-.200 3.02-5.08	53914-2	
		M4	9.91	15.77	32.41	40.54	7.87				

Note: "C" dimension applies from edge of metal wire barrel to center of stud hole.

### Spade Tongue Terminals

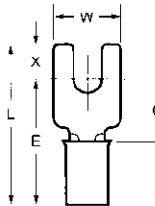

#### Material

**Insulation** — Nylon, UL 94V-2  
**Terminal Body and Metallic Sleeve** — Copper per ASTM B-152  
**Plating** — Tin per ASTM B-545

#### Related Product Data

**Insulation Color Code** — pg. 4  
**Packaging Quantities** — pg. 4  
**Performance Specifications** — pgs. 4 & 5  
**Application Tooling** — pg. 72

Wire Size Circular Mills [mm <sup>2</sup> ]	Tongue Material Thickness Max.	Stud Size	Dimensions					Terminal Insulation Color	Wire Insulation Diameter Max.	Part Numbers	
			W	C Min.	E Max.	L Max.	X			Loose Piece	Tape Mounted
26-24 238-475 [0.12-0.24]	.029 0.74	6	.250	.211	.632	.709	.072	Yellow	.095 2.41	53115-2	
		M3.5	6.35	5.36	16.05	18.01	1.83				
26-22 202-810 [0.10-0.41]	.020 0.51	0	.125	.078	.409	.476	.062	Yellow	.082 2.08	322001	
		4	.203	.211	.542	.627	.076			Yellow	.082 2.08
		2	.182	.203	.607	.727	.115	Red	.140 3.56		
		M2	4.62	5.16	15.42	18.47	2.92				
		4	.218	.156	.560	.674	.109	Red	.125 3.18	1-327717-0	
		M2	5.54	3.96	14.22	17.12	2.77				
		4	.218	.156	.560	.674	.109	Red	.140 3.56	327717* 1-327717-2	
		M2	5.54	3.96	14.22	17.12	2.77				
		4	.250	.312	.716	.846	.125	Red	.140 3.56	34541* 2-34541*	
		M2	6.35	7.92	18.19	21.49	3.18				
		4	.297	.203	.607	.753	.141	Red	.125 3.18	34080* 2-34080*	
		M2	7.54	5.16	15.42	19.13	3.58				
		6	.297	.203	.607	.753	.141	Red	.140 3.56	326861* 2-326861-1	
		M3.5	7.54	5.16	15.42	19.13	3.58				
		4	.344	.218	.622	.783	.156	Red	.125 3.18	32403	
		M3.5	8.74	5.54	15.80	19.89	3.96				
		4	.344	.218	.622	.783	.156	Red	.140 3.56	32404 2-32404-1	
		M3.5	8.74	5.54	15.80	19.89	3.96				
		8	.375	.312	.716	.908	.187	Red	.125 3.18	32050* 2-32050-1	
		M4	9.53	7.92	18.19	23.06	4.75				
		4	.375	.312	.716	.908	.187	Red	.140 3.56	32053* 2-32053-1	
		M4	9.53	7.92	18.19	23.06	4.75				
		10	.375	.312	.716	.908	.187	Red	.125 3.18	32051* 2-32051-1	
		M4	9.53	7.92	18.19	23.06	4.75				
		10	.375	.312	.716	.908	.187	Red	.140 3.56	32054* 2-32054-1	
		M4	9.53	7.92	18.19	23.06	4.75				

\*Available in small packaging quantities.

Note: "C" dimension applies from edge of metal wire barrel to center of stud hole.