

## 1-338088-3 Product Details

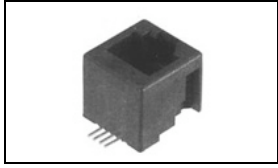

**1-338088-3**

TE Internal Number: 1-338088-3

 Active

### PCB Mounted Jacks - Single Port, Multi-port and Stacked

 Converted to EU RoHS/ELV Compliant  
(Statement of Compliance)

#### Product Highlights:

- Connector
- Preloaded
- Single Port Configuration
- 1 x 1 Jack Configuration
- Jack Type = RJ45

### Documentation & Additional Information

#### Product Drawings:

- [INVERTIBLE MODULAR JACK, 8 POSITION SURFACE MOUNT AP...](#) (PDF, English)

#### Catalog Pages/Data Sheets:

- [1-1773464-9\\_MODULAR JACKS\\_SINGLE\\_PORT\\_PCB\\_MOUNT](#) (PDF, English)
- [82066 - Modular Jacks and MRJ21 Product catalog - Si...](#) (PDF, English)

#### Product Specifications:

- None Available

#### Application Specifications:

- None Available

#### Instruction Sheets:

- None Available

#### CAD Files: (CAD Format & Compression Information)

- [2D Drawing](#) (DXF, Version W)
- [3D Model](#) (IGES, Version W)
- [3D Model](#) (STEP, Version W)

#### Additional Information:

- [Product Line Information](#)

#### Related Products:

- [Tooling](#)

### Product Features (Please use the Product Drawing for all design activity)

#### Product Type Features:

- Product Type = Connector
- Jack Type = RJ45
- PCB Mounting Orientation = Top Entry (Vertical)
- PCB Mount Style = Surface Mount
- Termination Method to PC Board = Solder
- Performance Category = Cat 3
- LED = Without
- Grounding Options = Without
- Panel Stops = Without
- Keyed = No
- Profile = Standard
- Color = Black
- Latch Style = Standard

#### Mechanical Attachment:

- Panel Mount Retention = With
- Flanged = No

#### Electrical Characteristics:

- Shielded = No

#### Termination Features:

- Solder Tail Contact Plating = Tin over Nickel

#### Dimensions:

- Height (mm [in]) = 12.70 [0.500]
- PCB Thickness, Recommended (mm [in]) = 1.57 [0.062]

#### Body Features:

- Inverted Jack Face = No
- Solder Bracket Material = Tin Plated Brass

#### Contact Features:

- Contact Plating, Mating Area, Material = Conforms to Product Requirements based on Product Specification 108-19117, Gold or Gold Flash over Palladium Nickel
- Contact Base Material = Phosphor Bronze

#### Housing Features:

- Housing Material = High Temperature Nylon
- UL Flammability Rating = UL 94V-0

#### Configuration Features:

- Preloaded = Yes
- Port Configuration = Single
- Jack Configuration = 1 x 1
- Number of Positions = 8
- Number of Contacts Loaded = 8

#### Industry Standards:

- RoHS/ELV Compliance = RoHS compliant, ELV compliant
- Lead Free Solder Processes = Reflow solder capable to 245°C, Reflow solder capable to 260°C
- RoHS/ELV Compliance History = Converted to comply with RoHS directive

#### Packaging Features:

- Packaging Method = Tape Mounted on Reel
- Packaging Quantity = 250 Pieces (per 36 cm diameter reel)

#### Product Availability:

- Region = Asia, North America

#### Other:

- Brand = AMP
- Comment = Embossed tape according to EIA 481-3.; This Invertible Modular Jack can also be applied hanging through a hole in the PC Board. (See PCB Layout) Surface can be used

note in the PCB Board. (See PCB Layout); Surface can be used for application by Type II SMD Machine.

THIS DRAWING IS UNPUBLISHED. RELEASED FOR PUBLICATION  
 © COPYRIGHT - TE CONNECTIVITY ALL RIGHTS RESERVED.

LOC		DIST		REVISIONS			
P	LTR	DESCRIPTION	DATE	DWN	APVD		
W		ECR-10-020218	28DEC2010	PS	PKS		
WI		3-338088-3 (HALOGEN FREE) ADDED	24AUG2011	PS	RRP		

NOTES:

- 1 TOLERANCES UNLESS OTHERWISE SPECIFIED:  $\pm 0.15$ .
- 2 CONTACT PLATING:  
OVERALL: Ni 1.27 $\mu$ m MIN. ALL OVER THE CONTACTS  
SOLDER ZONE: Sn 3.5-5.0 $\mu$ m ON THE SOLDER ZONE OF THE CONTACT  
MATING ZONE: PLATING CONFIRMS TO PRODUCT REQUIREMENTS AS PER SPECIFICATION 108-19117
- 3 CONTACT AND BRACKET MATERIAL:  
CONTACTS: PHOSPHOR BRONZE  
SOLDER BRACKET: TINPLATED BRASS WITH NICKEL UNDERLAYER.
- 4 THIS JACK CAN ALSO BE APPLIED HANGING THROUGH A HOLE, IN A PRINTED CIRCUIT BOARD. SEE LEFT PCB LAYOUT.
- 5 SURFACE CAN BE USED FOR PICKING THE MODULAR JACK WITH, TYPE 11 SMD MACHINE.
- 6 MEASURED AT HEEL OF CONTACTS, COPLANARITY AT TIPS MAX. 0.18mm.
- 7 TAPE AND REEL PACKAGING ACCORDING TO EIA 481-3 SPECIFICATIONS.
- 8 INCLUDES KAPTON TAPE (10mm x 14mm) ON TOP SURFACE FOR PICK AND PLACE UNIT
- 9 OBSOLETE
- 10 HOUSING MATERIAL:  
HOUSING: 30% G.F. P.A 9T, COLOR BLACK, UL 94V-0.
- 11 HOUSING MATERIAL:  
HOUSING: 30% G.F. LCP (HALOGEN FREE), COLOR BLACK, UL 94V-0.

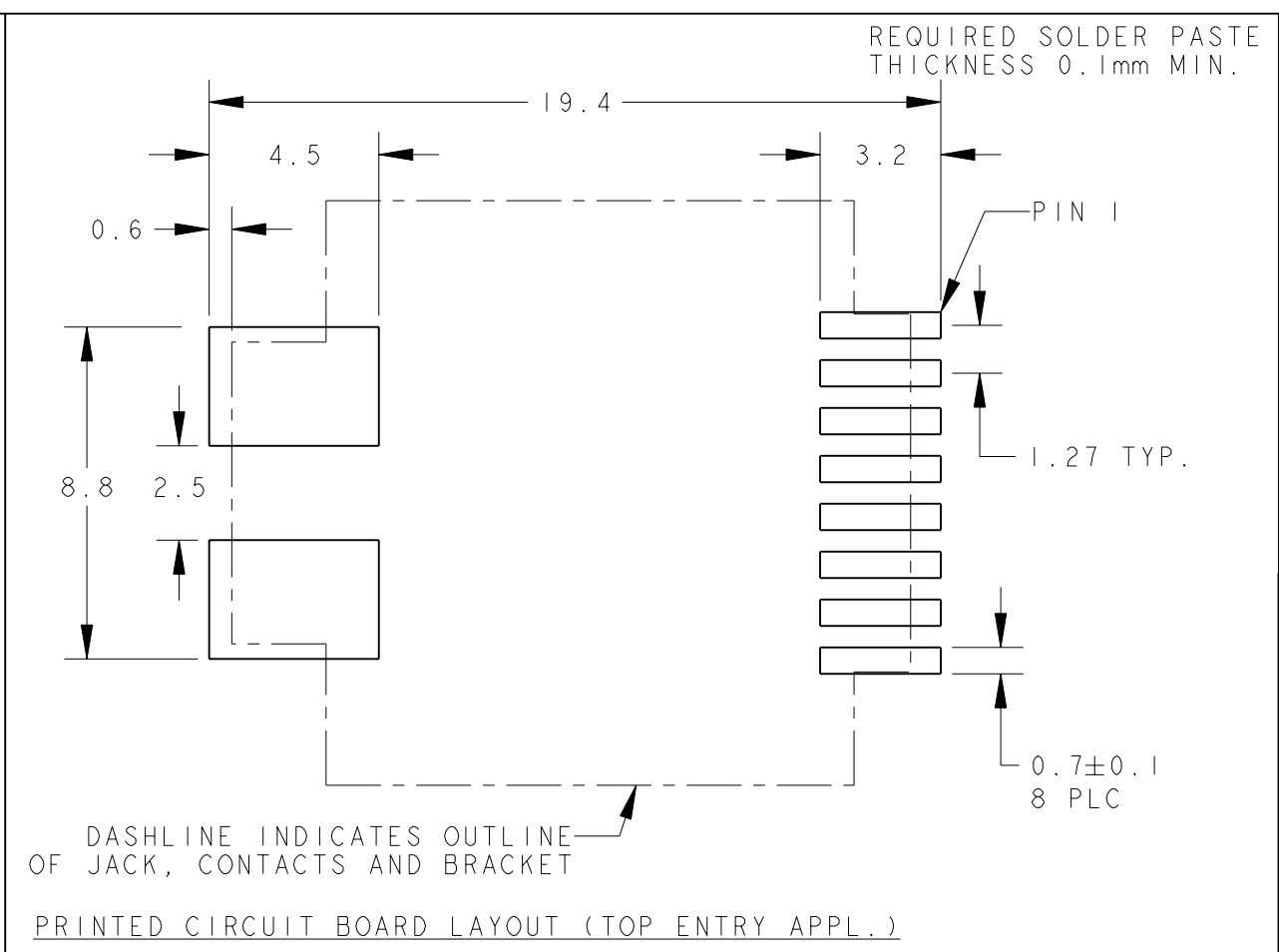
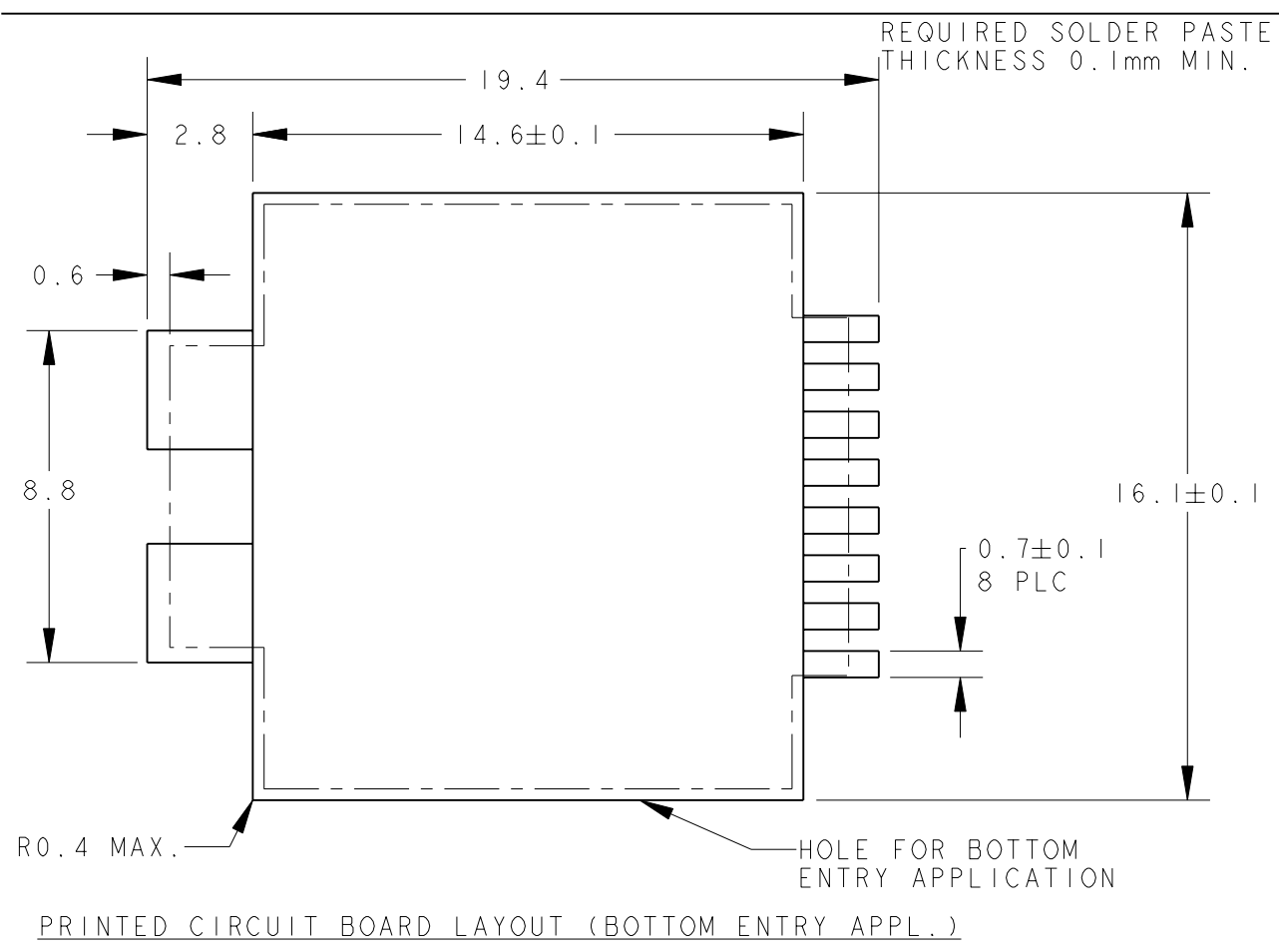
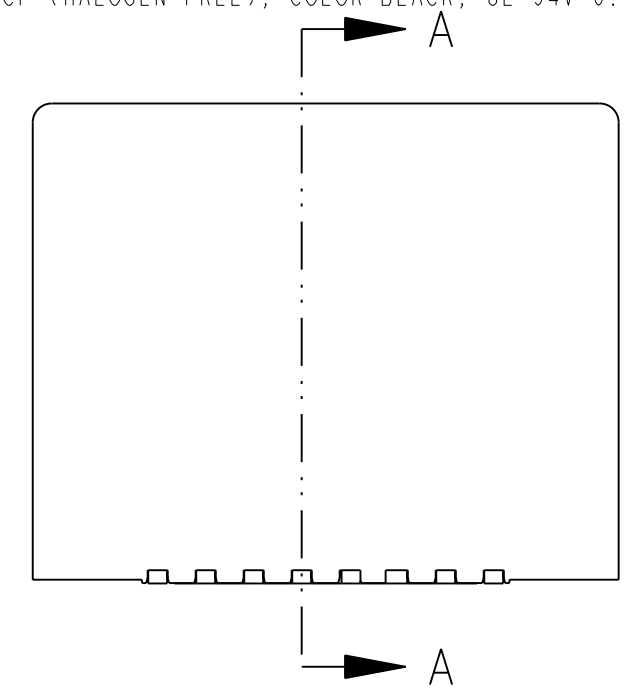
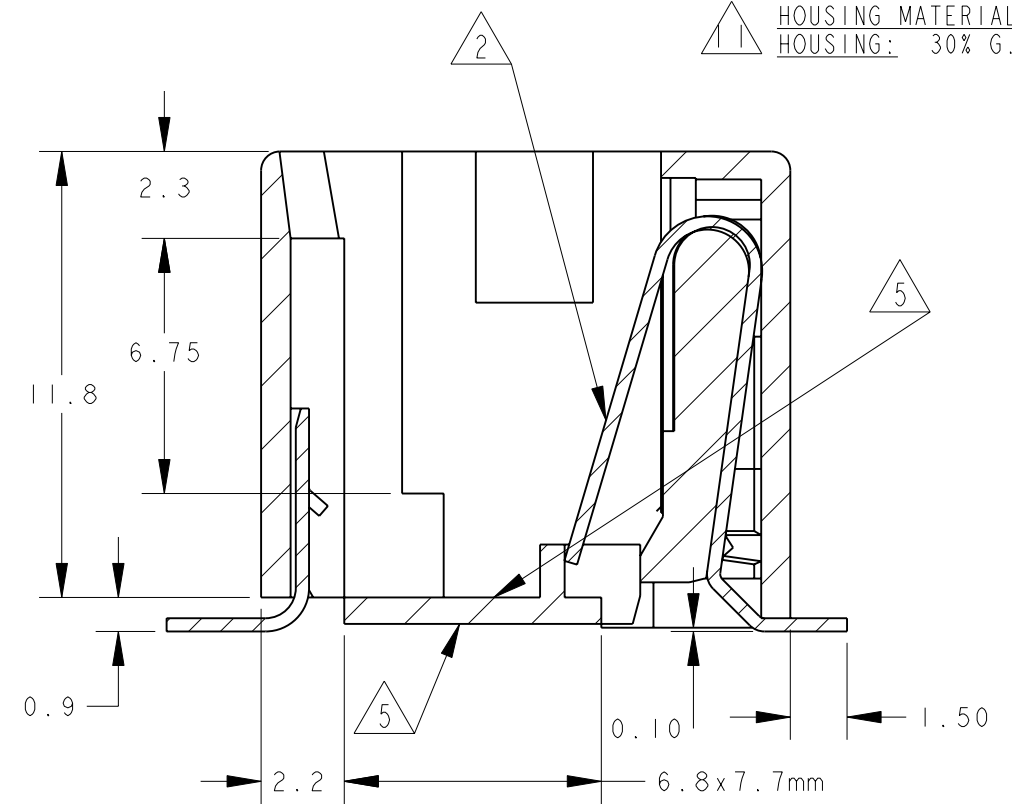
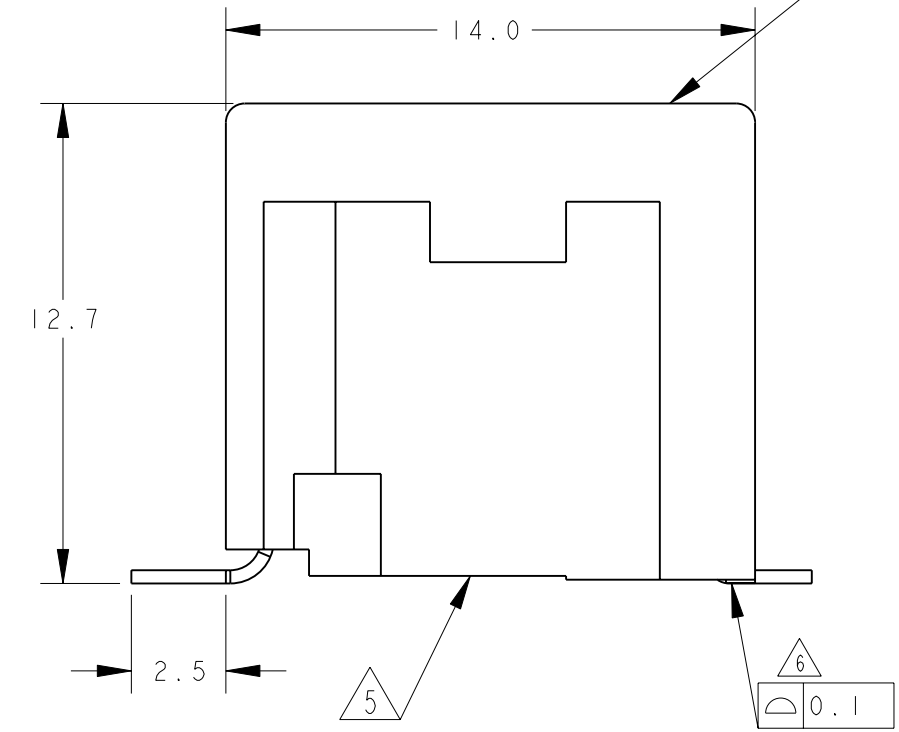
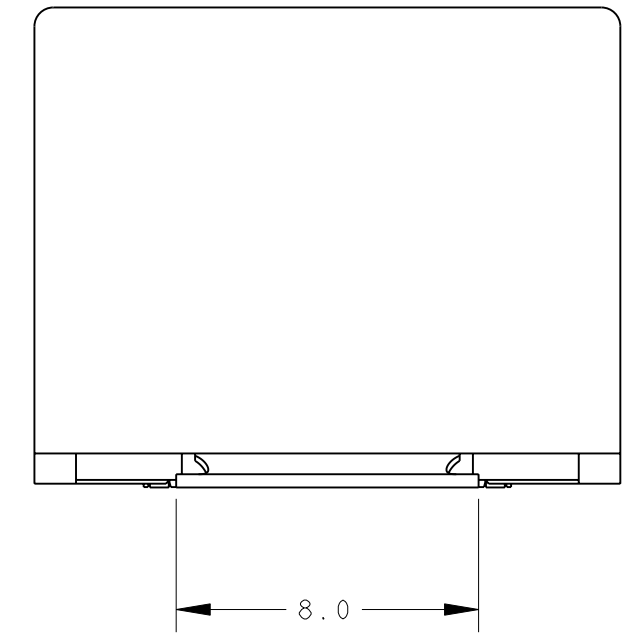
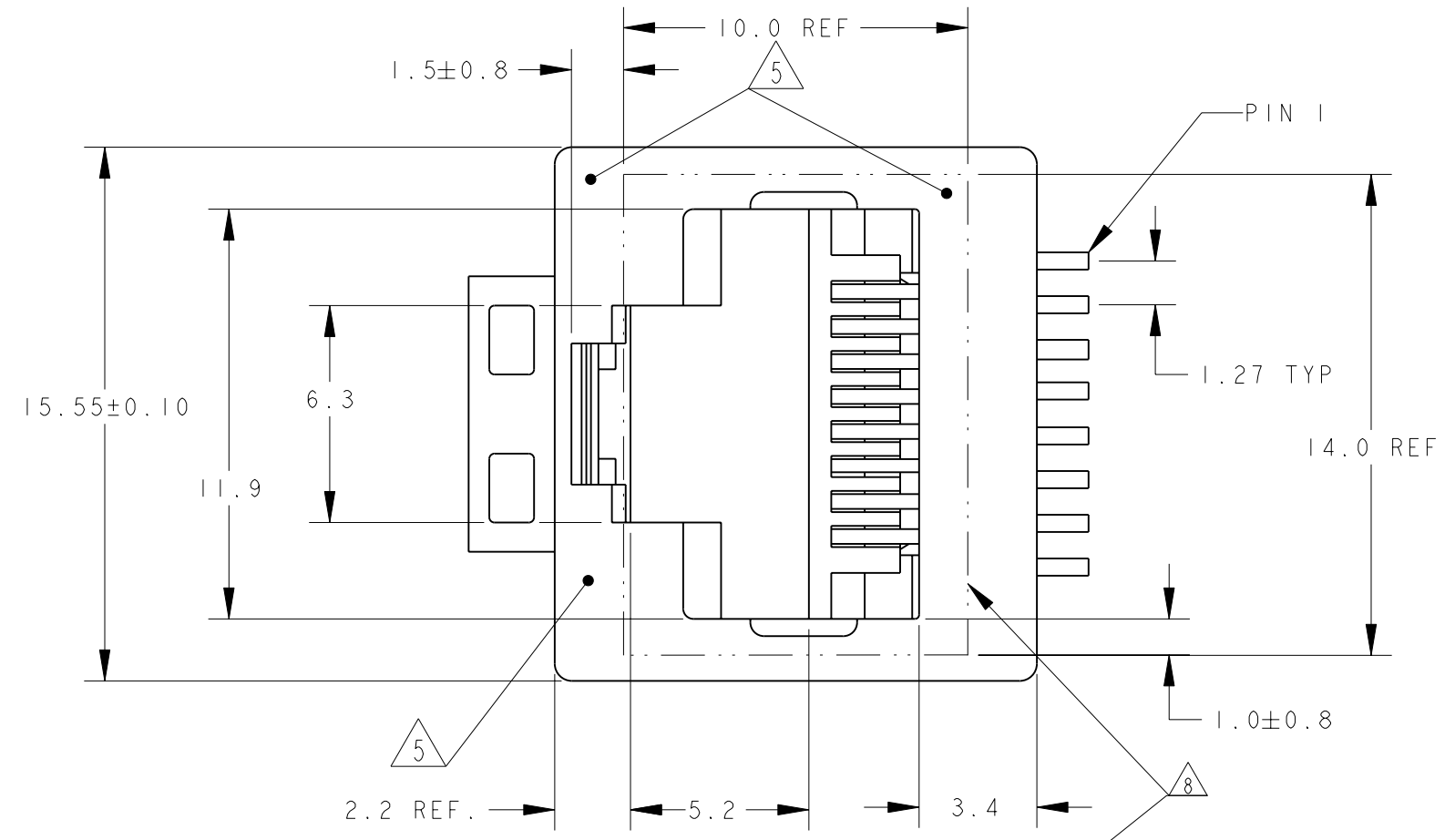
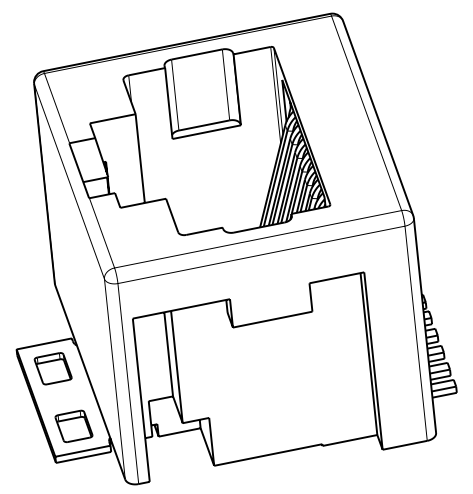

REMARKS	PACKAGING	PART NUMBER
8 POSN./8 CONTACT	250 PCS ON $\varnothing 360$ mm OD REEL TOP ENTRY ORIENTATION PER DETAIL B1	3-338088-3
8 POS./8 CONTACT	250PCS ON $\varnothing 360$ mm OD REEL TOP ENTRY ORIENTATION PER DETAIL B1 WITH KAPTON TAPE FOR PICK AND PLACING	1-338088-6
8 POSN./8 CONTACT	250 PCS ON $\varnothing 360$ mm OD REEL BOTTOM ENTRY ORIENTATION PER DETAIL B2	1-338088-5
8 POSN./8 CONTACT	500 PCS ON $\varnothing 560$ mm OD REEL TOP ENTRY ORIENTATION PER DETAIL B1	2-338088-3
8 POSN./8 CONTACT	250 PCS ON $\varnothing 360$ mm OD REEL TOP ENTRY ORIENTATION PER DETAIL B1	1-338088-3

THIS DRAWING IS A CONTROLLED DOCUMENT.

DIMENSIONS: mm

TOLERANCES UNLESS OTHERWISE SPECIFIED:

0 PLC	±
1 PLC	±
2 PLC	±
3 PLC	±
4 PLC	±
ANGLES	±
FINISH	±

MATERIAL: SEE NOTE 3-

APVD: R.SMEETS

PRODUCT SPEC: 108-19117

APPLICATION SPEC: 114-19041

WEIGHT: 2.1 gr

SCALE: 5:1

SHEET 1 OF 2

REV: W1

TE Connectivity

INVERTIBLE MODULAR JACK,  
8 POSITION  
SURFACE MOUNT APPLICATION

SIZE: A2 CAGE CODE: 0779 DRAWING NO: 338088

THIS DRAWING IS UNPUBLISHED. RELEASED FOR PUBLICATION  
 © COPYRIGHT - TE CONNECTIVITY ALL RIGHTS RESERVED.

LOC	DIST	REVISIONS			
P	LTR	DESCRIPTION	DATE	DWN	APVD
-	-	SEE SHEET 1	-	-	-

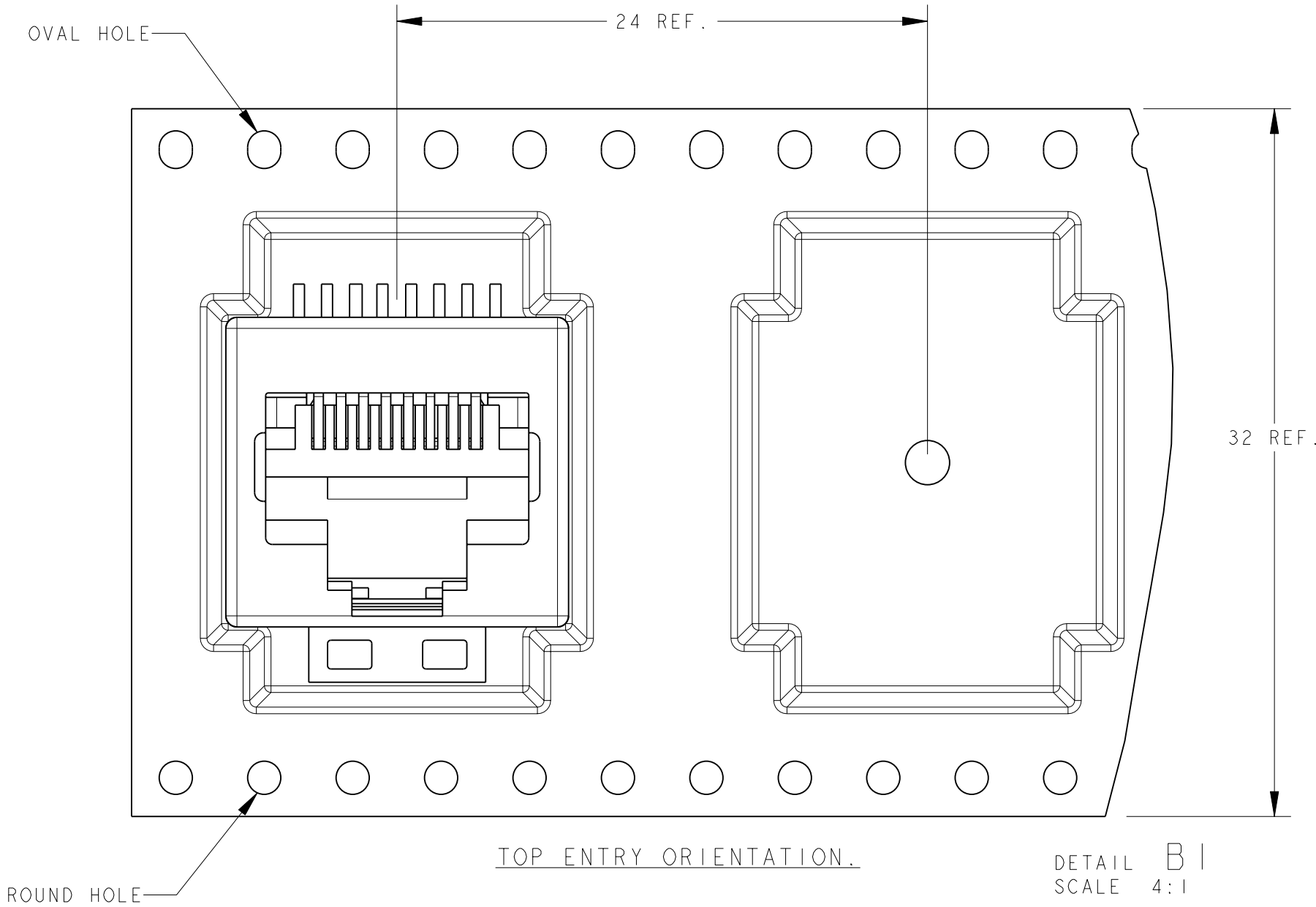

DETAIL B1  
SCALE 4:1

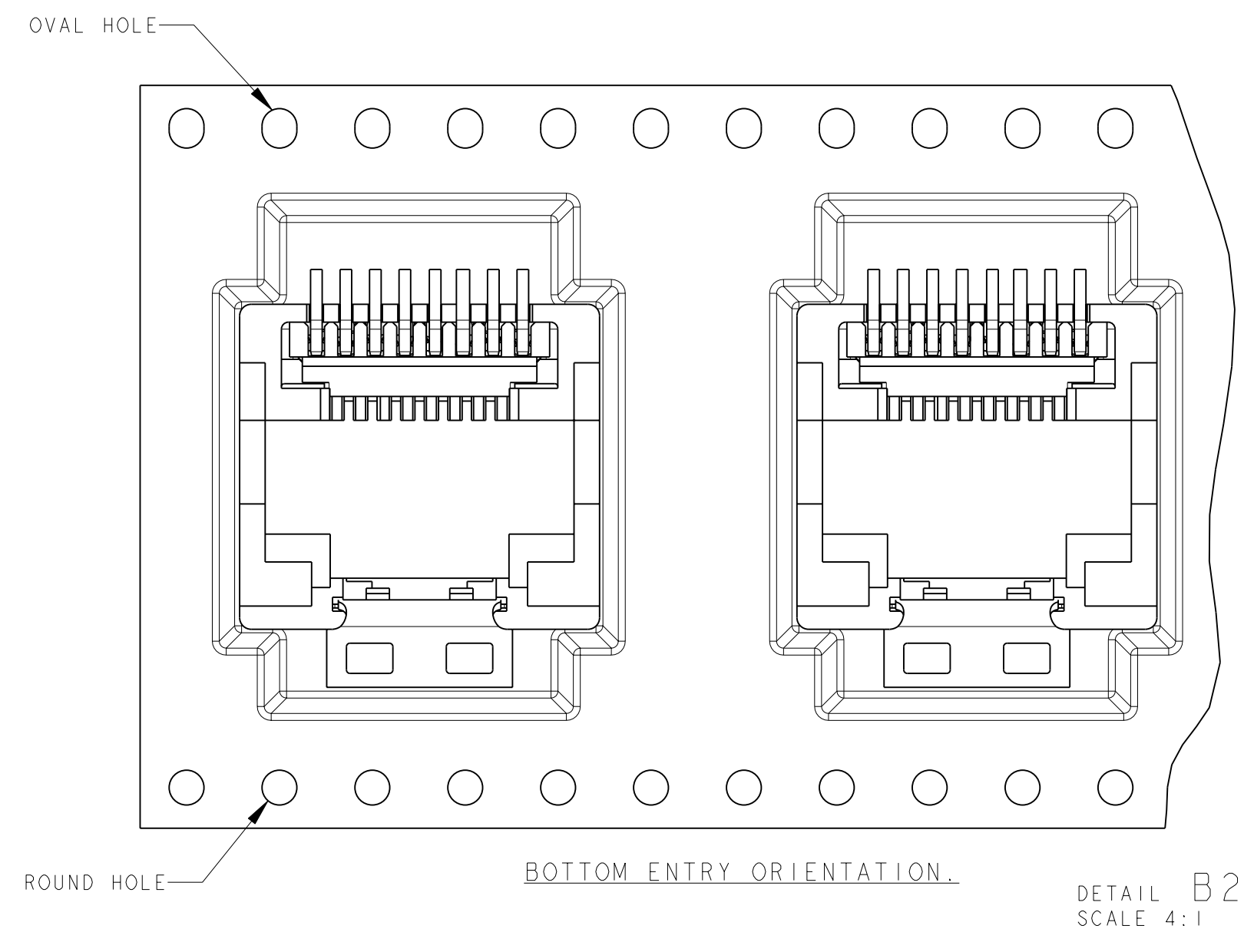

DETAIL B2  
SCALE 4:1

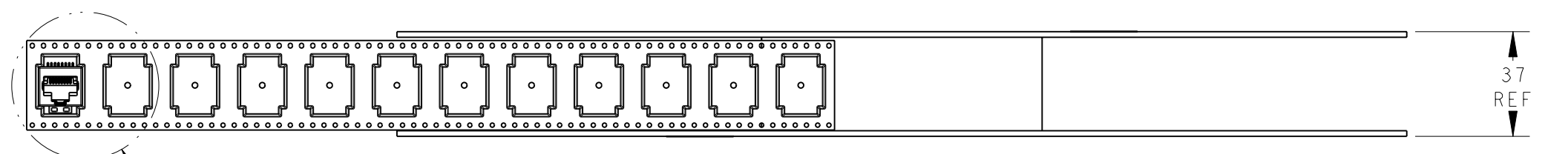

SEE DETAIL B1 & B2

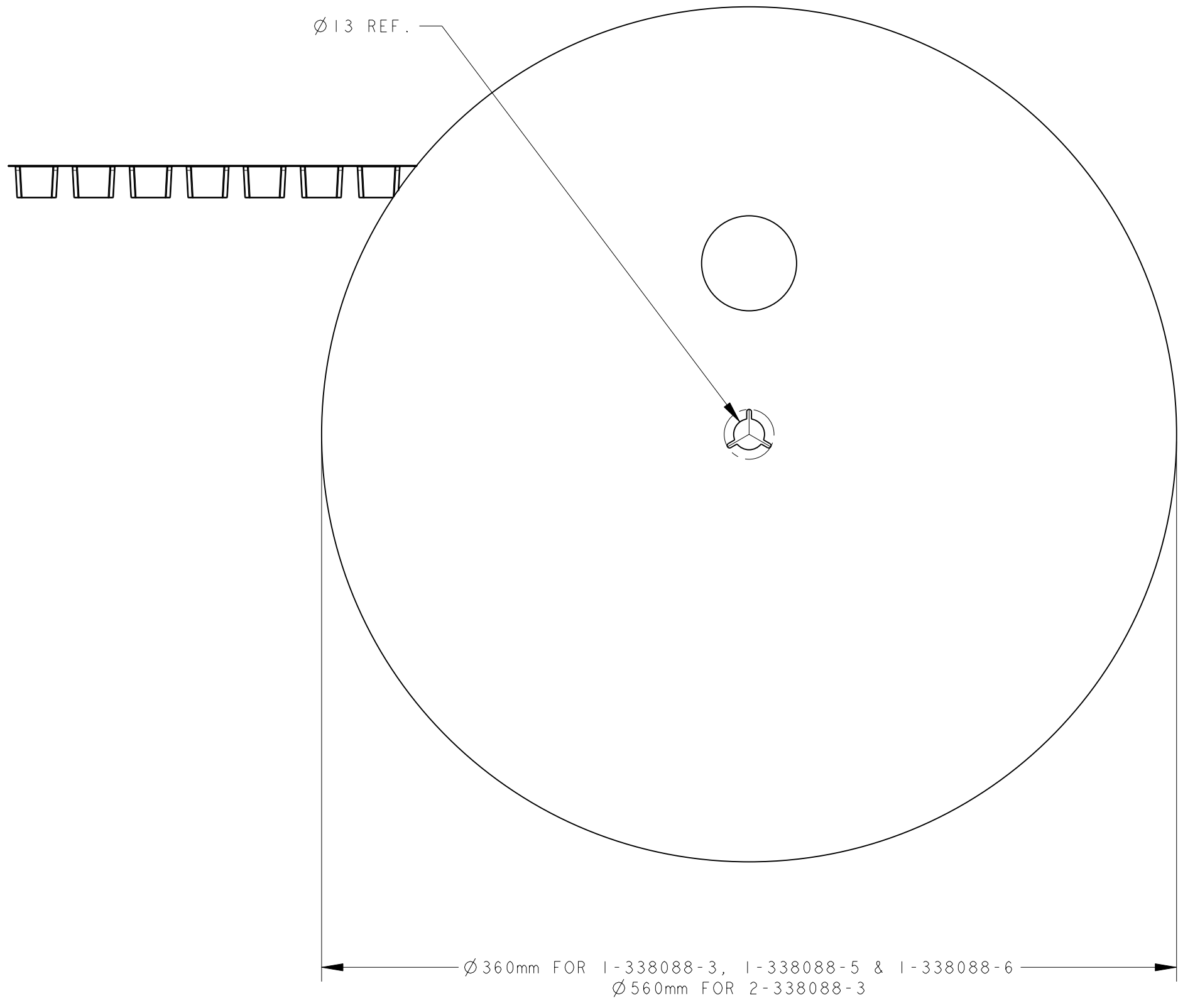

THIS DRAWING IS A CONTROLLED DOCUMENT.		DWN E.v.ELJK 30-Sep-96	TE Connectivity	
DIMENSIONS: mm		CHK E.STELLINGA Dec-96		
TOLERANCES UNLESS OTHERWISE SPECIFIED:		APVD R.SMEETS	NAME INVERTIBLE MODULAR JACK, 8 POSITION SURFACE MOUNT APPLICATION	
0 PLC ± 1 PLC ± 2 PLC ± 3 PLC ± 4 PLC ± ANGLES ± FINISH		PRODUCT SPEC 108-19117	SIZE 114-19041	DRAWING NO A20779C-338088
MATERIAL		WEIGHT 2.1 gr	RESTRICTED TO -	SCALE 5:1 SHEET 2 OF 2 REV. W1
-		CUSTOMER DRAWING		