

1-338088-6 Product Details

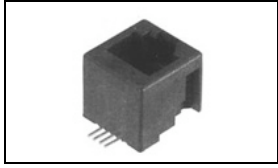

1-338088-6

TE Internal Number: 1-338088-6



PCB Mounted Jacks - Single Port, Multi-port and Stacked

 Converted to EU RoHS/ELV Compliant
(Statement of Compliance)

Product Highlights:

- Connector
- Preloaded
- Single Port Configuration
- 1 x 1 Jack Configuration
- Jack Type = RJ45

Documentation & Additional Information

Product Drawings:

- [INVERTIBLE MODULAR JACK, 8 POSITION SURFACE MOUNT AP...](#) (PDF, English)

Catalog Pages/Data Sheets:

- None Available

Product Specifications:

- None Available

Application Specifications:

- None Available

Instruction Sheets:

- None Available

CAD Files: (CAD Format & Compression Information)

- [2D Drawing](#) (DXF, Version W)
- [3D Model](#) (IGES, Version W)
- [3D Model](#) (STEP, Version W)

Additional Information:

- [Product Line Information](#)

Related Products:

- [Tooling](#)

Product Features (Please use the Product Drawing for all design activity)

Product Type Features:

- Product Type = Connector
- Jack Type = RJ45
- PCB Mounting Orientation = Top Entry (Vertical)
- PCB Mount Style = Surface Mount
- Termination Method to PC Board = Solder
- Performance Category = Cat 3
- LED = Without
- Grounding Options = Without
- Panel Stops = Without
- Keyed = No
- Profile = Standard
- Color = Black
- Latch Style = Standard

Mechanical Attachment:

- Panel Mount Retention = With
- Flanged = No

Electrical Characteristics:

- Shielded = No

Termination Features:

- Solder Tail Contact Plating = Tin over Nickel

Dimensions:

- Height (mm [in]) = 12.70 [0.500]
- PCB Thickness, Recommended (mm [in]) = 1.57 [0.062]

Body Features:

- Inverted Jack Face = No
- Solder Bracket Material = Tin Plated Brass

Contact Features:

- Contact Plating, Mating Area, Material = Conforms to Product Requirements based on Product Specification 108-19117, Gold or Gold Flash over Palladium Nickel
- Contact Base Material = Phosphor Bronze

Housing Features:

- Housing Material = High Temperature Nylon
- UL Flammability Rating = UL 94V-0

Configuration Features:

- Preloaded = Yes
- Port Configuration = Single
- Jack Configuration = 1 x 1
- Number of Positions = 8
- Number of Contacts Loaded = 8

Industry Standards:

- RoHS/ELV Compliance = RoHS compliant, ELV compliant
- Lead Free Solder Processes = Reflow solder capable to 245°C, Reflow solder capable to 260°C
- RoHS/ELV Compliance History = Converted to comply with RoHS directive

Packaging Features:

- Packaging Method = Tape Mounted on Reel
- Packaging Quantity = 250 Pieces (per 36 cm diameter reel)

Product Availability:

- Region = Asia, North America

Other:

- Brand = AMP
- Comment = Kapton tape applied to top surface of jack to facilitate vacuum pickup.; Surface can be used for application by Type II SMD Machine.; This Invertible Modular Jack can also be applied hanging through a hole in the PC Board. (See PCB

be applied hanging through a hole in the PCB board. (See PCB Layout); Surface can be used for application by Type I and Type II SMD machines.; Embossed tape according to EIA 481-3.

THIS DRAWING IS UNPUBLISHED. RELEASED FOR PUBLICATION
 © COPYRIGHT - TE CONNECTIVITY ALL RIGHTS RESERVED.

LOC		DIST		REVISIONS			
P	LTR	DESCRIPTION	DATE	DWN	APVD		
W		ECR-10-020218	28DEC2010	PS	PKS		
WI		3-338088-3 (HALOGEN FREE) ADDED	24AUG2011	PS	RRP		

NOTES:

- 1 TOLERANCES UNLESS OTHERWISE SPECIFIED: ±0.15.
- 2 CONTACT PLATING:
OVERALL: Ni 1.27µm MIN. ALL OVER THE CONTACTS
SOLDER ZONE: Sn 3.5-5.0µm ON THE SOLDER ZONE OF THE CONTACT
MATING ZONE: PLATING CONFIRMS TO PRODUCT REQUIREMENTS AS PER SPECIFICATION 108-19117
- 3 CONTACT AND BRACKET MATERIAL:
CONTACTS: PHOSPHOR BRONZE
SOLDER BRACKET: TINPLATED BRASS WITH NICKEL UNDERLAYER.
- 4 THIS JACK CAN ALSO BE APPLIED HANGING THROUGH A HOLE, IN A PRINTED CIRCUIT BOARD. SEE LEFT PCB LAYOUT.
- 5 SURFACE CAN BE USED FOR PICKING THE MODULAR JACK WITH, TYPE 11 SMD MACHINE.
- 6 MEASURED AT HEEL OF CONTACTS, COPLANARITY AT TIPS MAX. 0.18mm.
- 7 TAPE AND REEL PACKAGING ACCORDING TO EIA 481-3 SPECIFICATIONS.
- 8 INCLUDES KAPTON TAPE (10mm x 14mm) ON TOP SURFACE FOR PICK AND PLACE UNIT
- 9 OBSOLETE
- 10 HOUSING MATERIAL:
HOUSING: 30% G.F. P.A 9T, COLOR BLACK, UL 94V-0.
- 11 HOUSING MATERIAL:
HOUSING: 30% G.F. LCP (HALOGEN FREE), COLOR BLACK, UL 94V-0.

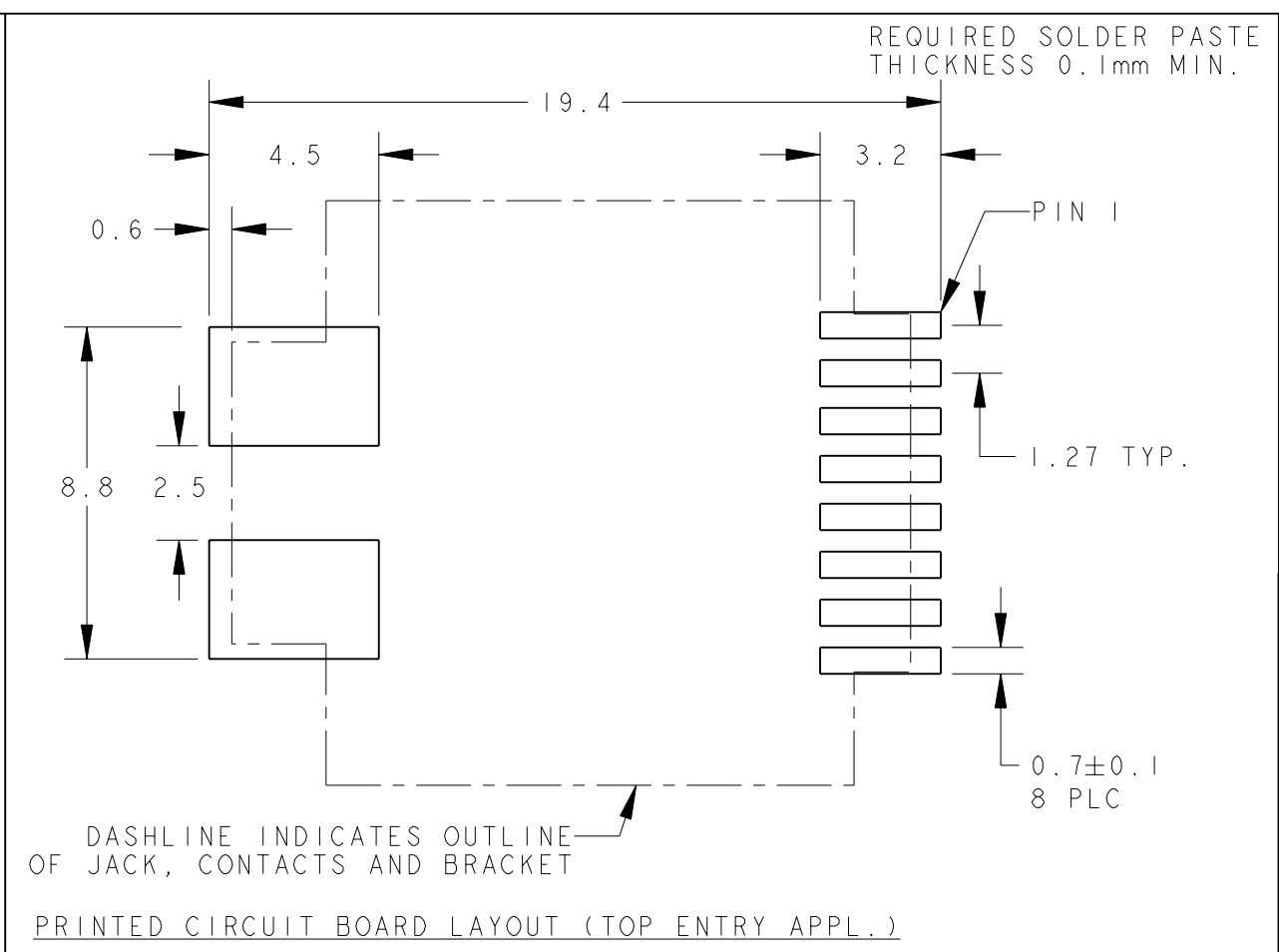
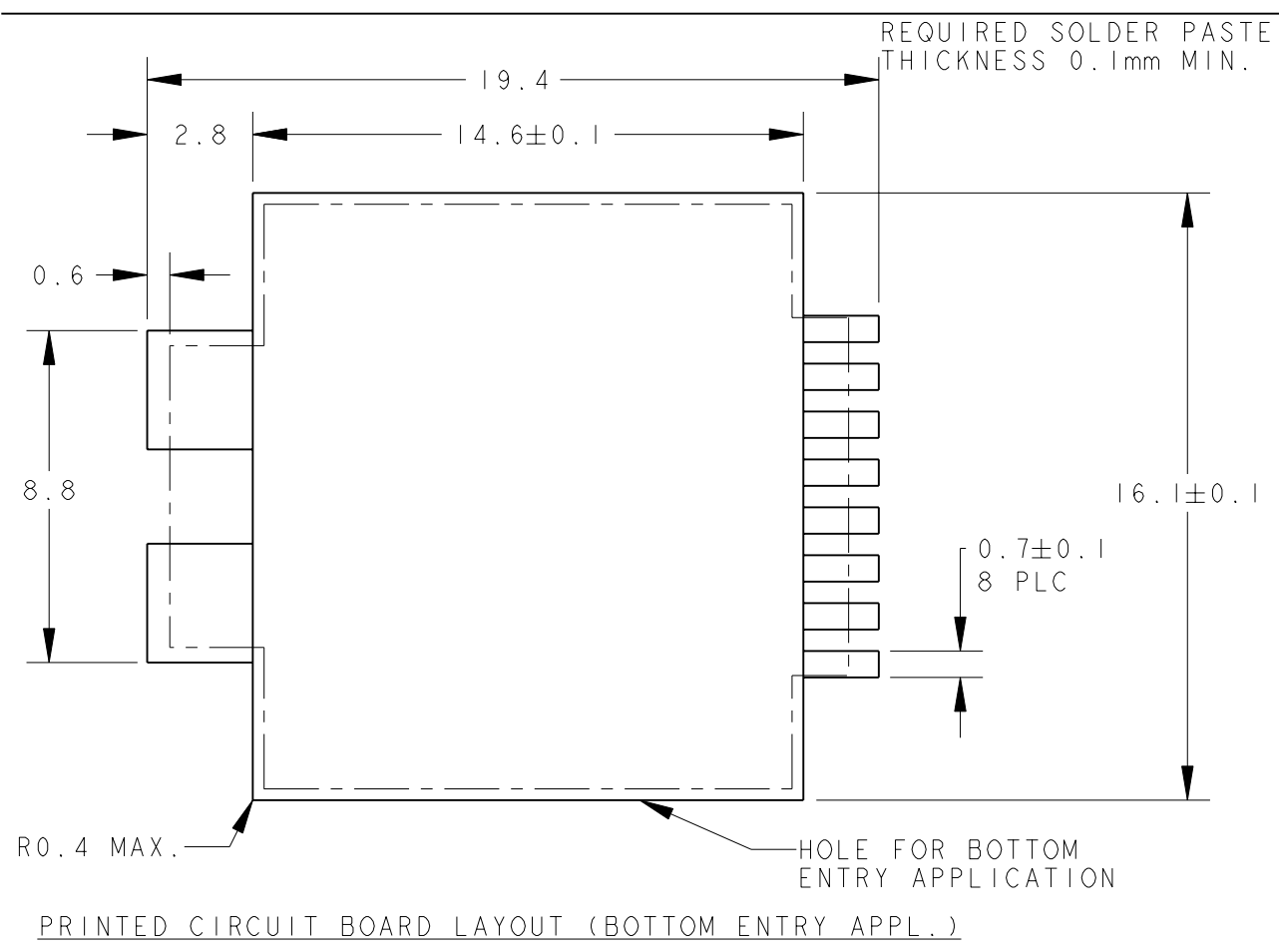
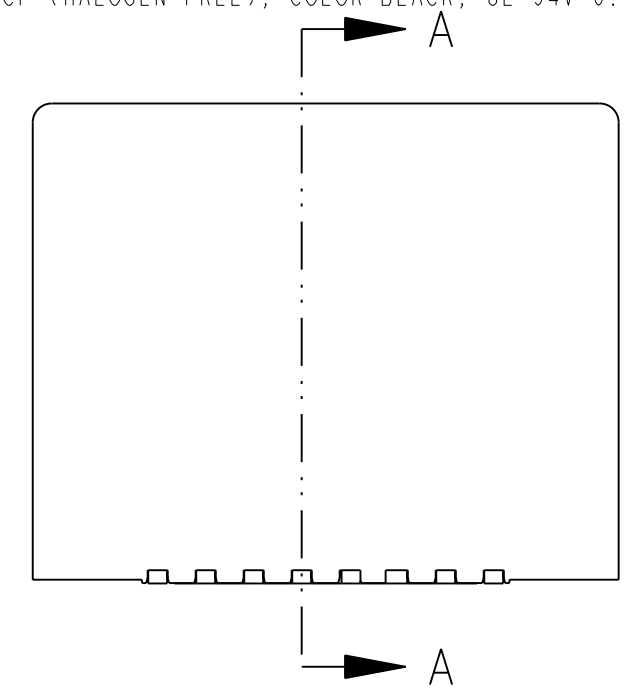
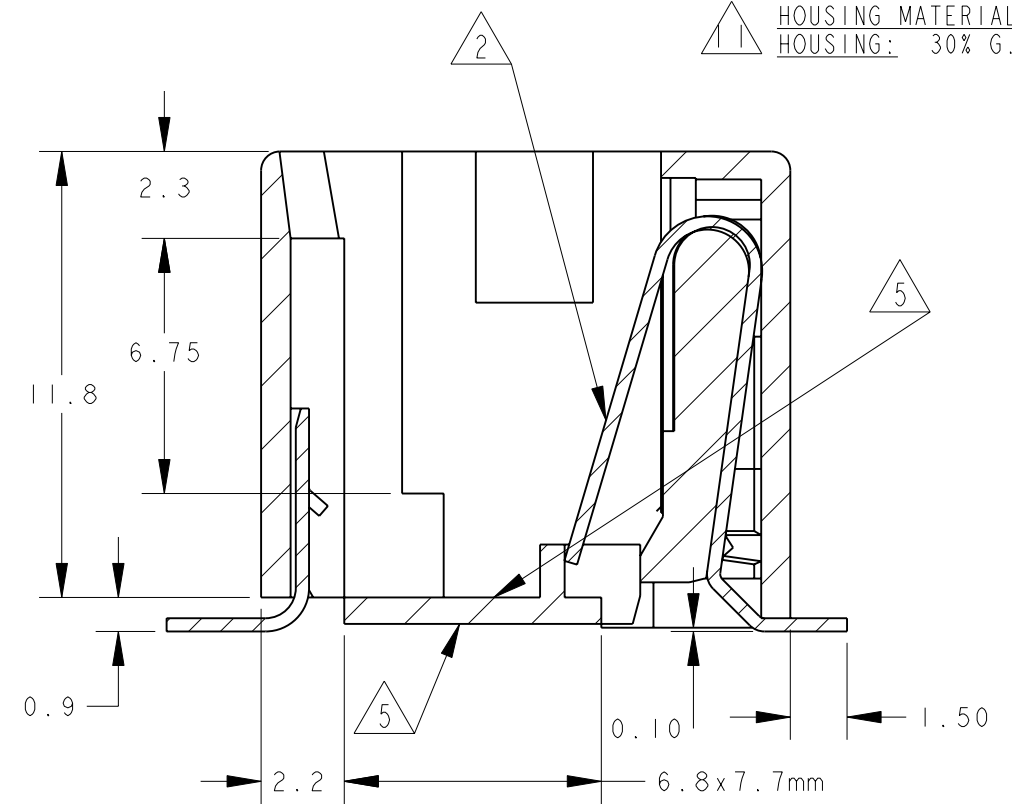
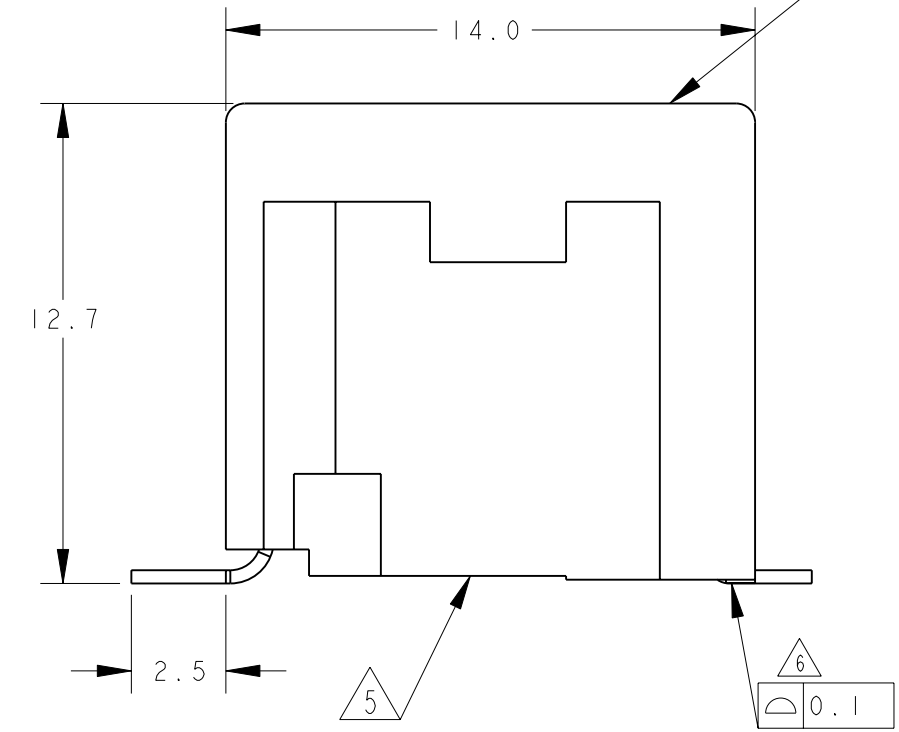
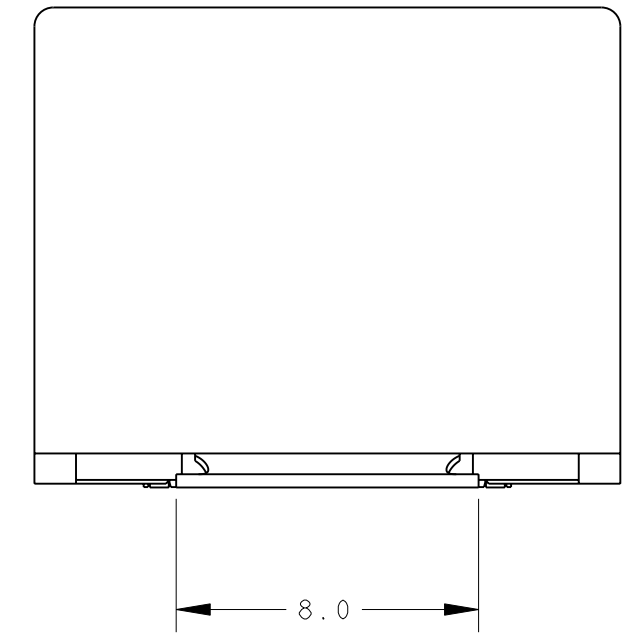
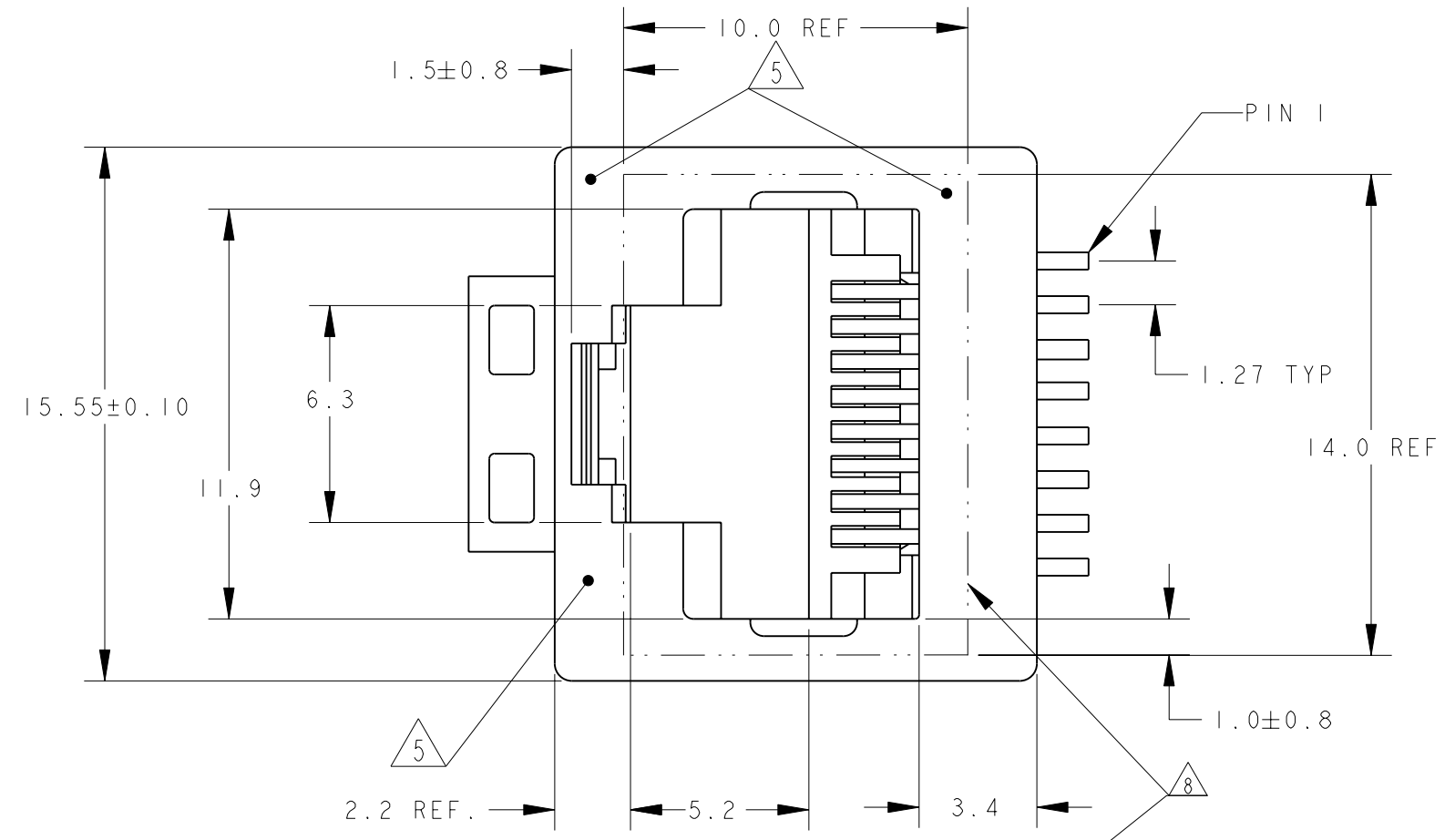
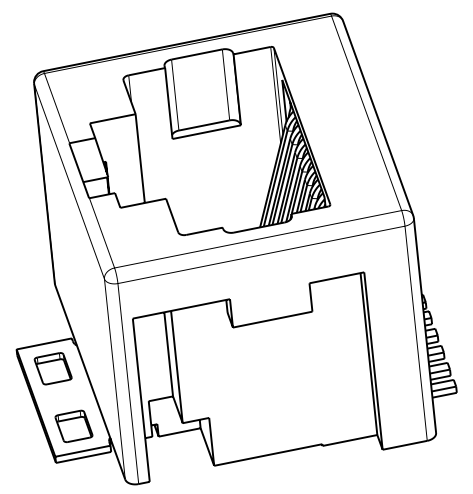

8 POSN./8 CONTACT	250 PCS ON Ø360mm OD REEL TOP ENTRY ORIENTATION PER DETAIL B1	3-338088-3
8 POS./8 CONTACT	250PCS ON Ø360mm OD REEL TOP ENTRY ORIENTATION PER DETAIL B1 WITH KAPTON TAPE FOR PICK AND PLACING	1-338088-6
8 POSN./8 CONTACT	250 PCS ON Ø360mm OD REEL BOTTOM ENTRY ORIENTATION PER DETAIL B2	1-338088-5
8 POSN./8 CONTACT	500 PCS ON Ø560mm OD REEL TOP ENTRY ORIENTATION PER DETAIL B1	2-338088-3
8 POSN./8 CONTACT	250 PCS ON Ø360mm OD REEL TOP ENTRY ORIENTATION PER DETAIL B1	1-338088-3

REMARKS: THIS DRAWING IS A CONTROLLED DOCUMENT.

APVD: R. SMEETS

DATE: 30-Sep-96

CHK: E. STELLINGA

DATE: Dec-96

NAME: INVERTIBLE MODULAR JACK, 8 POSITION SURFACE MOUNT APPLICATION

TE Connectivity

SCALE: 5:1

SHEET 1 OF 2

REV: W1

THIS DRAWING IS UNPUBLISHED. RELEASED FOR PUBLICATION
 © COPYRIGHT - TE CONNECTIVITY ALL RIGHTS RESERVED.

LOC	DIST	REVISIONS			
P	LTR	DESCRIPTION	DATE	DWN	APVD
IR	-	SEE SHEET 1	-	-	-

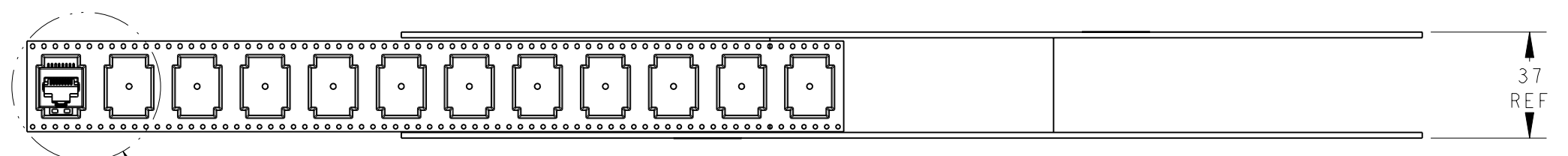
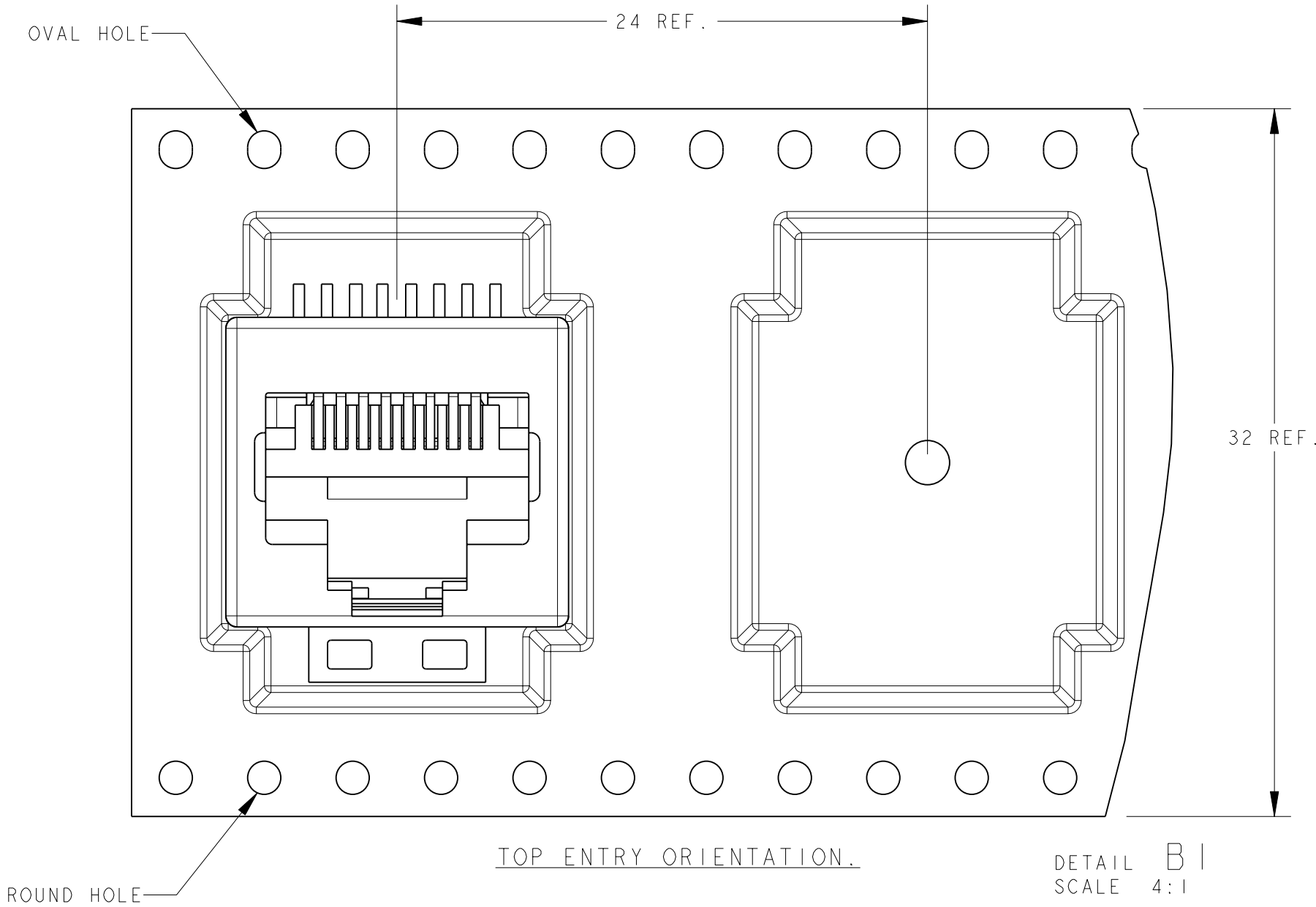

SEE DETAIL B1 & B2

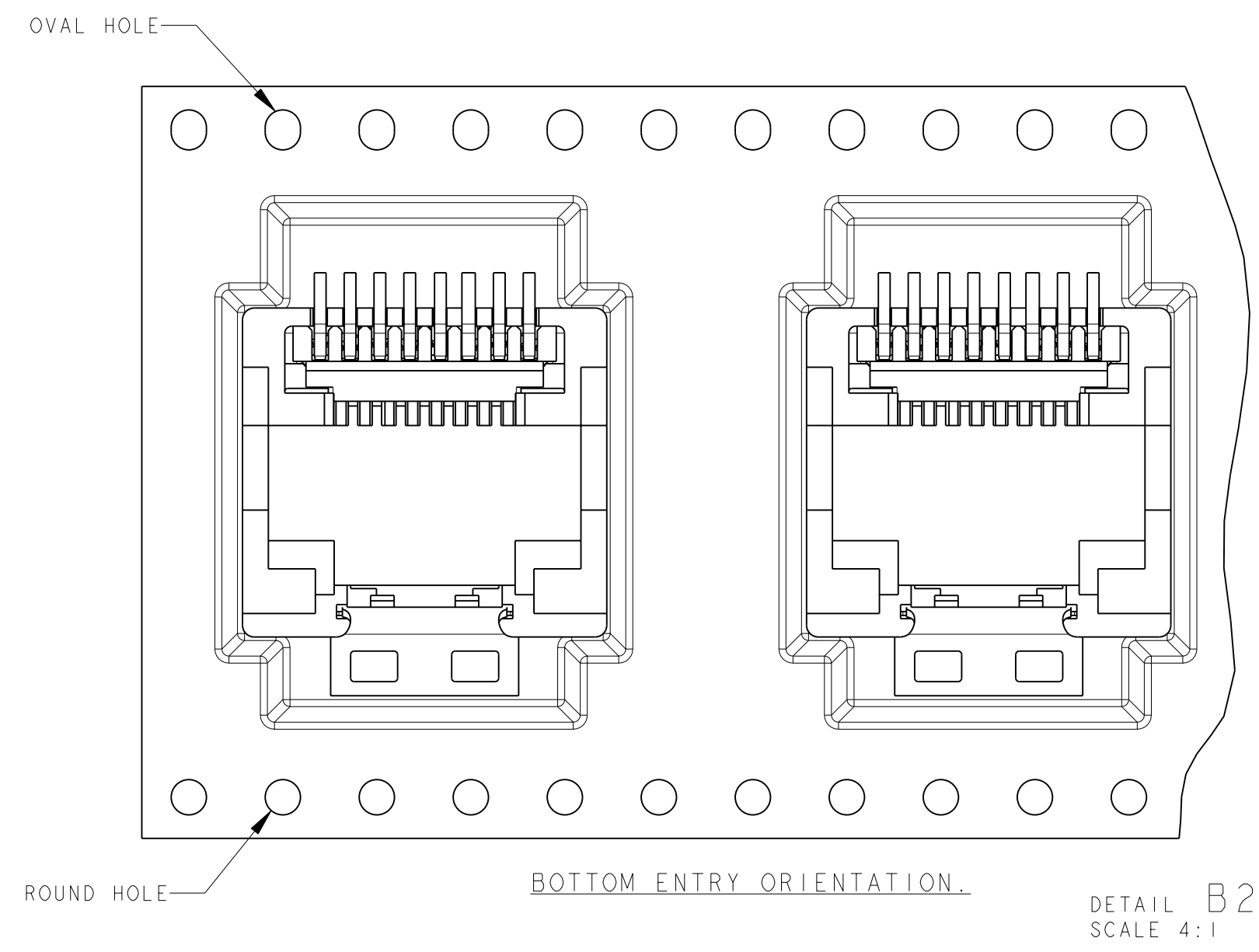
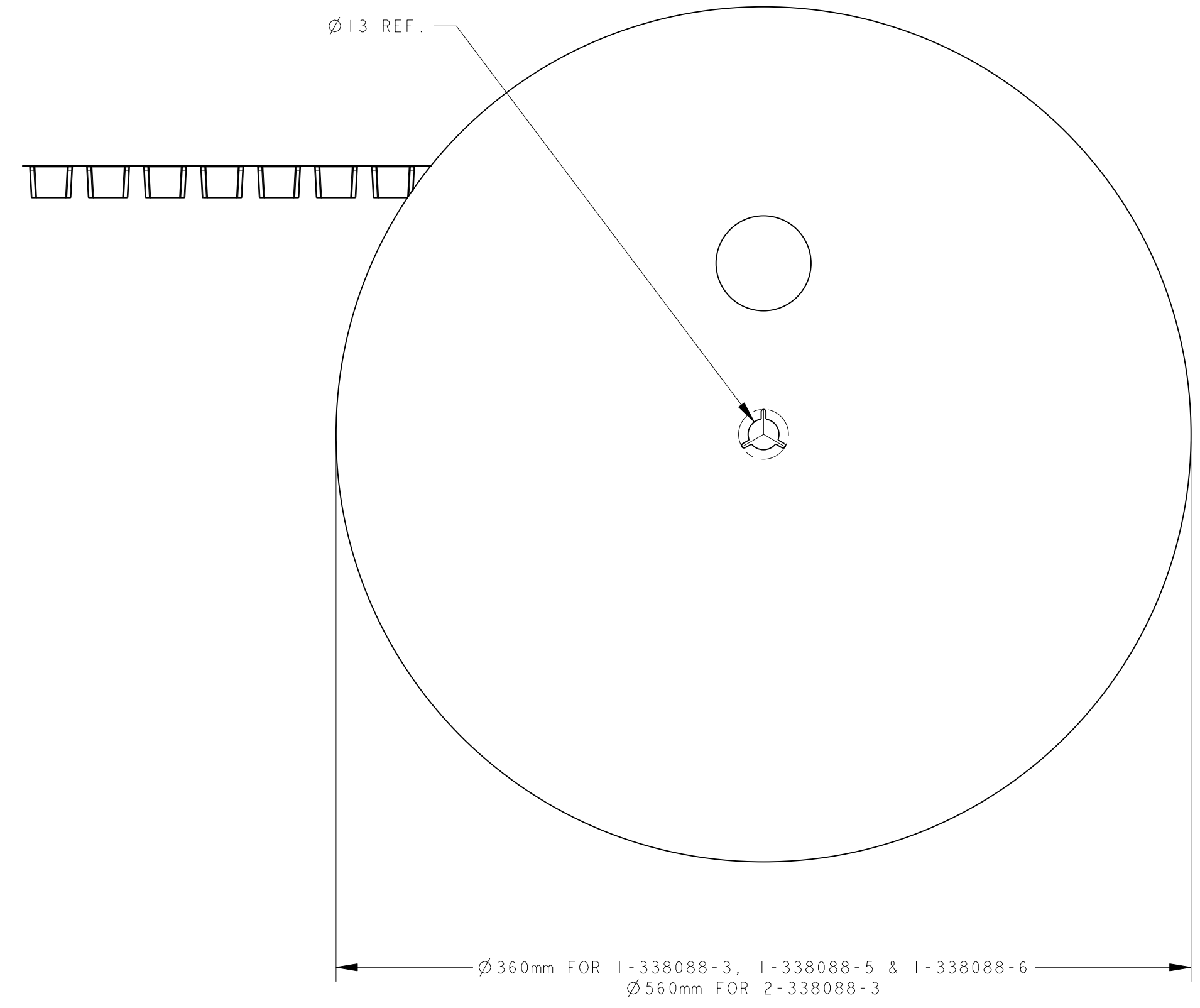

THIS DRAWING IS A CONTROLLED DOCUMENT.		DWN E.v.ELJK 30-Sep-96	TE Connectivity	
DIMENSIONS: mm		CHK E.STELLINGA Dec-96		
TOLERANCES UNLESS OTHERWISE SPECIFIED:		APVD R.SMEETS	NAME INVERTIBLE MODULAR JACK, 8 POSITION SURFACE MOUNT APPLICATION	
0 PLC ±	1 PLC ±	PRODUCT SPEC 108-19117	SIZE	CAGE CODE
2 PLC ±	3 PLC ±	APPLICATION SPEC 114-19041	DRAWING NO	RESTRICTED TO
4 PLC ±	ANGLES ±	WEIGHT 2.1 gr	A20779	C-338088
FINISH		CUSTOMER DRAWING	SCALE 5:1	SHEET 2 OF 2