

Distributed by:

**JAMECO**<sup>®</sup>  
ELECTRONICS

**www.Jameco.com ♦ 1-800-831-4242**

The content and copyrights of the attached  
material are the property of its owner.

Jameco Part Number 745580

4 3 2 1  
 DRAWING MADE IN THIRD ANGLE PROJECTION  
 THIS DRAWING IS UNPUBLISHED. RELEASED FOR PUBLICATION, 19  
 © COPYRIGHT 19 BY AMP INCORPORATED. ALL INTERNATIONAL RIGHTS RESERVED.

LOC	DIST	P	F	ZONE	LTR	REVISIONS	DATE	APPD
CM	54					REV & REDWN PER EC CM-11	2-10-94	RV
					K	REACT 1--1 PER PR CM 94-11		RS

- ① MATERIAL: POST - 0.56 BRASS  
STRIP - EXTRUDED POLYETHYLENE  
FINISH: BRIGHT TIN-LEAD
- ② MAY BE 3.81/1.78 WHERE TOP ENTRY OR SIDE ENTRY RECEPTACLES ARE USED.
- ③ THIS DIMENSION APPLIES WHEN STRIP IS HELD FLAT.

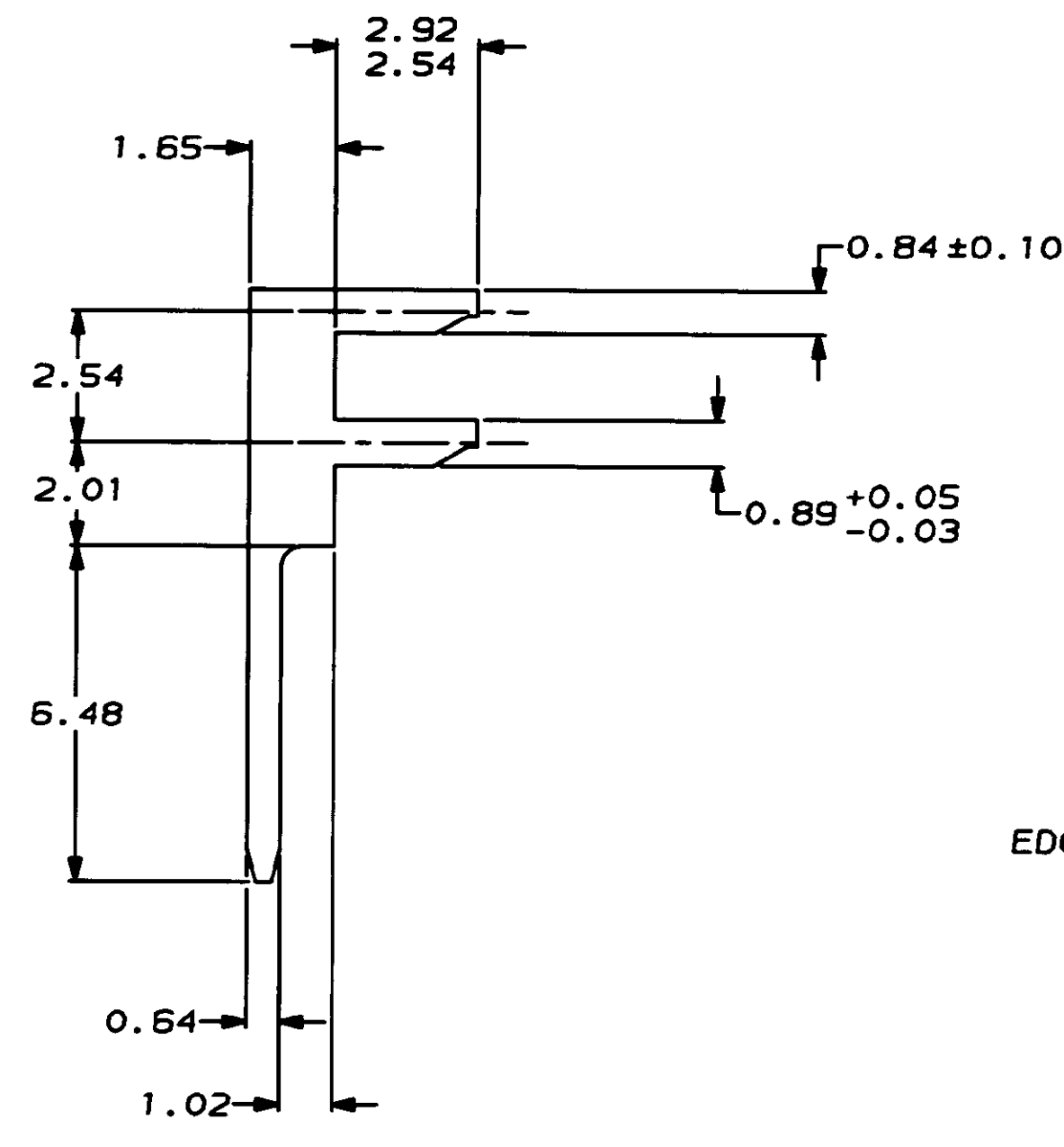
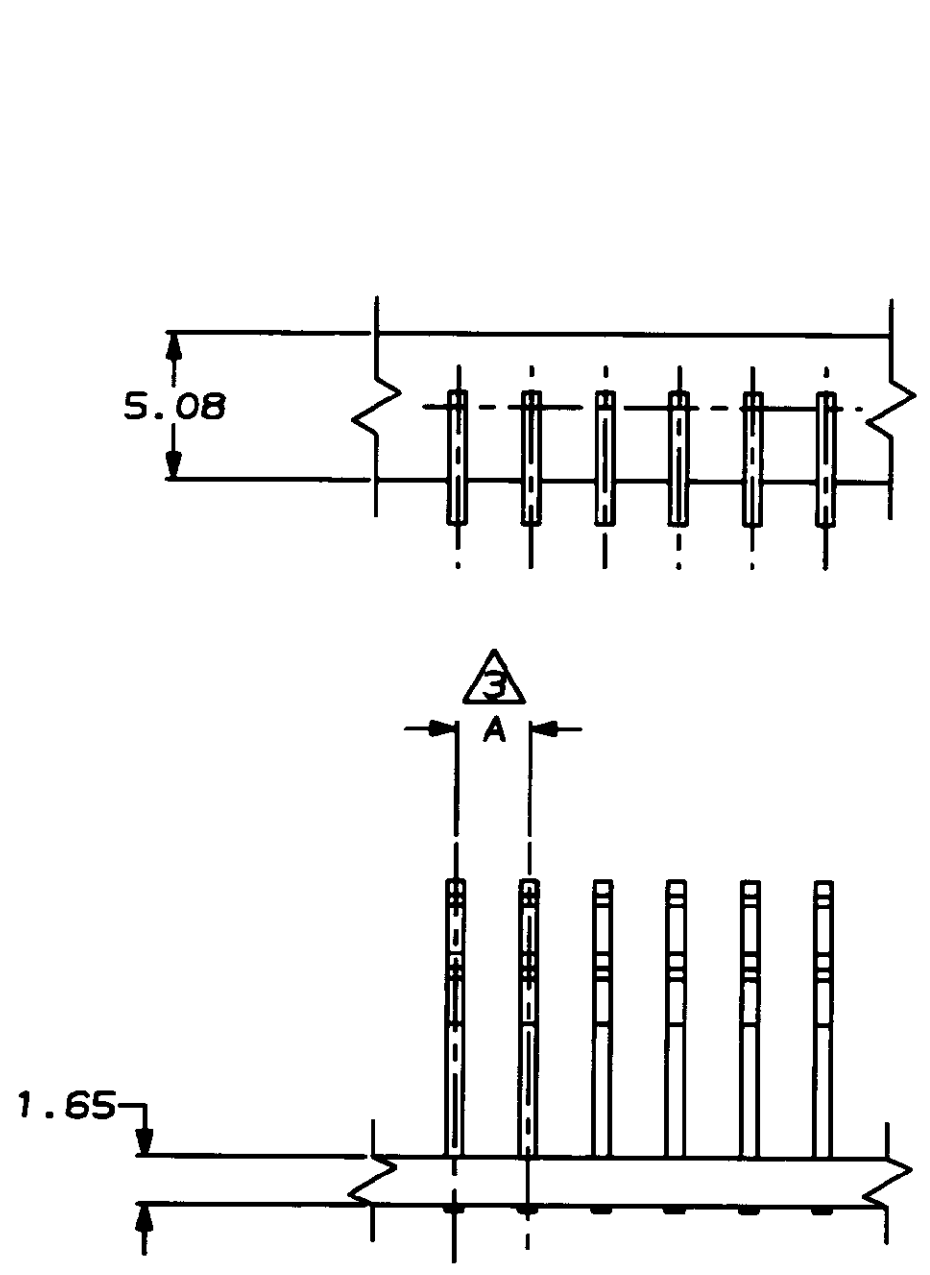

SCALE 8:1

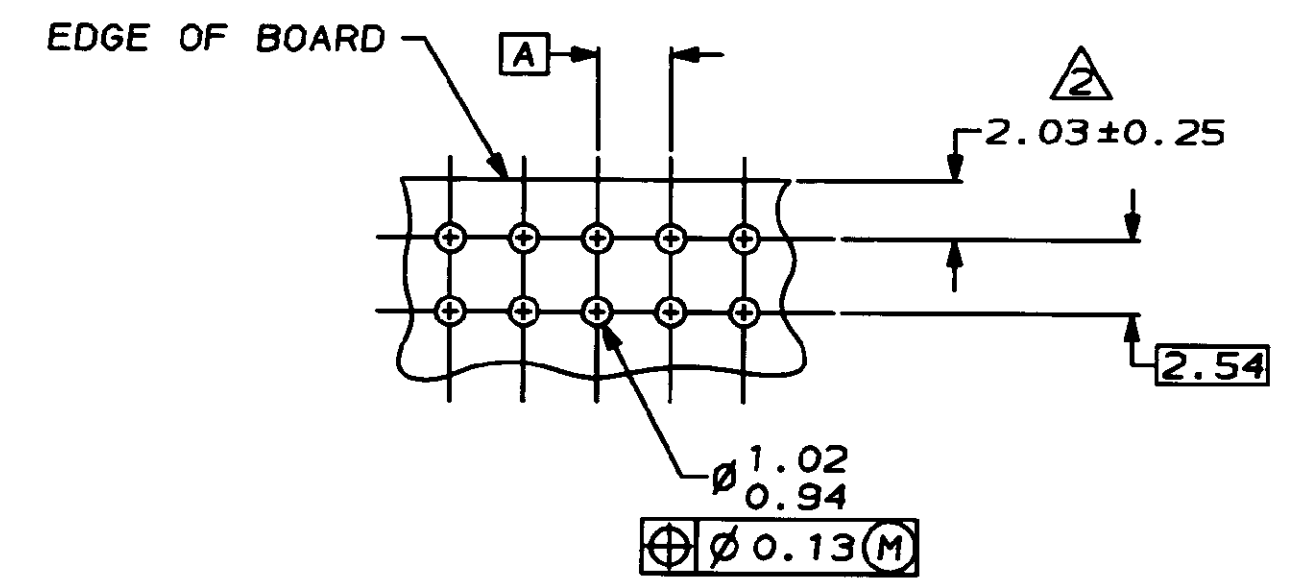

RECOMMENDED MOUNTING PATTERN

MM	IN	MM	IN
0.94	.037	-	-
0.89	.035	6.48	.255
0.84	.033	5.08	.200
0.64	.025	3.81	.150
0.56	.022	2.92	.115
0.38	.015	2.54	.100
0.25	.010	2.03	.080
0.13	.005	2.01	.079
0.10	.004	1.78	.070
0.05	.002	1.65	.065
0.03	.001	1.02	.040

CONVERSION TABLE

**METRIC**

THIS DRAWING IS A CONTROLLED DOCUMENT FOR AMP INCORPORATED. IT IS SUBJECT TO CHANGE AND THE CONTROLLING ENGINEERING ORGANIZATION SHOULD BE CONTACTED FOR THE LATEST REVISION.

DO NOT SCALE PRINT. UNLESS SPECIFIED DIMENSIONS IN mm (INCHES) TOLERANCES ON: 2 PLC DEC ± 0.38 3 PLC DEC ± - ANGLES ± -	DR 2-10-94 R. VESTAL
MATERIAL	CHK 2-10-94 R. SWING
FINISH	APPD 2-10-94 E. BEILES
	APPD 2-10-94 E. BEILES
	PRODUCT SPEC
	APPLICATION SPEC
	WEIGHT

2,500	2.54	1-380953-2
30,000	3.81	1-380953-1
30,000	2.54	1-380953-0
QUANTITY PER REEL	A	PART NO
<b>AMP</b> AMP Incorporated Harrisburg, PA 17105-3608		
NAME <b>F POST, STRIP, C.I.S.</b>		
SIZE	CAGE CODE	DRAWING NO
©	00779	©-380953
SCALE	4:1	SHEET
		1 OF 1

CUSTOMER DRAWING

A/C BUSINESS GROUP 3523 177-34 RALPH VESTAL

380953