

DRAWING MADE IN THIRD ANGLE PROJECTION
 RELEASED FOR PUBLICATION
 BY AMP INCORPORATED, PHILADELPHIA, PA. ALL INTERNATIONAL RIGHTS RESERVED. AMP PRODUCTS MAY BE COVERED BY U.S. AND FOREIGN PATENTS AND/OR PATENT PENDING.

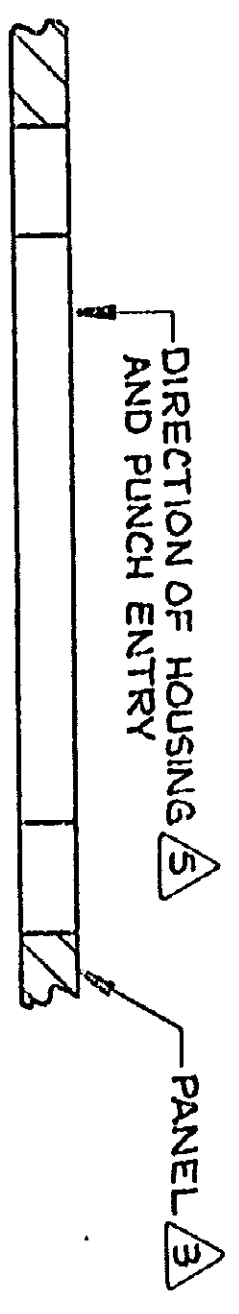
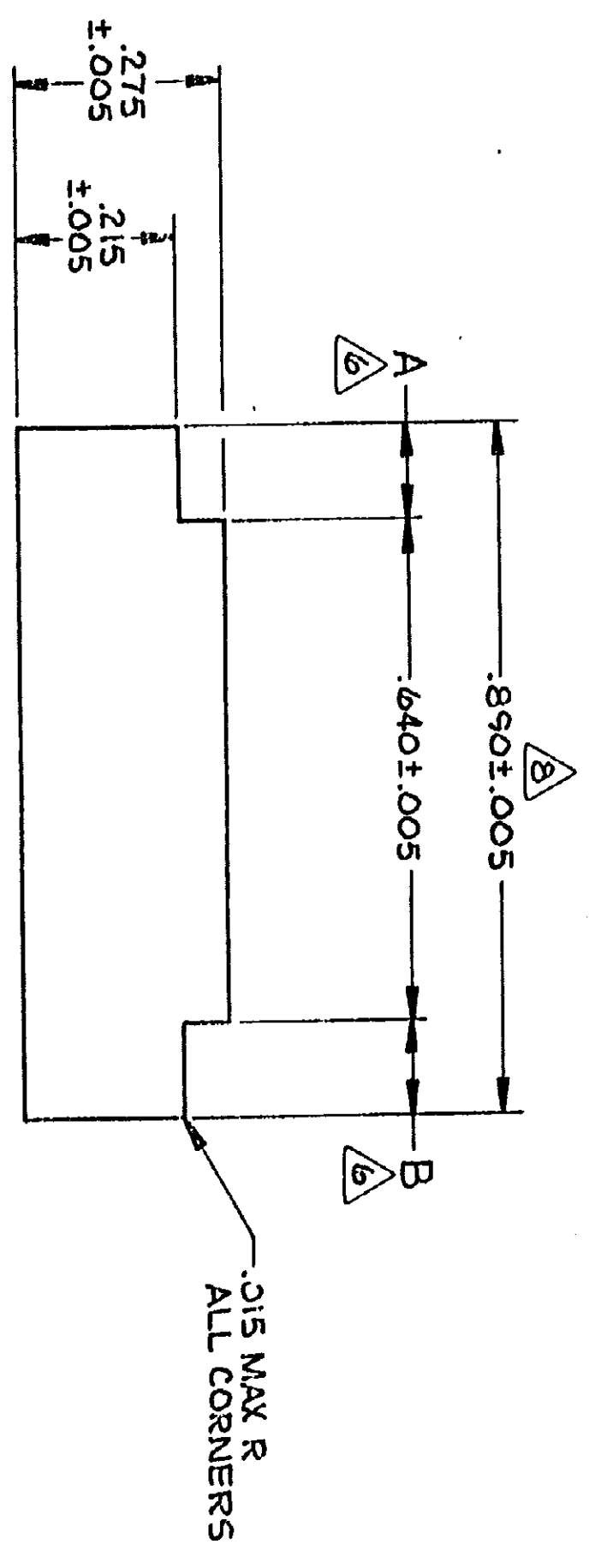
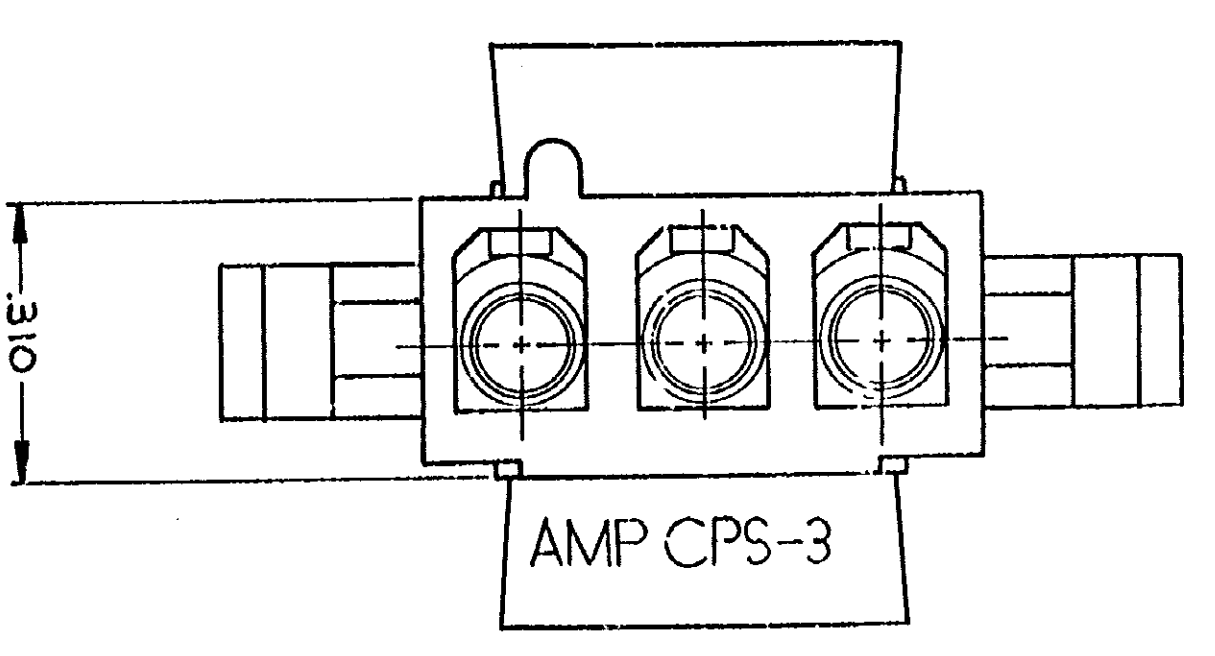
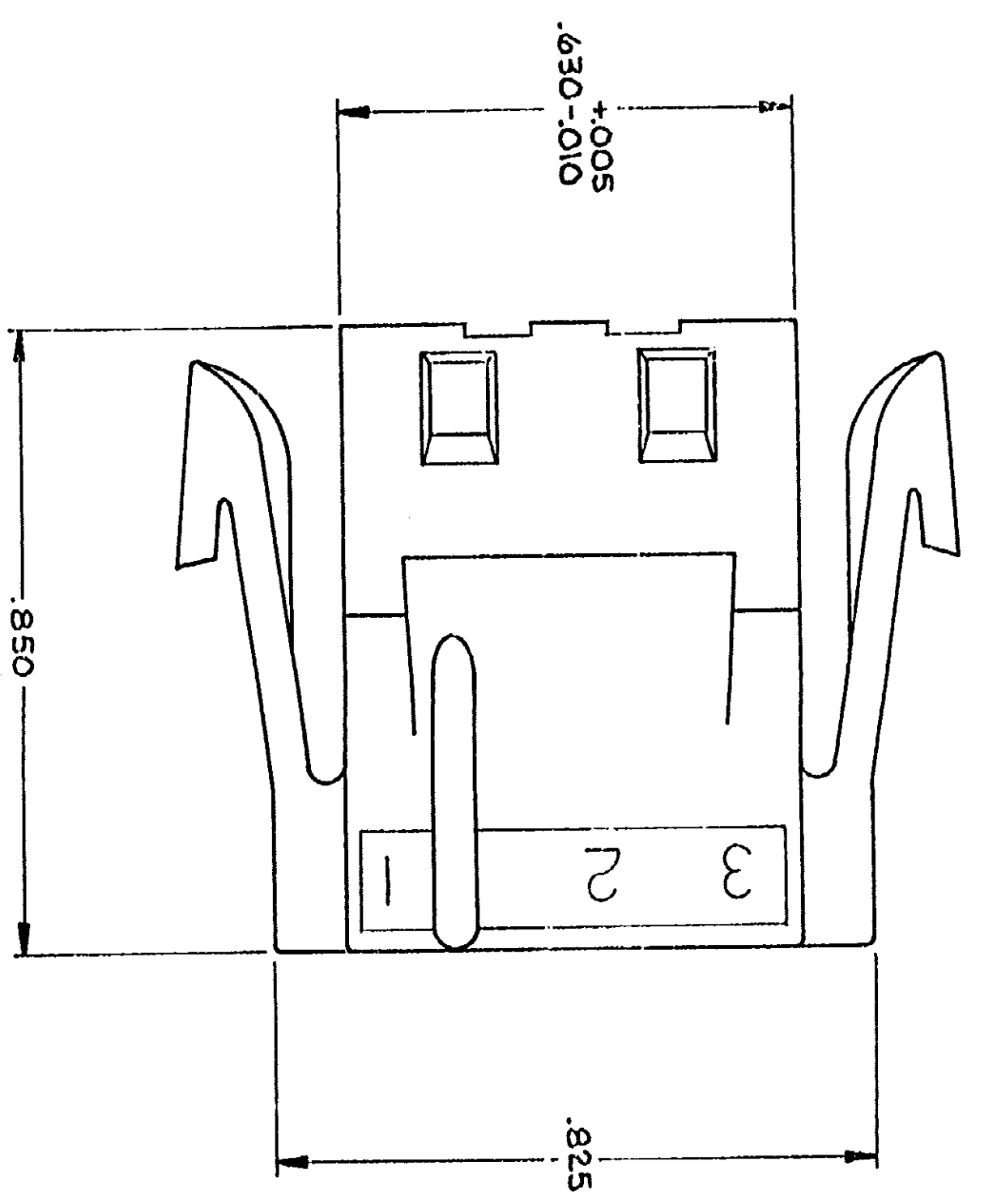
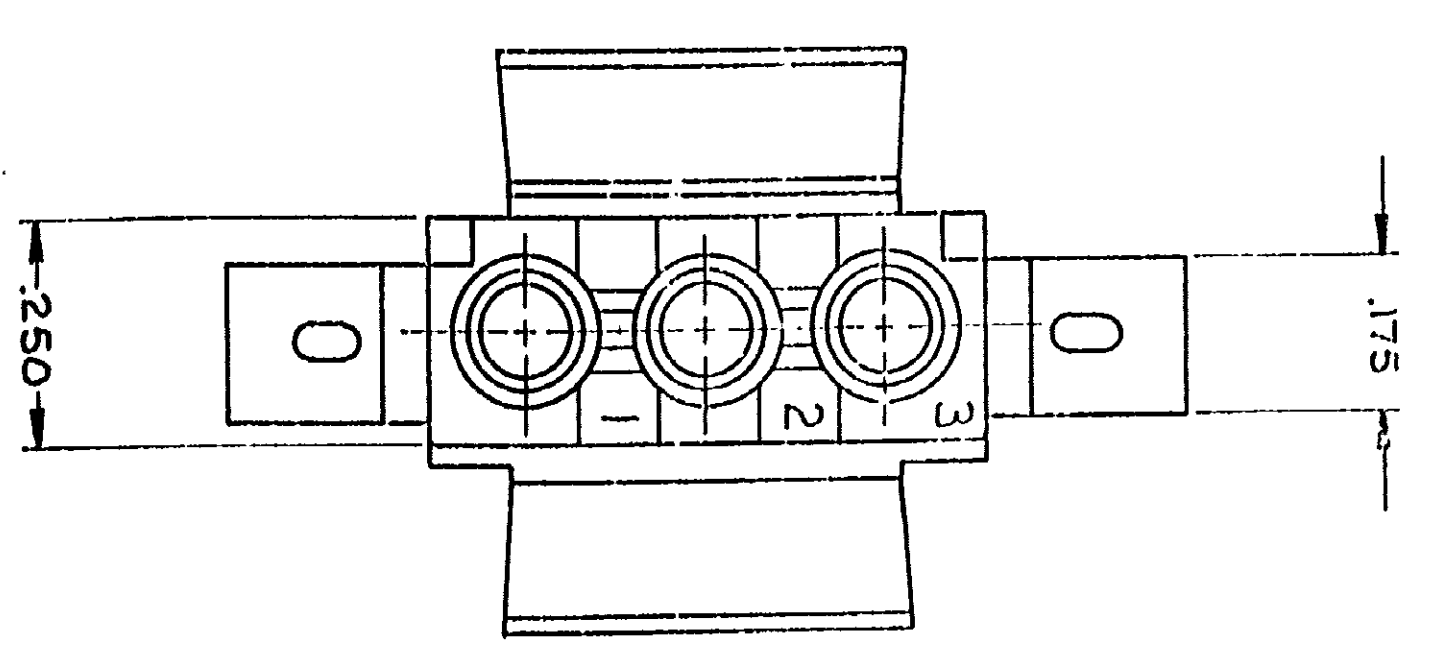

REV	DATE	APPROVED	DESCRIPTION
1	5-30-86	MJ/res	OBsolete 1-2, 1-5, 1-7, 1-8 PER CM-473. REVISED AND REDRAWN PER CM-589
2	6-3-86		OBsolete 1-2, 1-4, 1-6 PER CM-895 AND REV PER CM-503
3	1-23-88	RS	REVISE PER CM-1821
4	1-23-88	RS	REV PER CM-3430
5	12-21-85	RS	REV PER CM-3603
6	1-11-93	RS	OBsolete 1-9 PER CM-2708

1. MATES WITH CAP PART NUMBER 480305.
 2. ACCEPTS MATE-N-LOK SOCKET CONTACTS.
 3. RECOMMENDED PANEL THICKNESS .025-.065.
 4. BOTH LOCKING LEGS TO BE SQUEEZED TOGETHER AND HOUSING TO BE INSERTED "STRAIGHT-IN" AS OPPOSED TO A ROCKING MANNER OF INSERTION.
 5. PANEL MUST BE PUNCHED SO THAT THE HOUSING ENTERS THE PANEL IN THE SAME DIRECTION AS THE PUNCH.
 6. DIMENSIONS A AND B TO BE EQUAL WITHIN .005.
 7. PANEL MUST NOT HAVE ANY MATERIAL (PAINT, PORCELAIN, ETC.) APPLIED IN THE MOUNTING HOLE AREA THAT WOULD DECREASE RETENTION OF THE HOUSING IN THE PANEL.
- IF NOTES 5 AND/OR 7 ARE NOT COMPLIED WITH, THE .890 DIMENSION SHOULD BE REDUCED TO .880 TO ASSURE PROPER HOUSING RETENTION IN THE PANEL.

UNLESS OTHERWISE SPECIFIED, DIMENSIONS ARE IN INCHES. TOLERANCES ± .010 ANGLES ± .010		CONTRACT NO. AMP 5-30-86	
MATERIAL		DR. W. J. ...	CHK. ...
FINISH		APPRO. M. ...	DATE 6-3-86
OTHER APPRO.		DESIGN APPRO.	
SIZE D	FSCM NO. 00779	DRAWING NO. 480304	SHEET 1 OF 1
SCALE 5:1		NAME AMP INCORPORATED	
COLOR NATURAL		MATERIAL NYLON, UL 94V-2	
PART NO. 1-480304-0		PART NO.	
NAME AMP INCORPORATED		PHILADELPHIA, PA. 19103	
NAME PLUG,		CIRCUIT, 3	
NAME MATE-N-LOK™		DRAWING NO. 480304	

CUSTOMER DRAWING